

# Site Inventory Form

State Historical Society of Iowa

(November 2005)

State Inventory No. 92-00580

New  Supplemental

Part of a district with known boundaries (enter inventory no.) 92-00349

Relationship:  Contributing  Noncontributing

Contributes to a potential district with yet unknown boundaries

National Register Status:(any that apply)  Listed  De-listed  NHL  DOE

9-Digit SHPO Review & Compliance (R&C) Number \_\_\_\_\_

Non-Extant (enter year) \_\_\_\_\_

## 1. Name of Property

historic name G & S Wine and Spirits

other names/site number Downtown Survey Map # DT- 111

## 2. Location

street & number 106 W. Second Street

city or town Washington

vicinity, county Washington

Legal Description: (If Rural) Township Name \_\_\_\_\_ Township No. \_\_\_\_\_ Range No. \_\_\_\_\_ Section \_\_\_\_\_ Quarter of Quarter \_\_\_\_\_

(If Urban) Subdivision Original Plat Block(s) 3 Lot(s) 7

## 3. State/Federal Agency Certification [Skip this Section]

## 4. National Park Service Certification [Skip this Section]

## 5. Classification

Category of Property (Check only one box)

- building(s)
- district
- site
- structure
- object

### Number of Resources within Property

If Non-Eligible Property

Enter number of:

—	buildings
—	sites
—	structures
—	objects
—	Total

If Eligible Property, enter number of:

Contributing	Noncontributing
—	<u>1</u> buildings
—	— sites
—	— structures
—	— objects
—	<u>1</u> Total

Name of related project report or multiple property study (Enter "N/A" if the property is not part of a multiple property examination).

Title \_\_\_\_\_

Historical Architectural Data Base Number \_\_\_\_\_

## 6. Function or Use

Historic Functions (Enter categories from instructions)

0299 Commerce / liquor store

Current Functions (Enter categories from instructions)

0299 Commerce / liquor store

## 7. Description

Architectural Classification (Enter categories from instructions)

09F06 Commercial: Gable Front

Materials (Enter categories from instructions)

foundation 10B Concrete / poured

walls (visible material) 03 Brick

roof 08A Asphalt / shingle

other 10A Concrete / block sides

Narrative Description ( SEE CONTINUATION SHEETS, WHICH MUST BE COMPLETED)

## 8. Statement of Significance

Applicable National Register Criteria (Mark "x" representing your opinion of eligibility after applying relevant National Register criteria)

- Yes  No  More Research Recommended
- Yes  No  More Research Recommended
- Yes  No  More Research Recommended
- Yes  No  More Research Recommended

- A Property is associated with significant events.
- B Property is associated with the lives of significant persons.
- C Property has distinctive architectural characteristics.
- D Property yields significant information in archeology or history.

County Washington Address 106 W. 2nd St  
City Washington

Site Number 92-00580  
District Number 92-00349

**Criteria Considerations**

- A Owned by a religious institution or used for religious purposes.
- B Removed from its original location.
- C A birthplace or grave.
- D A cemetery
- E A reconstructed building, object, or structure.
- F A commemorative property.
- G Less than 50 years of age or achieved significance within the past 50 years.

**Areas of Significance** (Enter categories from instructions)

\_\_\_\_\_  
\_\_\_\_\_

**Significant Dates**

Construction date  
1987  check if circa or estimated date  
Other dates, including renovation

**Significant Person**

(Complete if National Register Criterion B is marked above)

\_\_\_\_\_  
\_\_\_\_\_

**Architect/Builder**

Architect

\_\_\_\_\_  
Builder

**Narrative Statement of Significance** ( SEE CONTINUATION SHEETS, WHICH MUST BE COMPLETED)

**9. Major Bibliographical References**

Bibliography  See continuation sheet for citations of the books, articles, and other sources used in preparing this form

**10. Geographic Data**

**UTM References (OPTIONAL)**

Zone	Easting	Northing	Zone	Easting	Northing
1	_____	_____	2	_____	_____
3	_____	_____	4	_____	_____

See continuation sheet for additional UTM references or comments

**11. Form Prepared By**

name/title Mary Patterson, Chair Rebecca L. McCarley, consultant, Davenport  
organization Washington Historic Preservation Commission date March 28, 2012  
street & number City Hall – 215 E. Washington St telephone 319-653-6584  
city or town Washington state Iowa zip code 52353

**ADDITIONAL DOCUMENTATION** (Submit the following items with the completed form)

**FOR ALL PROPERTIES**

- Map:** showing the property's location in a town/city or township.
- Site plan:** showing position of buildings and structures on the site in relation to public road(s).
- Photographs:** representative black and white photos. If the photos are taken as part of a survey for which the Society is to be curator of the negatives or color slides, a photo/catalog sheet needs to be included with the negatives/slides and the following needs to be provided below on this particular inventory site:

Roll/slide sheet #	_____	Frame/slot #	_____	Date Taken	_____
Roll/slide sheet #	_____	Frame/slot #	_____	Date Taken	_____
Roll/slide sheet #	_____	Frame/slot #	_____	Date Taken	_____

- See continuation sheet or attached *photo & slide catalog sheet* for list of photo roll or slide entries.
- Photos/illustrations without negatives are also in this site inventory file.

**FOR CERTAIN KINDS OF PROPERTIES, INCLUDE THE FOLLOWING AS WELL**

- Farmstead & District:** (List of structures and buildings, known or estimated year built, and contributing or noncontributing status)
- Barn:**
  - A sketch of the frame/truss configuration in the form of drawing a typical middle bent of the barn.
  - A photograph of the loft showing the frame configuration along one side.
  - A sketch floor plan of the interior space arrangements along with the barn's exterior dimensions in feet.

**State Historic Preservation Office (SHPO) Use Only Below This Line**

Concur with above survey opinion on National Register eligibility:  Yes  No  More Research Recommended  
 This is a locally designated property or part of a locally designated district.

Comments: \_\_\_\_\_

Evaluated by (name/title): \_\_\_\_\_ Date: \_\_\_\_\_

# Iowa Site Inventory Form Continuation Sheet

Page 1

---

<u>G&amp;S Wine and Spirits</u>	<u>Washington</u>
Name of Property	County
<u>106 W. Second Street</u>	<u>Washington</u>
Address	City

---

*This form was prepared as part of a research/survey/nomination project in 2011-2012 funded by a HRDP grant from the State Historical Society of Iowa for the nomination of the Washington Downtown Historic District. The project was primarily structured to develop the nomination for the downtown, with additional research on each building documented on an Iowa Site Inventory form. The information below is taken from the table in the August 2012 draft of the nomination, with additional information documented on the property and photographs in the following sections.*

**G & S Wine and Spirits - 106 W. Second St - State #92-00580 - Map #47 ~ 1 non-contributing building - 1987 - 1980s commercial**

Historic information:

(1890s-1930s - blacksmith shop)

(1940s-50s - produce store)

1987 - built as liquor store

2012 - Wine & Spirits

Architectural information:

Height: 1 story

Walls: concrete block , brick veneer façade

Storefront: -

Windows: -

Architectural details: "1987" plate in front gable

Architect/Builder: -

Modifications: -

## 7. Narrative Description

This is a one story, gable-oriented building facing the street to the south. The street facade is brick and the side facades and rear wall are concrete block. There is one horizontal double light window facing the street. Near the top of the gable is a concrete panel with the year 1987. The entry door is located on the west side, and it is glass and aluminum. It has a vertical window the same size as the door to the left of the door. A horizontal single light window is located between the corner of the building and the door. There is a one story concrete block addition at the rear of the building.

## 8. Narrative Statement of Significance

This building is non-contributing in the Washington Downtown Historic District due to its later construction. The property was purchased in August of 1987 by Marjorie R. Gloyer and Barbara A. Steele. The assessor's web site and the dated panel in the gable of the building both state that the building was built that same year. It opened as G&S Wine & Spirits, and it is still in that business today.

# Iowa Site Inventory Form Continuation Sheet

Page 2

---

<u>G&amp;S Wine and Spirits</u>	<u>Washington</u>
Name of Property	County
<u>106 W. Second Street</u>	<u>Washington</u>
Address	City

---

## 9. Major Bibliographical References

City/Telephone Directories, Washington. Various publishers, various dates. Available at the Washington Public Library.

Deed Records, Transfer Books, Auditor's Office, Washington County Courthouse, Washington, Iowa.

Newspaper advertisements, various years/dates, on microfilm at Washington Public Library:

*Washington Evening Journal*

*Washington Gazette*

*Washington Press*

Sanborn Map Company. "Washington, Iowa," Sanborn fire insurance maps. Pelham, NY: Sanborn Map Company, 1885, 1892, 1897, 1902, 1909, 1917, 1931, 1943.

Iowa Department of Cultural Affairs  
State Historical Society of Iowa  
**Iowa Site Inventory Form**  
**Continuation Sheet**

Site Number 92-00580  
Related District Number 92-00349

Page 3

Name of Property	G&S Wine and Spirits	County	Washington
Address	106 W. Second Street	City	Washington

**Location map**



*2009 aerial photograph (Washington County) – line indicates survey/research area boundary*

# Iowa Site Inventory Form Continuation Sheet

Site Number 92-00580

Related District Number 92-00349

Page 4

---

<u>G&amp;S Wine and Spirits</u>	<u>Washington</u>
Name of Property	County
<u>106 W. Second Street</u>	<u>Washington</u>
Address	City

---

### Building plan (from assessor's website)

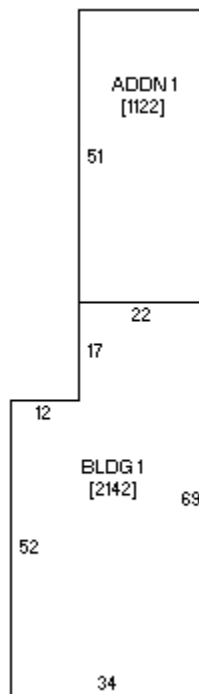

# Iowa Site Inventory Form Continuation Sheet

Page 5

G&S Wine and Spirits

Washington

Name of Property

County

106 W. Second Street

Washington

Address

City

## Digital photographs



Photograph 92-00580-001 - West and south elevations, looking northeast (McCarley, September 20, 2011)