

Site Inventory Form

State Historical Society of Iowa

(November 2005)

State Inventory No. 92-00553

New Supplemental

Part of a district with known boundaries (enter inventory no.) 92-00349

Relationship: Contributing Noncontributing

Contributes to a potential district with yet unknown boundaries

National Register Status:(any that apply) Listed De-listed NHL DOE

9-Digit SHPO Review & Compliance (R&C) Number _____

Non-Extant (enter year) _____

1. Name of Property

historic name Donovan Building

other names/site number Downtown Survey Map # DT- 034

2. Location

street & number 208 N. Marion Avenue

city or town Washington

vicinity, county Washington

Legal Description:(If Rural) Township Name _____ Township No. _____ Range No. _____ Section _____ Quarter of Quarter _____

(If Urban) Subdivision Original Plat Block(s) 3 Lot(s) 5 – S 33' of N 66' (1/2) – & Lot 6 – S 33' of N 66' (1/2)

3. State/Federal Agency Certification [Skip this Section]

4. National Park Service Certification [Skip this Section]

5. Classification

Category of Property (Check only one box)

- building(s)
- district
- site
- structure
- object

Number of Resources within Property

If Non-Eligible Property

Enter number of:

— buildings
— sites
— structures
— objects
— Total

If Eligible Property, enter number of:

Contributing	Noncontributing
—	<u>1</u>
—	—
—	—
—	—
—	<u>1</u>

Name of related project report or multiple property study (Enter "N/A" if the property is not part of a multiple property examination).

Title

Historical Architectural Data Base Number

6. Function or Use

Historic Functions (Enter categories from instructions)

02-99 Commerce / wallpaper

02A06 Commerce / machine shop

02G01 Commerce / restaurant

Current Functions (Enter categories from instructions)

02A Commerce / alternative power installation

7. Description

Architectural Classification (Enter categories from instructions)

09F06: Commercial / Gable Front

Materials (Enter categories from instructions)

foundation _____

walls (visible material) 10A Concrete Block

roof 05F Metal - steel

other 02A Weatherboard on gable

Narrative Description (SEE CONTINUATION SHEETS, WHICH MUST BE COMPLETED)

8. Statement of Significance

Applicable National Register Criteria (Mark "x" representing your opinion of eligibility after applying relevant National Register criteria)

- Yes No More Research Recommended
- Yes No More Research Recommended
- Yes No More Research Recommended
- Yes No More Research Recommended

- A Property is associated with significant events.
- B Property is associated with the lives of significant persons.
- C Property has distinctive architectural characteristics.
- D Property yields significant information in archeology or history.

County Washington Address 208 N. Marion Avenue
City Washington

Site Number 92-00553
District Number 92-00349

Criteria Considerations

- A Owned by a religious institution or used for religious purposes.
- B Removed from its original location.
- C A birthplace or grave.
- D A cemetery
- E A reconstructed building, object, or structure.
- F A commemorative property.
- G Less than 50 years of age or achieved significance within the past 50 years.

Areas of Significance (Enter categories from instructions)

Significant Dates

Construction date
1895 check if circa or estimated date
Other dates, including renovation
c.1960

Significant Person

(Complete if National Register Criterion B is marked above)

Architect/Builder

Architect

Builder

Narrative Statement of Significance SEE CONTINUATION SHEETS, WHICH MUST BE COMPLETED

9. Major Bibliographical References

Bibliography See continuation sheet for citations of the books, articles, and other sources used in preparing this form

10. Geographic Data

UTM References (OPTIONAL)

Zone	Easting	Northing	Zone	Easting	Northing
1	_____	_____	2	_____	_____
3	_____	_____	4	_____	_____

See continuation sheet for additional UTM references or comments

11. Form Prepared By

name/title Mary Patterson, Chair Rebecca L. McCarley, consultant, Davenport
organization Washington Historic Preservation Commission date March 16, 2012
street & number City Hall – 215 E. Washington St telephone 319-653-6584
city or town Washington state Iowa zip code 52353

ADDITIONAL DOCUMENTATION (Submit the following items with the completed form)

FOR ALL PROPERTIES

- Map:** showing the property's location in a town/city or township.
- Site plan:** showing position of buildings and structures on the site in relation to public road(s).
- Photographs:** representative black and white photos. If the photos are taken as part of a survey for which the Society is to be curator of the negatives or color slides, a photo/catalog sheet needs to be included with the negatives/slides and the following needs to be provided below on this particular inventory site:

Roll/slide sheet #	_____	Frame/slot #	_____	Date Taken	_____
Roll/slide sheet #	_____	Frame/slot #	_____	Date Taken	_____
Roll/slide sheet #	_____	Frame/slot #	_____	Date Taken	_____

- See continuation sheet or attached *photo & slide catalog sheet* for list of photo roll or slide entries.
- Photos/illustrations without negatives are also in this site inventory file.

FOR CERTAIN KINDS OF PROPERTIES, INCLUDE THE FOLLOWING AS WELL

- Farmstead & District:** (List of structures and buildings, known or estimated year built, and contributing or noncontributing status)
- Barn:**
 - A sketch of the frame/truss configuration in the form of drawing a typical middle bent of the barn.
 - A photograph of the loft showing the frame configuration along one side.
 - A sketch floor plan of the interior space arrangements along with the barn's exterior dimensions in feet.

State Historic Preservation Office (SHPO) Use Only Below This Line

Concur with above survey opinion on National Register eligibility: Yes No More Research Recommended
 This is a locally designated property or part of a locally designated district.

Comments: _____

Evaluated by (name/title): _____ Date: _____

Iowa Site Inventory Form Continuation Sheet

Page 1

<u>Donovan Building</u>	<u>Washington</u>
Name of Property	County
<u>208 N. Marion Avenue</u>	<u>Washington</u>
Address	City

This form was prepared as part of a research/survey/nomination project in 2011-2012 funded by a HRDP grant from the State Historical Society of Iowa for the nomination of the Washington Downtown Historic District. The project was primarily structured to develop the nomination for the downtown, with additional research on each building documented on an Iowa Site Inventory form. The information below is taken from the table in the August 2012 draft of the nomination, with additional information documented on the property and photographs in the following sections.

Donovan Building - 206-208 N. Marion Avenue - State #92-00553 - Map #51 ~ 1 non-contributing building (clad) - c.1895, c.1970s - gable front commercial

Historic information:

c.1895 - built by David L. and Dora Donovan - 1897 and 1902 maps shows south half as dwelling, north half as wallpaper store, and paint shop at rear - David was house painter, and 1st car owner in city in 1901

1905 - building sold, Carris Novelty Company in rear, Iowa Pride Stock Power Co in north (208), tea store in south (206) in 1909/1910; c.1912-c.1918/c.1925 - Western Hog Oiler Company - remodeled into single 1st story space (206)

1925-c.1930 - H. & A. Baking Company (E.T. Hansen, Lee Anderson) - remodeled building - oven at rear
1935 - Sandwich Shop, 1941 - Edith's Place, 1953 - Edith's Sandwich Shop (Edith Beaty owned from 1936 to 195?)

c.1960 - bought by Farmers Implement Company - expand into space from 210 - remodeled both storefronts jointly

2008 - Powercom

2012 - Powercom

Architectural information:

Height: 2 story

Walls: frame - asbestos/metal siding

Storefront: remodeled with concrete blocks to tie to building to north

Windows: covered by siding

Architectural details: -

Architect/Builder: -

Modifications: Historic: 1950s - storefront remodeled jointly with 210; Non-historic: -

7. Narrative Description

This is a two story gable-front frame commercial building constructed around 1895 as part residence and part commercial. The second story and gable are clad in asbestos siding, and the visible south side of the building is clad in metal siding. The roof is ridged steel. The storefront has been remodeled with concrete block in conjunction with the building to the north around 1960 for Farmers Implement Company. It has a central wood door with large window flanked by two large single-light windows. The asbestos shingle siding on the upper story has covered the earlier windows (see historic photo), and the metal siding on sides has covered those windows. A fixed awning extends across the front of the building and on to the front of the adjacent building to the north.

Iowa Site Inventory Form Continuation Sheet

Page 2

<u>Donovan Building</u>	<u>Washington</u>
Name of Property	County
<u>208 N. Marion Avenue</u>	<u>Washington</u>
Address	City

8. Narrative Statement of Significance

This two-story gable-front frame commercial building has been clad with siding on the upper portion of the facade and on the south elevation, covering window opening visible in a historic photograph of the building. As a result, the historic features and materials of the building have been obscured, and the building is counted as non-contributing in the Washington Downtown Historic District. If the siding were removed, it is recommended that the building be reassessed for historic significance. Despite the later storefront remodel, exposing the historic windows may be sufficient to reclassify the building as contributing in the historic district.

The 1892 Sanborn map shows a house on the north halves of Lots 5 and 6 in Block 3 at 208 N. Marion. Real estate developer Winfield Smouse bought the north halves of Lots 5, 6, and 7 in October 1894, and he then sold the property to Dora Donovan and husband in the same month. This building was likely built in 1895. The 1897 Sanborn map shows this two-story building on the south half of the north halves of the lots, and it identifies residential use in the south half of the building and wallpaper in the north half, with a paint shop at the rear of the building. The 1900 census lists David L. Donovan (33, house painter) with wife Dora (28) of nine years. D.L. Donovan is listed in the 1903 City Directory as a painter. The 1902 Sanborn map shows the same uses. The 1909 county history by H.A. Burrell has an interesting note - in 1901 Dave Donovan owned the first automobile in Washington, an Olds. By 1905, there were perhaps 25 cars in the city (Burrell 1909, Vol 1: 363).

The Donovans sold the building to L.H. O'Laughlin in 1905. The 1909 Sanborn map shows a tea store in the south half (206) and a store room in the north half (208), with Carris Novelty Company in the rear half of the building. Ed Carris invented and manufactured a one-match delivery box, as well as doing a variety of job work (Burrell 1909, Vol. 1: 434). The Iowa Pride Stock Powder Co. was listed at 208 N. Marion in the 1910 city directory, with Carris Novelty Company listed as at the rear of 206 N. Marion. They would move to a new location and continued to grow, expanding into manufacturing button machines by 1926.

The building was sold in 1912 to George Teas. The 1917 Sanborn map shows the Western Hog Oiler Company in the front half with office and shipping on the first story and a dwelling on the second story, and a tin shop in the rear. There is no longer any division for the north and south halves of the building, and it has an address of 206 N. Marion. An ad in 1920 notes that the Western Hog Oiler Company of Washington were manufacturers of the Ball, Ideal, and Capitol Hog Oilers, made of heavy galvanized iron with an improved oil burner to prohibit freezing

In 1918, Teas sold the property to J.L. Lyon and F.C. Lyon. By 1926, the H & A Baking Company is using the building, listed as 206 N. Marion in the directory. E.T. Hansen and Lee Anderson form the company and remodeled this building in fall 1925, located across from the Methodist Church. It was repainted and many new features added (25th anniversary edition, *Evening Journal*, April 3, 1926, page 65). They moved around the corner a few years later to the larger building at 107 W. 2nd Street. The

Iowa Department of Cultural Affairs
State Historical Society of Iowa
Iowa Site Inventory Form
Continuation Sheet

Site Number 92-00553
Related District Number 92-00349

Page 3

<u>Donovan Building</u>	<u>Washington</u>
Name of Property	County
<u>208 N. Marion Avenue</u>	<u>Washington</u>
Address	City

1931 Sanborn map shows the property as vacant, with the interior space combined into one large space with a small division for a store in the southwest corner and oven "not in use" at the east end. The 1935 City Directory indicates the Sandwich Shop at 206 N. Marion.

The Lyon family sold the building to Edith Beaty in 1936. The 1941 directory says Edith's Place (restaurant) is located there. On the 1943 Sanborn map, there is a wide opening in the north wall toward the rear of this building and the adjacent building to the north. The oven is still indicated at the rear. No listings were identified for 206 or 208 N. Marion in the 1950s. However, Edith's Sandwich Shop on N. Marion is noted among the restaurants in town in 1953, so she apparently continued her business here ("Washington is Served by Many Fine Restaurants," *Washington Evening Journal*, 60th Anniversary Edition, February 27, 1953, 82).

The building to the north at 210 N. Marion is occupied by the Farmers Implement Company in the 1950s and 1960s, and they may have overflowed into this building as well. They also built a large rear addition behind both buildings. Farmers Implement sold the combined property in 1981.

Powercom moved into the building in 2008.

9. Major Bibliographical References

City/Telephone Directories, Washington. Various publishers, various dates. Available at the Washington Public Library.

Deed Records, Transfer Books, Auditor's Office, Washington County Courthouse, Washington, Iowa.

Newspaper advertisements, various years/dates, on microfilm at Washington Public Library:

Washington Evening Journal
Washington Gazette
Washington Press

Patterson, Mary. Collection of historic images of Washington. Washington, IA.

Sanborn Map Company. "Washington, Iowa," Sanborn fire insurance maps. Pelham, NY: Sanborn Map Company, 1885, 1892, 1897, 1902, 1909, 1917, 1931, 1943.

Iowa Department of Cultural Affairs
State Historical Society of Iowa
Iowa Site Inventory Form
Continuation Sheet

Site Number 92-00553
Related District Number 92-00349

Page 4

Name of Property	Donovan Building	County	Washington
Address	208 N. Marion Avenue	City	Washington

Location map

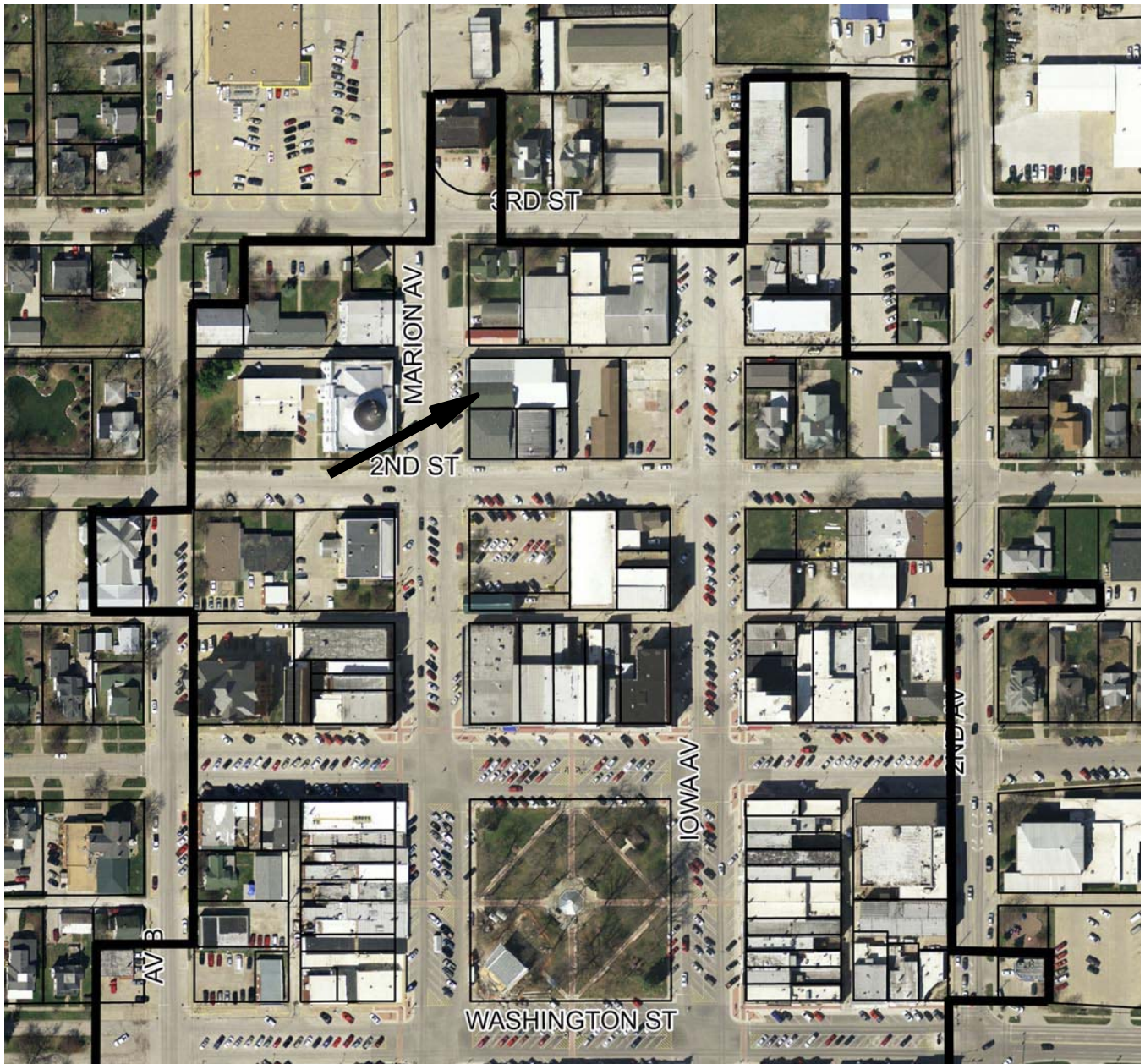

2009 aerial photograph (Washington County) – line indicates survey/research area boundary

Iowa Site Inventory Form Continuation Sheet

Page 5

<u>Donovan Building</u>	<u>Washington</u>
Name of Property	County
<u>208 N. Marion Avenue</u>	<u>Washington</u>
Address	City

Building plan (from assessor's website)

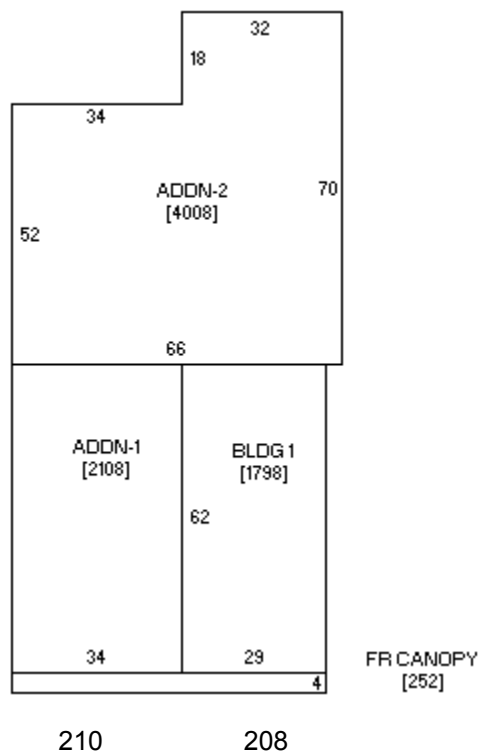

Iowa Site Inventory Form Continuation Sheet

Page 6

Donovan Building

Name of Property

Washington

County

208 N. Marion Avenue

Address

Washington

City

Historic images



Northwest corner of 2nd Street and Marion Ave around 1920 (Patterson collection)

Iowa Site Inventory Form Continuation Sheet

Page 7

Donovan Building

Name of Property

Washington

County

208 N. Marion Avenue

Address

Washington

City

Digital photographs



Photograph 92-00553-001 - West and south elevations, looking east-northeast (McCarley, September 20, 2011)