

# Site Inventory Form

State Historical Society of Iowa

(November 2005)

State Inventory No. 92-00531

New  Supplemental

Part of a district with known boundaries (enter inventory no.) \_\_\_\_\_

Relationship:  Contributing  Noncontributing

Contributes to a potential district with yet unknown boundaries

National Register Status:(any that apply)  Listed  De-listed  NHL  DOE

9-Digit SHPO Review & Compliance (R&C) Number \_\_\_\_\_

Non-Extant (enter year) \_\_\_\_\_

## 1. Name of Property

historic name Kentucky Fried Chicken

other names/site number Downtown Survey Map # DT- 062

## 2. Location

street & number 120 East Jefferson

city or town Washington

vicinity, county Washington

Legal Description: (If Rural) Township Name \_\_\_\_\_ Township No. \_\_\_\_\_ Range No. \_\_\_\_\_ Section \_\_\_\_\_ Quarter of Quarter \_\_\_\_\_

(If Urban) Subdivision Original Plat Block(s) 19 Lot(s) Lots 8 & 7

## 3. State/Federal Agency Certification [Skip this Section]

## 4. National Park Service Certification [Skip this Section]

## 5. Classification

Category of Property (Check only one box)

- building(s)
- district
- site
- structure
- object

### Number of Resources within Property

If Non-Eligible Property

Enter number of:

<u>1</u>	buildings
—	sites
—	structures
—	objects
<u>1</u>	Total

If Eligible Property, enter number of:

Contributing	Noncontributing
--------------	-----------------

—	—	buildings
—	—	sites
—	—	structures
—	—	objects
—	—	Total

Name of related project report or multiple property study (Enter "N/A" if the property is not part of a multiple property examination).

Title \_\_\_\_\_

Historical Architectural Data Base Number \_\_\_\_\_

## 6. Function or Use

Historic Functions (Enter categories from instructions)

14D07 Transportation / road-related / gas station

Current Functions (Enter categories from instructions)

02G: restaurant

## 7. Description

Architectural Classification (Enter categories from instructions)

Materials (Enter categories from instructions)

foundation 10A: Concrete Block

walls (visible material) 06: stucco

roof 02: 3-ply compo/wood deck

other \_\_\_\_\_

Narrative Description ( SEE CONTINUATION SHEETS, WHICH MUST BE COMPLETED)

## 8. Statement of Significance

Applicable National Register Criteria (Mark "x" representing your opinion of eligibility after applying relevant National Register criteria)

- Yes  No  More Research Recommended
- Yes  No  More Research Recommended
- Yes  No  More Research Recommended
- Yes  No  More Research Recommended

- A Property is associated with significant events.
- B Property is associated with the lives of significant persons.
- C Property has distinctive architectural characteristics.
- D Property yields significant information in archeology or history.

County Washington Address 120 East Jefferson Site Number 92-00531  
City Washington District Number \_\_\_\_\_

**Criteria Considerations**

- A Owned by a religious institution or used for religious purposes.
- B Removed from its original location.
- C A birthplace or grave.
- D A cemetery.
- E A reconstructed building, object, or structure.
- F A commemorative property.
- G Less than 50 years of age or achieved significance within the past 50 years.

**Areas of Significance** (Enter categories from instructions)

\_\_\_\_\_  
\_\_\_\_\_

**Significant Dates**

Construction date 1955  check if circa or estimated date  
Other dates, including renovation 1974, 2000s

**Significant Person**

(Complete if National Register Criterion B is marked above)

\_\_\_\_\_

**Architect/Builder**

Architect \_\_\_\_\_

Builder \_\_\_\_\_

**Narrative Statement of Significance**  SEE CONTINUATION SHEETS, WHICH MUST BE COMPLETED

**9. Major Bibliographical References**

Bibliography  See continuation sheet for citations of the books, articles, and other sources used in preparing this form

**10. Geographic Data**

**UTM References (OPTIONAL)**

Zone	Easting	Northing	Zone	Easting	Northing
1	_____	_____	2	_____	_____
3	_____	_____	4	_____	_____

See continuation sheet for additional UTM references or comments

**11. Form Prepared By**

name/title Stacy A. Nielsen, volunteer Rebecca L. McCarley, consultant, Davenport  
organization Washington Historic Preservation Commission date July 19, 2012  
street & number City Hall – 215 E. Washington St telephone 319-653-6584  
city or town Washington state Iowa zip code 52353

**ADDITIONAL DOCUMENTATION** (Submit the following items with the completed form)

**FOR ALL PROPERTIES**

- Map:** showing the property's location in a town/city or township.
- Site plan:** showing position of buildings and structures on the site in relation to public road(s).
- Photographs:** representative black and white photos. If the photos are taken as part of a survey for which the Society is to be curator of the negatives or color slides, a photo/catalog sheet needs to be included with the negatives/slides and the following needs to be provided below on this particular inventory site:

Roll/slide sheet #	_____	Frame/slot #	_____	Date Taken	_____
Roll/slide sheet #	_____	Frame/slot #	_____	Date Taken	_____
Roll/slide sheet #	_____	Frame/slot #	_____	Date Taken	_____

- See continuation sheet or attached *photo & slide catalog sheet* for list of photo roll or slide entries.
- Photos/illustrations without negatives are also in this site inventory file.

**FOR CERTAIN KINDS OF PROPERTIES, INCLUDE THE FOLLOWING AS WELL**

- Farmstead & District:** (List of structures and buildings, known or estimated year built, and contributing or noncontributing status)
- Barn:**
  - A sketch of the frame/truss configuration in the form of drawing a typical middle bent of the barn.
  - A photograph of the loft showing the frame configuration along one side.
  - A sketch floor plan of the interior space arrangements along with the barn's exterior dimensions in feet.

**State Historic Preservation Office (SHPO) Use Only Below This Line**

Concur with above survey opinion on National Register eligibility:  Yes  No  More Research Recommended  
 This is a locally designated property or part of a locally designated district.

Comments: \_\_\_\_\_

Evaluated by (name/title): \_\_\_\_\_ Date: \_\_\_\_\_

# Iowa Site Inventory Form Continuation Sheet

Page 1

---

Kentucky Fried Chicken	Washington
Name of Property	County
120 East Jefferson	Washington
Address	City

---

*This form was prepared as part of a research/survey/nomination project in 2011-2012 funded by a HRDP grant from the State Historical Society of Iowa for the nomination of the Washington Downtown Historic District. The project was primarily structured to develop the nomination for the downtown, with additional research on each building documented on an Iowa Site Inventory form.*

## 7. Narrative Description

The current building has a stucco finish, remodeled with corporate features and colors in the 2000s to modernize the restaurant. It houses both Kentucky Fried Chicken and Taco Bell.

## 8. Narrative Statement of Significance

This building appears to have been built around 1956 and used for Griggs Texaco Service from around this time until around 1973. It was then remodeled for Kentucky Fried Chicken. It was remodeled in the 2000s as a combined Kentucky Fried Chicken and Taco Bell. The current building does not resemble the original service station, so this property does not appear individually eligible for the NRHP and it was excluded from the boundary of the Washington Downtown Historic District as it would be non-contributing.

Notes on history:

- 1943 – Sanborn map shows single family dwelling on lots 7 & 8.
- 1955 – change of title from Ella A. Warren estate to Eugene Carew Warren
- 1954 – Harry R. and Mildred Wolf bought property from Eugene Carew Warren
- 1956 – April 30 – Harry R. Wolf and Wife sell to KP Griggs
- 1964 - Griggs Texaco Service - 221 S. 2nd Ave (this corner)
- 1973 - Kentucky Fried Chicken opened at this corner at 120 E. Jefferson (Bicentennial Edition, *Evening Journal*, July 1, 1976, page 125)
- 1976 - photo of building (see later pages)
- 1983 – June 10<sup>th</sup> – KP & Mabel G. Griggs sell property to Robert W. & Kevin L. Schultz (\$66,000)  
(Schultz Properties)
- 1989 - E. Jefferson St and S. 2<sup>nd</sup> Ave – Kentucky Fried Chicken

# Iowa Site Inventory Form Continuation Sheet

Page 2

---

<u>Kentucky Fried Chicken</u>	<u>Washington</u>
Name of Property	County
<u>120 East Jefferson</u>	<u>Washington</u>
Address	City

---

## 9. Major Bibliographical References

City/Telephone Directories, Washington. Various publishers, various dates. Available at the Washington Public Library.

Deed Records, Transfer Books, Auditor's Office, Washington County Courthouse, Washington, Iowa.

Newspaper advertisements, various years/dates, on microfilm at Washington Public Library:

- Washington Evening Journal*
- Washington Gazette*
- Washington Press*

Sanborn Map Company. "Washington, Iowa," Sanborn fire insurance maps. Pelham, NY: Sanborn Map Company, 1885, 1892, 1897, 1902, 1909, 1917, 1931, 1943.

## Building plan (from assessor's website)

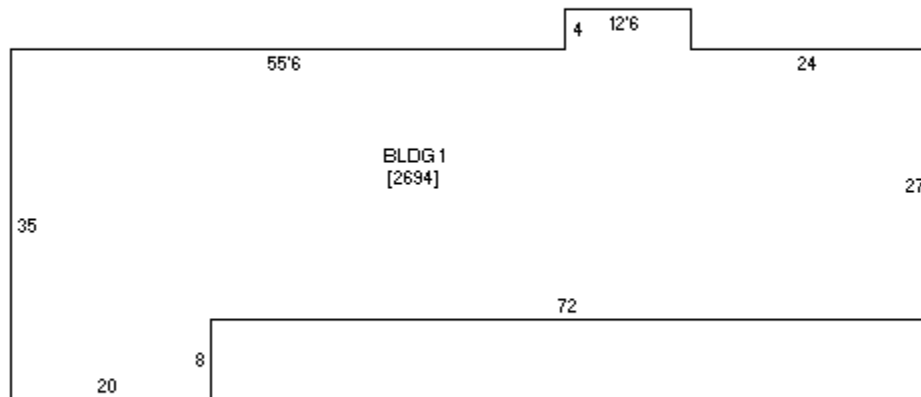

# Iowa Site Inventory Form Continuation Sheet

Page 3

Kentucky Fried Chicken

Washington

Name of Property

County

120 East Jefferson

Washington

Address

City

## Location map

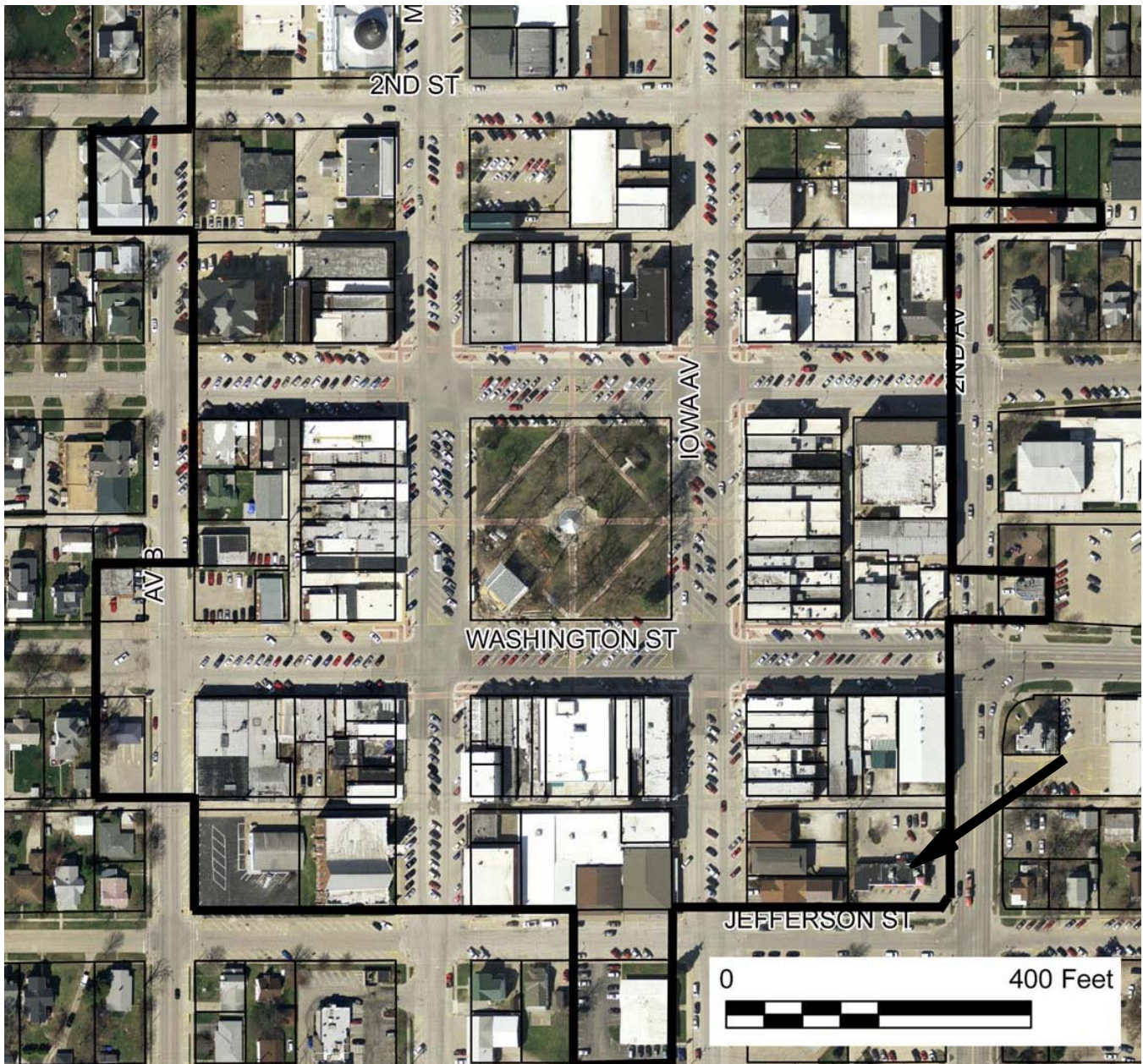

2009 aerial photograph (Washington County) – line indicates survey/research area boundary

# Iowa Site Inventory Form Continuation Sheet

Page 4

Kentucky Fried Chicken

Washington

Name of Property

County

120 East Jefferson

Washington

Address

City

## Historic images



*Evening Journal, July 1, 1976, p125*

# Iowa Site Inventory Form Continuation Sheet

Page 5

Kentucky Fried Chicken

Washington

Name of Property

County

120 East Jefferson

Washington

Address

City

## Digital photographs



92-00531-001 - East and north elevations, looking southwest (McCarley, September 20, 2011)