

Site Inventory Form

State Historical Society of Iowa

(November 2005)

State Inventory No. 92-00574

New Supplemental

Part of a district with known boundaries (enter inventory no.) 92-00349

Relationship: Contributing Noncontributing

Contributes to a potential district with yet unknown boundaries

National Register Status:(any that apply) Listed De-listed NHL DOE

9-Digit SHPO Review & Compliance (R&C) Number _____

Non-Extant (enter year) _____

1. Name of Property

historic name Sidney S. Smith & Company Garage

other names/site number Company D Armory, Downtown Survey Map # DT- 038

2. Location

street & number 222 S. Marion Avenue

city or town Washington

vicinity, county Washington

Legal Description: (If Rural) Township Name _____ Township No. _____ Range No. _____ Section _____ Quarter of Quarter _____

(If Urban) Subdivision Original Plat Block(s) 18 Lot(s) Lot 5 – S 88'

3. State/Federal Agency Certification [Skip this Section]

4. National Park Service Certification [Skip this Section]

5. Classification

Category of Property (Check only one box)

- building(s)
- district
- site
- structure
- object

Number of Resources within Property

If Non-Eligible Property

If Eligible Property, enter number of:

Enter number of:

Contributing

Noncontributing

— buildings

— sites

— structures

— objects

— Total

1

—

—

—

1

— buildings

— sites

— structures

— objects

— Total

Name of related project report or multiple property study (Enter "N/A" if the property is not part of a multiple property examination).

Title

Historical Architectural Data Base Number

6. Function or Use

Historic Functions (Enter categories from instructions)

Current Functions (Enter categories from instructions)

14D09 Transportation / automotive service or repair

12D09 Transportation / automotive service or repair

12A02 Defense / armory

08D04 Recreation & Culture / music facility / dance hall

7. Description

Architectural Classification (Enter categories from instructions)

Materials (Enter categories from instructions)

09F05 Commercial: Brick Front

foundation _____

walls (visible material) 03 Brick

roof _____

other _____

Narrative Description (SEE CONTINUATION SHEETS, WHICH MUST BE COMPLETED)

8. Statement of Significance

Applicable National Register Criteria (Mark "x" representing your opinion of eligibility after applying relevant National Register criteria)

- Yes No More Research Recommended
- Yes No More Research Recommended
- Yes No More Research Recommended
- Yes No More Research Recommended

- A Property is associated with significant events.
- B Property is associated with the lives of significant persons.
- C Property has distinctive architectural characteristics.
- D Property yields significant information in archeology or history.

County Washington Address 222 S. Marion Avenue
City Washington

Site Number 92-00574
District Number 92-00349

Criteria Considerations

- A Owned by a religious institution or used for religious purposes.
- B Removed from its original location.
- C A birthplace or grave.
- D A cemetery
- E A reconstructed building, object, or structure.
- F A commemorative property.
- G Less than 50 years of age or achieved significance within the past 50 years.

Areas of Significance (Enter categories from instructions)

02 Architecture
05 Commerce

Significant Dates

Construction date 1912 check if circa or estimated date
Other dates, including renovation _____

Significant Person

(Complete if National Register Criterion B is marked above)

Architect/Builder

Architect _____

Builder _____

Narrative Statement of Significance (SEE CONTINUATION SHEETS, WHICH MUST BE COMPLETED)

9. Major Bibliographical References

Bibliography See continuation sheet for citations of the books, articles, and other sources used in preparing this form

10. Geographic Data

UTM References (OPTIONAL)

Zone	Easting	Northing	Zone	Easting	Northing
1	_____	_____	2	_____	_____
3	_____	_____	4	_____	_____

See continuation sheet for additional UTM references or comments

11. Form Prepared By

name/title Mary Patterson, Chair Rebecca L. McCarley, consultant, Davenport
organization Washington Historic Preservation Commission date April 2, 2012
street & number City Hall – 215 E. Washington St telephone 319-653-6584
city or town Washington state Iowa zip code 52353

ADDITIONAL DOCUMENTATION (Submit the following items with the completed form)

FOR ALL PROPERTIES

- Map:** showing the property's location in a town/city or township.
- Site plan:** showing position of buildings and structures on the site in relation to public road(s).
- Photographs:** representative black and white photos. If the photos are taken as part of a survey for which the Society is to be curator of the negatives or color slides, a photo/catalog sheet needs to be included with the negatives/slides and the following needs to be provided below on this particular inventory site:

Roll/slide sheet # _____	Frame/slot # _____	Date Taken _____
Roll/slide sheet # _____	Frame/slot # _____	Date Taken _____
Roll/slide sheet # _____	Frame/slot # _____	Date Taken _____

See continuation sheet or attached *photo & slide catalog sheet* for list of photo roll or slide entries.

Photos/illustrations without negatives are also in this site inventory file.

FOR CERTAIN KINDS OF PROPERTIES, INCLUDE THE FOLLOWING AS WELL

- Farmstead & District:** (List of structures and buildings, known or estimated year built, and contributing or noncontributing status)
- Barn:**
 - A sketch of the frame/truss configuration in the form of drawing a typical middle bent of the barn.
 - A photograph of the loft showing the frame configuration along one side.
 - A sketch floor plan of the interior space arrangements along with the barn's exterior dimensions in feet.

State Historic Preservation Office (SHPO) Use Only Below This Line

Concur with above survey opinion on National Register eligibility: Yes No More Research Recommended

This is a locally designated property or part of a locally designated district.

Comments: _____

Evaluated by (name/title): _____ Date: _____

Iowa Site Inventory Form Continuation Sheet

Page 1

<u>Sidney S. Smith Garage</u>	<u>Washington</u>
Name of Property	County
<u>222 S. Marion Avenue</u>	<u>Washington</u>
Address	City

This form was prepared as part of a research/survey/nomination project in 2011-2012 funded by a HRDP grant from the State Historical Society of Iowa for the nomination of the Washington Downtown Historic District. The project was primarily structured to develop the nomination for the downtown, with additional research on each building documented on an Iowa Site Inventory form. The information below is taken from the table in the August 2012 draft of the nomination, with additional information documented on the property and photographs in the following sections.

Sidney S. Smith & Company Garage - 222 S. Marion Avenue - State #92-00574 - Map #110 ~ 1 contributing building (A and C) - 1912 - Classical Revival (simplified)

Historic information:

- 1912 - built by Sidney S. Smith for use as garage on first story and armory for Company D of Iowa National Guard on second story; Iowa National Guard unit on second story from 1912 to 1928
- 1930s-40s - hall on 2nd story; 1916-1922 - Keifer's Garage; 1926 - Dodge Bros (auto sales); 1932 - Iowa Motor Service
- 1935-1946 - Ross Motor Service - Bob Ross; 1946-1960s - Ross Motor Company - son Darrell as partner
- 1960s-1970s - Ross Motor Company - Darrell Ross
- 1970s-2000s - Ross Motor Company
- 2012 - Ross Auto & Muffler

Architectural information:

- Height: 2 story
- Walls: brick
- Storefront: large opening with wood paneling and small windows
- Windows: 1/1 windows - sets of 3 - replaced
- Architectural details: brick pilasters with stone accents, brick arch detail, inset parapet brick panels, stepped parapet
- Architect/Builder: -
- Modifications: Historic: -; Non-historic: windows replaced

7. Narrative Description

This is a two-story brick building sited on the northeast corner of the intersection of S. Marion and W. Jefferson. The first floor is red brick while the second and third stories are tan/yellow brick. The west facing facade is the main facade, and the south facade is also visible, as is the third floor from all four directions. There is a limestone band at the base of the building, another between the first and second stories, and the cornice is capped with limestone.

The west facade faces S. Marion. There are five wide brick pilasters with a limestone base and capital from the second to third stories dividing the main facade into four bays. Between the corner pilasters and the next pilaster there is an arch which extends above the tops of the pilasters and above the third story windows. Inset brick panels are found at the top of each bay between the pilasters. The two large panels have an inset diamond in the center. All of the openings on first floor have wood infill and modern replacement doors and windows. The first floor has the following openings on the main facade,

Iowa Site Inventory Form Continuation Sheet

Page 2

<u>Sidney S. Smith Garage</u>	<u>Washington</u>
Name of Property	County
<u>222 S. Marion Avenue</u>	<u>Washington</u>
Address	City

from left to right: a large opening with a steel entry door with a double-hung window, a small window, a large window, an extra tall garage door, another large window, another steel entry door with a window set in a tall opening, two very large windows infilled with wood and two larger horizontal windows in each one. The second story windows are grouped into sets of three windows. The windows in the two center sections were originally taller than the two side sections, but replacement windows are the same height on all four sections. The infill above these windows appears to be concrete. The windows have stone sills and no lintel differentiation from the wall. The center window in each grouping is a little wider than the two flanking windows.

The south elevation faces Jefferson Street, and it is divided into three sections by four pilasters. The pilasters are identical to the west side, with bases and capitals. No arch detail is found on this side, and the parapet has a two large inset rectangular on the two sides with a higher top and a lower center section with an inset diamond. The first story also has all infilled window and door openings. From left to right, there is another large window opening infilled with wood two larger horizontal windows, a covered double-hung window, a steel garage door, and a series of three small infilled windows, two of which have smaller windows installed and the final one has a large vent cover. The second story has three sets of three double-hung windows with concrete infill above them. They are the same size and shape as the middle windows on the west facade. As noted, there is brick detail on the upper stories and parapet, and the parapet is higher on the two end sections than the middle.

The second story of the north and east elevations are visible above the neighboring buildings. They are covered with vertical steel siding. The north elevation has three two-over-two-light double-hung windows, and the east elevation has two windows near the south end of the elevation.

8. Narrative Statement of Significance

The Sidney S. Smith Garage appears to contribute historically and architecturally to the Washington Downtown Historic District.

The 1909 Sanborn map shows two small vacant one story buildings on the site. According to the transfer records, the property was purchased in March 1910 by Wesley Smith. In 1912, this building was constructed at a cost of \$30,000 for Sidney S. Smith & Company garage ("Building in 1912," *Evening Journal*, April 26, 1913, 1). His ad notes that Sidney S. Smith was an automobile dealer with garage and repair shop ("Building in 1912," *Evening Journal*, April 26, 1913, 10).

The building was also constructed as the Armory for Company D of the Iowa National Guard. They occupied 4,800 square feet on the upper story of the Sidney S. Smith garage, used as drilling space. The company evolved from the Washington Guards, organized on July 31, 1877, which became attached to the Iowa National Guard in 1878. They drilled in the old skating rink (Music Hall) on W. Jefferson and then used the Commercial Club gymnasium. With this construction, they had one of the

Iowa Site Inventory Form Continuation Sheet

Page 3

<u>Sidney S. Smith Garage</u>	<u>Washington</u>
Name of Property	County
<u>222 S. Marion Avenue</u>	<u>Washington</u>
Address	City

most complete armories in Iowa ("Company D, Iowa National Guard," *Evening Journal*, April 26, 1913, 17). The company became the 1st Cavalry Squadron of Iowa National Guard in 1915, and they served in World War I. They were reorganized as the war as Troop D, 1st Regiment of Cavalry in Iowa National Guard, and then redesignated in late 1921 as as Troop D of 113th Cavalry. In the 1920s, the unit was called to Muscatine during button cutter's strike riot. They continued to occupy the second story of this building until 1928. They then moved to a barn and building on Elm Grove Road (*Souvenir History of Washington, Iowa* 1989: 69).

On April 15, 1914, Wesley Smith sold the building to his son Sidney Smith. The 1917 Sanborn map shows the building with a garage on the first story with a capacity of 50 cars and as an armory on the second story. Sidney Smith continued to own the building until 1943, with the auto business changing over this period. In 1916, W.J. Keifer moved his garage from Kalona to the armory building, and then moved to 115 S. 2nd Avenue in 1922.

Evening Journal – Washington County Centennial Celebration – July 1936 - page 55 – Keifer's Garage – 25 years in auto business – start in Kalona – move to armory building in Washington 20 years ago (1916) – moved to present location north of State Theatre 14 years ago (1922) – photo of building

The 1926 telephone directory lists Dodge Bros. Sales and Service at 222 S. Marion. The 1931 Sanborn map identifies a garage on the first story with a capacity of 25 cars, and a hall on the second story. The 1932 directory lists the Iowa Motor Service here, and in the 1935 city directory Little Transfer & Storage is here. Also by 1935, the current occupant, Ross Motor Service, had moved into the garage area, and the Iowa Ballroom occupied the second floor (1935 City Directory). In 1941, the name of the dance hall had changed to The Rendezvous. The building was sold in 1943 to Darrel L. and Avis C. Ross.

Evening Journal – Washington County Centennial Celebration – July 1936 - page 47 – Ross Motor Service – 222 S. Marion – present location for 1 year and 3 months

Washington Evening Journal, 60th Anniversary Edition, February 27, 1953, page 28 – "Ross Motor Co. Offers Complete Repair Service" – completely modern garage – 222 S. Marion – Darrel Ross – sons Dick and Bob joined in 1949 – started on October 1, 1930? – Pease? and Ross – then dissolved in 1933? (can't read copy)

Bicentennial Edition, *Evening Journal*, July 1, 1976 - page 59 – Ross Motor Service – 220 S. Marion Ave – in this location since 1935 – Bob Ross joined father Darrell in 1946 – now owner – wheel alignment, tune-ups, general auto repair

The building is currently owned and occupied by Ross Auto and Muffler.

Iowa Site Inventory Form Continuation Sheet

Page 4

Sidney S. Smith Garage

Washington

Name of Property

County

222 S. Marion Avenue

Washington

Address

City

9. Major Bibliographical References

City/Telephone Directories, Washington. Various publishers, various dates. Available at the Washington Public Library.

Deed Records, Transfer Books, Auditor's Office, Washington County Courthouse, Washington, Iowa.

Newspaper advertisements, various years/dates, on microfilm at Washington Public Library:

Washington Evening Journal

Washington Gazette

Washington Press

Patterson, Mary. Collection of historic images of Washington. Washington, IA.

Sanborn Map Company. "Washington, Iowa," Sanborn fire insurance maps. Pelham, NY: Sanborn Map Company, 1885, 1892, 1897, 1902, 1909, 1917, 1931, 1943.

Iowa Site Inventory Form Continuation Sheet

Page 5

Sidney S. Smith Garage

Name of Property

Washington

County

222 S. Marion Avenue

Address

Washington

City

Location map

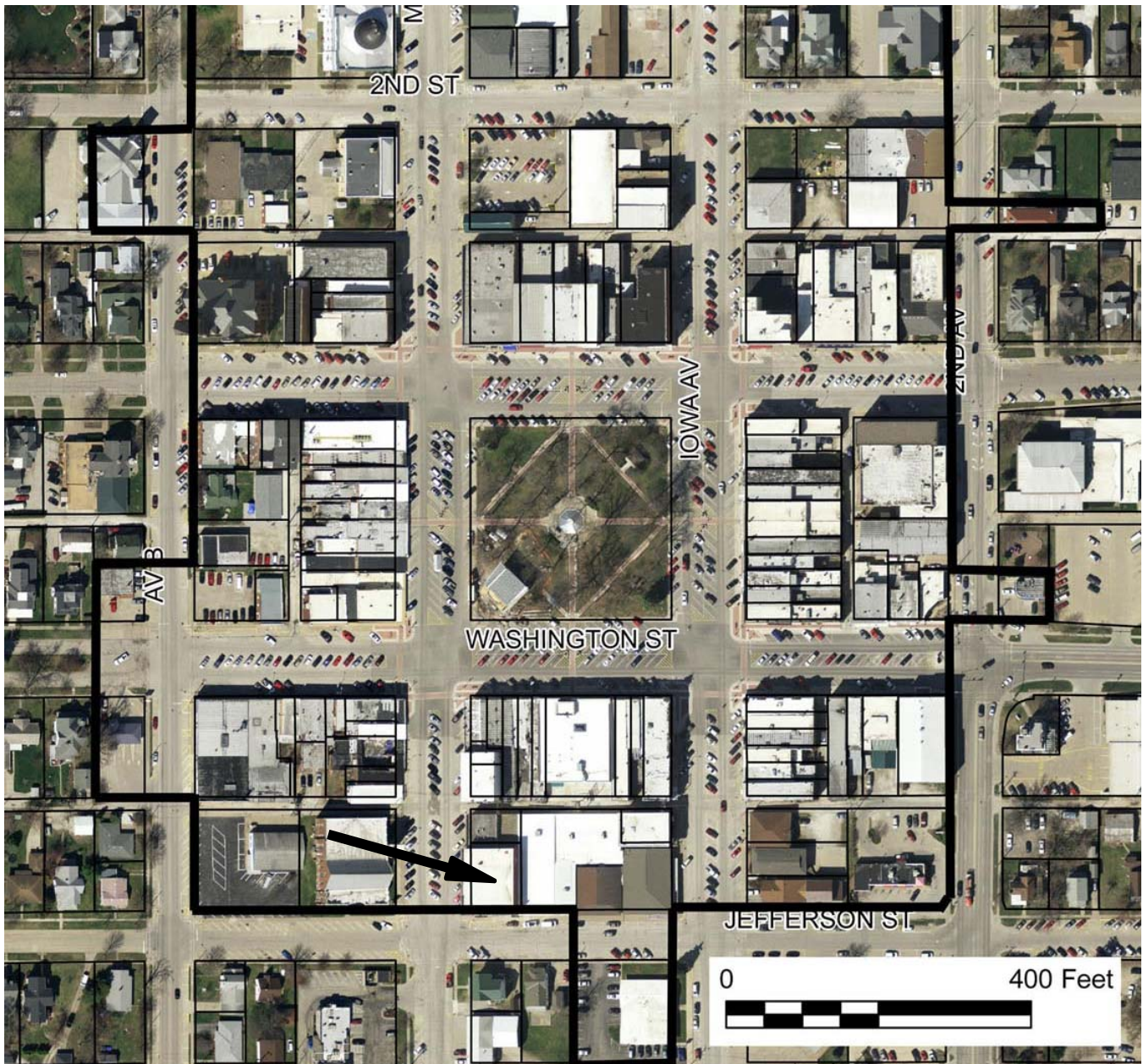

2009 aerial photograph (Washington County) – line indicates survey/research area boundary

Iowa Site Inventory Form Continuation Sheet

Page 6

Sidney S. Smith Garage Washington
Name of Property County

222 S. Marion Avenue Washington
Address City

Building plan (from assessor's website)

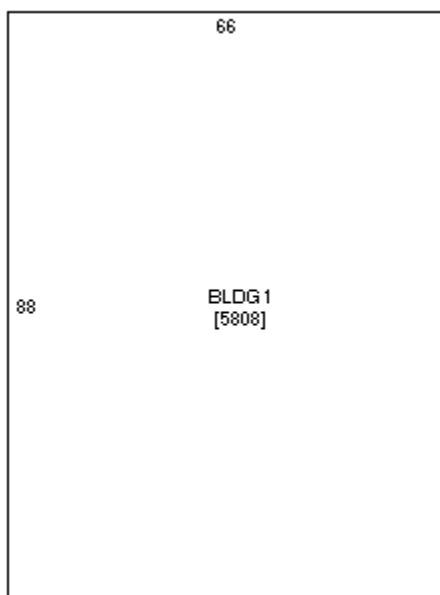

Iowa Site Inventory Form Continuation Sheet

Page 7

Sidney S. Smith Garage

Washington

Name of Property

County

222 S. Marion Avenue

Washington

Address

City

Historic images



Sidney S. Smith & Company Garage in 1913 (*Evening Journal*, April 26, 1913, 4).

Iowa Site Inventory Form Continuation Sheet

Page 8

Sidney S. Smith Garage

Washington

Name of Property

County

222 S. Marion Avenue

Washington

Address

City



Building in 1910s (Patterson collection)

**Iowa Site Inventory Form
Continuation Sheet**

Page 9

Sidney S. Smith Garage

Washington

Name of Property

County

222 S. Marion Avenue

Washington

Address

City

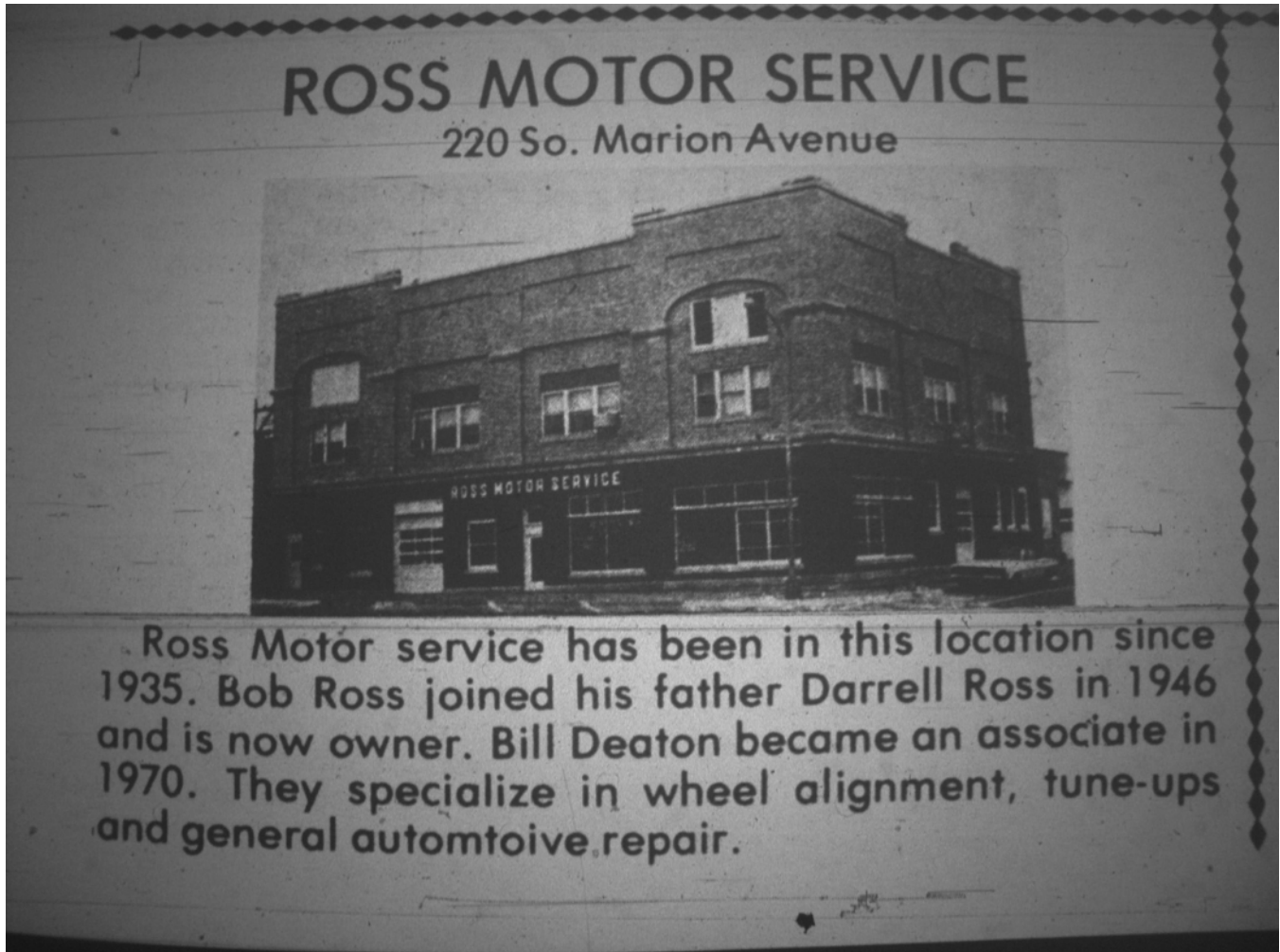

Evening Journal, July 1, 1976, p59

Iowa Site Inventory Form Continuation Sheet

Page 10

Sidney S. Smith Garage

Name of Property

Washington

County

222 S. Marion Avenue

Address

Washington

City

Digital photographs



Photograph 92-00574-001 - West and south elevations, looking northeast (McCarley, September 20, 2011)

Iowa Site Inventory Form Continuation Sheet

Page 11

Sidney S. Smith Garage

Washington

Name of Property

County

222 S. Marion Avenue

Washington

Address

City



Photograph 92-00574-002 - West elevation, looking east (McCarley, September 20, 2011)

Iowa Site Inventory Form
Continuation Sheet

Page 12

Sidney S. Smith Garage

Washington

Name of Property

County

222 S. Marion Avenue

Washington

Address

City



Photograph 92-00574-003 - South and east elevations, looking northwest (McCarley, September 20, 2011)