

Site Inventory Form

State Historical Society of Iowa

(November 2005)

State Inventory No. 92-00530

New Supplemental

Part of a district with known boundaries (enter inventory no.) _____

Relationship: Contributing Noncontributing

Contributes to a potential district with yet unknown boundaries

National Register Status:(any that apply) Listed De-listed NHL DOE

9-Digit SHPO Review & Compliance (R&C) Number _____

Non-Extant (enter year) 2008

1. Name of Property

historic name Y & G Service Station

other names/site number Downtown Survey Map # DT-112a

2. Location

street & number 201 N. Iowa Avenue

city or town Washington

vicinity, county Washington

Legal Description: (If Rural) Township Name _____ Township No. _____ Range No. _____ Section _____ Quarter of Quarter _____

(If Urban) Subdivision Original Plat Block(s) 3 Lot(s) south part of Lot 8

3. State/Federal Agency Certification [Skip this Section]

4. National Park Service Certification [Skip this Section]

5. Classification

Category of Property (Check only one box)

- building(s)
- district
- site
- structure
- object

Number of Resources within Property

If Non-Eligible Property
Enter number of:

If Eligible Property, enter number of:
Contributing Noncontributing

—	buildings	—	—	buildings
—	sites	—	—	sites
—	structures	—	—	structures
—	objects	—	—	objects
—	Total	—	—	Total

Name of related project report or multiple property study (Enter "N/A" if the property is not part of a multiple property examination).

Title _____

Historical Architectural Data Base Number _____

6. Function or Use

Historic Functions (Enter categories from instructions)

Current Functions (Enter categories from instructions)

14D07 Transportation / gas station

14D09 Transportation / automotive service or repair

7. Description

Architectural Classification (Enter categories from instructions)

Materials (Enter categories from instructions)

foundation _____

walls (visible material) _____

roof _____

other _____

Narrative Description (SEE CONTINUATION SHEETS, WHICH MUST BE COMPLETED)

8. Statement of Significance

Applicable National Register Criteria (Mark "x" representing your opinion of eligibility after applying relevant National Register criteria)

- Yes No More Research Recommended
- Yes No More Research Recommended
- Yes No More Research Recommended
- Yes No More Research Recommended

- A Property is associated with significant events.
- B Property is associated with the lives of significant persons.
- C Property has distinctive architectural characteristics.
- D Property yields significant information in archeology or history.

County Washington Address 201 N. Iowa Avenue
City Washington

Site Number 92-00530
District Number _____

Criteria Considerations

- A Owned by a religious institution or used for religious purposes.
- B Removed from its original location.
- C A birthplace or grave.
- D A cemetery
- E A reconstructed building, object, or structure.
- F A commemorative property.
- G Less than 50 years of age or achieved significance within the past 50 years.

Areas of Significance (Enter categories from instructions)

Significant Dates

Construction date 1955 check if circa or estimated date
Other dates, including renovation _____

Significant Person

(Complete if National Register Criterion B is marked above)

Architect/Builder

Architect _____

Builder _____

Narrative Statement of Significance SEE CONTINUATION SHEETS, WHICH MUST BE COMPLETED

9. Major Bibliographical References

Bibliography See continuation sheet for citations of the books, articles, and other sources used in preparing this form

10. Geographic Data

UTM References (OPTIONAL)

Zone	Easting	Northing	Zone	Easting	Northing
1	_____	_____	2	_____	_____
3	_____	_____	4	_____	_____

See continuation sheet for additional UTM references or comments

11. Form Prepared By

name/title Mary Patterson, Chair Rebecca L. McCarley, consultant, Davenport
organization Washington Historic Preservation Commission date March 30, 2012
street & number City Hall – 215 E. Washington St telephone 319-653-6584
city or town Washington state Iowa zip code 52353

ADDITIONAL DOCUMENTATION (Submit the following items with the completed form)

FOR ALL PROPERTIES

- Map:** showing the property's location in a town/city or township.
- Site plan:** showing position of buildings and structures on the site in relation to public road(s).
- Photographs:** representative black and white photos. If the photos are taken as part of a survey for which the Society is to be curator of the negatives or color slides, a photo/catalog sheet needs to be included with the negatives/slides and the following needs to be provided below on this particular inventory site:

Roll/slide sheet # _____	Frame/slot # _____	Date Taken _____
Roll/slide sheet # _____	Frame/slot # _____	Date Taken _____
Roll/slide sheet # _____	Frame/slot # _____	Date Taken _____

- See continuation sheet or attached *photo & slide catalog sheet* for list of photo roll or slide entries.
- Photos/illustrations without negatives are also in this site inventory file.

FOR CERTAIN KINDS OF PROPERTIES, INCLUDE THE FOLLOWING AS WELL

- Farmstead & District:** (List of structures and buildings, known or estimated year built, and contributing or noncontributing status)
- Barn:**
 - A sketch of the frame/truss configuration in the form of drawing a typical middle bent of the barn.
 - A photograph of the loft showing the frame configuration along one side.
 - A sketch floor plan of the interior space arrangements along with the barn's exterior dimensions in feet.

State Historic Preservation Office (SHPO) Use Only Below This Line

Concur with above survey opinion on National Register eligibility: Yes No More Research Recommended
 This is a locally designated property or part of a locally designated district.

Comments: _____

Evaluated by (name/title): _____ Date: _____

Iowa Site Inventory Form Continuation Sheet

Page 1

<u>Y & G Service Station</u>	<u>Washington</u>
Name of Property	County
<u>201 N. Iowa Avenue</u>	<u>Washington</u>
Address	City

This form was prepared as part of a research/survey/nomination project in 2011-2012 funded by a HRDP grant from the State Historical Society of Iowa for the nomination of the Washington Downtown Historic District. The project was primarily structured to develop the nomination for the downtown, with additional research on each building documented on an Iowa Site Inventory form. This building was demolished prior to the start of the project.

7. Narrative Description

Building was demolished in 2008. It was a one-story concrete block structure, facing 2nd St to the south, at the northwest corner of N. Iowa Ave and 2nd St. The southeast corner was infilled with wood panels and smaller windows, likely originally large windows facing the corner. The entry door was to the left of that infill, with two large windows to the left/west and a pedestrian door at the west end. There was an addition on the north side of the building, connecting it to the earlier c.1942 dry cleaners building to the north.

8. Narrative Statement of Significance

This gas station was demolished in 2008. Thus, it is not counted in the Washington Downtown Historic District. The 1931 and 1943 Sanborn maps show an earlier tile block gas station on the corner, angled to face the corner itself. Tankar Service Station is listed at 201 N. Iowa in 1941 and 1946. It was listed as *Davenport Democrat* newspaper office in 1952. Perhaps a new gas station was then built. Y & G Service is then listed here in 1956. In the 1964 City Directory, it is listed at 102 W. 2nd Street as Downtown 66 Service. The 1943 map also shows a "cleaning plant" at the rear of the lot at 211 N. Iowa (see 92-00598). Martin's Modern Cleaners was listed here in 1952, 1956, and 1964. They are noted to have moved to a completely modern, drive-in establishment in 1942. In 1953, they were the only drive-in cleaners in Washington. After the gas station closed, the cleaners expanded into the gas station building as well, with a connecting addition.

9. Major Bibliographical References

City/Telephone Directories, Washington. Various publishers, various dates. Available at the Washington Public Library.

Newspaper advertisements, various years/dates, on microfilm at Washington Public Library:

Washington Evening Journal
Washington Gazette
Washington Press

Sanborn Map Company. "Washington, Iowa," Sanborn fire insurance maps. Pelham, NY: Sanborn Map Company, 1885, 1892, 1897, 1902, 1909, 1917, 1931, 1943.

Iowa Site Inventory Form Continuation Sheet

Page 2

<u>Y & G Service Station</u> Name of Property	<u>Washington</u> County
<u>201 N. Iowa Avenue</u> Address	<u>Washington</u> City

Location map



2009 aerial photograph (Washington County) – line indicates survey/research area boundary

Iowa Site Inventory Form Continuation Sheet

Page 3

<u>Y & G Service Station</u>	<u>Washington</u>
Name of Property	County
<u>201 N. Iowa Avenue</u>	<u>Washington</u>
Address	City

Building plan (from assessor's website)

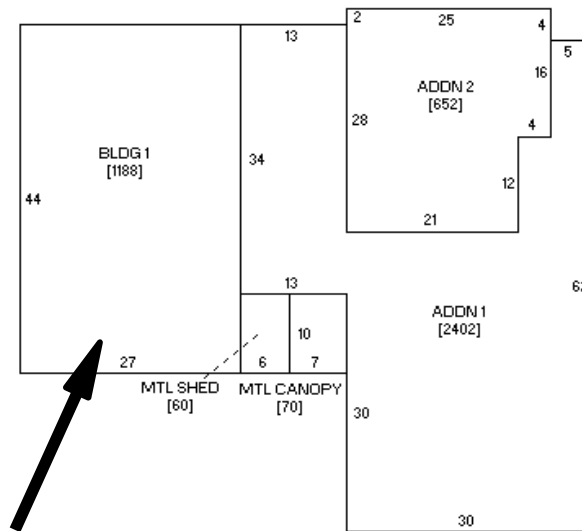

Iowa Site Inventory Form Continuation Sheet

Page 4

Y & G Service Station

Washington

Name of Property

County

201 N. Iowa Avenue

Washington

Address

City

Digital photograph



gas station at 201 N Iowa

cleaners at 211 N Iowa

Photograph 92-00530-001 - South and east elevations, looking northwest (Patterson, May 20, 2006)