

Iowa Site Inventory Form

State Historic Preservation Office

(July 2014)

State Inventory Number: 92-00757 New Supplemental

9-Digit SHPO Review & Compliance (R&C) Number _____

Non-extant Year: _____

Read the Iowa Site Inventory Form Instructions carefully, to ensure accuracy and completeness before completing this form. The instructions are available on our website: <http://www.iowahistory.org/historic-preservation/statewide-inventory-and-collections/iowa-site-inventory-form.html>

• Property Name

A) Historic name Iva Essley House

B) Other names: West side survey map #WS-043

• Location

A) Street address: 111 South Avenue B

B) City or town: Washington (Vicinity) County Washington

C) Legal Description:

Rural: Township Name: _____ Township No.: _____ Range No.: _____ Section: _____ Quarter: _____ of Quarter: _____

Urban: Subdivision: Original Plat Block(s): 15 Lot(s): N 50' of Lot 8

• Classification

A) Property category: *Check only one*

- Building(s)
- District
- Site
- Structure
- Object

B) Number of Resources (within property)

If eligible property, enter number of:		If non-eligible property, enter number of:	
Contributing	Noncontributing		
<u>2</u>	Buildings	—	Buildings
—	Sites	—	Sites
—	Structures	—	Structures
—	Objects	—	Objects
<u>2</u>	Total	—	Total

C) For properties listed in the National Register:

National Register status: Listed De-listed NHL NPS DOE

D) For properties within a historic district:

- Property contributes to a National Register or local certified historic district.
- Property contributes to a potential historic district, based on professional historic/architectural survey and evaluation.
- Property *does not* contribute to the historic district in which it is located.

Historic district name: West side residential historic district Historic district site inventory number: 92-00350

Name of related project report or multiple property study, if applicable:

MPD Title

Historical Architectural Data Base #

Architectural and Historical Survey of the "west side" residential neighborhood in Washington 92-013

• **Function or Use** *Enter categories (codes and terms) from the Iowa Site Inventory Form Instructions*

A) Historic functions

01A01: Domestic / residence

01C05: Domestic / garage

B) Current functions

01A01: Domestic / residence

01C05: Domestic / garage

• **Description** *Enter categories (codes and terms) from the Iowa Site Inventory Form Instructions*

A) Architectural Classification

07E02: Craftsman

B) Materials

Foundation (visible exterior): 10A: Concrete block

walls (visible exterior): 10B: vinyl

Roof: 08A: Asphalt shingles

Other: _____

C) Narrative Description SEE CONTINUATION SHEETS, WHICH MUST BE COMPLETED

● **Statement of Significance**

A) Applicable National Register Criteria: *Mark your opinion of eligibility after applying relevant National Register criteria*

- Criterion A: Property is associated with significant events. Yes No More research recommended
Criterion B: Property is associated with the lives of significant persons. Yes No More Research Recommended
Criterion C: Property has distinctive architectural characteristics. Yes No More Research Recommended
Criterion D: Property yields significant information in archeology/history. Yes No More Research Recommended

B) Special criteria considerations: *Mark any special considerations; leave blank if none*

- A Owned by a religious institution or used for religious purposes. E A reconstructed building, object, or structure.
 B Removed from its original location. F A commemorative property.
 C A birthplace or grave. G Less than 50 years of age or
 D A cemetery achieved significance within the past 50 years.

C) Areas of Significance

Enter categories from instructions

Community planning and development

D) Period(s) of significance

E) Significant dates

Construction date

1924 *check if circa or estimated date*

Other dates, including renovations

F) Significant person

Complete if Criterion B is marked above

G) Cultural affiliation

Complete if Criterion D is marked above

H) Architect/Builder

Architect

Builder/contractor

I) Narrative statement of significance **SEE CONTINUATION SHEETS, WHICH MUST BE COMPLETED**

● **Bibliography** *See continuation sheet for the list of research sources used in preparing this form*

● **Geographic Data** *Optional UTM references* *See continuation sheet for additional UTM references or comments*

UTM References (OPTIONAL)

Zone	Easting	Northing	NAD	Zone	Easting	Northing	NAD
1	_____	_____	_____	2	_____	_____	_____
3	_____	_____	_____	4	_____	_____	_____

● **Form Preparation**

Name and Title: Nancy Maguire - volunteer Rebecca Lawin McCarley, consultant Date: June 15, 2015

Organization/firm: Washington Historic Preservation Commission E-mail: -

Street address: City Hall, 215 E. Washington St Telephone: 319-653-6584

City or Town: Washington State: Iowa Zip code: 52353

● **ADDITIONAL DOCUMENTATION** *Submit the following items with the completed form*

A) For all properties, attach the following, as specified in the Iowa Site Inventory Form Instructions:

- 1. Map** of property's location within the community.
- 2. Glossy color 4x6 photos labeled** on back with property/building name, address, date taken, view shown, and unique photo number.
- 3. Photo key showing each photo number on a map and/or floor plan, using arrows next to each photo number to indicate the location and directional view of each photograph.**
- 4. Site plan** of buildings/structures on site, identifying boundaries, public roads, and building/structure footprints.

B) For State Historic Tax Credit Part 1 Applications, historic districts and farmsteads, and barns:

See lists of special requirements and attachments in the Iowa Site Inventory Form Instructions.

State Historic Preservation Office (SHPO) Use Only Below This Line

The SHPO has reviewed the Site Inventory and concurs with above survey opinion on National Register eligibility:

- Yes No More Research Recommended
 This is a locally designated property or part of a locally designated district.

Comments: _____

SHPO authorized signature: _____ Date: _____

Iowa Site Inventory Form
State Historic Preservation Office
Continuation Sheet

Site Number: 92-00757
Related District Number: 92-00350

Page 1

<u>Iva Essley House</u>	<u>Washington</u>
Name of Property	County
<u>111 South Avenue B</u>	<u>Washington</u>
Address	City

Narrative Description

This is a two-story, gable-front frame Craftsman house built on the west side of South Avenue B around 1924. The foundation is rusticated concrete block. The gable-front roof is clad in asphalt shingles, and it has wide eaves with triangular brackets. The house is clad in vinyl siding. The windows are vinyl replacements.

The house faces S. Avenue B to the east. The front porch appears original, and it spans the width of the facade. It has two rusticated concrete block piers with battered wood columns. Two later smaller wood columns and a wood railing has been added to the porch. There are six concrete steps that lead up to the wood porch floor. The first story of the house has an entry at the right/north. The south half of the first story has a set of three one-over-one-light double-hung windows. The second story has two one-over-one-light double-hung windows. All the windows have shutters. The wide eaves of the roof are supported by five triangular brackets on the facade. A small octagon window is centered in the front gable.

The north side has a side entry at the ground level, with a shed-roof overhang supported by large brackets. The first story has a high rectangular window to the left/east and a one-over-one-light double-hung window to the right/west. Above the entry, at mid-story level, there is a one-over-one-light double-hung window. The second story has a one-over-one-light double-hung window to the left/east and a smaller one-over-one-light double-hung window to the right/west, each above the first story windows. The basement has one boarded up window.

The south side has a one-over-one-light double-hung window on the front/east/right half of the first story and a square bay window with a shed roof on the rear/west/left half. The bay window has a center high rectangular window with a one-over-one-light double-hung window to either side on the main south face. There are no windows on the sides of the bay window. The second story has a one-over-one-light double-hung window on the front/right/east and a set of three one-over-one-light double-hung windows on the left/west/right half.

The rear has a enclosed rear porch on the first story, with a rear entry. The second story has two one-over-one-light double-hung windows. The wide eaves of the roof on the rear are also supported by five triangular brackets. There is a rectangular attic window.

There is a one-car frame garage that sits immediately behind the house, facing the alley to the north. The garage appears on the 1931 Sanborn map, and it was likely constructed at the same time as the house or shortly thereafter. The frame walls are clad in wood siding, the foundation is concrete and the gable-front roof is clad in asphalt shingles. The north side has a one-car garage door. The east side has a six-light wood window.

Iowa Site Inventory Form
State Historic Preservation Office
Continuation Sheet

Site Number: 92-00757
Related District Number: 92-00350

Page 2

<u>Iva Essley House</u>	<u>Washington</u>
Name of Property	County
<u>111 South Avenue B</u>	<u>Washington</u>
Address	City

Narrative Statement of Significance

The Iva Essley House appears to contribute historically to the potential “west side” residential historic district in Washington. The house was built in the 1920s during a period of development of vacant lots and subdivision of larger lots in the neighborhood that increased the density of the neighborhood, and it contributes to this house. The Craftsman house retains fair integrity, with the wide eaves, brackets, and porch continuing to convey elements of the style.

The house does not appear to be individually eligible for listing on the National Register of Historic Places under Criteria A, B, or C. The house does not appear to have particular historical or architectural significance, and the historic integrity has been impacted by the vinyl siding and replacement windows.

History / research summary of property

The 1917 Sanborn map shows a house on lot 8 at 302 W. Washington Blvd. The property reverted to the Farmers and Merchants Bank in 1916, who sold it to O.K. Clapper in February 1917. The property was then sold to H.F. Darbyshire in 1920 and to W.W. McFarland in 1923. This property, the north 50 feet of Lot 8, was then first sold as a separate parcel by W.W. McFarland and wife to Iva Essley on February 26, 1924. The 1931 Sanborn map shows a small gas station at the corner on the south portion of the lot and this house at 111 S. Avenue B on the north portion of the lot. The 1926 telephone directory has a listing for Mrs. A.H. Essley living at 111 S. Avenue B. The 1930 census identifies Iva M. Essley at this address. She is the only resident, the home owner of property valued at \$7,000. She is age 65, single, and lists no occupation. Cemetery records indicate that Abram H. Essley died on May 24, 1921, so she was a widow when she moved into this house. The 1931 Sanborn map shows the house much as it is today, with an auto garage at the rear of the house. The 1932 telephone directory lists Mrs. H.A. Essley (Iva). The 1935 city directory lists Mrs. Iva Essley (widow of A.H.) living at 111 S. Ave C (probably a typo). Cemetery records indicate that Iva (McFarland) Essley died in 1937.

Myra M. Newell and husband transferred the property to Anna (McFarland) Malin on March 26, 1938. The 1938 telephone book lists Mrs. Richard H. Malin living at 111 S. Avenue B. The 1941 city directory lists Mrs. Anna Malin (widow of R.H.), a housekeeper and home owner, at this address. The 1940 census lists Anna Malin, home owner and head of the household, age 72 and a widow living here. The house is valued at \$4,000.

On January 14, 1948, E.O. Newell, executor for Anna Malin, sold the property to Donald H. Minick. He transferred the property to Raymond and Betty Minick on February 2, 1948. On November 1, 1950, they sold the property to John and Mary McConahen. They then sold it to Ed and Daisy Simmering on October 31, 1951.

From the 1952 telephone directory through 1976 city directories Ed E. Simmering is listed at this address as the home owner. Beginning with the 1964 city directory, he is noted as retired, living with his wife Daisy M.

Iowa Site Inventory Form
State Historic Preservation Office
Continuation Sheet

Site Number: 92-00757
Related District Number: 92-00350

Page 3

<u>Iva Essley House</u>	<u>Washington</u>
Name of Property	County
<u>111 South Avenue B</u>	<u>Washington</u>
Address	City

Bibliography

Atlas of Washington County, Iowa. No publisher noted, 1894. In collection of Washington Public Library.

Burrell, Howard A. *History of Washington County, Iowa*. Chicago, IL: S.J. Clarke Publishing Company, 1909. 2 volumes.

City/telephone directories. Washington Public Library. Various years, including 1894, 1903, 1908, 1910-11, 1917, 1932, 1934, 1935, 1938, 1941, 1952, 1954, 1956, 1958, 1960, 1962, 1964, 1967, 1969, 1972, and 1976.

Fisher, Kathy. *In the beginning there was land : a history of Washington County, Iowa*. Washington, Iowa: Washington County Historical Society, 1978.

Newspapers, including anniversary/celebration editions on microfilm and/or bound at Washington Public Library:

Washington Gazette, January 6, 1893

Twentieth Anniversary Edition, *Evening Journal*, April 26, 1913

Twenty-Fifth Anniversary Edition, *Evening Journal*, April 3, 1926

Washington County Centennial Edition, *Evening Journal*, July 1936

Souvenir Edition of Washington Centennial, *The Evening Journal*, August 1939

Sixtieth Anniversary Edition, *The Washington Evening Journal*, February 27, 1953

Bicentennial edition, *The Washington Evening Journal*, July 1, 1976

Sesquicentennial edition, *The Washington Evening Journal*, April 13, 1989

Patterson, Mary. Collection of historic postcards, images, and city/telephone directories. Washington, Iowa. Accessed 2014-2015.

Sanborn Map Company. *Washington, Iowa*. Fire insurance maps. 1885, 1892, 1897, 1902, 1909, 1917, 1931, 1943.

Souvenir History of Washington, Iowa. Washington, IA: Washington Evening Journal, June 23, 1989.

Washington County Historical Society. Collection of historic postcards and photographs.

Iowa Site Inventory Form
State Historic Preservation Office
Continuation Sheet

Site Number: 92-00757
Related District Number: 92-00350

Page 4

Iva Essley House Washington
Name of Property County

111 South Avenue B Washington
Address City

Location map



2009 aerial photograph (Washington County) – line indicates survey/research area boundary

Iowa Site Inventory Form
State Historic Preservation Office
Continuation Sheet

Site Number: 92-00757
Related District Number: 92-00350

Page 5

Iva Essley House Washington
Name of Property County

111 South Avenue B Washington
Address City

Building plan (from assessor's website)

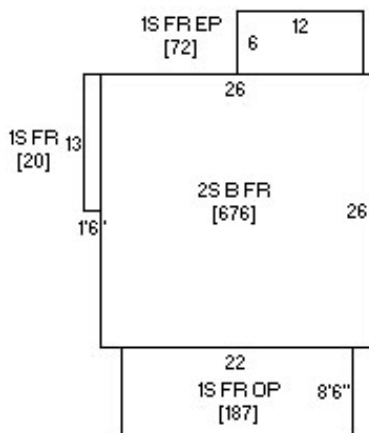

Photo from assessor's website



Iowa Site Inventory Form
State Historic Preservation Office
Continuation Sheet

Site Number: 92-00757
Related District Number: 92-00350

Page 6

Iva Essley House
Name of Property

Washington
County

111 South Avenue B
Address

Washington
City

Digital photographs



Photograph 92-00757-001 - House, looking southwest (December 2014)

Iowa Site Inventory Form
State Historic Preservation Office
Continuation Sheet

Site Number: 92-00757
Related District Number: 92-00350

Page 7

Iva Essley House
Name of Property

Washington
County

111 South Avenue B
Address

Washington
City



Photograph 92-00757-002 - House, looking northwest (December 2014)

Iowa Site Inventory Form
State Historic Preservation Office
Continuation Sheet

Site Number: 92-00757
Related District Number: 92-00350

Page 8

Iva Essley House
Name of Property

Washington
County

111 South Avenue B
Address

Washington
City



Photograph 92-00757-003 - House, looking southeast (December 2014)