

Iowa Site Inventory Form

State Historic Preservation Office

(July 2014)

State Inventory Number: 92-00159 New Supplemental

9-Digit SHPO Review & Compliance (R&C) Number _____

Non-extant Year: _____

Read the Iowa Site Inventory Form Instructions carefully, to ensure accuracy and completeness before completing this form. The instructions are available on our website: <http://www.iowahistory.org/historic-preservation/statewide-inventory-and-collections/iowa-site-inventory-form.html>

• Property Name

A) Historic name Alexander and Mary Gibson House

B) Other names: West side survey map #WS-006

• Location

A) Street address: 308 W Jefferson Street

B) City or town: Washington (Vicinity) County Washington

C) Legal Description:

Rural: Township Name: _____ Township No.: _____ Range No.: _____ Section: _____ Quarter: _____ of Quarter: _____

Urban: Subdivision: Original Plat Block(s): 16 Lot(s): 7

• Classification

A) Property category: *Check only one*

- Building(s)
- District
- Site
- Structure
- Object

B) Number of Resources (within property)

If eligible property, enter number of:		If non-eligible property, enter number of:	
Contributing	Noncontributing		
<u>1</u>	Buildings	—	Buildings
—	Sites	—	Sites
—	Structures	—	Structures
—	Objects	—	Objects
<u>1</u>	Total	—	Total

C) For properties listed in the National Register:

National Register status: Listed De-listed NHL NPS DOE

D) For properties within a historic district:

- Property contributes to a National Register or local certified historic district.
- Property contributes to a potential historic district, based on professional historic/architectural survey and evaluation.
- Property *does not* contribute to the historic district in which it is located.

Historic district name: West side residential historic district Historic district site inventory number: 92-00350

Name of related project report or multiple property study, if applicable:

MPD Title

Historical Architectural Data Base #

Architectural and Historical Survey of the "west side" residential neighborhood in Washington 92-013

• **Function or Use** *Enter categories (codes and terms) from the Iowa Site Inventory Form Instructions*

A) Historic functions

01A01: Domestic / residence

B) Current functions

01A01: Domestic / residence

01C05: Domestic / garage

• **Description** *Enter categories (codes and terms) from the Iowa Site Inventory Form Instructions*

A) Architectural Classification

05D: Queen Anne

B) Materials

Foundation (visible exterior): 04: Stone

walls (visible exterior): 15B: Vinyl

Roof: 08A: Asphalt shingles

Other: _____

C) Narrative Description **SEE CONTINUATION SHEETS, WHICH MUST BE COMPLETED**

• **Statement of Significance**

A) Applicable National Register Criteria: *Mark your opinion of eligibility after applying relevant National Register criteria*

- Criterion A: Property is associated with significant events. Yes No More research recommended
- Criterion B: Property is associated with the lives of significant persons. Yes No More Research Recommended
- Criterion C: Property has distinctive architectural characteristics. Yes No More Research Recommended
- Criterion D: Property yields significant information in archeology/history. Yes No More Research Recommended

B) Special criteria considerations: *Mark any special considerations; leave blank if none*

- A Owned by a religious institution or used for religious purposes. E A reconstructed building, object, or structure.
- B Removed from its original location. F A commemorative property.
- C A birthplace or grave. G Less than 50 years of age or achieved significance within the past 50 years.
- D A cemetery

C) Areas of Significance

Enter categories from instructions

Community planning and development

D) Period(s) of significance

E) Significant dates

Construction date

1898 *check if circa or estimated date*

Other dates, including renovations

F) Significant person

Complete if Criterion B is marked above

G) Cultural affiliation

Complete if Criterion D is marked above

H) Architect/Builder

Architect

Builder/contractor

I) Narrative statement of significance **SEE CONTINUATION SHEETS, WHICH MUST BE COMPLETED**

• **Bibliography** *See continuation sheet for the list of research sources used in preparing this form*

• **Geographic Data** *Optional UTM references* *See continuation sheet for additional UTM references or comments*

UTM References (OPTIONAL)

Zone	Easting	Northing	NAD	Zone	Easting	Northing	NAD
1				2			
3				4			

• **Form Preparation**

Name and Title: Mary Patterson - volunteer Rebecca Lawin McCarley, consultant Date: February 15, 2015

Organization/firm: Washington Historic Preservation Commission E-mail: -

Street address: City Hall, 215 E. Washington St Telephone: 319-653-6584

City or Town: Washington State: Iowa Zip code: 52353

• **ADDITIONAL DOCUMENTATION** *Submit the following items with the completed form*

A) For all properties, attach the following, as specified in the Iowa Site Inventory Form Instructions:

1. **Map** of property's location within the community.
2. **Glossy color 4x6 photos labeled** on back with property/building name, address, date taken, view shown, and unique photo number.
3. **Photo key showing each photo number on a map and/or floor plan, using arrows next to each photo number to indicate the location and directional view of each photograph.**
4. **Site plan** of buildings/structures on site, identifying boundaries, public roads, and building/structure footprints.

B) For State Historic Tax Credit Part 1 Applications, historic districts and farmsteads, and barns:

See lists of special requirements and attachments in the Iowa Site Inventory Form Instructions.

State Historic Preservation Office (SHPO) Use Only Below This Line

The SHPO has reviewed the Site Inventory and concurs with above survey opinion on National Register eligibility:

- Yes No More Research Recommended
- This is a locally designated property or part of a locally designated district.*

Comments: _____

SHPO authorized signature: _____ Date: _____

Iowa Site Inventory Form
State Historic Preservation Office
Continuation Sheet

Site Number: 92-00159
Related District Number: 92-00350

Page 1

Alexander and Mary Gibson House
Name of Property

Washington
County

308 W Jefferson Street
Address

Washington
City

Narrative Description

This is a two story, two bay, frame Queen Anne house built about 1898 on the north side of W Jefferson Street. The house sits on a stone foundation, and it is clad in vinyl siding. The cross gable roof is covered with asphalt shingles. A full porch spans the façade. The porch has a wood floor and railings, vinyl clad square posts, and wood steps. The windows were replaced in 2005 and are vinyl clad with vinyl surrounds. All windows have aluminum storm / screens. There are wood fishscale shingles on the gables. A two car, steel clad, garage is located at the northeast corner of the lot with access from the alley, built in 1985 per the assessor.

The façade, the south elevation, is divided into two sections, with the right/east gable-front section being slightly projected. On the first story, the west third has a decorative steel entry door with an aluminum storm / screen door. The east two-thirds has a large one-over-one-light double-hung wood window. On the second story, the west third has a one-over-one-light double-hung vinyl window above the entry. The east gable-roof section has a centrally located one-over-one-light double-hung vinyl window above the first floor window. On the gable, there are wood fishscale shingles and a small centered one-over-one-light double-hung vinyl window.

The west elevation is divided into three sections by a center gable-roof section. On the first story, the right/south/front section has a one-over-one-light double-hung window on each story. The middle section, which projects a few feet, has a large one-over-one-light double-hung window on each story, wider than typical for the house. The third/rear/north section has a one-over-one-light double-hung window to the far right of the section, and another smaller one-over-one-light double-hung window with a higher than typical sill on the left/north of the section. The second story has a smaller one-over-one-light double-hung vinyl window on the left side.

The east elevation is divided into three sections by a center two-story bay window with a gable roof. The left/south/front section has a one-over-one-light double-hung vinyl window on both stories. The center bay window has a large one-over-one-light double-hung vinyl window in the center on the first story, and three second story one-over-one-light double-hung vinyl windows, one in the center and one on each angled wall of the bay window. There are wood fishscale shingles on the gable, and there is a one-over-one-light double-hung vinyl window in the center of the gable. The rear/north section of the house has a one-over-one-light double-hung vinyl window on each story.

The north/rear elevation has a one-over-one-light double-hung vinyl window on the far right/west on the rear section of the house. The remainder of the north elevation consists of a one story enclosed porch with a shed roof covered with asphalt shingles. The porch is clad with vinyl siding. The west end of the porch has a two-light sliding window. The north side of the porch has an aluminum storm / screen door at the right (west) end of the wall, and to the left there is a set of four one-over-one-light double-hung vinyl windows. On the east end of the porch, there are two two-light casement windows. On the second story of the house, there are two widely spaced one-over-one-light double-hung vinyl windows, one at each side of the house

Iowa Site Inventory Form
State Historic Preservation Office
Continuation Sheet

Site Number: 92-00159
Related District Number: 92-00350

Page 2

Alexander and Mary Gibson House
Name of Property

Washington
County

308 W Jefferson Street
Address

Washington
City

The two car garage near the northeast corner of the lot adjacent to the alley sits on a poured concrete slab, and it is clad with corrugated steel panels. The gable-front roof is also steel. There are two steel one-car garage doors facing west, and between them is a steel entry door. There are wood surrounds on the garage doors and entry. There are no windows on any side of this garage.

Narrative Statement of Significance

The Alexander and Mary Gibson House appears to contribute historically to the potential "west side" residential historic district in Washington. The house was built in 1898 during the period of development of the neighborhood with large homes for successful men. Several Queen Anne houses were built in this period, with this one typical of a standard home of this style. It is significant within this period of development of the neighborhood.

The house does not appear individually eligible for listing on the National Register of Historic Places under Criteria A, B, or C. The house does not appear to have particular architectural or historical significance.

History / research summary of property (chronological order, by owner/period):

The 1897 Sanborn map indicates lot 7 is vacant. Alexander Gibson purchased the property on January 31, 1898. The 1900 census lists Alexander Gibson (76), his wife Mary (64), and his sister Sarah J. Gibson (71). A boarder, Sadie E. Hastings (25), also lives with them. The 1903 city directory lists the family at 308 W Jefferson as Alex Gibson, a retired farmer, his wife Mary, and Sarah Gibson. When Alexander Gibson died on January 1, 1905, the property was transferred to his heirs, who later transferred their shares to his son William Gibson on July 15, 1912. The 1910 census lists Mary Gibson (74, widow) living here with lodgers John and Mary Stewart. John H. and Mary J. Stewart, a retired farmer, are living at 308 W Jefferson in the 1910-11 city directory.

William A. Gibson sold the property to Mary Brooks, unmarried, in October 1918, who sold it in December 1918 to Henderson Wallace and his sister Annie Wallace. The 1920 census lists the residents as Henderson Wallace, age 63 and single, Anna Wallace, age 61, his sister, Mrs. Jennie Brashier, age 65, also a sister, and Minnie Stein, age 28, a niece and single. Wallace also appears in the 1926 and 1932 telephone directories at this address, and in the 1935 city directory. The 1930 census lists Henderson Wallace, age 73, single, living here with sisters Anna Wallace, 65, single, and Jennie Brashear, 70, single. The house is valued at \$4,000.

On January 9, 1936, Wallace transferred the property to Minnie Stein Beach (the niece). She used it as a rental property. The 1940 census lists Homer Jugenheimer (23, salesman for auto parts), renting this house and living here with wife Mildred (23). They rented it for \$24 per month. The 1941 city directory lists the house as vacant.

Iowa Site Inventory Form
State Historic Preservation Office
Continuation Sheet

Site Number: 92-00159
Related District Number: 92-00350

Page 3

Alexander and Mary Gibson House
Name of Property

Washington
County

308 W Jefferson Street
Address

Washington
City

Minnie Stein Beach and husband transferred the property to Bessie Palmer on March 2, 1945. She sold it to H.M. Smith on July 3, 1947, and he sold it to Coralie T. Briley on January 11, 1952. The 1954 telephone directory names Mrs. Willa A. Young living at this address, and she appears again as Billie Young in 1956 and 1958 directories. The 1964 city directory lists Mabel E. Merriman, widow of Van A. and Alice Merriman, a bookkeeper at Washington State Bank as residents at 308 W Jefferson, and John W. Richards, a cutter at McCleery-Cumming Company, and his wife Sue S. Richards, living at 308 1/2 W Jefferson. By 1967, only Alice Merriman is listed there.

On November 22, 1968, Coralie T. Briley, single et al. sold the property to Cecil H. and Colleen Bruns. In the 1969 city directory, Glen A. Bruns, assistant manager at Mid-American Manufacturing, his wife Charlotte, E. and children Randy, Leroy, Teresa, Brian, and Bruce are living here. The 1972 and 1976 city directories identify Forest A. Cline, a custodian at the University of Iowa and his wife Velma living in the house. Cecil H. and Colleen Bruns transferred the property to Ronald L. and Linda Bruns on October 5, 1976.

Iowa Site Inventory Form
State Historic Preservation Office
Continuation Sheet

Site Number: 92-00159
Related District Number: 92-00350

Page 4

Alexander and Mary Gibson House
Name of Property

Washington
County

308 W Jefferson Street
Address

Washington
City

Bibliography

Atlas of Washington County, Iowa. Clinton, IA, and Philadelphia, PA: Harrison and Warner, 1874.

Atlas of Washington County, Iowa. No publisher noted, 1894. In collection of Washington Public Library.

Burrell, Howard A. *History of Washington County, Iowa.* Chicago, IL: S.J. Clarke Publishing Company, 1909. 2 volumes.

City/telephone directories. Washington Public Library. Various years, including 1894, 1903, 1908, 1910-11, 1917, 1932, 1934, 1935, 1938, 1941, 1952, 1954, 1956, 1958, 1960, 1962, 1964, 1967, 1969, 1972, and 1976.

Fisher, Kathy. *In the beginning there was land : a history of Washington County, Iowa.* Washington, Iowa: Washington County Historical Society, 1978.

Newspapers, including anniversary/celebration editions on microfilm and/or bound at Washington Public Library:

Washington Gazette, January 6, 1893

Twentieth Anniversary Edition, *Evening Journal*, April 26, 1913

Twenty-Fifth Anniversary Edition, *Evening Journal*, April 3, 1926

Washington County Centennial Edition, *Evening Journal*, July 1936

Souvenir Edition of Washington Centennial, *The Evening Journal*, August 1939

Sixtieth Anniversary Edition, *The Washington Evening Journal*, February 27, 1953

Bicentennial edition, *The Washington Evening Journal*, July 1, 1976

Sesquicentennial edition, *The Washington Evening Journal*, April 13, 1989

Patterson, Mary. Collection of historic postcards, images, and city/telephone directories. Washington, Iowa. Accessed 2014-2015.

Portrait and Biographical Album of Washington County, Iowa. Chicago, Acme Publishing Company, 1887.

Sanborn Map Company. *Washington, Iowa.* Fire insurance maps. 1885, 1892, 1897, 1902, 1909, 1917, 1931, 1943.

Souvenir History of Washington, Iowa. Washington, IA: Washington Evening Journal, June 23, 1989.

Washington County Historical Society. Collection of historic postcards and photographs.

Iowa Site Inventory Form
State Historic Preservation Office
Continuation Sheet

Site Number: 92-00159
Related District Number: 92-00350

Page 5

Alexander and Mary Gibson House
Name of Property

Washington
County

308 W Jefferson Street
Address

Washington
City

Location map



2009 aerial photograph (Washington County) – line indicates survey/research area boundary

Iowa Site Inventory Form
State Historic Preservation Office
Continuation Sheet

Site Number: 92-00159
Related District Number: 92-00350

Page 6

Alexander and Mary Gibson House
Name of Property

Washington
County

308 W Jefferson Street
Address

Washington
City

Building plan (from assessor's website)

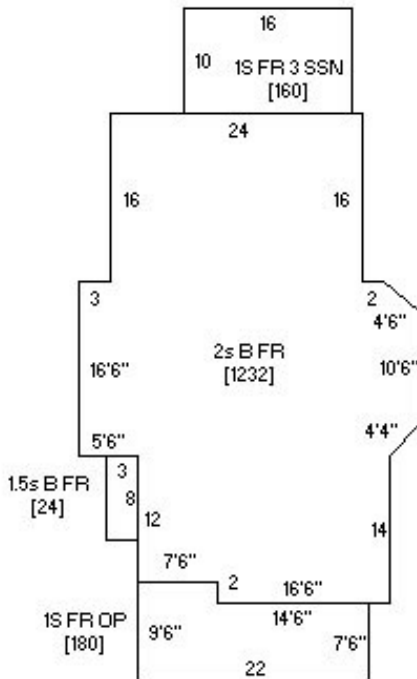

Photo from assessor's website



Iowa Site Inventory Form
State Historic Preservation Office
Continuation Sheet

Site Number: 92-00159
Related District Number: 92-00350

Page 7

Alexander and Mary Gibson House
Name of Property

Washington
County

308 W Jefferson Street
Address

Washington
City

Digital photographs



Photograph 92-00159-001 - House, looking northeast (December 2014)

Iowa Site Inventory Form
State Historic Preservation Office
Continuation Sheet

Site Number: 92-00159
Related District Number: 92-00350

Page 8

Alexander and Mary Gibson House
Name of Property

Washington
County

308 W Jefferson Street
Address

Washington
City



Photograph 92-00159-002 - House, looking northwest (December 2014)

Iowa Site Inventory Form
State Historic Preservation Office
Continuation Sheet

Site Number: 92-00159
Related District Number: 92-00350

Page 9

Alexander and Mary Gibson House
Name of Property

Washington
County

308 W Jefferson Street
Address

Washington
City



Photograph 92-00159-003 - House, looking southeast (December 2014)

Iowa Site Inventory Form
State Historic Preservation Office
Continuation Sheet

Site Number: 92-00159
Related District Number: 92-00350

Page 10

Alexander and Mary Gibson House
Name of Property

Washington
County

308 W Jefferson Street
Address

Washington
City



Photograph 92-00159-004 - Garage, looking southeast (December 2014)