

Iowa Site Inventory Form

State Historic Preservation Office

(July 2014)

State Inventory Number: 92-00421 New Supplemental

9-Digit SHPO Review & Compliance (R&C) Number _____

Non-extant Year: _____

Read the Iowa Site Inventory Form Instructions carefully, to ensure accuracy and completeness before completing this form. The instructions are available on our website: <http://www.iowahistory.org/historic-preservation/statewide-inventory-and-collections/iowa-site-inventory-form.html>

• Property Name

A) Historic name Thomas and Jeanette McElhinney House

B) Other names: West side survey map #WS-011

• Location

A) Street address: 317 W Jefferson Street

B) City or town: Washington (Vicinity) County Washington

C) Legal Description:

Rural: Township Name: _____ Township No.: _____ Range No.: _____ Section: _____ Quarter: _____ of Quarter: _____

Urban: Subdivision: Original Plat Block(s): 25 Lot(s): W 1/2 of Lot 3

• Classification

A) Property category: *Check only one*

- Building(s)
- District
- Site
- Structure
- Object

B) Number of Resources (within property)

If eligible property, enter number of:		If non-eligible property, enter number of:	
Contributing	Noncontributing		
<u>2</u>	Buildings	—	Buildings
—	Sites	—	Sites
—	Structures	—	Structures
—	Objects	—	Objects
<u>2</u>	Total	—	Total

C) For properties listed in the National Register:

National Register status: Listed De-listed NHL NPS DOE

D) For properties within a historic district:

- Property contributes to a National Register or local certified historic district.
- Property contributes to a potential historic district, based on professional historic/architectural survey and evaluation.
- Property *does not* contribute to the historic district in which it is located.

Historic district name: West side residential historic district Historic district site inventory number: 92-00350

Name of related project report or multiple property study, if applicable:

MPD Title

Historical Architectural Data Base #

Architectural and Historical Survey of the "west side" residential neighborhood in Washington 92-013

• **Function or Use** *Enter categories (codes and terms) from the Iowa Site Inventory Form Instructions*

A) Historic functions

B) Current functions

01A01: Domestic / residence

01A01: Domestic / residence

01C08: Domestic / carriage house

01C05: Domestic / garage

• **Description** *Enter categories (codes and terms) from the Iowa Site Inventory Form Instructions*

A) Architectural Classification

B) Materials

05F: Shingle Style

Foundation (visible exterior): 04: Stone

walls (visible exterior): 02: Wood

Roof: 08A: Asphalt shingles

Other: Walls shingle and weatherboard

C) Narrative Description **SEE CONTINUATION SHEETS, WHICH MUST BE COMPLETED**

● **Statement of Significance**

A) Applicable National Register Criteria: *Mark your opinion of eligibility after applying relevant National Register criteria*

- Criterion A: Property is associated with significant events. Yes No More research recommended
 Criterion B: Property is associated with the lives of significant persons. Yes No More Research Recommended
 Criterion C: Property has distinctive architectural characteristics. Yes No More Research Recommended
 Criterion D: Property yields significant information in archeology/history. Yes No More Research Recommended

B) Special criteria considerations: *Mark any special considerations; leave blank if none*

- A Owned by a religious institution or used for religious purposes. E A reconstructed building, object, or structure.
 B Removed from its original location. F A commemorative property.
 C A birthplace or grave. G Less than 50 years of age or
 D A cemetery achieved significance within the past 50 years.

C) Areas of Significance

Enter categories from instructions

Community planning and development

D) Period(s) of significance

E) Significant dates

Construction date

1907 *check if circa or estimated date*

Other dates, including renovations

F) Significant person

Complete if Criterion B is marked above

G) Cultural affiliation

Complete if Criterion D is marked above

H) Architect/Builder

Architect

Builder/contractor

I) Narrative statement of significance **SEE CONTINUATION SHEETS, WHICH MUST BE COMPLETED**

● **Bibliography** *See continuation sheet for the list of research sources used in preparing this form*

● **Geographic Data** *Optional UTM references* *See continuation sheet for additional UTM references or comments*

UTM References (OPTIONAL)

Zone	Easting	Northing	NAD	Zone	Easting	Northing	NAD
1				2			
3				4			

● **Form Preparation**

Name and Title: Mary Patterson - volunteer Rebecca Lawin McCarley, consultant Date: February 17, 2015

Organization/firm: Washington Historic Preservation Commission E-mail: -

Street address: City Hall, 215 E. Washington St Telephone: 319-653-6584

City or Town: Washington State: Iowa Zip code: 52353

● **ADDITIONAL DOCUMENTATION** *Submit the following items with the completed form*

A) For all properties, attach the following, as specified in the Iowa Site Inventory Form Instructions:

- 1. Map** of property's location within the community.
- 2. Glossy color 4x6 photos labeled** on back with property/building name, address, date taken, view shown, and unique photo number.
- 3. Photo key showing each photo number on a map and/or floor plan, using arrows next to each photo number to indicate the location and directional view of each photograph.**
- 4. Site plan** of buildings/structures on site, identifying boundaries, public roads, and building/structure footprints.

B) For State Historic Tax Credit Part 1 Applications, historic districts and farmsteads, and barns:

See lists of special requirements and attachments in the Iowa Site Inventory Form Instructions.

State Historic Preservation Office (SHPO) Use Only Below This Line

The SHPO has reviewed the Site Inventory and concurs with above survey opinion on National Register eligibility:

- Yes No More Research Recommended
 This is a locally designated property or part of a locally designated district.

Comments: _____

SHPO authorized signature: _____ Date: _____

Iowa Site Inventory Form
State Historic Preservation Office
Continuation Sheet

Site Number: 92-00421
Related District Number: 92-00350

Page 1

<u>Thomas and Jeannette McElhinney House</u>	<u>Washington</u>
Name of Property	County
<u>317 W Jefferson Street</u>	<u>Washington</u>
Address	City

Narrative Description

This is a two-story frame Shingle style house on the south side of W Jefferson Street. The house sits on a stone foundation, and the walls are clad in wood weatherboard on the first story, and with several patterns of wood shingles on the second story. The house has a gambrel roof, with a front bay window with a gambrel roof and a front dormer with a gambrel roof. The roof is covered with asphalt shingles. All the windows are wood with wood surrounds and most have aluminum storm / screens. There is an inset front entry porch. There is a one story addition at the rear of the house. A two story barn / garage sits at the rear of the lot with access from the alley.

The façade, the north elevation, is divided into two sections. The left/east section has an inset front porch. The porch has concrete steps, a wood floor, and wood railing and balusters. At the corner of the porch, there is a square wood support column sitting on a brick pier, and there is wood weatherboard siding on the east railing/wall. The historic wood front door has an aluminum storm / screen door. To the left/east of the front entry, there is a pair of six-light wood casement windows. The second story has a gambrel roof dormer with a one-over-one-light double-hung wood window with a fix semi circular transom above the window. The surround is wood, and the dormer is sided with inverted wood fishscale shingles. The right/west section of the facade is the bay window with the gambrel roof second story overhanging the angled first story walls. There is a one-over-one-light double-hung window in each of the three sides of the bay window on the first story. The center window is wider than the two side windows. In the center of the second story, there is a one-over-one-light double-hung wood window with a wood surround and wood shutters. The siding on the gable is inverted fishscale wood singles, matching the dormer.

The east elevation has wood weatherboard siding on the first story, and chisel pattern wood shingles on the second story gambrel end. The first story has a one-over-one-light double-hung wood window at the far right/north, near the front porch. A small, two light fixed wood window is located at the far left/south side of the house. On the east side of the one-story rear addition, there is a one-over-one-light double-hung wood window with wood surround and wood storm window.

The west elevation has wood weatherboard siding on the first story and chisel pattern wood shingles on the second story gambrel end, matching the east elevation. On the first story, there is a one-over-one-light double-hung wood window on the right/south half. On the second story, there are two evenly spaced one-over-one-light double-hung wood windows. On the west side of the one-story rear addition, there is a one-over-one-light double-hung wood window with wood surround.

The south elevation, the rear of the house, has a one-over-one-light double-hung wood window with wood surround located at the far left/west side. The original hip-roof one-story rear section is then visible to the right, covered by the later one-story rear addition that spans most of the width of the back of the house. It has a poured concrete foundation, is clad in wood weatherboard siding, and the hip roof is covered with asphalt shingles. There is a rear entry with a wood door on the far left/west. On the east/right half, there are two one-over-one-light double-hung wood windows with wood surrounds and wood storm windows. On the second story of the main section of the house, there are two gable-roof dormers, each with a one-over-one-light double-hung wood window with wood surround.

Iowa Site Inventory Form
State Historic Preservation Office
Continuation Sheet

Site Number: 92-00421
Related District Number: 92-00350

Page 2

<u>Thomas and Jeannette McElhinney House</u>	<u>Washington</u>
Name of Property	County
<u>317 W Jefferson Street</u>	<u>Washington</u>
Address	City

There is a two story, gable-roof frame barn / garage at the rear of the property, with access from the alley. The building does not appear on the 1909 map, but it is depicted on the 1917 and later maps. The building is clad with vertically wood boards, and the roof is covered with asphalt shingles. The east façade has an aluminum single-car garage door at ground level, and a four-light wood window near the peak of the gable. The south elevation, the alley side, has a hinging wood panel/window at the east/right end on both stories. Centered on the wall, there is a four-light wood window. Farther to the left/west, there is a wide sliding barn door. The sliding mechanism is covered with wood, and runs the full length of the building. The west elevation has a four-light wood window near the peak of the gable. The north elevation, facing the house, has a small shed-roof addition to the right/west, a wood entry door somewhat left of the center, and to the left/east of the entry is a pair of six-light wood windows. This building is likely similar to a number that existed throughout the neighborhood in the 1890s to 1920s, then demolished and replaced with garages. It is one of only a few remaining in the area.

Narrative Statement of Significance

The Thomas and Jeanette McElhinney House appears to contribute historically and architecturally to the potential “west side” residential historic district in Washington. The house was built during the early 20th century during a period of development of the neighborhood with large and stylistic homes for successful businessmen. The Shingle style house with a gambrel roof form is somewhat unique in the neighborhood and retains a high level of historic integrity. The barn/garage at the rear of the lot reflects a type of building once common throughout the neighborhood, with few examples remaining. Both buildings are significant within the potential historic district.

The house may also be individually eligible for listing on the National Register of Historic Places under Criterion B for its association with Thomas McElhinney and/or Criterion C for architecture. The house is an excellent example of the Shingle style, and it retains a high level of historic integrity. The barn/garage may also be eligible under Criterion C. Further evaluation of the interior integrity of the house, comparison with other houses and barns/garages, and research on Thomas McElhinney would solidify these determinations.

History / research summary of property

Elmira Mather owned lots 2 and 3 on this block until her death in 1893. She lived in the house on the east half of Lot 3 and west edge of Lot 2, currently 313 W. Jefferson, to the east. This is the only house shown on these lots on the 1894 atlas. On February 28, 1894, the estate of Elmira Mather transferred lots 2 and 3 to Harry Letts. On the same day, Letts transferred the west ¼ of lot 2 and the east ½ of lot 3 to Grecia Wilkin, an area corresponding to the house shown on the 1894 atlas. Another transaction by Letts, also on February 28, 1894, transferred the east ¾ of lot 2 to siblings Grecia Wilkin and D.H. Logan (same parents, per death records). The final transaction that day transferred the west ½ of lot 3 to D.H. Logan. A notice in the *Washington Press* on July 4, 1894, states “D.H. Logan, editor of the *Gazette*, was married at 6 pm., Tuesday, June 26, to Miss Lynne Stewart, at the home of the bride's

Iowa Site Inventory Form
State Historic Preservation Office
Continuation Sheet

Site Number: 92-00421
Related District Number: 92-00350

Page 3

<u>Thomas and Jeannette McElhinney House</u>	<u>Washington</u>
Name of Property	County
<u>317 W Jefferson Street</u>	<u>Washington</u>
Address	City

mother...Mr. and Mrs. Logan will make their home in the house formerly owned by Harry Letts.” The 1894 city directory lists D.H. Logan living at 305 W. Jefferson (earlier numbering). In May 1895, David Logan transferred his half of the east ¾ of lot 2 to Grecia Wilkin. On January 9, 1896, Grecia Wilkin and husband transferred all of lot 2 and the east half of lot 3 to David J. Patterson. The 1897 Sanborn map shows the basic T-plan footprint of the house currently at 313 W. Jefferson and a smaller one-story house on the west half of Lot 3, current location of 317 W. Jefferson. The 1900 census shows David H. Logan, age 38, a journalist, his wife Mary L. age 31, and daughter Gladys, age 1, living listed between Sarah Brokaw and the David Patterson family (313 W. Jefferson). The 1902 Sanborn map continues to show the earlier L-shaped house on the west half of Lot 3. Interestingly, a new house is noted as having been built for D.H. Logan in 1901, but this was likely his new home at 320 W. Madison, technically owned by his mother-in-law Agnes Stewart (“New Residences the Past Year,” *Evening Journal*, January 2, 1902, 2). He is then listed there in the 1903 city directory.

On September 22, 1902, David H. Logan and wife transferred the property at 317 W. Jefferson to Thomas J. McElhinney. He is not listed in the 1903 city directory of Washington. The *Evening Journal* on March 3, 1904 noted that Mr. McElhinney and his son had bought the drug store business of E.C. Carris and Company, and McElhinney Drug Company would open next week after completing inventory (page 4). The 1905 Iowa census lists the family living on W. Madison: Thomas J., wife Jeannette, and children Andrew, Joseph, Isabel, and James. They may be living here awaiting completion of a new house. The 1909 Sanborn shows the current Shingle-style house on this lot, indicating construction by this time. Thus, c.1907 is used as the construction date for the house, pending further research. The city directory for 1910-11 lists the family at 315 W. Jefferson (earlier numbering, now 317): Thomas J. McElhinney of McElhinney Drug Co., his wife Jeanette, Joseph S., also with McElhinney Drug Co., and Andrew K., restaurant, and J. Hoy, a student. The 1910 census lists Thomas McElhinney, age 60, his wife Jeanette, age 54, and sons Joseph, age 29, and Ian, age 17. Interestingly, Thomas is listed as a furniture store owner while Joseph is listed as a drug store owner. The – 20th anniversary edition of *Evening Journal* on April 26, 1913 lists ads for the McElhinney Drug Company – drugs, paint, wallpaper (page 23), and for McElhinney Furniture, which had been in business for four years (page 41). Joseph McElhinney continued to own the drug store until George L. McDaniel bought it in 1926, and he continued to run McElhinney Furniture. The 1917 Sanborn map shows the house with a simplified footprint along with a one and half story barn at the south edge of the lot along the alley. The family is listed as T.J. McElhinney, retired, wife Nettie, and James Hoy, a student in the 1917 county directory. The 1920 census lists Thomas McElhinney, age 71, as the home owner and a retired farmer, and Jeanette, his wife, age 64. The 1926 phone directory also lists them as living here. They are living at 317 W. Jefferson in the 1930 census as well: Thomas, McElhinney, age 80, and Jeanette, his wife, age 74. The house is valued at \$2,500. T.J. McElhinney appears in the 1932 and 1935 telephone directories at this address. They transferred the property to only Jeannette Helen McElhinney on October 19, 1935. The 1940 census shows Orville Hardin age 33 and a renter, his wife Emma, age 31, and son James, age 5, living at this address. No McElhinneys are listed in Washington in the 1941 city directory. O. B. Hardin, a salesman, is listed as renting and living at 317 W. Jefferson with wife Emma.

Jeannette Helen McElhinney, a widow, sold the property to Frank M. and Rachel H. Longwell on December 31, 1943. Frank and Rachel Longwell are listed here in directories through the 1950s and

Iowa Site Inventory Form
State Historic Preservation Office
Continuation Sheet

Site Number: 92-00421
Related District Number: 92-00350

Page 4

Thomas and Jeannette McElhinney House	Washington
Name of Property	County
317 W Jefferson Street	Washington
Address	City

1960s. The 1964 directory notes that Frank is a painter, and the 1967 directory lists him as an interior decorator.

Frank M. Longwell and wife sold the property to Lester H. and Dorothy M. Luckenbill on May 3, 1967, who owned it until 1991. The 1969 directory lists Lester and Dorothy Luckenbill living at 317 W. Washington, and he is a conservation aide for the USDA and she is the society editor for the *Washington Journal*. They continue to be listed with these jobs in 1972, but then Lester has retired by 1976.

Bibliography

Atlas of Washington County, Iowa. Clinton, IA, and Philadelphia, PA: Harrison and Warner, 1874.

Atlas of Washington County, Iowa. No publisher noted, 1894. In collection of Washington Public Library.

Burrell, Howard A. *History of Washington County, Iowa*. Chicago, IL: S.J. Clarke Publishing Company, 1909. 2 volumes.

City/telephone directories. Washington Public Library. Various years, including 1894, 1903, 1908, 1910-11, 1917, 1932, 1934, 1935, 1938, 1941, 1952, 1954, 1956, 1958, 1960, 1962, 1964, 1967, 1969, 1972, and 1976.

Fisher, Kathy. *In the beginning there was land : a history of Washington County, Iowa*. Washington, Iowa: Washington County Historical Society, 1978.

History of Washington County, Iowa. Des Moines, IA: Union Historical Co., 1880.

Newspapers, including anniversary/celebration editions on microfilm and/or bound at Washington Public Library:

Washington Gazette, January 6, 1893

Twentieth Anniversary Edition, *Evening Journal*, April 26, 1913

Twenty-Fifth Anniversary Edition, *Evening Journal*, April 3, 1926

Washington County Centennial Edition, *Evening Journal*, July 1936

Souvenir Edition of Washington Centennial, *The Evening Journal*, August 1939

Sixtieth Anniversary Edition, *The Washington Evening Journal*, February 27, 1953

Bicentennial edition, *The Washington Evening Journal*, July 1, 1976

Sesquicentennial edition, *The Washington Evening Journal*, April 13, 1989

Patterson, Mary. Collection of historic postcards, images, and city/telephone directories. Washington, Iowa. Accessed 2014-2015.

Iowa Site Inventory Form
State Historic Preservation Office
Continuation Sheet

Site Number: 92-00421
 Related District Number: 92-00350

Page 5

Name of Property	Thomas and Jeannette McElhinney House	County	Washington
Address	317 W Jefferson Street	City	Washington

Portrait and Biographical Album of Washington County, Iowa. Chicago, Acme Publishing Company, 1887.

Sanborn Map Company. *Washington, Iowa.* Fire insurance maps. 1885, 1892, 1897, 1902, 1909, 1917, 1931, 1943.

Souvenir History of Washington, Iowa. Washington, IA: Washington Evening Journal, June 23, 1989.

Washington County Historical Society. Collection of historic postcards and photographs.

Location map



2009 aerial photograph (Washington County) – line indicates survey/research area boundary

Iowa Site Inventory Form
State Historic Preservation Office
Continuation Sheet

Site Number: 92-00421
Related District Number: 92-00350

Page 6

Thomas and Jeannette McElhinney House
Name of Property

Washington
County

317 W Jefferson Street
Address

Washington
City

Building plan (from assessor's website)

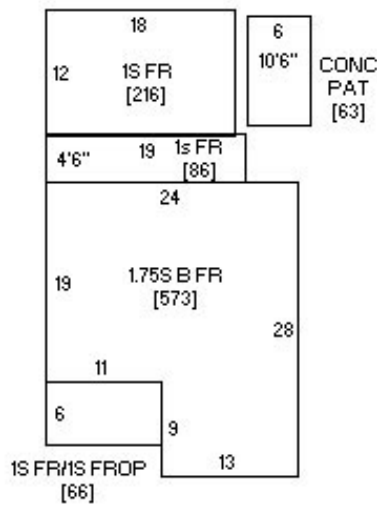

Photo from assessor's website



Iowa Site Inventory Form
State Historic Preservation Office
Continuation Sheet

Site Number: 92-00421
Related District Number: 92-00350

Page 7

Thomas and Jeannette McElhinney House
Name of Property

Washington
County

317 W Jefferson Street
Address

Washington
City

Digital photographs



Photograph 92-00421-001 - House, looking southwest (December 2014)

Iowa Site Inventory Form
State Historic Preservation Office
Continuation Sheet

Site Number: 92-00421
Related District Number: 92-00350

Page 8

Thomas and Jeannette McElhinney House
Name of Property

Washington
County

317 W Jefferson Street
Address

Washington
City



Photograph 92-00421-002 - House, looking northeast (December 2014)

Iowa Site Inventory Form
State Historic Preservation Office
Continuation Sheet

Site Number: 92-00421
Related District Number: 92-00350

Page 9

Thomas and Jeannette McElhinney House
Name of Property

Washington
County

317 W Jefferson Street
Address

Washington
City



Photograph 92-00421-003 - Garage, looking northwest (December 2014)

Iowa Site Inventory Form
State Historic Preservation Office
Continuation Sheet

Site Number: 92-00421
Related District Number: 92-00350

Page 10

Thomas and Jeannette McElhinney House
Name of Property

Washington
County

317 W Jefferson Street
Address

Washington
City



Photograph 92-00421-004 - Garage, looking northeast (December 2014)