

Iowa Site Inventory Form

State Historic Preservation Office

(July 2014)

State Inventory Number: 92-00423 New Supplemental

9-Digit SHPO Review & Compliance (R&C) Number _____

Non-extant Year: _____

Read the Iowa Site Inventory Form Instructions carefully, to ensure accuracy and completeness before completing this form. The instructions are available on our website: <http://www.iowahistory.org/historic-preservation/statewide-inventory-and-collections/iowa-site-inventory-form.html>

• Property Name

A) Historic name Belle Smith House

B) Other names: West side survey map #WS-016

• Location

A) Street address: 415 W. Jefferson Street

B) City or town: Washington (Vicinity) County Washington

C) Legal Description:

Rural: Township Name: _____ Township No.: _____ Range No.: _____ Section: _____ Quarter: _____ of Quarter: _____

Urban: Subdivision: Addition to Washington Block(s): 5 Lot(s): 3

• Classification

A) Property category: *Check only one*

- Building(s)
- District
- Site
- Structure
- Object

B) Number of Resources (within property)

If eligible property, enter number of:		If non-eligible property, enter number of:	
Contributing	Noncontributing		
<u>2</u>	Buildings	—	Buildings
—	Sites	—	Sites
—	Structures	—	Structures
—	Objects	—	Objects
<u>2</u>	Total	—	Total

C) For properties listed in the National Register:

National Register status: Listed De-listed NHL NPS DOE

D) For properties within a historic district:

- Property contributes to a National Register or local certified historic district.
- Property contributes to a potential historic district, based on professional historic/architectural survey and evaluation.
- Property *does not* contribute to the historic district in which it is located.

Historic district name: West side residential historic district Historic district site inventory number: 92-00350

Name of related project report or multiple property study, if applicable:

MPD Title

Historical Architectural Data Base #

Architectural and Historical Survey of the "west side" residential neighborhood in Washington 92-013

• **Function or Use** *Enter categories (codes and terms) from the Iowa Site Inventory Form Instructions*

A) Historic functions

B) Current functions

01A01: Domestic / residence

01A01: Domestic / residence

01C05: Domestic / garage

01C05: Domestic / garage

• **Description** *Enter categories (codes and terms) from the Iowa Site Inventory Form Instructions*

A) Architectural Classification

B) Materials

05D: Queen Anne

Foundation (visible exterior): 04: Stone

walls (visible exterior): 15B: vinyl

Roof: 05F: Steel

Other: _____

C) Narrative Description SEE CONTINUATION SHEETS, WHICH MUST BE COMPLETED

• **Statement of Significance**

A) Applicable National Register Criteria: *Mark your opinion of eligibility after applying relevant National Register criteria*

- Criterion A: Property is associated with significant events. Yes No More research recommended
- Criterion B: Property is associated with the lives of significant persons. Yes No More Research Recommended
- Criterion C: Property has distinctive architectural characteristics. Yes No More Research Recommended
- Criterion D: Property yields significant information in archeology/history. Yes No More Research Recommended

B) Special criteria considerations: *Mark any special considerations; leave blank if none*

- A Owned by a religious institution or used for religious purposes. E A reconstructed building, object, or structure.
- B Removed from its original location. F A commemorative property.
- C A birthplace or grave. G Less than 50 years of age or achieved significance within the past 50 years.
- D A cemetery

C) Areas of Significance

Enter categories from instructions

Community planning and development

D) Period(s) of significance

E) Significant dates

Construction date

1900 *check if circa or estimated date*

Other dates, including renovations

F) Significant person

Complete if Criterion B is marked above

G) Cultural affiliation

Complete if Criterion D is marked above

H) Architect/Builder

Architect

Builder/contractor

I) Narrative statement of significance **SEE CONTINUATION SHEETS, WHICH MUST BE COMPLETED**

• **Bibliography** *See continuation sheet for the list of research sources used in preparing this form*

• **Geographic Data** *Optional UTM references* *See continuation sheet for additional UTM references or comments*

UTM References (OPTIONAL)

Zone	Easting	Northing	NAD	Zone	Easting	Northing	NAD
1				2			
3				4			

• **Form Preparation**

Name and Title: Mary Patterson - volunteer Rebecca Lawin McCarley, consultant Date: July 28, 2015

Organization/firm: Washington Historic Preservation Commission E-mail: -

Street address: City Hall, 215 E. Washington St Telephone: 319-653-6584

City or Town: Washington State: Iowa Zip code: 52353

• **ADDITIONAL DOCUMENTATION** *Submit the following items with the completed form*

A) For all properties, attach the following, as specified in the Iowa Site Inventory Form Instructions:

1. **Map** of property's location within the community.
2. **Glossy color 4x6 photos labeled** on back with property/building name, address, date taken, view shown, and unique photo number.
3. **Photo key showing each photo number on a map and/or floor plan, using arrows next to each photo number to indicate the location and directional view of each photograph.**
4. **Site plan** of buildings/structures on site, identifying boundaries, public roads, and building/structure footprints.

B) For State Historic Tax Credit Part 1 Applications, historic districts and farmsteads, and barns:

See lists of special requirements and attachments in the Iowa Site Inventory Form Instructions.

State Historic Preservation Office (SHPO) Use Only Below This Line

The SHPO has reviewed the Site Inventory and concurs with above survey opinion on National Register eligibility:

- Yes No More Research Recommended
- This is a locally designated property or part of a locally designated district.*

Comments: _____

SHPO authorized signature: _____ Date: _____

Iowa Site Inventory Form
State Historic Preservation Office
Continuation Sheet

Site Number: 92-00423
Related District Number: 92-00350

Page 1

<u>Belle Smith House</u>	<u>Washington</u>
Name of Property	County
<u>415 W. Jefferson Street</u>	<u>Washington</u>
Address	City

Narrative Description

This is a two story frame Queen Anne house on the south side of W. Jefferson Street. The house sits on a cut stone foundation, and it is clad with vinyl siding. The cross gable roof is covered with corrugated steel roofing, and there is a historic brick chimney near the center of the house. The windows are wood with vinyl surrounds and aluminum storm / screens. There is a full front porch.

The façade, the north elevation, has two sections spanned by a front porch. The porch has wood steps, a wood floor, railing, and plain square wood balusters. The tapered round columns are wood, and there is dentil decoration along the frieze of the porch. The porch has a hip roof with steel roofing, and there is a pediment above the centrally located porch steps. The grating below the porch is vertical wood with slightly rounded tops. The left/east two-thirds of the façade protrudes somewhat from the right/west third. It has a wide one-over-one-light double-hung wood window on the left/east. On this section near the center of the house overall, there is an entry with a historic wood door with an aluminum storm / screen door. On the right/west section, there is another wide one-over-one-light double-hung wood window. The second story has a wide one-over-one-light double-hung wood window above the left window on the first story and a narrower one-over-one-light double-hung wood window above the front door on the left/east section. On the right/west section, there is a one-over-one-light double-hung wood window. At attic level, the left/east section terminates in the north gable, which is clad with wood shingles in a decorative pattern of fish scale and square shingling. A decorative fixed window is located at the center of the gable.

The east elevation is divided into three sections. On the right/north half, there is a wide one-over-one-light double-hung wood window, and on the second story, there is a narrower one-over-one-light double-hung wood window. The center section has an angled wall facing the street to the north, but a square corner on the south that continues into the rear section of the house. The angled wall has a one-over-one-light double-hung wood window on both the first and second stories. The east/main side of this half bay window has a wide one-over-one-light double-hung wood window on the first story, and the second story has a one-over-one-light double-hung wood window which is the same width as most of the other second story windows. The east gable crowns this section, and it is clad with wood shingles in a decorative pattern of fish scale and square shingling. There is centrally located decorative fixed window matching the window on the north facing gable. On the short south wall of this center section, there is a one-over-one-light double-hung wood window. The two-story rear section of the house then extends further to the south. It has an enclosed porch on the first story. A one-story enclosed back porch is tucked into the corner formed by the east section and rear section. It has an entry with a wood door and a wood storm door on the left/south and a one-over-one-light double-hung wood window to the right/north. There are three basement windows on this side of the house, one centered in the slightly protruding center wing, and two in the third section toward the rear of the house. The one-story rear addition extends further to the south. A small wood deck is located in the southeast corner formed by the enclosed porch on the east side and the addition.

The west elevation is divided into two sections on the main section of the house. The left/north half is the west cross gable section. It has a wide one-over-one-light double-hung wood window on the first story. To the right/south, there is a one-over-one-light double-hung stained glass wood window

Iowa Site Inventory Form
State Historic Preservation Office
Continuation Sheet

Site Number: 92-00423
Related District Number: 92-00350

Page 2

<u>Belle Smith House</u>	<u>Washington</u>
Name of Property	County
<u>415 W. Jefferson Street</u>	<u>Washington</u>
Address	City

between the first and second stories on this section. On the second story, there is a one-over-one-light double-hung wood window above the wider first story window. At attic level, the west gable is clad with wood shingles in a decorative pattern of fish scale and square shingling. A decorative fixed window, which matches the other two attic windows, is located at the center of the gable. The second section is the west side of the rear two-story section of the house. It has a smaller one-over-one-light double-hung wood window toward the right/south side of the section. There are no windows on the second story. There are three basement windows on this side of the house, one centered in the first section below the wider window and two on the rear wing of the house.

The south elevation, the rear of the house, consists of the rear gable-roof section of the main house, and a one-story gable-roof addition has been built on the first story. The addition sits on a poured concrete foundation, and it has a steel covered gable-front roof. The east elevation of the addition faces the wood deck, and it has a vinyl entry door at the left. The south elevation of the addition has a one-by-one-light sliding vinyl window centered below the gable. The west elevation of the addition has a smaller one-by-one-light sliding vinyl window, also centered in that elevation. Above the addition, the second story of the rear of the house has a rectangular vinyl awning window on the left/west, and a one-over-one-light double-hung wood window to the right/east. At attic level, the south gable is clad with square wood shingles.

The frame two and a half car garage is located at the southeast corner of the lot, with a driveway to the west and access from the alley. The assessor lists a construction date of c.1950. There is a shed-roof extension built on the north elevation of the garage. The garage faces west, and it has an aluminum double-car garage door. The north elevation has an entry door at the far right/west side of the wall. There is no fenestration on the remaining elevations of the garage.

Narrative Statement of Significance

The Belle Smith House appears to contribute historically to the potential "west side" residential historic district in Washington. The house was built during the period of development of the neighborhood around the turn of the century with large homes. This Queen Anne house was built in 1900 for Belle Smith, between her childhood home at the corner to the east and her sister's home to the west.

The house does not appear individually eligible for listing on the National Register of Historic Places under Criteria A, B, or C. The house does not appear to have particular architectural or historical significance.

History / research summary of property (chronological order, by owner/period):

Lots 1, 2, 3, and 4 were purchased by Hugh Smith in 1875. A brick house was already located on Lots 1 and 2 of the property. Following Smith's death in 1891, Lot 3 part of a dispute involving Lots 1, 2, 3 and 4 of Block 5 in the Addition to Washington. On September 20, 1893, referees J.T. Anderson, Wm. A. Cook, and Frank Stewart awarded Lots 1, 2, and 3 to his daughter Belle J. Smith. Lot 4 was awarded

Iowa Site Inventory Form
State Historic Preservation Office
Continuation Sheet

Site Number: 92-00423
Related District Number: 92-00350

Page 3

<u>Belle Smith House</u>	<u>Washington</u>
Name of Property	County
<u>415 W. Jefferson Street</u>	<u>Washington</u>
Address	City

to the opposing side of the dispute (Sarah J. Wilson). The older brick house sat primarily on Lot 1, facing Avenue C to the east. Lot 2 was then the back yard, with Lot 3 further to the west.

The 1894 city directory lists Mrs. H. Smith living at 301 S. First Street (now Avenue C), the brick house on Lot 1. In the May 24, 1899 edition of the *Washington Press*, a brief note says, "Mrs. Hugh Smith thinks of building opposite Morton, facing north, and sell the present home." The house where she had been living, at 301 South Avenue C, was sold on October 9, 1900. By 1900, there are two households listed in the same house: Catharine Smith, head of the household, age 80, and her daughter Belle J., age 49 and single. Lee D. Robinson is also listed as head of the household and living in the same dwelling. He is 49 years old and lists his occupation as a jewelry merchant. His wife Catharine (Smith) Robinson is 47 years old. They are listed between William A. Wilson and his wife Sarah, also a daughter of Catharine Smith, who are living at 302 South Avenue D, and the John Morton family living across the street at 414 W. Jefferson. Building notes in the *Washington Gazette* on March 16, 1900, page 3, state that "Contracts have been let for the residences of L.D. Robinson and Miss Belle Smith. Mr. Robinson will build on the corner, just across the street from Eugene Anderson's residence [400 W. Washington] and Miss Smith on west Jefferson street, between the residence now occupied by herself and her mother and Will Wilson's home."

The 1902 Sanborn map does not show individual houses, but does note there are three brick dwellings and two frame dwellings on this block, including this house. The 1903 city directory lists Mrs. Hugh Smith and Belle Smith living at 413 W. Jefferson Street. There is a listing in the 1904 and 1908 telephone directories for Miss Belle Smith, but unfortunately, no address are included in these directories. The 1909 Sanborn map shows the house with a full front porch and a small rear porch at the southeast corner of the house. The 1910-11 city directory identifies Mrs. Catherine Smith, widow of Hugh, and Miss Betty (sic.) Y. Smith living at 413 E. Jefferson. The 1920 census lists Catharine Smith, head of the household and home owner with no mortgage, age 90, and her daughter Belle, single and age 58, living on Jefferson Street (no number given).

Belle Smith sold the property to Charles Speer and wife on June 14, 1916. In 1917, the Sanborn map shows no rear porches, but on the 1931 and 1943 maps, the rear side porch is again shown. The 1917 county directory lists the residents at 413 W. Jefferson as Charles A. Speer, meat dealer, and his wife Myrtle. William Bragg is also living at this address. The 1920 census identifies the family at 413 W. Jefferson Street as C.A. Speer, a home owner with a mortgage, age 38, his wife Myrtle E., age 40, and her son William Bragg, age 13. Speer is working as a merchant in a meat market. The 1926 telephone directory has a listing for Charles Speer at this address, and the Business Classified Directory in the back of the book also lists Oriez and Speer Meat Market at 105 W. Washington Street. The 1930 census lists the family here: Charles Arthur Speer, age 47, meat market, married at age 33; wife Myrtle Morton Speer, age 51, married at age 37, and step-son William Morton Bragg, age 23, embalmer for an undertaker. The house is valued at \$4,000. Charles Speer is listed at 415 W. Jefferson Street in the 1932 and 1938 telephone directories, and in the 1935 city directory, the listing says Charles A. Speer (Myrtle E.) Oriez & Speer, 415 W. Jefferson. The 1940 census lists O.E. Sisk, a renter paying \$25 a month, living at 415 W. Jefferson Street. He is 55 years old, head of the household, working as a telegrapher for the railroad, and lives here with his wife Julia, age 45, and their daughter Phyllis June,

Iowa Site Inventory Form
State Historic Preservation Office
Continuation Sheet

Site Number: 92-00423
Related District Number: 92-00350

Page 4

<u>Belle Smith House</u>	<u>Washington</u>
Name of Property	County
<u>415 W. Jefferson Street</u>	<u>Washington</u>
Address	City

age 17. Sisk also appears in the 1941 city directory which repeats the census information and adds that he works for the Chicago Milwaukee St. Paul and Pacific Railroad.

Speer transferred the property to W.S. and Jennie V. Eldridge on September 28, 1944. There are no telephone or city directories available between 1941 and 1951.

Eldridge sold the property to Wayne A. Jr. and Kay Simmerman on September 27, 1950, and two weeks later, on October 14, 1950, Simmerman sold it to Harold C. and Frieda M. Miller. The 1951 telephone directory lists Harold C. Miller living at 415 W. Jefferson. He is also listed at this address in the 1954 city directory index, but does not appear in the 1954 telephone directory.

Miller transferred the property to Charles E. and Evelyne T. Lawson on August 22, 1954. The 1955 telephone directory lists Charles E. Lawson living at this address, and the listing is repeated through the 1960 telephone directory.

On September 9, 1961, Lawson sold the property to James W. and Sherri K. Stalder, and they are listed in the 1962 telephone directory at this address. The 1964 city directory lists J.W. Stalder, working maintenance at the county yards, his wife Sherri K. and children Lori Luann, age 5, Gina, age 4, Kevin James, age 2, and Debra Sue, age 1 living at 415 W. Jefferson. By 1967, the directory listing is for Jim Stadler, owner of the Diamond Inn, with his wife Sherri and the same children. In 1969, the listing is for Mrs. Sherri Stalder, widow of Jim, with the four children. Then in the 1972 city directory, the residents at this address are Carroll F. Hershberger, an employee at Farmers Supply Sales, his wife Sherri K., and children Lori, Gina, Kevin, and Debbie.

Sherri K. Hershberger and husband sold the property to Richard W. and Nancy Jo Collins on August 24, 1974, and later that same day, Collins sold it to Thomas and Diane Ganson. He appears in the 1976 city directory working as a driver and salesman for Tony's Pizza, with his wife Diane and daughters Angela, born in 1969, and Jennifer, born in 1971. The family is also listed in the 1978 city directory where Thomas is working as a salesman for Davis Marketing, and a son Scott, born in 1975, has been added to the family.

Ganson transferred the property to Dale Torpey, on May 15, 1978. He is listed in the 1978 city directory as a cashier at National Bank of Washington, and is living at the address.

Torpey, single, sold the property to Steven D. and Linda Kay Soundy on September 23, 1980.

Iowa Site Inventory Form
State Historic Preservation Office
Continuation Sheet

Site Number: 92-00423
Related District Number: 92-00350

Page 5

<u>Belle Smith House</u>	<u>Washington</u>
Name of Property	County
<u>415 W. Jefferson Street</u>	<u>Washington</u>
Address	City

Bibliography

Atlas of Washington County, Iowa. Clinton, IA, and Philadelphia, PA: Harrison and Warner, 1874.

Atlas of Washington County, Iowa. No publisher noted, 1894. In collection of Washington Public Library.

Burrell, Howard A. *History of Washington County, Iowa.* Chicago, IL: S.J. Clarke Publishing Company, 1909. 2 volumes.

City/telephone directories. Washington Public Library. Various years, including 1894, 1903, 1908, 1910-11, 1917, 1932, 1934, 1935, 1938, 1941, 1952, 1954, 1956, 1958, 1960, 1962, 1964, 1967, 1969, 1972, and 1976.

Fisher, Kathy. *In the beginning there was land : a history of Washington County, Iowa.* Washington, Iowa: Washington County Historical Society, 1978.

Newspapers, including anniversary/celebration editions on microfilm and/or bound at Washington Public Library:

Washington Gazette, January 6, 1893

Twentieth Anniversary Edition, *Evening Journal*, April 26, 1913

Twenty-Fifth Anniversary Edition, *Evening Journal*, April 3, 1926

Washington County Centennial Edition, *Evening Journal*, July 1936

Souvenir Edition of Washington Centennial, *The Evening Journal*, August 1939

Sixtieth Anniversary Edition, *The Washington Evening Journal*, February 27, 1953

Bicentennial edition, *The Washington Evening Journal*, July 1, 1976

Sesquicentennial edition, *The Washington Evening Journal*, April 13, 1989

Patterson, Mary. Collection of historic postcards, images, and city/telephone directories. Washington, Iowa. Accessed 2014-2015.

Portrait and Biographical Album of Washington County, Iowa. Chicago, Acme Publishing Company, 1887.

Sanborn Map Company. *Washington, Iowa.* Fire insurance maps. 1885, 1892, 1897, 1902, 1909, 1917, 1931, 1943.

Souvenir History of Washington, Iowa. Washington, IA: Washington Evening Journal, June 23, 1989.

Washington County Historical Society. Collection of historic postcards and photographs.

Iowa Site Inventory Form
State Historic Preservation Office
Continuation Sheet

Site Number: 92-00423
Related District Number: 92-00350

Page 6

Belle Smith House
Name of Property

Washington
County

415 W. Jefferson Street
Address

Washington
City

Location map



2009 aerial photograph (Washington County) – line indicates survey/research area boundary

Iowa Site Inventory Form
State Historic Preservation Office
Continuation Sheet

Site Number: 92-00423
Related District Number: 92-00350

Page 7

<u>Belle Smith House</u>	<u>Washington</u>
Name of Property	County
<u>415 W. Jefferson Street</u>	<u>Washington</u>
Address	City

Building plan (from assessor's website)

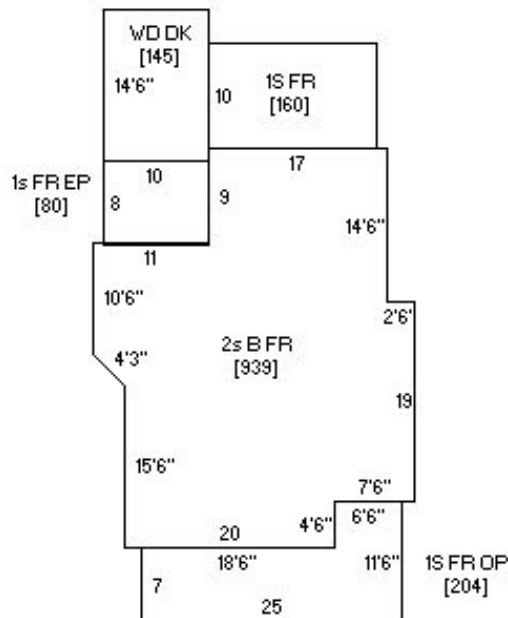

Photo from assessor's website



Iowa Site Inventory Form
State Historic Preservation Office
Continuation Sheet

Site Number: 92-00423
Related District Number: 92-00350

Page 8

Belle Smith House
Name of Property

Washington
County

415 W. Jefferson Street
Address

Washington
City

Digital photographs



Photograph 92-00423-001 - House, looking southeast (December 2014)

Iowa Site Inventory Form
State Historic Preservation Office
Continuation Sheet

Site Number: 92-00423
Related District Number: 92-00350

Page 9

Belle Smith House
Name of Property

Washington
County

415 W. Jefferson Street
Address

Washington
City



Photograph 92-00423-002 - House, looking southwest (December 2014)

Iowa Site Inventory Form
State Historic Preservation Office
Continuation Sheet

Site Number: 92-00423
Related District Number: 92-00350

Page 10

Belle Smith House
Name of Property

Washington
County

415 W. Jefferson Street
Address

Washington
City



Photograph 92-00423-003 - House, looking northeast (December 2014)

Iowa Site Inventory Form
State Historic Preservation Office
Continuation Sheet

Site Number: 92-00423
Related District Number: 92-00350

Page 11

Belle Smith House
Name of Property

Washington
County

415 W. Jefferson Street
Address

Washington
City



Photograph 92-00423-004 - Garage, looking southeast (December 2014)