

Iowa Site Inventory Form

State Historic Preservation Office

(July 2014)

State Inventory Number: 92-00735 New Supplemental

9-Digit SHPO Review & Compliance (R&C) Number _____

Non-extant Year: _____

Read the Iowa Site Inventory Form Instructions carefully, to ensure accuracy and completeness before completing this form. The instructions are available on our website: <http://www.iowahistory.org/historic-preservation/statewide-inventory-and-collections/iowa-site-inventory-form.html>

• Property Name

A) Historic name John W. and Emma A. Morton House

B) Other names: West side survey map #WS-020

• Location

A) Street address: 414 W. Jefferson Street

B) City or town: Washington (Vicinity) County Washington

C) Legal Description:

Rural: Township Name: _____ Township No.: _____ Range No.: _____ Section: _____ Quarter: _____ of Quarter: _____

Urban: Subdivision: Addition to Washington Block(s): 4 Lot(s): Lot 6 and the W 7 ft. of S. 1/2 Lot 7

• Classification

A) Property category: *Check only one*

- Building(s)
- District
- Site
- Structure
- Object

B) Number of Resources (within property)

If eligible property, enter number of:		If non-eligible property, enter number of:	
Contributing	Noncontributing		
<u>2</u>	Buildings	—	Buildings
—	Sites	—	Sites
—	Structures	—	Structures
—	Objects	—	Objects
<u>2</u>	Total	—	Total

C) For properties listed in the National Register:

National Register status: Listed De-listed NHL NPS DOE

D) For properties within a historic district:

- Property contributes to a National Register or local certified historic district.
- Property contributes to a potential historic district, based on professional historic/architectural survey and evaluation.
- Property *does not* contribute to the historic district in which it is located.

Historic district name: West side residential historic district Historic district site inventory number: 92-00350

Name of related project report or multiple property study, if applicable:

MPD Title

Historical Architectural Data Base #

Architectural and Historical Survey of the "west side" residential neighborhood in Washington 92-013

• **Function or Use** *Enter categories (codes and terms) from the Iowa Site Inventory Form Instructions*

A) Historic functions

B) Current functions

01A01: Domestic / residence

01A01: Domestic / residence

01C05: Domestic / garage

01C05: Domestic / garage

• **Description** *Enter categories (codes and terms) from the Iowa Site Inventory Form Instructions*

A) Architectural Classification

B) Materials

05D: Queen Anne

Foundation (visible exterior): 04: Stone

walls (visible exterior): 15B: vinyl

Roof: 08A: Asphalt shingles

Other: _____

C) Narrative Description **SEE CONTINUATION SHEETS, WHICH MUST BE COMPLETED**

• **Statement of Significance**

A) Applicable National Register Criteria: *Mark your opinion of eligibility after applying relevant National Register criteria*

- Criterion A: Property is associated with significant events. Yes No More research recommended
Criterion B: Property is associated with the lives of significant persons. Yes No More Research Recommended
Criterion C: Property has distinctive architectural characteristics. Yes No More Research Recommended
Criterion D: Property yields significant information in archeology/history. Yes No More Research Recommended

B) Special criteria considerations: *Mark any special considerations; leave blank if none*

- A Owned by a religious institution or used for religious purposes. E A reconstructed building, object, or structure.
 B Removed from its original location. F A commemorative property.
 C A birthplace or grave. G Less than 50 years of age or
 D A cemetery achieved significance within the past 50 years.

C) Areas of Significance

Enter categories from instructions

Community planning and development

D) Period(s) of significance

E) Significant dates

Construction date

1889 *check if circa or estimated date*

Other dates, including renovations

F) Significant person

Complete if Criterion B is marked above

G) Cultural affiliation

Complete if Criterion D is marked above

H) Architect/Builder

Architect

Builder/contractor

I) Narrative statement of significance **SEE CONTINUATION SHEETS, WHICH MUST BE COMPLETED**

• **Bibliography** *See continuation sheet for the list of research sources used in preparing this form*

• **Geographic Data** *Optional UTM references* *See continuation sheet for additional UTM references or comments*

UTM References (OPTIONAL)

Zone	Easting	Northing	NAD	Zone	Easting	Northing	NAD
1	_____	_____	_____	2	_____	_____	_____
3	_____	_____	_____	4	_____	_____	_____

• **Form Preparation**

Name and Title: Mary Patterson - volunteer Rebecca Lawin McCarley, consultant Date: September 24, 2015

Organization/firm: Washington Historic Preservation Commission E-mail: -

Street address: City Hall, 215 E. Washington St Telephone: 319-653-6584

City or Town: Washington State: Iowa Zip code: 52353

• **ADDITIONAL DOCUMENTATION** *Submit the following items with the completed form*

A) For all properties, attach the following, as specified in the Iowa Site Inventory Form Instructions:

- 1. Map** of property's location within the community.
- 2. Glossy color 4x6 photos labeled** on back with property/building name, address, date taken, view shown, and unique photo number.
- 3. Photo key showing each photo number on a map and/or floor plan, using arrows next to each photo number to indicate the location and directional view of each photograph.**
- 4. Site plan** of buildings/structures on site, identifying boundaries, public roads, and building/structure footprints.

B) For State Historic Tax Credit Part 1 Applications, historic districts and farmsteads, and barns:

See lists of special requirements and attachments in the Iowa Site Inventory Form Instructions.

State Historic Preservation Office (SHPO) Use Only Below This Line

The SHPO has reviewed the Site Inventory and concurs with above survey opinion on National Register eligibility:

- Yes No More Research Recommended
 This is a locally designated property or part of a locally designated district.

Comments: _____

SHPO authorized signature: _____ Date: _____

Iowa Site Inventory Form
State Historic Preservation Office
Continuation Sheet

Site Number: 92-00735
Related District Number: 92-00350

Page 1

John W. and Emma A. Morton House
Name of Property

Washington
County

414 W. Jefferson Street
Address

Washington
City

Narrative Description

This is a two-story frame Queen Anne house on the north side of W. Jefferson Street. The house sits on a cut stone foundation, and it is clad with vinyl siding. The combination hip and cross gable roof is covered with asphalt shingles. There is a wrap-around porch on the south and east sides of the house, and a one story enclosed porch at the rear of the house. The windows are vinyl replacements. A frame garage sits at the north end of the property with access from the alley.

The façade, the south elevation, has wood wrap around porch with concrete steps on the south side of the west end, and wood steps north end of the east side. There is a pediment above the front steps, and there is no railing on this porch except at the steps. The main section of the facade is divided into two sections, with the larger right/east gable-roof section protruding a few feet from the left/west section. There is an entry in this left/west section, with a vinyl door with a decorative window in the upper half of the door. A small one-over-one-light double-hung vinyl window is found on the second story above the entry. On the protruding gable-roof section to the right, there is a small one-over-one-light double-hung vinyl window and then a centered larger one-over-one-light double-hung vinyl window on the first story. On the second story, this section has a small one-over-one-light double-hung vinyl window on the left and a larger one-over-one-light double-hung vinyl window near center. The gable is covered with wood fishscale shingles and has boarded up window centered below the peak of the gable. The porch continues around the east side of the house, meeting the south wall of the east gable-roof wing. This short wall has a side entry with a vinyl door with a decorative window in the upper half of the door.

The east elevation has three sections: the side of the front/south wing, the gable-roof east wing, and the side of the rear wing. The left/front/south section where the front porch wraps around to the east side of the house, there is a one-over-one-light double-hung vinyl window, with another one-over-one-light double-hung vinyl window above it on the second story. The center gable-roof section protrudes somewhat, and has an angled wall on the left/southeast corner. There is a one-over-one-light double-hung vinyl window in the angled wall on both the first and second stories. Decorative brackets are found above this window under the corner of the gable. The main, east facing portion of this section has a one-over-one-light double-hung vinyl window centered in the wall of both the first and second stories. The gable is clad with wood fishscale shingles, and an attic window in the gable has been boarded up. The short north wall of this section has a one-over-one-light double-hung vinyl window on both the first and second stories of the central wing. The third section is the side of the north wing of the house, and has two evenly distributed one-over-one-light double-hung vinyl windows on the first story. Above, on the second story, there is a small one-over-one-light double-hung vinyl window centered on the wall. There are two basement windows on this side of the house, one centered in the second section and the other centered in the third section. Both are closed with plain concrete block.

The west elevation is divided into three sections: the side of the front/south wing, the gable-roof west wing, and the side of the rear wing. On the front/south/right section, there is a one-and-one-half-story staircase addition. An extension of the front porch extends around the corner to access the entry on the south side of this addition. There is a small one-over-one-light double-hung vinyl window high on the staircase wall and toward the far left of this section. The center gable-roof west section protrudes

Iowa Site Inventory Form
State Historic Preservation Office
Continuation Sheet

Site Number: 92-00735
Related District Number: 92-00350

Page 2

John W. and Emma A. Morton House
Name of Property

Washington
County

414 W. Jefferson Street
Address

Washington
City

somewhat, and it has an angled wall on the right/southwest corner. There are no windows on the angled wall, but there is a one-over-one-light double-hung vinyl window on both the first story and the second story of the main, west facing portion of this section. The gable is covered with wood fishscale shingles, and it has a ventilation grill installed below the peak of the gable. On the short north wall of this section, there is a one-over-one-light double-hung vinyl window on the first story. The third/north/rear section, the west elevation of the rear wing of the house, has two evenly distributed one-over-one-light double-hung vinyl windows on the north half of the first story, with an entry with a vinyl door at the far right side of the section. There is a small hip roof porch with a small wood stoop and steps. On the second story, there is a small one-over-one-light double-hung vinyl window toward the right of center, with a small vinyl sliding window located above the first story entry door.

The north elevation, the rear of the house, has an enclosed one-story porch on the first story. The porch has a hip roof covered with asphalt shingles and it sits on a stone foundation. This enclosed porch is divided into two approximately equal halves. The left/east half is clad with wood and has a vertical wood grill below the floor, while the right/west half sits on a cut stone foundation and has narrow wood weatherboard on the north facing wall. The 1909 Sanborn map shows that the west half was originally enclosed, while the east half was an open porch. There is vinyl siding on the west elevation of the porch, and wood siding with a plywood covered entry on the east elevation of the porch. On the left half of the porch, there is a one-over-one-light double-hung vinyl window, with a six pane fixed wood window to the right. There are two decorative wood panels, probably remnants of the porch railing, below these two windows. The right half of the rear porch has a small one-over-one-light double-hung vinyl window located just under the eaves and to the left side of this part of the porch. The west elevation of the porch has a small sliding vinyl window just below the eaves. On the second story of the rear wing, there are two evenly distributed one-over-one-light double-hung vinyl windows with a smaller one-over-one-light double-hung vinyl window in the gable at the attic level.

A frame garage sits at the northwest corner of the lot, facing east, with access from the alley. It has no visible foundation, and it has a dirt floor. It is clad with wood board and batten siding, and has exposed rafter ends, with asphalt shingles on the roof. There is a wood sliding garage door on the east elevation. The south elevation has a wood door at the far right end of the wall, and a window opening (with no window) centered in the wall. The north and west elevations have no fenestration. The garage appears to be here on the 1917 and later Sanborn maps, with an earlier building on the 1909 map.

Narrative Statement of Significance

The John W. and Emma A. Morton House appears to contribute historically to the potential “west side” residential historic district in Washington. The house was built during the period of development at the end of the 19th century of the neighborhood with large homes for successful businessmen, and it contributes to this significance. Though the house has sustained some later modifications, the house continues to read as a large Queen Anne home on this lot.

The house does not appear individually eligible for listing on the National Register of Historic Places under Criteria A, B, or C. The house does not appear to have particular architectural or historical

Iowa Site Inventory Form
State Historic Preservation Office
Continuation Sheet

Site Number: 92-00735
Related District Number: 92-00350

Page 3

John W. and Emma A. Morton House	Washington
Name of Property	County
414 W. Jefferson Street	Washington
Address	City

significance, and the integrity has been impacted by the later windows, siding, and conversion to apartments.

History / research summary of property (chronological order, by owner/period):

The 1874 and 1894 atlases of Washington shows an earlier rectangular house, and the 1869 birds-eye view show it to be a gable-front house. Willie D. Miller purchased Lot 6 on November 15, 1885, and three years later, on November 10, 1888, purchased the west 7 feet of the south half of Lot 7. Miller sold Lot 6 and the west 7 feet of the south half of Lot 7 to Alice Morton on June 6, 1889. This Queen Anne house was then likely built in 1889. The 1895 Iowa census list the Morton family on the same page as Catharine Smith and Wm. A. Wilson (lived on this south side of this block). The household includes John W. (52, insurance agent), Alice (40), Nannie (20), Maud (18), Myrtle (16), Mable (14), Walter (9), Susan M. (7), and Helen (2). On January 14, 1872, the A.O.U.W. (Ancient Order of Union Workers), Hawkeye Lodge No. 1 was organized in Washington, the first lodge of the order in the state. Charter members were: A. R. Dewey, C. H. Dixon, W. T. Smith, J. H. Taylor, J. W. Morton, J. M. Stinson, and S. P. :Montgomery. The purpose noted in the 1880 history was life insurance. For \$4 per year, the family received \$2,000 upon death, and they had over 100 members by 1880 (*History of Washington County* 1880: 558). The 1900 census lists John W. Morton, head of the household and home owner with no mortgage, an insurance agent, age 57. His household includes his wife Alice A., age 45, Maud E., single and a sales woman for a druggist, age 23, Myrtle E., age 21 and single, Mabel E., age 16, Walter, age 13, Susie M., age 11, Helen A., age 7, and Mildred, age 4. They are listed between Catharine Smith and Harry Shrader (house to east). This block is not depicted on the 1902 Sanborn map.

The 1903 city directory lists the residents at 414 W. Jefferson Street as J.W. Morton, insurance agent, his wife Alice, and children Susie, Helen, Mildred, Mathel. Separate listings were included for Walter, a student, Mable, a stenographer, Maud, a clerk, and Myrtle, a stenographer, but are also living at this address. The 1904 telephone directory, which has no addresses, has a listing for J.W. Morton's residence, and another for his office. The 1909 Sanborn map is the first map to show this block in detail and shows the current house. The 1910 census lists the family living at 414 W. Jefferson as John W. Morton, age 65, a real estate agent; his wife Alice, age 54; Maud, age 33, single and working as a sales lady in a dry goods store, Mabel, age 24, single and working as a deaconess, a pastor's assistant; Helen, age 16; Mildred, age 13; and Mathel, a daughter, age 7. The 1910-11 city directory's entry for the family adds the information that Morton sells both real estate and insurance, and has an office at 122 1/2 W. Main Street. Miss Maude Morton is a clerk at the New York Store, and Miss Mildred is a student. The other children are not included in the city directory listing. Emma Alice (Rogers) Morton died on December 4, 1915. By 1917, the city directory lists John W. Morton still at this address, working as an insurance agent. His wife is listed as Emma A., and Helen and Mildred are working as teachers, while Mathel is a student. The 1920 census for this address lists John W. Morton, head of the household, and home owner with no mortgage, age 78, working as an insurance agent, his daughter Mabel, age 35, single and bookkeeper in a bank, and daughter Mathell, age 19 and not working. John Wesley Morton died on May 14, 1926. No Mortons are listed in the 1926 telephone directory.

Iowa Site Inventory Form
State Historic Preservation Office
Continuation Sheet

Site Number: 92-00735
Related District Number: 92-00350

Page 4

<u>John W. and Emma A. Morton House</u>	<u>Washington</u>
Name of Property	County
<u>414 W. Jefferson Street</u>	<u>Washington</u>
Address	City

On several dates in September 1930, Myrtle Speer and husband (Charles Speer), Mabel Morton, Maude Schnoebelen, and Walter Morton presented quit claim deeds to Mayme Cunningham. In this period, Charles and Myrtle (Morton) Speer lived across the street at 415 W. Jefferson (1915-1935). The 1930 census lists Belle Carris (widow, age 78) renting the house at 414 W. Jefferson for \$30 per month, living here with daughter May Carris Jay (58, divorced, nurse). The 1935 directory lists the property as vacant. Mayme Cunningham and husband transferred the property to Lloyd Vanderham on August 12, 1935, but then provided Wade Gardner with a quit claim deed on November 9, 1935. No listing was identified for this address in the 1938 city directory.

Wade Gardner sold the property to Jessie B. Stewart on March 11, 1940. She was not identified in the 1940 census. In spring 1940, she converted the property into four apartments of five rooms each. Additionally, she installed new hardwood floors, light ivory enamel on woodwork, new wiring, new plumbing, and a new heating system. Initial occupants were Miss Stewart, Mrs. Seymour Martin, Mr. and Mrs. John Westphal, and Mary and Mae McCreedy ("Building Activity Reported," *Democrat Independent*, May 8, 1940, 1). The 1941 city directory lists Miss Jessie B. Stewart, home owner and a nurse, living at 414 W. Jefferson Street, along with Mrs. Inez Martin, a widow. There is also a listing at 414 ½ W. Jefferson Street for John Westphal, owner of Westphal Jewelry, with his wife Katherine, and Miss Mary Westphal, a stenographer at Iowa Southern Utilities Co., and a listing at 414 ½ W. Jefferson for C.B. Lipscomb, a salesman, and his wife Esther. The 1952 telephone directory lists Jessie B. Stewart living here. The 1954 city directory lists Jessie B. Stewart, Ray Box, Mrs. Mae McCreedy, and Mrs. Myrtle Simmerman living at this address.

Stewart transferred the property to Alice W. and Ethel M Eichelberger on June 1, 1955. They continued to own the house through 1974, using it as a rental property. The 1964 city directory lists James D. Jones, a truck driver for Havel and Sons, and his wife Nita N. living at 414 W. Jefferson Street. Also listed at that address are Mrs. Winnie G. Baker (widow of Lynn A.), and Mrs. Phyllis J. Duncan, a lugger at Advance Ross Electronics Corp. Eugene Brock, an employee at Blue Bird Bus Co., his wife Nancy J., and daughter Pamela, age 1, are living at 414 ½ W. Jefferson. In 1967, the city directory listings have changed completely. At the 414 address are Nancy J. Greiner, a checker at Fareway, Laverne Smothers, a beautician at Evelyn's Beauty Shop, Jeri Lee Snider, a dining room attendant at Halcyon House Retirement Home, and Aileen L. Snider, a cashier at Jack & Jill Grocery. The 414 ½ address is home to Arleen Chalupa, a waitress at Winga's Café, Janise Chalupa, secretary at a fertilizer company, and Linda Greiner, secretary and receptionist at KCII radio. The 1969 city directory for 414 W. Jefferson still lists Jeri Lee Snider and Aileen L. Snider, both working at the same jobs, along with Mrs. Louisa M. Kimmel, widow of John, and Fern Kimmel. The 414 ½ address is home to Rhonda Horak, a bookkeeper at Crane Co., and Barbara K. Roth, a sales clerk at Seifert's Store for Women. The residents at both the 414 and 414 ½ addresses are all different by 1972. Living downstairs are Mrs. Geneva E. Christian (widow of Ora), working at Winga's Café, Stephen L. Johnson, a power truck operator at Crane Co., and his wife Sandra and daughter Kimberly, and Alan Wayne Clark, working for Iowa Southern Utilities Co. Upstairs, Nellie Miller, a nurses' aide at the Washington County Hospital is the only resident.

Iowa Site Inventory Form
State Historic Preservation Office
Continuation Sheet

Site Number: 92-00735
Related District Number: 92-00350

Page 5

John W. and Emma A. Morton House
Name of Property

Washington
County

414 W. Jefferson Street
Address

Washington
City

Bibliography

Atlas of Washington County, Iowa. Clinton, IA, and Philadelphia, PA: Harrison and Warner, 1874.

Atlas of Washington County, Iowa. No publisher noted, 1894. In collection of Washington Public Library.

Burrell, Howard A. *History of Washington County, Iowa.* Chicago, IL: S.J. Clarke Publishing Company, 1909. 2 volumes.

City/telephone directories. Washington Public Library. Various years, including 1894, 1903, 1908, 1910-11, 1917, 1932, 1934, 1935, 1938, 1941, 1952, 1954, 1956, 1958, 1960, 1962, 1964, 1967, 1969, 1972, and 1976.

Fisher, Kathy. *In the beginning there was land : a history of Washington County, Iowa.* Washington, Iowa: Washington County Historical Society, 1978.

History of Washington County, Iowa. Des Moines, IA: Union Historical Co., 1880.

Koch, Augustus. *Birds-eye View of the City of Washington.* Chicago: Chicago Lithograph Company, 1869.

Newspapers, including anniversary/celebration editions on microfilm and/or bound at Washington Public Library:

Washington Gazette, January 6, 1893

Twentieth Anniversary Edition, *Evening Journal*, April 26, 1913

Twenty-Fifth Anniversary Edition, *Evening Journal*, April 3, 1926

Washington County Centennial Edition, *Evening Journal*, July 1936

Souvenir Edition of Washington Centennial, *The Evening Journal*, August 1939

Sixtieth Anniversary Edition, *The Washington Evening Journal*, February 27, 1953

Bicentennial edition, *The Washington Evening Journal*, July 1, 1976

Sesquicentennial edition, *The Washington Evening Journal*, April 13, 1989

Patterson, Mary. Collection of historic postcards, images, and city/telephone directories. Washington, Iowa. Accessed 2014-2015.

Portrait and Biographical Album of Washington County, Iowa. Chicago, Acme Publishing Company, 1887.

Sanborn Map Company. *Washington, Iowa.* Fire insurance maps. 1885, 1892, 1897, 1902, 1909, 1917, 1931, 1943.

Souvenir History of Washington, Iowa. Washington, IA: Washington Evening Journal, June 23, 1989.

Washington County Historical Society. Collection of historic postcards and photographs.

Iowa Site Inventory Form
State Historic Preservation Office
Continuation Sheet

Site Number: 92-00735
Related District Number: 92-00350

Page 6

John W. and Emma A. Morton House
Name of Property

Washington
County

414 W. Jefferson Street
Address

Washington
City

Location map



2009 aerial photograph (Washington County) – line indicates survey/research area boundary

Iowa Site Inventory Form
State Historic Preservation Office
Continuation Sheet

Site Number: 92-00735
Related District Number: 92-00350

Page 7

John W. and Emma A. Morton House
Name of Property

Washington
County

414 W. Jefferson Street
Address

Washington
City

Building plan (from assessor's website)

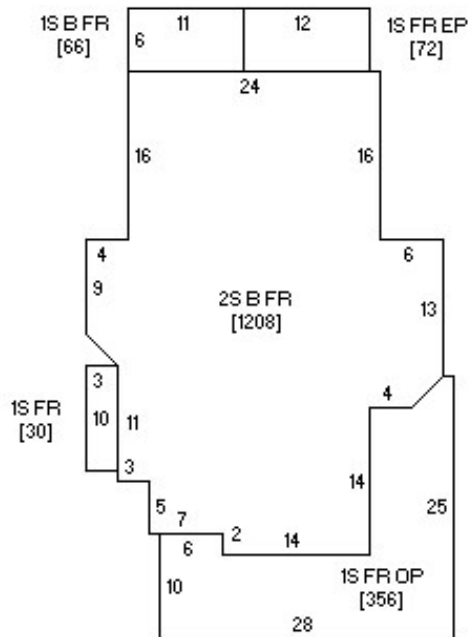

Photo from assessor's website



Iowa Site Inventory Form
State Historic Preservation Office
Continuation Sheet

Site Number: 92-00735
Related District Number: 92-00350

Page 8

John W. and Emma A. Morton House
Name of Property

Washington
County

414 W. Jefferson Street
Address

Washington
City

Digital photographs



Photograph 92-00735-001 - House, looking northwest (December 2014)

Iowa Site Inventory Form
State Historic Preservation Office
Continuation Sheet

Site Number: 92-00735
Related District Number: 92-00350

Page 9

John W. and Emma A. Morton House
Name of Property

Washington
County

414 W. Jefferson Street
Address

Washington
City



Photograph 92-00735-002 - House, looking northeast (December 2014)

Iowa Site Inventory Form
State Historic Preservation Office
Continuation Sheet

Site Number: 92-00735
Related District Number: 92-00350

Page 10

John W. and Emma A. Morton House
Name of Property

Washington
County

414 W. Jefferson Street
Address

Washington
City



Photograph 92-00735-003 - House, looking southeast (December 2014)

Iowa Site Inventory Form
State Historic Preservation Office
Continuation Sheet

Site Number: 92-00735
Related District Number: 92-00350

Page 11

John W. and Emma A. Morton House
Name of Property

Washington
County

414 W. Jefferson Street
Address

Washington
City



Photograph 92-00735-004 - House, looking southwest (December 2014)

Iowa Site Inventory Form
State Historic Preservation Office
Continuation Sheet

Site Number: 92-00735
Related District Number: 92-00350

Page 12

John W. and Emma A. Morton House
Name of Property

Washington
County

414 W. Jefferson Street
Address

Washington
City



Photograph 92-00735-005 - Garage, looking southwest (December 2014)