

Iowa Site Inventory Form

State Historic Preservation Office

(July 2014)

State Inventory Number: 92-00740 New Supplemental

9-Digit SHPO Review & Compliance (R&C) Number _____

Non-extant Year: _____

Read the Iowa Site Inventory Form Instructions carefully, to ensure accuracy and completeness before completing this form. The instructions are available on our website: <http://www.iowahistory.org/historic-preservation/statewide-inventory-and-collections/iowa-site-inventory-form.html>

• Property Name

A) Historic name Walter and Margaret Kyle House

B) Other names: West side survey map #WS-025

• Location

A) Street address: 510 W. Jefferson Street

B) City or town: Washington (Vicinity) County Washington

C) Legal Description:

Rural: Township Name: _____ Township No.: _____ Range No.: _____ Section: _____ Quarter: _____ of Quarter: _____

Urban: Subdivision: Subdivision of Outlot 3 Block(s): _____ Lot(s): Lot 8

• Classification

A) Property category: *Check only one*

- Building(s)
- District
- Site
- Structure
- Object

B) Number of Resources (within property)

If eligible property, enter number of:		If non-eligible property, enter number of:	
Contributing	Noncontributing		
<u>1</u>	Buildings	—	Buildings
—	Sites	—	Sites
—	Structures	—	Structures
—	Objects	—	Objects
<u>1</u>	Total	—	Total

C) For properties listed in the National Register:

National Register status: Listed De-listed NHL NPS DOE

D) For properties within a historic district:

- Property contributes to a National Register or local certified historic district.
- Property contributes to a potential historic district, based on professional historic/architectural survey and evaluation.
- Property *does not* contribute to the historic district in which it is located.

Historic district name: West side residential historic district Historic district site inventory number: 92-00350

Name of related project report or multiple property study, if applicable:

MPD Title

Historical Architectural Data Base #

Architectural and Historical Survey of the "west side" residential neighborhood in Washington 92-013

• **Function or Use** *Enter categories (codes and terms) from the Iowa Site Inventory Form Instructions*

A) Historic functions

01A01: Domestic / residence

B) Current functions

01A01: Domestic / residence

• **Description** *Enter categories (codes and terms) from the Iowa Site Inventory Form Instructions*

A) Architectural Classification

10C: Rambler / ranch

B) Materials

Foundation (visible exterior): 10B: Poured concrete

walls (visible exterior): 15E: wood fiberboard siding

Roof: 08A: Asphalt shingles

Other: _____

C) Narrative Description SEE CONTINUATION SHEETS, WHICH MUST BE COMPLETED

● **Statement of Significance**

A) Applicable National Register Criteria: *Mark your opinion of eligibility after applying relevant National Register criteria*

- Criterion A: Property is associated with significant events. Yes No More research recommended
 Criterion B: Property is associated with the lives of significant persons. Yes No More Research Recommended
 Criterion C: Property has distinctive architectural characteristics. Yes No More Research Recommended
 Criterion D: Property yields significant information in archeology/history. Yes No More Research Recommended

B) Special criteria considerations: *Mark any special considerations; leave blank if none*

- A Owned by a religious institution or used for religious purposes. E A reconstructed building, object, or structure.
 B Removed from its original location. F A commemorative property.
 C A birthplace or grave. G Less than 50 years of age or
 D A cemetery achieved significance within the past 50 years.

C) Areas of Significance

Enter categories from instructions

Community planning and development

D) Period(s) of significance

E) Significant dates

Construction date

1959 *check if circa or estimated date*

Other dates, including renovations

F) Significant person

Complete if Criterion B is marked above

G) Cultural affiliation

Complete if Criterion D is marked above

H) Architect/Builder

Architect

Builder/contractor

I) Narrative statement of significance **SEE CONTINUATION SHEETS, WHICH MUST BE COMPLETED**

● **Bibliography** *See continuation sheet for the list of research sources used in preparing this form*

● **Geographic Data** *Optional UTM references* *See continuation sheet for additional UTM references or comments*

UTM References (OPTIONAL)

Zone	Easting	Northing	NAD	Zone	Easting	Northing	NAD
1	_____	_____	_____	2	_____	_____	_____
3	_____	_____	_____	4	_____	_____	_____

● **Form Preparation**

Name and Title: Mary Patterson - volunteer Rebecca Lawin McCarley, consultant Date: August 1, 2015

Organization/firm: Washington Historic Preservation Commission E-mail: -

Street address: City Hall, 215 E. Washington St Telephone: 319-653-6584

City or Town: Washington State: Iowa Zip code: 52353

● **ADDITIONAL DOCUMENTATION** *Submit the following items with the completed form*

A) For all properties, attach the following, as specified in the Iowa Site Inventory Form Instructions:

- 1. Map** of property's location within the community.
- 2. Glossy color 4x6 photos labeled** on back with property/building name, address, date taken, view shown, and unique photo number.
- 3. Photo key showing each photo number on a map and/or floor plan, using arrows next to each photo number to indicate the location and directional view of each photograph.**
- 4. Site plan** of buildings/structures on site, identifying boundaries, public roads, and building/structure footprints.

B) For State Historic Tax Credit Part 1 Applications, historic districts and farmsteads, and barns:

See lists of special requirements and attachments in the Iowa Site Inventory Form Instructions.

State Historic Preservation Office (SHPO) Use Only Below This Line

The SHPO has reviewed the Site Inventory and concurs with above survey opinion on National Register eligibility:

- Yes No More Research Recommended
 This is a locally designated property or part of a locally designated district.

Comments: _____

SHPO authorized signature: _____ Date: _____

Iowa Site Inventory Form
State Historic Preservation Office
Continuation Sheet

Site Number: 92-00740
Related District Number: 92-00350

Page 1

Walter and Margaret Kyle House
Name of Property

Washington
County

510 W. Jefferson Street
Address

Washington
City

Narrative Description

This is a one-story frame ranch house on the north side of W. Jefferson Street. It sits on a poured concrete foundation, and the walls are clad with wide wood siding. The windows are wood with aluminum storm / screens. There is an attached garage at the east end of the house, with access from W. Jefferson Street.

The façade, the south elevation, is divided into three sections. The house has two protruding wings, on on the east/right side of the house for the garage and on the left/west side of the house. The center section is then setback, with a concrete patio bordered with a wrought iron fence. On the left/west end of the patio is a concrete stoop leading to the entry. The wood door has a three-light window in the upper half of the door, and a tall narrow sidelight of glass block just to the left/west of the door. Roughly centered in this section is a wide wood picture window flanked by one-over-one-light double-hung wood windows. The left/west hip-roof section has pairs of one-over-one-light double-hung windows installed at the southeast and southwest corners of the wing, one on the south side and one around each corner. The right/east hip-roof section is the garage, with a one-car aluminum garage door.

The east elevation has a one-over-one-light double-hung window to the left/front/south. At roughly the center of this elevation, there is a side entry with a wood door and an aluminum storm / screen door. At the far right/north/rear at the northeast corner of the house, there is a set of tall single-light casement windows.

The west elevation has four windows. At the center of the elevation, there are two one-over-one-light double-hung windows, which are smaller than typical for this house and have higher than typical sills. At the far left corner and the far right corner of the house, there is atypical size one-over-one-light double-hung window.

The rear of the house, the north elevation, has a pair of one-over-one-light double-hung windows toward the center of the elevation, with another pair of one-over-one-light double-hung windows to the left of them. Beyond these window, there is a set of small single-light casement windows with a higher than typical sill. At the far left/east end of the wall at the northeast corner, there is set of a tall single-light casement windows, complementing the set around the corner on the east side..

Iowa Site Inventory Form
State Historic Preservation Office
Continuation Sheet

Site Number: 92-00740
Related District Number: 92-00350

Page 2

<u>Walter and Margaret Kyle House</u>	<u>Washington</u>
Name of Property	County
<u>510 W. Jefferson Street</u>	<u>Washington</u>
Address	City

Narrative Statement of Significance

The Walter and Margaret Kyle House appears to contribute historically and architecturally to the potential "west side" residential historic district in Washington. The ranch house was built during the period of development of the neighborhood in the 1950s and 1960s with construction of additional houses on previously undeveloped lots and portions of larger parcels, and it is significant within this period of later development of the neighborhood. The period of significance for the historic district is anticipated to extend through 1969, so it would fall within this period.

This house does not appear eligible for individual listing on the National Register of Historic Places under Criteria A, B, or C. The house does not appear to have particular historic or architectural significance individually.

History / research summary of property (chronological order, by owner/period):

This property was vacant from the 1909 to 1943 Sanborn maps. Carrie Dill bought Lot 8 in Out Lot 3 on February 26, 1935. From 1919 to 1958, she owned and lived in the house on the block to the north at 516 W. Washington. The Carrie Dill estate transferred the property to daughter Mae Smith on June 30, 1959, and she sold it to Margaret W. Kyle on July 24 of that same year. The assessor lists a construction date of 1959, which appears to be correct. The 1960 telephone directory lists Walter M. Kyle living at 510 W. Jefferson Street. He continues to appear in telephone directories at this address through 1963. The 1964 city directory lists the residents living here as Walter M. Kyle, retired and the home owner, his wife Margaret, and Florence Kyle, RN, working for Dr. M.L. McCreedy. This listing remains unchanged in the 1967 and 1969 city directories.

On October 1, 1970, Eunice L Kyle, single, and C. Naomi Finnes and husband transferred their interest in the property to Florence M. Kyle, single. The 1972 city directory lists Florence M. Kyle, RN, working for Dr. M.L. McCreedy. Kyle sold the property to Miriam and Mildred Davis on April 27, 1973. In the 1976 city directory, Mildred Davis, executive secretary at Stewart and Shearer Law Office is living at this address.

Iowa Site Inventory Form
State Historic Preservation Office
Continuation Sheet

Site Number: 92-00740
Related District Number: 92-00350

Page 3

Walter and Margaret Kyle House
Name of Property

Washington
County

510 W. Jefferson Street
Address

Washington
City

Bibliography

Atlas of Washington County, Iowa. Clinton, IA, and Philadelphia, PA: Harrison and Warner, 1874.

Atlas of Washington County, Iowa. No publisher noted, 1894. In collection of Washington Public Library.

City/telephone directories. Washington Public Library. Various years, including 1894, 1903, 1908, 1910-11, 1917, 1932, 1934, 1935, 1938, 1941, 1952, 1954, 1956, 1958, 1960, 1962, 1964, 1967, 1969, 1972, and 1976.

Fisher, Kathy. *In the beginning there was land : a history of Washington County, Iowa.* Washington, Iowa: Washington County Historical Society, 1978.

Newspapers, including anniversary/celebration editions on microfilm and/or bound at Washington Public Library:

Washington County Centennial Edition, *Evening Journal*, July 1936

Souvenir Edition of Washington Centennial, *The Evening Journal*, August 1939

Sixtieth Anniversary Edition, *The Washington Evening Journal*, February 27, 1953

Bicentennial edition, *The Washington Evening Journal*, July 1, 1976

Sesquicentennial edition, *The Washington Evening Journal*, April 13, 1989

Patterson, Mary. Collection of historic postcards, images, and city/telephone directories. Washington, Iowa. Accessed 2014-2015.

Sanborn Map Company. *Washington, Iowa.* Fire insurance maps. 1885, 1892, 1897, 1902, 1909, 1917, 1931, 1943.

Souvenir History of Washington, Iowa. Washington, IA: Washington Evening Journal, June 23, 1989.

Washington County Historical Society. Collection of historic postcards and photographs.

Iowa Site Inventory Form
State Historic Preservation Office
Continuation Sheet

Site Number: 92-00740
Related District Number: 92-00350

Page 4

Walter and Margaret Kyle House
Name of Property

Washington
County

510 W. Jefferson Street
Address

Washington
City

Location map



2009 aerial photograph (Washington County) – line indicates survey/research area boundary

Iowa Site Inventory Form
State Historic Preservation Office
Continuation Sheet

Site Number: 92-00740
Related District Number: 92-00350

Page 5

Walter and Margaret Kyle House
Name of Property

Washington
County

510 W. Jefferson Street
Address

Washington
City

Building plan (from assessor's website)

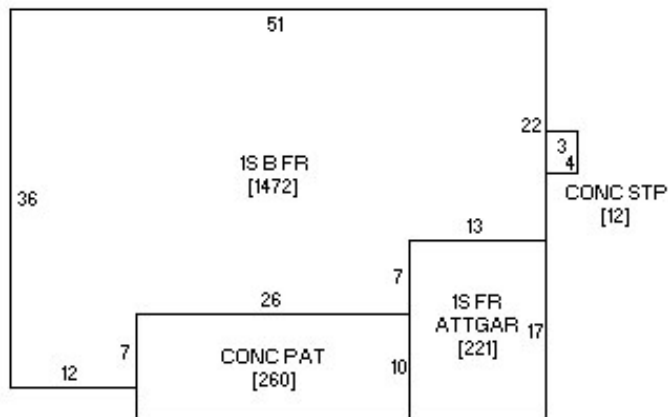

Photo from assessor's website



Iowa Site Inventory Form
State Historic Preservation Office
Continuation Sheet

Site Number: 92-00740
Related District Number: 92-00350

Page 6

Walter and Margaret Kyle House
Name of Property

Washington
County

510 W. Jefferson Street
Address

Washington
City

Digital photographs



Photograph 92-00740-001 - House, looking northeast (December 2014)

Iowa Site Inventory Form
State Historic Preservation Office
Continuation Sheet

Site Number: 92-00740
Related District Number: 92-00350

Page 7

Walter and Margaret Kyle House
Name of Property

Washington
County

510 W. Jefferson Street
Address

Washington
City



Photograph 92-00740-002 - House, looking northwest (December 2014)

Iowa Site Inventory Form
State Historic Preservation Office
Continuation Sheet

Site Number: 92-00740
Related District Number: 92-00350

Page 8

Walter and Margaret Kyle House
Name of Property

Washington
County

510 W. Jefferson Street
Address

Washington
City



Photograph 92-00740-003 - House, looking southwest (December 2014)