

Iowa Site Inventory Form

State Historic Preservation Office

(July 2014)

State Inventory Number: 92-00741 New Supplemental

9-Digit SHPO Review & Compliance (R&C) Number _____

Non-extant Year: _____

Read the Iowa Site Inventory Form Instructions carefully, to ensure accuracy and completeness before completing this form. The instructions are available on our website: <http://www.iowahistory.org/historic-preservation/statewide-inventory-and-collections/iowa-site-inventory-form.html>

● **Property Name**

A) Historic name Lafe and Ruth Stout House

B) Other names: West side survey map #WS-026

● **Location**

A) Street address: 516 W. Jefferson Street

B) City or town: Washington (Vicinity) County Washington

C) Legal Description:

Rural: Township Name: _____ Township No.: _____ Range No.: _____ Section: _____ Quarter: _____ of Quarter: _____

Urban: Subdivision: Subdivision of Outlot 3 Block(s): _____ Lot(s): S 122' of Lot 7

● **Classification**

A) **Property category:** *Check only one*

- Building(s)
- District
- Site
- Structure
- Object

B) **Number of Resources (within property)**

If eligible property, enter number of:		If non-eligible property, enter number of:	
Contributing	Noncontributing		
<u>1</u>	Buildings	—	Buildings
—	Sites	—	Sites
—	Structures	—	Structures
—	Objects	—	Objects
<u>1</u>	Total	—	Total

C) **For properties listed in the National Register:**

National Register status: Listed De-listed NHL NPS DOE

D) **For properties within a historic district:**

- Property contributes to a National Register or local certified historic district.
- Property contributes to a potential historic district, based on professional historic/architectural survey and evaluation.
- Property *does not* contribute to the historic district in which it is located.

Historic district name: West side residential historic district Historic district site inventory number: 92-00350

Name of related project report or multiple property study, if applicable:

MPD Title

Historical Architectural Data Base #

Architectural and Historical Survey of the "west side" residential neighborhood in Washington 92-013

● **Function or Use** *Enter categories (codes and terms) from the Iowa Site Inventory Form Instructions*

A) **Historic functions**

B) **Current functions**

01A01: Domestic / residence

01A01: Domestic / residence

● **Description** *Enter categories (codes and terms) from the Iowa Site Inventory Form Instructions*

A) **Architectural Classification**

B) **Materials**

10C: Rambler / ranch

Foundation (visible exterior): 10B: Poured concrete

walls (visible exterior): 15E: Wood fiberboard

Roof: 08A: Asphalt shingles

Other: _____

C) **Narrative Description** **SEE CONTINUATION SHEETS, WHICH MUST BE COMPLETED**

• **Statement of Significance**

A) Applicable National Register Criteria: *Mark your opinion of eligibility after applying relevant National Register criteria*

- Criterion A: Property is associated with significant events. Yes No More research recommended
Criterion B: Property is associated with the lives of significant persons. Yes No More Research Recommended
Criterion C: Property has distinctive architectural characteristics. Yes No More Research Recommended
Criterion D: Property yields significant information in archeology/history. Yes No More Research Recommended

B) Special criteria considerations: *Mark any special considerations; leave blank if none*

- A Owned by a religious institution or used for religious purposes. E A reconstructed building, object, or structure.
 B Removed from its original location. F A commemorative property.
 C A birthplace or grave. G Less than 50 years of age or
 D A cemetery achieved significance within the past 50 years.

C) Areas of Significance

Enter categories from instructions

Community planning and development

D) Period(s) of significance

E) Significant dates

Construction date

1951 *check if circa or estimated date*

Other dates, including renovations

F) Significant person

Complete if Criterion B is marked above

G) Cultural affiliation

Complete if Criterion D is marked above

H) Architect/Builder

Architect

Builder/contractor

Donald Foss

I) Narrative statement of significance **SEE CONTINUATION SHEETS, WHICH MUST BE COMPLETED**

• **Bibliography** *See continuation sheet for the list of research sources used in preparing this form*

• **Geographic Data** *Optional UTM references* *See continuation sheet for additional UTM references or comments*

UTM References (OPTIONAL)

Zone	Easting	Northing	NAD	Zone	Easting	Northing	NAD
1	_____	_____	_____	2	_____	_____	_____
3	_____	_____	_____	4	_____	_____	_____

• **Form Preparation**

Name and Title: Mary Patterson - volunteer Rebecca Lawin McCarley, consultant Date: August 1, 2015

Organization/firm: Washington Historic Preservation Commission E-mail: -

Street address: City Hall, 215 E. Washington St Telephone: 319-653-6584

City or Town: Washington State: Iowa Zip code: 52353

• **ADDITIONAL DOCUMENTATION** *Submit the following items with the completed form*

A) For all properties, attach the following, as specified in the Iowa Site Inventory Form Instructions:

- 1. Map** of property's location within the community.
- 2. Glossy color 4x6 photos labeled** on back with property/building name, address, date taken, view shown, and unique photo number.
- 3. Photo key showing each photo number on a map and/or floor plan, using arrows next to each photo number to indicate the location and directional view of each photograph.**
- 4. Site plan** of buildings/structures on site, identifying boundaries, public roads, and building/structure footprints.

B) For State Historic Tax Credit Part 1 Applications, historic districts and farmsteads, and barns:

See lists of special requirements and attachments in the Iowa Site Inventory Form Instructions.

State Historic Preservation Office (SHPO) Use Only Below This Line

The SHPO has reviewed the Site Inventory and concurs with above survey opinion on National Register eligibility:

- Yes No More Research Recommended
 This is a locally designated property or part of a locally designated district.

Comments: _____

SHPO authorized signature: _____ Date: _____

Iowa Site Inventory Form
State Historic Preservation Office
Continuation Sheet

Site Number: 92-00741
Related District Number: 92-00350

Page 1

<u>Lafe and Ruth Stout House</u>	<u>Washington</u>
Name of Property	County
<u>516 W. Jefferson Street</u>	<u>Washington</u>
Address	City

Narrative Description

This is a one-story frame ranch house on the north side of W. Jefferson Street. The house sits on a poured concrete foundation, and it is clad with wide wood siding. The hip roof is covered with asphalt shingles. The windows are wood with aluminum storm / screens. There is a one car attached garage at the east end of the house, and a wood deck is tucked in the southeast corner.

The façade, the south elevation, is divided into two sections. On the right/east, the attached one-car garage and front entry are recessed several feet from the remainder of the façade. A square wood column supports the roof at the southeast corner of the roof . The entry, to the left/west of the garage door, is reached by a set of concrete steps leading up to a concrete stoop. There is a decorative window in the upper half of the vinyl door, and an aluminum storm / screen door. The second/west/left section of the façade has an oriel window with angled sides. There is a casement window in each of the angled sides, with a larger fixed window at the center. To the far left, there is a pair of one-over-one-light double-hung windows at the west corner of the house.

The west elevation has three one-over-one-light double-hung windows. One is located at the far right/south side of the elevation, at the southwest corner of the house. The second window is at the middle of the elevation, and the third window is at the far left/north, at the rear corner of the house.

The east elevation, the garage, has a one-over-one-light double-hung window.

The rear of the house, the north elevation, has a wood deck in the corner formed by the east / west wing of the house and the north wing. There is a vinyl patio door located at the approximate center of the first/east/left section, the recessed portion of this elevation. To the right of the patio door, there is a set of three-light wood casement windows. Just beyond the casement windows, the north protruding wing extends away from the house. The east side of this wing has an entry with a wood screen door. At the north corner of this section, there is a hexagonal window placed high on the wall. The north side of this wing has two wood rectangular single-light awning windows evenly distributed across the wall.

Narrative Statement of Significance

The Lafe and Ruth Stout House appears to contribute historically and architecturally to the potential “west side” residential historic district in Washington. The ranch house was built during the period of development of the neighborhood in the 1950s and 1960s with construction of additional houses on previously undeveloped lots and portions of larger parcels, and it is significant within this period of later development of the neighborhood. The period of significance for the historic district is anticipated to extend through 1969, so it would fall within this period.

This house does not appear eligible for individual listing on the National Register of Historic Places under Criteria A, B, or C. The house does not appear to have particular historic or architectural significance individually.

Iowa Site Inventory Form
State Historic Preservation Office
Continuation Sheet

Site Number: 92-00741
Related District Number: 92-00350

Page 2

<u>Lafe and Ruth Stout House</u>	<u>Washington</u>
Name of Property	County
<u>516 W. Jefferson Street</u>	<u>Washington</u>
Address	City

History / research summary of property

Lot 7 was owned with Lot 3 to the north by the Bratten/Murdock family who lived at 523 W. Washington on Lot 3 through the first half of the 20th century. Sanborn maps show their house to the north on Lot 3 and show Lot 7 as a vacant lot through 1943. The south 122 feet of Out Lot 7 was first sold as a separate parcel on June 23, 1949 when Elsie S. Murdock and husband sold it to local contractor Donald Foss. Foss returned the north 16 ½ feet of the parcel to Murdock on May 12, 1952, and two weeks later, on May 27, 1952, he sold this property to Lafe Stout. The assessor lists a construction date of 1951 for this house, which appears to be accurate. The 1952 telephone directory lists Lyle Stout living at 516 W. Jefferson Street, which is corrected to Lafe Stout by 1954. He appears in subsequent telephone directories through 1962. On June 15, 1959, the property transferred from Lafe Stout and wife to Ruth S. Stout. The 1964 city directory lists Mrs. Ruth Stout, widow of Lafe, living here. She is listed again in the 1967, 1969, and 1972 city directories.

Ruth S. Stout sold the property to Minnie G. Witthoft on April 1, 1974, and Mrs. John Witthoft is listed as the occupant at 516 W. Jefferson Street in the 1976 city directory. Her estate later sold the property in 1979 to Richard Humston, who owned it until 1997.

Bibliography

City/telephone directories. Washington Public Library. Various years, including 1910-11, 1917, 1932, 1934, 1935, 1938, 1941, 1952, 1954, 1956, 1958, 1960, 1962, 1964, 1967, 1969, 1972, and 1976.

Fisher, Kathy. *In the beginning there was land : a history of Washington County, Iowa*. Washington, Iowa: Washington County Historical Society, 1978.

Newspapers, including anniversary/celebration editions on microfilm and/or bound at Washington Public Library:

- Washington County Centennial Edition, *Evening Journal*, July 1936
- Souvenir Edition of Washington Centennial, *The Evening Journal*, August 1939
- Sixtieth Anniversary Edition, *The Washington Evening Journal*, February 27, 1953
- Bicentennial edition, *The Washington Evening Journal*, July 1, 1976
- Sesquicentennial edition, *The Washington Evening Journal*, April 13, 1989

Patterson, Mary. Collection of historic postcards, images, and city/telephone directories. Washington, Iowa. Accessed 2014-2015.

Sanborn Map Company. *Washington, Iowa*. Fire insurance maps. 1885, 1892, 1897, 1902, 1909, 1917, 1931, 1943.

Souvenir History of Washington, Iowa. Washington, IA: Washington Evening Journal, June 23, 1989.

Iowa Site Inventory Form
State Historic Preservation Office
Continuation Sheet

Site Number: 92-00741
Related District Number: 92-00350

Page 3

Life and Ruth Stout House
Name of Property Washington
County

516 W. Jefferson Street
Address Washington
City

Location map



2009 aerial photograph (Washington County) – line indicates survey/research area boundary

Iowa Site Inventory Form
State Historic Preservation Office
Continuation Sheet

Site Number: 92-00741
Related District Number: 92-00350

Page 4

<u>Lafe and Ruth Stout House</u>	<u>Washington</u>
Name of Property	County
<u>516 W. Jefferson Street</u>	<u>Washington</u>
Address	City

Building plan (from assessor's website)

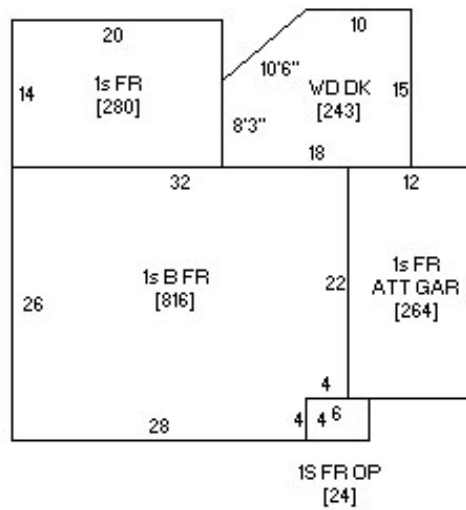

Photo from assessor's website



Iowa Site Inventory Form
State Historic Preservation Office
Continuation Sheet

Site Number: 92-00741
Related District Number: 92-00350

Page 5

Lafe and Ruth Stout House
Name of Property

Washington
County

516 W. Jefferson Street
Address

Washington
City

Digital photographs



Photograph 92-00741-001 - House, looking northeast (December 2014)

Iowa Site Inventory Form
State Historic Preservation Office
Continuation Sheet

Site Number: 92-00741
Related District Number: 92-00350

Page 6

Lafe and Ruth Stout House
Name of Property

Washington
County

516 W. Jefferson Street
Address

Washington
City



Photograph 92-00741-002 - House, looking southwest (December 2014)