

Iowa Site Inventory Form

State Historic Preservation Office

(July 2014)

State Inventory Number: 92-00745 New Supplemental

9-Digit SHPO Review & Compliance (R&C) Number _____

Non-extant Year: _____

Read the Iowa Site Inventory Form Instructions carefully, to ensure accuracy and completeness before completing this form. The instructions are available on our website: <http://www.iowahistory.org/historic-preservation/statewide-inventory-and-collections/iowa-site-inventory-form.html>

• Property Name

A) Historic name Henry and Freida Witthoft House

B) Other names: West side survey map #WS-030

• Location

A) Street address: 525 W. Jefferson Street

B) City or town: Washington (Vicinity) County Washington

C) Legal Description:

Rural: Township Name: _____ Township No.: _____ Range No.: _____ Section: _____ Quarter: _____ of Quarter: _____

Urban: Subdivision: Subdivision of Outlot 4 Block(s): _____ Lot(s): Lot 4 and W 3' of Lot 3

• Classification

A) Property category: *Check only one*

- Building(s)
- District
- Site
- Structure
- Object

B) Number of Resources (within property)

If eligible property, enter number of:		If non-eligible property, enter number of:	
Contributing	Noncontributing		
<u>1</u>	Buildings	—	Buildings
—	Sites	—	Sites
—	Structures	—	Structures
—	Objects	—	Objects
<u>1</u>	Total	—	Total

C) For properties listed in the National Register:

National Register status: Listed De-listed NHL NPS DOE

D) For properties within a historic district:

- Property contributes to a National Register or local certified historic district.
- Property contributes to a potential historic district, based on professional historic/architectural survey and evaluation.
- Property *does not* contribute to the historic district in which it is located.

Historic district name: West side residential historic district Historic district site inventory number: 92-00350

Name of related project report or multiple property study, if applicable:

MPD Title

Historical Architectural Data Base #

Architectural and Historical Survey of the "west side" residential neighborhood in Washington 92-013

• **Function or Use** *Enter categories (codes and terms) from the Iowa Site Inventory Form Instructions*

A) Historic functions

01A01: Domestic / residence

B) Current functions

01A01: Domestic / residence

• **Description** *Enter categories (codes and terms) from the Iowa Site Inventory Form Instructions*

A) Architectural Classification

10C: ranch

B) Materials

Foundation (visible exterior): 10A: Concrete block

walls (visible exterior): 15E: wood fiberboard

Roof: 08A: Asphalt shingles

Other: _____

C) Narrative Description *SEE CONTINUATION SHEETS, WHICH MUST BE COMPLETED*

• **Statement of Significance**

A) Applicable National Register Criteria: *Mark your opinion of eligibility after applying relevant National Register criteria*

- Criterion A: Property is associated with significant events. Yes No More research recommended
- Criterion B: Property is associated with the lives of significant persons. Yes No More Research Recommended
- Criterion C: Property has distinctive architectural characteristics. Yes No More Research Recommended
- Criterion D: Property yields significant information in archeology/history. Yes No More Research Recommended

B) Special criteria considerations: *Mark any special considerations; leave blank if none*

- A Owned by a religious institution or used for religious purposes. E A reconstructed building, object, or structure.
- B Removed from its original location. F A commemorative property.
- C A birthplace or grave. G Less than 50 years of age or achieved significance within the past 50 years.
- D A cemetery

C) Areas of Significance

Enter categories from instructions

Community planning and development

D) Period(s) of significance

E) Significant dates

Construction date

1958 *check if circa or estimated date*

Other dates, including renovations

F) Significant person

Complete if Criterion B is marked above

G) Cultural affiliation

Complete if Criterion D is marked above

H) Architect/Builder

Architect

Builder/contractor

Donald Foss

I) Narrative statement of significance **SEE CONTINUATION SHEETS, WHICH MUST BE COMPLETED**

• **Bibliography** *See continuation sheet for the list of research sources used in preparing this form*

• **Geographic Data** *Optional UTM references* *See continuation sheet for additional UTM references or comments*

UTM References (OPTIONAL)

Zone	Easting	Northing	NAD	Zone	Easting	Northing	NAD
1	_____	_____	_____	2	_____	_____	_____
3	_____	_____	_____	4	_____	_____	_____

• **Form Preparation**

Name and Title: Mary Patterson - volunteer Rebecca Lawin McCarley, consultant Date: August 1, 2015

Organization/firm: Washington Historic Preservation Commission E-mail: -

Street address: City Hall, 215 E. Washington St Telephone: 319-653-6584

City or Town: Washington State: Iowa Zip code: 52353

• **ADDITIONAL DOCUMENTATION** *Submit the following items with the completed form*

A) For all properties, attach the following, as specified in the Iowa Site Inventory Form Instructions:

1. **Map** of property's location within the community.
2. **Glossy color 4x6 photos labeled** on back with property/building name, address, date taken, view shown, and unique photo number.
3. **Photo key showing each photo number on a map and/or floor plan, using arrows next to each photo number to indicate the location and directional view of each photograph.**
4. **Site plan** of buildings/structures on site, identifying boundaries, public roads, and building/structure footprints.

B) For State Historic Tax Credit Part 1 Applications, historic districts and farmsteads, and barns:

See lists of special requirements and attachments in the Iowa Site Inventory Form Instructions.

State Historic Preservation Office (SHPO) Use Only Below This Line

The SHPO has reviewed the Site Inventory and concurs with above survey opinion on National Register eligibility:

- Yes No More Research Recommended
- This is a locally designated property or part of a locally designated district.*

Comments: _____

SHPO authorized signature: _____ Date: _____

Iowa Site Inventory Form
State Historic Preservation Office
Continuation Sheet

Site Number: 92-00745
Related District Number: 92-00350

Page 1

<u>Henry and Freida Witthoft House</u>	<u>Washington</u>
Name of Property	County
<u>525 W. Jefferson Street</u>	<u>Washington</u>
Address	City

Narrative Description

This is a one-story frame ranch house on the south side of W. Jefferson Street. It sits on a concrete block foundation, and it is clad with wide wood siding. The side gable roof is covered with asphalt shingles. The windows are two-over-two-light double-hung wood windows, with horizontal muntins, a typical style for the 1950s. The windows have aluminum storm / screens and shutters. There is an attached one-car garage at the east end of the house.

The façade, the north elevation, has two sections. On the left/east, the northeast corner is inset, with the attached garage and two entries doors. A square wood column supports the northeast corner of the roof. The garage door is wood and includes a row of fixed windows. To the right/east of the garage door, there is an entry into the garage. Immediately to its right/west, there is a the main entry, which has a concrete stoop with metal railings. This door is wood with three horizontal fixed windows in the upper half of the door. The remainder of the facade is then the typical depth. Roughly centered overall, there is a picture window flanked by narrow horizontal two-over-two-light double-hung windows. To the right/west, there is a two-over-two-light double-hung window.

The west elevation has two evenly spaced horizontal two-over-two-light double-hung windows.

The east elevation, the wall of the garage, has no fenestration.

The rear of the house, the south elevation, has a two-over-two-light double-hung window at the far left/west end of the wall. To the right, there is a smaller two-over-two-light double-hung window with a sill slightly higher than typical for this house. At the approximate center of this elevation, there is another smaller two-over-two-light double-hung window. Roughly centered on the east half, there is a ground level entry with a aluminum storm / screen entry door. There are three basement windows on this side of the house.

Narrative Statement of Significance

The Henry and Freida Witthoft House appears to contribute historically and architecturally to the potential “west side” residential historic district in Washington. The ranch house was built during the period of development of the neighborhood in the 1950s and 1960s with construction of additional houses on previously undeveloped lots and portions of larger parcels, and it is significant within this period of later development of the neighborhood. The period of significance for the historic district is anticipated to extend through 1969, so it would fall within this period.

This house does not appear eligible for individual listing on the National Register of Historic Places under Criteria A, B, or C. The house does not appear to have particular historic or architectural significance individually.

Iowa Site Inventory Form
State Historic Preservation Office
Continuation Sheet

Site Number: 92-00745
Related District Number: 92-00350

Page 2

Henry and Freida Witthoft House	Washington
Name of Property	County
525 W. Jefferson Street	Washington
Address	City

History / research summary of property

Lot 4 is depicted as a vacant lot on the 1894 atlas and Sanborn maps from 1909, 1917, 1931, and 1943. The property (lot 4 and west 3' of lot 3) was purchased through a referee deed by Donald S. Foss, a local housing contractor, on June 26, 1957. The assessor lists a construction date of 1958, which appears to be accurate. He sold it to Henry and Frieda Witthoft on December 31, 1958. The 1960 telephone directory lists Henry Witthoft at 525 W. Jefferson. The property transferred from Freida Witthoft to her husband Henry on October 14, 1960. Henry Witthoft is listed at 525 W. Jefferson Street in every telephone and city directory through 1976. The 1964 city directory notes that he is retired. His daughter, Mrs. Frances Miller, is also listed in the 1962 telephone directory, though not in other directories. Henry Witthoft died on June 24, 1977.

The heirs of Henry Witthoft sold the property to son Arthur J. and Martha E. Witthoft on March 20, 1978. Arthur died on February 11, 2013, and Martha continues to own the house.

Bibliography

City/telephone directories. Washington Public Library. Various years, including 1894, 1903, 1908, 1910-11, 1917, 1932, 1934, 1935, 1938, 1941, 1952, 1954, 1956, 1958, 1960, 1962, 1964, 1967, 1969, 1972, and 1976.

Fisher, Kathy. *In the beginning there was land : a history of Washington County, Iowa*. Washington, Iowa: Washington County Historical Society, 1978.

Newspapers, including anniversary/celebration editions on microfilm and/or bound at Washington Public Library:

- Sixtieth Anniversary Edition, *The Washington Evening Journal*, February 27, 1953
- Bicentennial edition, *The Washington Evening Journal*, July 1, 1976
- Sesquicentennial edition, *The Washington Evening Journal*, April 13, 1989

Patterson, Mary. Collection of historic postcards, images, and city/telephone directories. Washington, Iowa. Accessed 2014-2015.

Sanborn Map Company. *Washington, Iowa*. Fire insurance maps. 1885, 1892, 1897, 1902, 1909, 1917, 1931, 1943.

Souvenir History of Washington, Iowa. Washington, IA: Washington Evening Journal, June 23, 1989.

Iowa Site Inventory Form
State Historic Preservation Office
Continuation Sheet

Site Number: 92-00745
Related District Number: 92-00350

Page 3

Henry and Freida Withoft House
Name of Property

Washington
County

525 W. Jefferson Street
Address

Washington
City

Location map



2009 aerial photograph (Washington County) – line indicates survey/research area boundary

Iowa Site Inventory Form
State Historic Preservation Office
Continuation Sheet

Site Number: 92-00745
Related District Number: 92-00350

Page 4

Henry and Freida Withhoft House
Name of Property

Washington
County

525 W. Jefferson Street
Address

Washington
City

Building plan (from assessor's website)

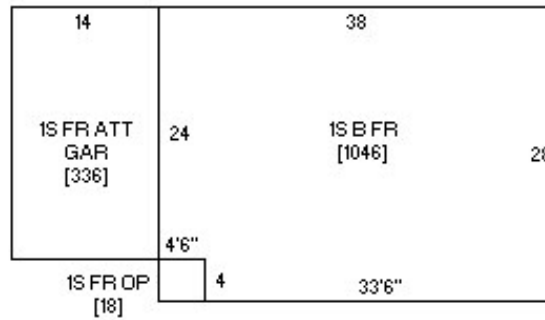

Photo from assessor's website



Iowa Site Inventory Form
State Historic Preservation Office
Continuation Sheet

Site Number: 92-00745
Related District Number: 92-00350

Page 5

Henry and Freida Witthoft House
Name of Property

Washington
County

525 W. Jefferson Street
Address

Washington
City

Digital photographs



Photograph 92-00745-001 - House, looking southeast (December 2014)

Iowa Site Inventory Form
State Historic Preservation Office
Continuation Sheet

Site Number: 92-00745
Related District Number: 92-00350

Page 6

Henry and Freida Withhoff House
Name of Property

Washington
County

525 W. Jefferson Street
Address

Washington
City



Photograph 92-00740-002 - House, looking southwest (December 2014)