

# Iowa Site Inventory Form

State Historic Preservation Office

(July 2014)

State Inventory Number: 92-00748  New  Supplemental

9-Digit SHPO Review & Compliance (R&C) Number \_\_\_\_\_

Non-extant Year: \_\_\_\_\_

*Read the Iowa Site Inventory Form Instructions carefully, to ensure accuracy and completeness before completing this form. The instructions are available on our website: <http://www.iowahistory.org/historic-preservation/statewide-inventory-and-collections/iowa-site-inventory-form.html>*

● **Property Name**

A) Historic name Charles King House

B) Other names: West side survey map #WS-034

● **Location**

A) Street address: 614 W Jefferson Street

B) City or town: Washington ( Vicinity) County Washington

C) Legal Description:

Rural: Township Name: \_\_\_\_\_ Township No.: \_\_\_\_\_ Range No.: \_\_\_\_\_ Section: \_\_\_\_\_ Quarter: \_\_\_\_\_ of Quarter: \_\_\_\_\_

Urban: Subdivision: Southwest Washington Block(s): 1 Lot(s): 11

● **Classification**

**A) Property category:** *Check only one*

- Building(s)
- District
- Site
- Structure
- Object

**B) Number of Resources (within property)**

If eligible property, enter number of:		If non-eligible property, enter number of:	
Contributing	Noncontributing		
—	Buildings <u>1</u>	—	Buildings
—	Sites <u>—</u>	—	Sites
—	Structures <u>—</u>	—	Structures
—	Objects <u>—</u>	—	Objects
—	<b>Total</b> <u>1</u>	—	<b>Total</b>

**C) For properties listed in the National Register:**

National Register status:  Listed  De-listed  NHL  NPS DOE

**D) For properties within a historic district:**

- Property contributes to a National Register or local certified historic district.
- Property contributes to a potential historic district, based on professional historic/architectural survey and evaluation.
- Property *does not* contribute to the historic district in which it is located.

Historic district name: West side residential historic district Historic district site inventory number: 92-00350

**Name of related project report or multiple property study, if applicable:**

MPD Title

Historical Architectural Data Base #

Architectural and Historical Survey of the "west side" residential neighborhood in Washington 92-013

● **Function or Use** *Enter categories (codes and terms) from the Iowa Site Inventory Form Instructions*

**A) Historic functions**

**B) Current functions**

01A01: Domestic / residence

01A01: Domestic / residence

01C05: Domestic / garage

● **Description** *Enter categories (codes and terms) from the Iowa Site Inventory Form Instructions*

**A) Architectural Classification**

**B) Materials**

09A01: Front-gabled Roof

Foundation (visible exterior): 10A: Concrete block

walls (visible exterior): 05E: Aluminum

Roof: 08A: Asphalt shingles

Other: \_\_\_\_\_

**C) Narrative Description**  **SEE CONTINUATION SHEETS, WHICH MUST BE COMPLETED**

● **Statement of Significance**

**A) Applicable National Register Criteria:** *Mark your opinion of eligibility after applying relevant National Register criteria*

- Criterion A: Property is associated with significant events.  Yes  No  More research recommended  
 Criterion B: Property is associated with the lives of significant persons.  Yes  No  More Research Recommended  
 Criterion C: Property has distinctive architectural characteristics.  Yes  No  More Research Recommended  
 Criterion D: Property yields significant information in archeology/history.  Yes  No  More Research Recommended

**B) Special criteria considerations:** *Mark any special considerations; leave blank if none*

- A Owned by a religious institution or used for religious purposes.  E A reconstructed building, object, or structure.  
 B Removed from its original location.  F A commemorative property.  
 C A birthplace or grave.  G Less than 50 years of age or  
 D A cemetery achieved significance within the past 50 years.

**C) Areas of Significance**

*Enter categories from instructions*

Community planning and development

**D) Period(s) of significance**

**E) Significant dates**

*Construction date*

1910  *check if circa or estimated date*

*Other dates, including renovations*

**F) Significant person**

*Complete if Criterion B is marked above*

**G) Cultural affiliation**

*Complete if Criterion D is marked above*

**H) Architect/Builder**

*Architect*

*Builder/contractor*

**I) Narrative statement of significance**  *SEE CONTINUATION SHEETS, WHICH MUST BE COMPLETED*

● **Bibliography**  *See continuation sheet for the list of research sources used in preparing this form*

● **Geographic Data** *Optional UTM references*  *See continuation sheet for additional UTM references or comments*

**UTM References (OPTIONAL)**

Zone	Easting	Northing	NAD	Zone	Easting	Northing	NAD
1	_____	_____	_____	2	_____	_____	_____
3	_____	_____	_____	4	_____	_____	_____

● **Form Preparation**

Name and Title: Mary Patterson - volunteer Rebecca Lawin McCarley, consultant Date: December 30, 2015

Organization/firm: Washington Historic Preservation Commission E-mail: -

Street address: City Hall, 215 E. Washington St Telephone: 319-653-6584

City or Town: Washington State: Iowa Zip code: 52353

● **ADDITIONAL DOCUMENTATION** *Submit the following items with the completed form*

**A) For all properties, attach the following, as specified in the Iowa Site Inventory Form Instructions:**

- 1. Map** of property's location within the community.
- 2. Glossy color 4x6 photos labeled** on back with property/building name, address, date taken, view shown, and unique photo number.
- 3. Photo key showing each photo number on a map and/or floor plan, using arrows next to each photo number to indicate the location and directional view of each photograph.**
- 4. Site plan** of buildings/structures on site, identifying boundaries, public roads, and building/structure footprints.

**B) For State Historic Tax Credit Part 1 Applications, historic districts and farmsteads, and barns:**

*See lists of special requirements and attachments in the Iowa Site Inventory Form Instructions.*

**State Historic Preservation Office (SHPO) Use Only Below This Line**

*The SHPO has reviewed the Site Inventory and concurs with above survey opinion on National Register eligibility:*

- Yes  No  More Research Recommended  
 *This is a locally designated property or part of a locally designated district.*

Comments: \_\_\_\_\_

SHPO authorized signature: \_\_\_\_\_ Date: \_\_\_\_\_

**Iowa Site Inventory Form**  
**State Historic Preservation Office**  
**Continuation Sheet**

Site Number: 92-00748  
Related District Number: 92-00350

Page 1

---

<u>Charles King House</u>	<u>Washington</u>
Name of Property	County
<u>614 W. Jefferson Street</u>	<u>Washington</u>
Address	City

---

**Narrative Description**

This is a one-story frame gable-front house on the north side of W. Jefferson Street. The house sits on a rusticated concrete block foundation, and it is clad with aluminum siding. The gable-front roof is covered with asphalt shingles. Some windows are vinyl replacements and some are replacement wood windows, and both have aluminum storm / screen windows. There is a large rear addition which extends to the west and includes a garage and car port.

The façade, the south elevation, has a one story gable-roof addition built around 1970, which obscures the original façade. According to the current owner, who lived here as a child at the time that the addition was built, the original front porch was removed (see historic photo at end) and the addition was built to enlarge the living room. The addition sits on a poured concrete foundation, is clad with aluminum siding, and has a gable-front roof covered with asphalt shingles. The addition is somewhat wider than the original house, and the slope of the roof is less steep than the original house's roof. The entry on the left/west has a wood door with a window in the upper part of the door, and it is located at ground level. It has a wood cross buck railing on the south and east sides of the entry area, with a shed roof supported with wood braces above it. To the right/east, there is a pair of one-over-one-light double-hung wood windows. Farther to the right/east, there is another one-over-one-light double-hung wood window. The east elevation of the addition has a one-over-one-light double-hung wood window at the left/south end of the addition, near the corner. The west elevation of the addition has a one-over-one-light double-hung wood window also located on the south half.

The east elevation of the house has two sections, the side of the front addition and the side of the original house. In addition to the window at the corner, there are two additional one-over-one-light double-hung wood window on the side of the front addition. On the original house, there are two one-over-one-light double-hung wood windows. Under each of these windows is a two-light fixed metal basement window.

The west elevation of the house has three sections. The right/south section is the side of the front addition, and it has a one-over-one-light double-hung wood window, as noted. The middle section is the side of the original house, and it has two one-over-one-light double-hung vinyl windows. The third/north/rear section is an enlargement of the earlier rear porch. It has a small one-over-one-light double-hung vinyl window to the right, and beside it, to the left, is an entry with a wood door with a small window in the top and an aluminum storm / screen door. This entry leads out to the east end of south porch on the west addition.

The north elevation, the rear of the house, has several additions which cover the original house. The largest addition extends west from the rear of the house, and it sits on a rusticated concrete block foundation. It has a side gable roof covered with asphalt shingles, and it is clad with aluminum siding. There is an enclosed porch constructed around 1974 at the east end of the addition which has a shed roof with metal roofing and one-over-one-light double-hung aluminum storm / screen windows on three sides. There is one wide aluminum window on the south elevation of the porch where it protrudes beyond the main house, and there are six more aluminum windows on the east elevation. The north elevation of the porch has an aluminum storm / screen door at the left, and two aluminum windows to

**Iowa Site Inventory Form**  
**State Historic Preservation Office**  
**Continuation Sheet**

Site Number: 92-00748  
Related District Number: 92-00350

Page 2

---

<u>Charles King House</u>	<u>Washington</u>
Name of Property	County
<u>614 W. Jefferson Street</u>	<u>Washington</u>
Address	City

---

the right. The north elevation of the main addition has four sections. At the left, a one-over-one-light double-hung vinyl window is centered in the first section. The second section is a cross gable section extending to the north (bedroom), and it sits on a concrete block foundation and has a north facing gable. This projected section has a one-over-one-light double-hung vinyl window centered on each side of its three walls. The third section of the main addition has a one-over-one-light double-hung vinyl window. To the right of this window, the fourth section is an attached one-car garage with a gable-front roof. A one-over-one-light double-hung vinyl window is located in the west elevation of the garage. Attached to the north side of the older garage, there is another frame addition built in the early 1970s also with a north facing gable roof. This addition sits on a poured concrete foundation, and it is clad with T-111 wood siding. The east elevation of this addition has a pair of fixed light wood windows, and the west elevation has two additional fixed light wood windows.

The south/front elevation of the main addition to the west of the original house has an open porch with a shed roof, which runs from the rear of the original house along the west addition almost to the east side of the older garage. This porch was added around 1979. There a set of wood steps leading down to an entry into the garage, which has a wood door with three vertical lights at the top of the door. In front of the garage, obscuring the location of an earlier garage door, there is a frame gable-front carport also built around 1979. It has T-111 siding on the west wall, and a wood picket fence along the open east side. The car port is open on the south elevation, and has access from W. Main Street.

**Narrative Statement of Significance**

The Charles King House is likely non-contributing in the potential “west side” residential historic district in Washington. The original house was a small gable-front bungalow, which was expanded significantly in the 1960s and again in the 1970s. The house also has replacement windows and aluminum siding. The house does not appear to retain sufficient integrity to contribute to the historic district.

The house is likewise not individually eligible for listing on the National Register of Historic Places under Criteria A, B, or C.

*History / research summary of property (chronological order, by owner/period):*

The 1909 Sanborn map shows Lot 11 as a vacant lot. The property was historically owned by the Hollingsworth family, as the southern portion of their property to the north at 611 W. Washington Blvd. Clarence Hollingsworth sold transferred the larger property to A.N. Alberson on March 28, 1910. He then sold only Lot 11 to Charles S. King on August 30, 1910. King appears in the 1910-11 city directory living on E. Main Street. The 1917 Sanborn map shows a simple rectangular house footprint, and the 1917 county directory lists Charley King, drayman, living on W. Jefferson Street. In the 1920 census, he is listed at 624 W. Jefferson Street (earlier numbering for this house). He is 53 years old, owns his home free and clear, is single, and working in auto delivery. This entry is between Martha J. Crawford at 626 W. Jefferson, and Fred L. Stewart at 320 W. Jefferson. The 1917 Sanborn map shows no other houses in the north side of the 500 and 600 blocks of W. Jefferson until it reaches South Avenue D.

**Iowa Site Inventory Form**  
**State Historic Preservation Office**  
**Continuation Sheet**

Site Number: 92-00748  
Related District Number: 92-00350

Page 3

---

<u>Charles King House</u>	<u>Washington</u>
Name of Property	County
<u>614 W. Jefferson Street</u>	<u>Washington</u>
Address	City

---

On June 22, 1920, King sold the property to Ira Rathmel. The 1926 telephone directory lists Ira Rathmel living 6 ½ miles NW of Washington on Rt. 5, and he continues to be listed as a rural telephone number in the 1932 telephone directory. The 1935 city directory lists Rathmel living at 617 W. Washington, a property which is directly north of Lot 11, and 612 W. Jefferson is listed as Vacant. In 1941, the city directory lists the residents at 614 W. Jefferson as Martin Syfert, a laborer at Brewer's Dairy, and his wife Lois. The 1943 Sanborn map shows the same rectangular house footprint, with an open front porch. Ira and Cora Rathmel sold the house to the north at 611 W. Washington in 1948, and it appears that they then moved into this house. The house was then expanded with a rear/west addition during the time that Rathmels lived here. The 1954 city directory lists Mrs. Ira Rathmel living at this address, and she continues to be listed here in telephone and city directories through 1964. The 1964 city directory includes the information she is the widow of Ira.

The Ira D. Rathmel estate transferred ownership of the property to Olga M. Rathmel on December 7, 1970. About six month later, she sold the property to Ray G. and Stella Hough. The 1967 city directory identifies the Hough family as Ray, partner with Humston and Hough, his wife Stella, an employee at McCleery Cumming Co., and their children Sharon, a student at Muscatine Community College, and Douglas, born in 1954. A front addition was constructed in the 1970s to enlarge the living room. The family continues to be listed here through the 1976 city directory. Ray's estate transferred the property to the kids in 2006, and then Douglas transferred his interest to Sharon. Sharon Hough is the current owner of the property.

**Iowa Site Inventory Form**  
**State Historic Preservation Office**  
**Continuation Sheet**

Site Number: 92-00748  
Related District Number: 92-00350

Page 4

---

<u>Charles King House</u>	<u>Washington</u>
Name of Property	County
<u>614 W. Jefferson Street</u>	<u>Washington</u>
Address	City

---

**Bibliography**

*Atlas of Washington County, Iowa.* Clinton, IA, and Philadelphia, PA: Harrison and Warner, 1874.

*Atlas of Washington County, Iowa.* No publisher noted, 1894. In collection of Washington Public Library.

Burrell, Howard A. *History of Washington County, Iowa.* Chicago, IL: S.J. Clarke Publishing Company, 1909. 2 volumes.

City/telephone directories. Washington Public Library. Various years, including 1894, 1903, 1908, 1910-11, 1917, 1932, 1934, 1935, 1938, 1941, 1952, 1954, 1956, 1958, 1960, 1962, 1964, 1967, 1969, 1972, and 1976.

Fisher, Kathy. *In the beginning there was land : a history of Washington County, Iowa.* Washington, Iowa: Washington County Historical Society, 1978.

*History of Washington County, Iowa.* Des Moines, IA: Union Historical Co., 1880.

Hough, Sharon, current owner and daughter of Ray G. and Stella Hough who bought the house in 1970 (and made several improvements - dates noted per her notes/recollections)

Koch, Augustus. *Birds-eye View of the City of Washington.* Chicago: Chicago Lithograph Company, 1869.

Newspapers, including anniversary/celebration editions on microfilm and/or bound at Washington Public Library:

*Washington Gazette*, January 6, 1893

Twentieth Anniversary Edition, *Evening Journal*, April 26, 1913

Twenty-Fifth Anniversary Edition, *Evening Journal*, April 3, 1926

Washington County Centennial Edition, *Evening Journal*, July 1936

Souvenir Edition of Washington Centennial, *The Evening Journal*, August 1939

Sixtieth Anniversary Edition, *The Washington Evening Journal*, February 27, 1953

Bicentennial edition, *The Washington Evening Journal*, July 1, 1976

Sesquicentennial edition, *The Washington Evening Journal*, April 13, 1989

Patterson, Mary. Collection of historic postcards, images, and city/telephone directories. Washington, Iowa. Accessed 2014-2015.

*Portrait and Biographical Album of Washington County, Iowa.* Chicago, Acme Publishing Company, 1887.

Sanborn Map Company. *Washington, Iowa.* Fire insurance maps. 1885, 1892, 1897, 1902, 1909, 1917, 1931, 1943.

**Iowa Site Inventory Form**  
State Historic Preservation Office  
**Continuation Sheet**

Site Number: 92-00748  
Related District Number: 92-00350

Page 5

Charles King House Washington  
Name of Property County

614 W. Jefferson Street Washington  
Address City

*Souvenir History of Washington, Iowa.* Washington, IA: Washington Evening Journal, June 23, 1989.

Washington County Historical Society. Collection of historic postcards and photographs.

**Location map**



2009 aerial photograph (Washington County) – line indicates survey/research area boundary

**Iowa Site Inventory Form**  
**State Historic Preservation Office**  
**Continuation Sheet**

Site Number: 92-00748  
 Related District Number: 92-00350

Page 6

Charles King House	Washington
Name of Property	County
614 W. Jefferson Street	Washington
Address	City

**Building plan (from assessor's website)**

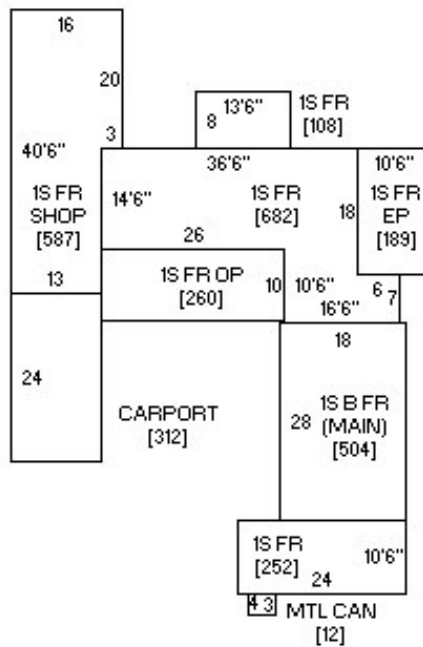

**Photo from assessor's website**





**Iowa Site Inventory Form**  
State Historic Preservation Office  
**Continuation Sheet**

Site Number: 92-00748  
Related District Number: 92-00350

Page 7

Charles King House  
Name of Property

Washington  
County

614 W. Jefferson Street  
Address

Washington  
City

**Historic images**



Historic image of house from current owner (Sharon Hough)

**Iowa Site Inventory Form**  
State Historic Preservation Office  
**Continuation Sheet**

Site Number: 92-00748  
Related District Number: 92-00350

Page 8

Charles King House  
Name of Property

Washington  
County

614 W. Jefferson Street  
Address

Washington  
City



**Historic image of house from current owner (Sharon Hough)**

**Iowa Site Inventory Form**  
State Historic Preservation Office  
**Continuation Sheet**

Site Number: 92-00748  
Related District Number: 92-00350

Page 9

Charles King House  
Name of Property

Washington  
County

614 W. Jefferson Street  
Address

Washington  
City

**Digital photographs**



**Photograph 92-00748-001 - House, looking northwest (December 2014)**

**Iowa Site Inventory Form**  
State Historic Preservation Office  
**Continuation Sheet**

Site Number: 92-00748  
Related District Number: 92-00350

Page 10

Charles King House  
Name of Property

Washington  
County

614 W. Jefferson Street  
Address

Washington  
City



**Photograph 92-00748-002 - House, looking northeast (December 2014)**

**Iowa Site Inventory Form**  
State Historic Preservation Office  
**Continuation Sheet**

Site Number: 92-00748  
Related District Number: 92-00350

Page 11

Charles King House  
Name of Property

Washington  
County

614 W. Jefferson Street  
Address

Washington  
City



**Photograph 92-00748-003 - House, looking northeast (December 2014)**

**Iowa Site Inventory Form**  
State Historic Preservation Office  
**Continuation Sheet**

Site Number: 92-00748  
Related District Number: 92-00350

Page 12

Charles King House  
Name of Property

Washington  
County

614 W. Jefferson Street  
Address

Washington  
City



**Photograph 92-00748-004 - House, looking southwest (December 2014)**

**Iowa Site Inventory Form**  
State Historic Preservation Office  
**Continuation Sheet**

Site Number: 92-00748  
Related District Number: 92-00350

Page 13

---

Charles King House  
Name of Property

Washington  
County

614 W. Jefferson Street  
Address

Washington  
City

---



**Photograph 92-00748-005 - House, looking southeast (December 2014)**