

Iowa Site Inventory Form

State Historic Preservation Office

(July 2014)

State Inventory Number: 92-00752 New Supplemental

9-Digit SHPO Review & Compliance (R&C) Number _____

Non-extant Year: _____

Read the Iowa Site Inventory Form Instructions carefully, to ensure accuracy and completeness before completing this form. The instructions are available on our website: <http://www.iowahistory.org/historic-preservation/statewide-inventory-and-collections/iowa-site-inventory-form.html>

● **Property Name**

A) Historic name Minnie C. White House

B) Other names: West side survey map #WS-038

● **Location**

A) Street address: 609 W Jefferson Street

B) City or town: Washington (Vicinity) County Washington

C) Legal Description:

Rural: Township Name: _____ Township No.: _____ Range No.: _____ Section: _____ Quarter: _____ of Quarter: _____

Urban: Subdivision: Southwest Washington Block(s): 3 Lot(s): 2

● **Classification**

A) Property category: *Check only one*

- Building(s)
- District
- Site
- Structure
- Object

B) Number of Resources (within property)

If eligible property, enter number of:		If non-eligible property, enter number of:	
Contributing	Noncontributing		
<u>1</u>	Buildings	—	Buildings
	Sites	—	Sites
—	Structures	—	Structures
	Objects	—	Objects
<u>1</u>	Total	—	Total

C) For properties listed in the National Register:

National Register status: Listed De-listed NHL NPS DOE

D) For properties within a historic district:

- Property contributes to a National Register or local certified historic district.
- Property contributes to a potential historic district, based on professional historic/architectural survey and evaluation.
- Property *does not* contribute to the historic district in which it is located.

Historic district name: West side residential historic district Historic district site inventory number: 92-00350

Name of related project report or multiple property study, if applicable:

MPD Title

Historical Architectural Data Base #

Architectural and Historical Survey of the "west side" residential neighborhood in Washington 92-013

● **Function or Use** *Enter categories (codes and terms) from the Iowa Site Inventory Form Instructions*

A) Historic functions

B) Current functions

01A01: Domestic / residence

01A01: Domestic / residence

01C05: Domestic / garage

● **Description** *Enter categories (codes and terms) from the Iowa Site Inventory Form Instructions*

A) Architectural Classification

B) Materials

09A09: Cross gable house

Foundation (visible exterior): 10B: Concrete

walls (visible exterior): 15B: vinyl

Roof: 08A: Asphalt shingles

Other: _____

C) Narrative Description **SEE CONTINUATION SHEETS, WHICH MUST BE COMPLETED**

● **Statement of Significance**

A) Applicable National Register Criteria: *Mark your opinion of eligibility after applying relevant National Register criteria*

- Criterion A: Property is associated with significant events. Yes No More research recommended
Criterion B: Property is associated with the lives of significant persons. Yes No More Research Recommended
Criterion C: Property has distinctive architectural characteristics. Yes No More Research Recommended
Criterion D: Property yields significant information in archeology/history. Yes No More Research Recommended

B) Special criteria considerations: *Mark any special considerations; leave blank if none*

- A Owned by a religious institution or used for religious purposes. E A reconstructed building, object, or structure.
 B Removed from its original location. F A commemorative property.
 C A birthplace or grave. G Less than 50 years of age or
 D A cemetery achieved significance within the past 50 years.

C) Areas of Significance

Enter categories from instructions

Community planning and development

D) Period(s) of significance

E) Significant dates

Construction date

1921 *check if circa or estimated date*

Other dates, including renovations

F) Significant person

Complete if Criterion B is marked above

G) Cultural affiliation

Complete if Criterion D is marked above

H) Architect/Builder

Architect

Builder/contractor

I) Narrative statement of significance **SEE CONTINUATION SHEETS, WHICH MUST BE COMPLETED**

● **Bibliography** *See continuation sheet for the list of research sources used in preparing this form*

● **Geographic Data** *Optional UTM references* *See continuation sheet for additional UTM references or comments*

UTM References (OPTIONAL)

Zone	Easting	Northing	NAD	Zone	Easting	Northing	NAD
1				2			
3				4			

● **Form Preparation**

Name and Title: Mary Patterson - volunteer Rebecca Lawin McCarley, consultant Date: May 8, 2015

Organization/firm: Washington Historic Preservation Commission E-mail: -

Street address: City Hall, 215 E. Washington St Telephone: 319-653-6584

City or Town: Washington State: Iowa Zip code: 52353

● **ADDITIONAL DOCUMENTATION** *Submit the following items with the completed form*

A) For all properties, attach the following, as specified in the Iowa Site Inventory Form Instructions:

- 1. Map** of property's location within the community.
- 2. Glossy color 4x6 photos labeled** on back with property/building name, address, date taken, view shown, and unique photo number.
- 3. Photo key showing each photo number on a map and/or floor plan, using arrows next to each photo number to indicate the location and directional view of each photograph.**
- 4. Site plan** of buildings/structures on site, identifying boundaries, public roads, and building/structure footprints.

B) For State Historic Tax Credit Part 1 Applications, historic districts and farmsteads, and barns:

See lists of special requirements and attachments in the Iowa Site Inventory Form Instructions.

State Historic Preservation Office (SHPO) Use Only Below This Line

The SHPO has reviewed the Site Inventory and concurs with above survey opinion on National Register eligibility:

- Yes No More Research Recommended
 This is a locally designated property or part of a locally designated district.

Comments: _____

SHPO authorized signature: _____ Date: _____

Iowa Site Inventory Form
State Historic Preservation Office
Continuation Sheet

Site Number: 92-00752
Related District Number: 92-00350

Page 1

<u>Minnie C. White House</u>	<u>Washington</u>
Name of Property	County
<u>609 W. Jefferson Street</u>	<u>Washington</u>
Address	City

Narrative Description

This is a two-story frame T-plan house on the south side of W. Jefferson Street. The foundation, where visible, appears to be poured concrete, and the cross gable roof is covered with asphalt singles. The house is clad with vinyl siding, and it has vinyl windows with vinyl shutters. There is an addition extending to the west, and another addition to the south/rear from the original two-story section of the house. A covered deck is attached to the rear of the house, and the front porch has been enclosed or replaced with a one-story addition in the front corner of the house. At the south end of the lot, along the alley, there is a small frame schoolhouse next to a small frame playhouse, and to the northeast of the playhouse, there is a small wood garden shed.

The façade, the north elevation, consists primarily of the original two-story cross gable house and the one-story side additions to the west. The northeast corner of the house, where a porch was historically located, has an enclosed one-story section that the assessor notes dates to 1996. At the right/west edge of this section, there is an entry with a steel door with a decorative window. To the left, more or less centered on the wall, there is a vinyl octagon window. Outside the entry, there is a small concrete stoop and a concrete walk to the public sidewalk. The right section, the gable-front wing of the house, has a pair of one-over-one-light double-hung vinyl windows with vinyl shutters, centered on the first story wall. On the second story, centered below the peak of the gable, there is a one-over-one-light double-hung vinyl window with vinyl shutters. A one-story addition extends west from the house, which has two section but both date to 1997 per the assessor's information. The addition has a combination shed and hip roof covered with asphalt shingles, a poured concrete foundation, and is clad with vinyl siding. The north elevation, continuing the façade to the west of the original house, has an entry with a steel door on the left/east, near the main house, with an aluminum storm / screen door. To the right, there is a vinyl octagon window. Just to the right of the octagon window, there is a pair of one-over-one-light double-hung vinyl windows with vinyl shutters.

The east elevation is divided into two sections. The gable-roof east wing of the house has a one-over-one-light double-hung vinyl window with vinyl shutters centered on the first story wall, and no windows on the second story. The one-story three-seasons room extends to the south, with six one-over-one-light double-hung vinyl windows along its east side.

The west elevation's first story is obscured by a one-story addition extending west from the house. The west elevation of the addition has no fenestration. The second story of the original house has two one-over-one-light double-hung vinyl window with vinyl shutters.

The south elevation, the rear of the house, has three sections. The left/west section is the south side of the two-part west addition. On the left/west, there is a one-over-one-light double-hung vinyl window with vinyl shutters. This window has a sill somewhat higher than typical for this house. On the right/east, under the shed-roof portion, there is a pair of one-over-one-light double-hung vinyl windows with vinyl shutters. The center section is within the rear deck/porch, and it is the short gable-roof south wing of the original house. It has two one-over-one-light double-hung vinyl window with vinyl shutters on the first story. On the second story, centered under the rear facing gable, there is a one-over-one-light double-hung vinyl window with vinyl shutters. To the right, the first story of the remainder of the

Iowa Site Inventory Form
State Historic Preservation Office
Continuation Sheet

Site Number: 92-00752
Related District Number: 92-00350

Page 2

<u>Minnie C. White House</u>	<u>Washington</u>
Name of Property	County
<u>609 W. Jefferson Street</u>	<u>Washington</u>
Address	City

original house, the third section, is covered by the south addition (described below). On the second story, this section has a one-over-one-light double-hung vinyl window with vinyl shutters. A covered wood deck is located in the corner between the rear of the main house and the west elevation of the south wing. The deck has wood lattice applied to part of the west wall of this area, below the deck railing, and around the upper edge of the roof. The roof is supported by square wood posts and wood braces, and covered with corrugated fiberglass roofing panels. There are two sets of wood steps, one to the west and the other at the southeast corner of the deck, both leading into the yard.

The south addition is attached to the south elevation at the east end of the house, and it covers the entire first story of the south side of the east wing of the house. It sits on a poured concrete foundation, and it is clad with vinyl siding. The west elevation, on the deck side of the addition, has an entry with a door with a window and an aluminum storm / screen door. To the left of the entry, there is a one-over-one-light double-hung vinyl window. To the right of the entry, there are two one-over-one-light double-hung vinyl windows. There are no shutters in this area. The south elevation of the addition has a set of three one-over-one-light double-hung vinyl windows with vinyl shutters at each end of the group of windows. The east elevation has a continuous line of six one-over-one-light double-hung vinyl windows, and there are no shutters on these windows.

The frame one car detached garage sits on a poured concrete foundation and is clad with vinyl siding. The assessor lists a construction date of 1965. The gable-front roof is covered with asphalt shingles. A single-car aluminum garage door faces west, with access from the alley to the south. On the north elevation, there two four-light wood windows with window boxes below them. A wood cupola encloses a metal school bell and sits on the ridge of the roof at the center of the building. The garage is counted as the second contributing building on the property.

Two other small buildings on the property are not tabulated. The playhouse faces north, with a small inset porch at the northwest corner of the building. The porch has a wood railing and porch floor. There is a wood cross buck door to the right side of the north elevation, and a small one-over-one-light double-hung vinyl window with shutters and a window box, to the left of the porch and entry. The west elevation has a small one-over-one-light double-hung vinyl window and window box located to the right of center. The east elevation has a pair of wood double doors. The south elevation has no fenestration. The portable garden shed has no apparent foundation, is clad with T-111 siding, and has an asphalt shingled gambrel roof. There is a pair of wood cross buck double doors facing east. A small wood cupola with a weathervane is centered on the ridge of the roof.

Narrative Statement of Significance

The Minnie C. White House appears to contribute historically to the potential “west side” residential historic district in Washington. While the integrity of the house has been comprised by later additions, vinyl siding, and replacement windows, the overall two-story cross-gable frame house is still discernible. The side addition is one story and setback from the main section of the house, detracting less from the original form. The replacement windows appear to be the same size as the original

Iowa Site Inventory Form
State Historic Preservation Office
Continuation Sheet

Site Number: 92-00752
Related District Number: 92-00350

Page 3

<u>Minnie C. White House</u>	<u>Washington</u>
Name of Property	County
<u>609 W. Jefferson Street</u>	<u>Washington</u>
Address	City

windows. Thus, the house retains sufficient integrity to be tabulated as a contributing building in the historic district.

The house does not retain sufficient historic integrity to be individually eligible for listing on the National Register of Historic Places under Criteria A, B, or C.

History / research summary of property

The 1909 Sanborn map shows a square two story house with a front porch on Lot 2. The same house is depicted on the 1917 Sanborn map. The house is listed as 615 W. Jefferson on the maps, which then became the address of the new house to the west in the 1920s, with this house then renumbered as 609. The assessor lists 1906 as an estimated construction date for the house, but Sanborn maps clearly show a different house on this lot in 1909 and 1917. The overall form of the house does suggest construction in the late 19th or early 20th century, which may suggest that the house was moved to this lot in the 1920s. S.P. Keefer bought this property (Lot 2) from the sheriff on September 8, 1908. Simon P. and Elizabeth Keefer are listed at 615 W. Jefferson in the 1910-11 city directory, and he is a retired farmer.

Mrs. Adelia Feters, administrator, then sold the property on March 12, 1918 to G.F. Feters, who sold it on October 18, 1919 to W.P. Littlefield (single), who sold it to Sarah A. Ingham (widow) on January 6, 1920, and who sold it to C.W. Busby on December 6, 1920. C.W. Busby sold it to Minnie C. White on March 31, 1921. The 1920 census identifies the White family as Edward J., age 54, a farmer, his wife Minnie, age 50, and three daughters, Lela, age 27 and a stenographer at a lumber company, Norma, age 17, and Margery, age 13. At this time, the family is living on a farm northwest of Washington. Edward J. White died on March 11, 1921. So, her purchase coincided with his death and moving to town. The 1926 telephone directory lists Mrs. E.J. White living at 609 W. Jefferson Street. Based on the Sanborn maps and this history, it appears that the house was built (or moved here) around 1921, not shown on the 1917 Sanborn map but here on the 1931 Sanborn map.

On April 9, 1928, Mrs. White transferred the property to her daughter, Lela White. She used it as a rental property. The 1930 census lists the residents at this address as Paul Lytle, a renter, age 25, who is a salesman for a Feed & Seed store, and his wife Marjorie, age 23, a rural school teacher. They rented the house for \$15 per month. The 1931 Sanborn map shows a house very much like the house on Lot 2 today, including the T-plan form with a front porch at the northeast corner of the house and a small back porch at the southeast corner of the house. The 1932 telephone directory indicates the Lytle family is still living at this address, and the 1935 city directory lists the family as Paul Lytle, attendant at Brown's Super Service, and his wife Marjorie. The 1940 census lists Willard Campbell, age 31 and a gas station manager, with his wife Helen, age 26 and a cutter at the button factory, and children Eugene, age 8, Willard, Jr. age 5, and Rodney, age 1 living here. The 1941 city directory lists John Kurtz, an employee at Bush Coal Co., and his wife Minnie living at 609 W. Jefferson.

Iowa Site Inventory Form
State Historic Preservation Office
Continuation Sheet

Site Number: 92-00752
Related District Number: 92-00350

Page 4

<u>Minnie C. White House</u>	<u>Washington</u>
Name of Property	County
<u>609 W. Jefferson Street</u>	<u>Washington</u>
Address	City

On September 1, 1945, Lela White Ronse and husband transferred the property to C.P. Weldin, who sold it four days later to Lyle E. and Lillie Mae Long. The 1954 city directory index lists Lyle Long living here.

Long sold the property to Harold and Helen Rathmel on January 30, 1956. The 1956 telephone directory lists Harold Rathmel living at 609 W. Jefferson. and the Rathmel family continues to appear at this address in telephone and city directories through 1964. In that directory, Rathmel, the home owner, is listed as a press man at McCleery-Cumming Co., and his wife Helen is a bookkeeper at Hotle Feed and Grain Co.

On February 27, 1965, Rathmel and wife transferred the property to Howard F. and Myrtle B. Altenbernd. The 1967 city directory lists Howard as retired, and a home owner, and this listing continues through the 1976 city directory with no changes.

Iowa Site Inventory Form
State Historic Preservation Office
Continuation Sheet

Site Number: 92-00752
Related District Number: 92-00350

Page 5

<u>Minnie C. White House</u>	<u>Washington</u>
Name of Property	County
<u>609 W. Jefferson Street</u>	<u>Washington</u>
Address	City

Bibliography

Atlas of Washington County, Iowa. Clinton, IA, and Philadelphia, PA: Harrison and Warner, 1874.

Atlas of Washington County, Iowa. No publisher noted, 1894. In collection of Washington Public Library.

Burrell, Howard A. *History of Washington County, Iowa.* Chicago, IL: S.J. Clarke Publishing Company, 1909. 2 volumes.

City/telephone directories. Washington Public Library. Various years, including 1894, 1903, 1908, 1910-11, 1917, 1932, 1934, 1935, 1938, 1941, 1952, 1954, 1956, 1958, 1960, 1962, 1964, 1967, 1969, 1972, and 1976.

Fisher, Kathy. *In the beginning there was land : a history of Washington County, Iowa.* Washington, Iowa: Washington County Historical Society, 1978.

Newspapers, including anniversary/celebration editions on microfilm and/or bound at Washington Public Library:

Washington Gazette, January 6, 1893

Twentieth Anniversary Edition, *Evening Journal*, April 26, 1913

Twenty-Fifth Anniversary Edition, *Evening Journal*, April 3, 1926

Washington County Centennial Edition, *Evening Journal*, July 1936

Souvenir Edition of Washington Centennial, *The Evening Journal*, August 1939

Sixtieth Anniversary Edition, *The Washington Evening Journal*, February 27, 1953

Bicentennial edition, *The Washington Evening Journal*, July 1, 1976

Sesquicentennial edition, *The Washington Evening Journal*, April 13, 1989

Patterson, Mary. Collection of historic postcards, images, and city/telephone directories. Washington, Iowa. Accessed 2014-2015.

Portrait and Biographical Album of Washington County, Iowa. Chicago, Acme Publishing Company, 1887.

Sanborn Map Company. *Washington, Iowa.* Fire insurance maps. 1885, 1892, 1897, 1902, 1909, 1917, 1931, 1943.

Souvenir History of Washington, Iowa. Washington, IA: Washington Evening Journal, June 23, 1989.

Washington County Historical Society. Collection of historic postcards and photographs.

Iowa Site Inventory Form
State Historic Preservation Office
Continuation Sheet

Site Number: 92-00752
Related District Number: 92-00350

Page 6

Minnie C. White House Washington
Name of Property County

609 W. Jefferson Street Washington
Address City

Location map



2009 aerial photograph (Washington County) – line indicates survey/research area boundary

Iowa Site Inventory Form
State Historic Preservation Office
Continuation Sheet

Site Number: 92-00752
 Related District Number: 92-00350

Page 7

<u>Minnie C. White House</u>	<u>Washington</u>
Name of Property	County
<u>609 W. Jefferson Street</u>	<u>Washington</u>
Address	City

Building plan (from assessor's website)

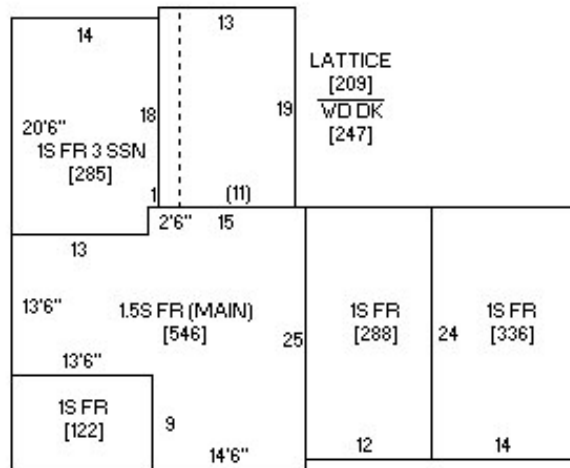

Photo from assessor's website



Iowa Site Inventory Form
State Historic Preservation Office
Continuation Sheet

Site Number: 92-00752
Related District Number: 92-00350

Page 8

Minnie C. White House
Name of Property

Washington
County

609 W. Jefferson Street
Address

Washington
City

Digital photographs



Photograph 92-00752-001 - House, looking southwest (December 2014)

Iowa Site Inventory Form
State Historic Preservation Office
Continuation Sheet

Site Number: 92-00752
Related District Number: 92-00350

Page 9

Minnie C. White House
Name of Property

Washington
County

609 W. Jefferson Street
Address

Washington
City



Photograph 92-00752-002 - House, looking southeast (December 2014)

Iowa Site Inventory Form
State Historic Preservation Office
Continuation Sheet

Site Number: 92-00752
Related District Number: 92-00350

Page 10

Minnie C. White House
Name of Property

Washington
County

609 W. Jefferson Street
Address

Washington
City



Photograph 92-00752-003 - House, looking northeast (December 2014)

Iowa Site Inventory Form
State Historic Preservation Office
Continuation Sheet

Site Number: 92-00752
Related District Number: 92-00350

Page 11

Minnie C. White House
Name of Property

Washington
County

609 W. Jefferson Street
Address

Washington
City



Photograph 92-00752-004 - House, looking northwest (December 2014)

Iowa Site Inventory Form
State Historic Preservation Office
Continuation Sheet

Site Number: 92-00752
Related District Number: 92-00350

Page 12

Minnie C. White House
Name of Property

Washington
County

609 W. Jefferson Street
Address

Washington
City



Photograph 92-00752-005 - Sheds, looking southeast (December 2014)