

# Iowa Site Inventory Form

State Historic Preservation Office

(July 2014)

State Inventory Number: 92-00376  New  Supplemental

9-Digit SHPO Review & Compliance (R&C) Number: \_\_\_\_\_

Non-extant Year: \_\_\_\_\_

**Read the Iowa Site Inventory Form Instructions carefully, to ensure accuracy and completeness before completing this form. The instructions are available on our website: <http://www.iowahistory.org/historic-preservation/statewide-inventory-and-collections/iowa-site-inventory-form.html>**

## • Property Name

A) Historic name: Howard A. and Martha J. Burrell House

B) Other names: West side survey map #WS-064

## • Location

A) Street address: 527 W. Washington Blvd

B) City or town: Washington ( Vicinity) County: Washington

C) Legal description:

Rural: Township Name: \_\_\_\_\_ Township No.: \_\_\_\_\_ Range No.: \_\_\_\_\_ Section: \_\_\_\_\_ Quarter: \_\_\_\_\_ of Quarter: \_\_\_\_\_

Urban: Subdivision: Subdivision of Out Lot 3 Block(s): \_\_\_\_\_ Lot(s): LOT 5 & N 16.5 FT of LOT 6

## • Classification

**A) Property category:** *Check only one*

- Building(s)
- District
- Site
- Structure
- Object

**B) Number of resources (within property):**

If eligible property, enter number of:		If non-eligible property, enter number of:	
Contributing	Noncontributing		
<u>1</u>	Buildings	<u>1</u>	Buildings
—	Sites	—	Sites
—	Structures	—	Structures
—	Objects	—	Objects
<u>1</u>	<b>Total</b>	<u>1</u>	<b>Total</b>

**C) For properties listed in the National Register:**

National Register status:  Listed  De-listed  NHL  NPS DOE

**D) For properties within a historic district:**

- Property contributes to a National Register or local certified historic district.
- Property contributes to a potential historic district, based on professional historic/architectural survey and evaluation.
- Property *does not* contribute to the historic district in which it is located.

Historic district name: West side residential historic district Historic district site inventory number: 92-00350

**E) Name of related project report or multiple property study, if applicable:**

MPD title: Architectural and Historical Survey of the "west side" residential neighborhood in Washington Historical Architectural Data Base #: 92-013

## • Function or Use *Enter categories (codes and terms) from the Iowa Site Inventory Form Instructions*

**A) Historic functions**

01A01: Domestic / residence  
\_\_\_\_\_  
\_\_\_\_\_

**B) Current functions**

01A01: Domestic / residence  
01C05: Domestic/garage  
\_\_\_\_\_

## • Description *Enter categories (codes and terms) from the Iowa Site Inventory Form Instructions*

**A) Architectural classification**

05B: Italianate  
\_\_\_\_\_  
\_\_\_\_\_

**B) Materials**

Foundation (visible exterior): 04: Stone  
Walls (visible exterior): 02A: Weatherboard  
Roof: 08A: Asphalt shingles  
Other: \_\_\_\_\_

**C) Narrative description**  *SEE CONTINUATION SHEETS, WHICH MUST BE COMPLETED*

• **Statement of Significance**

**A) Applicable National Register Criteria:** *Mark your opinion of eligibility after applying relevant National Register criteria*

- Criterion A: Property is associated with significant events.  Yes  No  More research recommended  
 Criterion B: Property is associated with the lives of significant persons.  Yes  No  More research recommended  
 Criterion C: Property has distinctive architectural characteristics.  Yes  No  More research recommended  
 Criterion D: Property yields significant information in archaeology/history.  Yes  No  More research recommended

**B) Special criteria considerations:** *Mark any special considerations; leave blank if none*

- A: Owned by a religious institution or used for religious purposes.  E: A reconstructed building, object, or structure.  
 B: Removed from its original location.  F: A commemorative property.  
 C: A birthplace or grave.  G: Property less than 50 years of age or achieved significance within the past 50 years.  
 D: A cemetery

**C) Areas of significance**

*Enter categories from instructions*

Community planning and development

**D) Period(s) of significance**

\_\_\_\_\_

**E) Significant dates**

*Construction date*

1876  *check if circa or estimated date*

*Other dates, including renovations*

**F) Significant person**

*Complete if Criterion B is marked above*

\_\_\_\_\_

**G) Cultural affiliation**

*Complete if Criterion D is marked above*

\_\_\_\_\_

**H) Architect/Builder**

*Architect*

\_\_\_\_\_

**I) Narrative statement of significance**  *SEE CONTINUATION SHEETS, WHICH MUST BE COMPLETED*

• **Bibliography**  *See continuation sheets for the list of research sources used in preparing this form*

• **Geographic Data** *Optional UTM references*  *See continuation sheet for additional UTM or comments*

Zone	Easting	Northing	NAD	Zone	Easting	Northing	NAD
1	_____	_____	_____	2	_____	_____	_____
3	_____	_____	_____	4	_____	_____	_____

• **Form Preparation**

Name and Title: Joanne L. Breen - volunteer Rebecca Lawin McCarley, consultant Date: July 24, 2015

Organization/firm: Washington Historic Preservation Commission E-mail: -

Street address: City Hall, 215 E, Washington St Telephone: 319-653-6584

City or Town: Washington State: Iowa Zip code: 52353

• **ADDITIONAL DOCUMENTATION** *Submit the following items with the completed form*

**A) For all properties, attach the following, as specified in the Iowa Site Inventory Form Instructions:**

1. **Map** of property's location within the community.
2. **Glossy color 4x6 photos labeled** on back with property/building name, address, date taken, view shown, and unique photo number.
3. **Photo key showing each photo number on a map and/or floor plan, using arrows next to each photo number to indicate the location and directional view of each photograph.**
4. **Site plan** of buildings/structures on site, identifying boundaries, public roads, and building/structure footprints.

**B) For State Historic Tax Credit Part 1 Applications, historic districts and farmsteads, and barns:**

*See lists of special requirements and attachments in the Iowa Site Inventory Form Instructions.*

**State Historic Preservation Office (SHPO) Use Only Below This Line**

*The SHPO has reviewed the Site Inventory and concurs with above survey opinion on National Register eligibility:*

- Yes  No  More research recommended  
 *This is a locally designated property or part of a locally designated district.*

Comments: \_\_\_\_\_

SHPO authorized signature: \_\_\_\_\_ Date: \_\_\_\_\_

**Iowa Site Inventory Form**  
**State Historic Preservation Office**  
**Continuation Sheet**

Site Number: 92-00376  
Related District Number: 92-00350

Page 1

Howard A. and Martha J. Burrell House  
Name of Property

Washington  
County

527 Washington Blvd  
Address

Washington  
City

**Narrative Description**

This is a two-story frame, Italianate house with a gable roof, built on the south side of W. Washington Boulevard. The house sits on a stone foundation, and the walls are clad in weatherboard siding. The gable roof is covered in asphalt shingles and has wood eaves. The windows retain wood surrounds and wood sashes, and some have storms/screens on the windows. There is an open porch on the front. A detached frame garage is on the southwest side of the house and is accessed from the street.

The front of the house (north elevation) is spanned by a one story, open porch. The porch has six round columns supporting a flat roof with wooden eaves and brackets. Two engaged columns are attached to the east and west corners of the house. The foundation is concrete with concrete stairs and deck. A sidewalk runs north and connects to the city sidewalk. The façade is composed of the main three-bay gable-front section and the two-bay side wing. On the first story, there are two entries, one into each of these sections. The original entry into the house is in the left bay of the gable-front section, and it has a wood door with two rectangular windows. There is a transom above the door and wood surround and a cornice. There is a storm door with two large windows. The other entry is in the bay to the east. It has a decorative wooden door (raised design on the front panel) with a transom above and wood surround and a cornice. On the west section, on the first story to the right/west of the entry, there are two tall two-over-two-light double-hung windows with wood surrounds and a cornice, which reach nearly from floor to ceiling. On the second story of this section, there are three two-over-two-light double-hung windows with a wood cornice and shutters on each side. In the gable, there is a small two-over-two-light double-hung window with a wood cornice and shutters on each side. In the east side wing, there is a tall one-light window with wood molding and a cornice on the first story to the left/east of the entry. The second story has two two-over-two-light double-hung windows with a wood cornice and shutters on each side.

The west elevation of the main section of the house has a brick chimney in the center. At the first story level, the chimney has ornate masonry, including a horizontal design inlay with a fan-like inlay above, and five square columns with stone caps. The top of the chimney is ornate also. To the north/left of the chimney, there is a two-over-two-light double-hung window on the first and second stories with wood molding and shutters on each side. To the south/right, there also is a two-over-two-light double-hung window on the first and second stories with wood molding and shutters on each side. Basement windows are found to either side of the chimney as well.

The east elevation of the side wing of the house has two two-over-two-light double-hung windows on the first and second stories with wood molding. The windows on the second story have shutters on each side.

On the rear/south of the main section of the house has a two-over-two-light double-hung window with wood molding on the first and second stories at the left/west side. Near the east end of the rear gable and on east/right section, there are two two-over-two-light double-hung windows on the second story. In the gable at the attic level, there is a two-light wood window to the left/west of center.

The rear of the house also has three smaller rear sections, two of which are shown on the 1909 Sanborn map and the third is in the place of an earlier open porch. The first section, on the west side of the rear/south side, is one story, gable-roof section, which has a half gable roof extension. It has a

**Iowa Site Inventory Form**  
**State Historic Preservation Office**  
**Continuation Sheet**

Site Number: 92-00376  
Related District Number: 92-00350

Page 2

Howard A. and Martha J. Burrell House  
Name of Property

Washington  
County

527 Washington Blvd  
Address

Washington  
City

one-over-one-light double-hung window on the west side. The east gable extends south, with a skylight on the east side. There is a one-light window on the east side of this section. To the south/rear of the first section, there is a one-story, gable-roof section. There is a skylight in the asphalt shingles on the roof on the west and east sides. There are two one-over-one-light double-hung windows on the west side. On the side south, there is an ornate brick chimney. About half way up there are five square columns with stone caps. There is a one-over-one-light double-hung window with transoms to either side of the chimney. Above these windows are quarter circle windows flanking the chimney in the gable. On the south end of the east side, there is a set of sliding glass doors. On the north end, there is a one-light window. These two additions – a two-story and then one-story section – are depicted on Sanborn maps from 1909 to 1943, though the one-story section appears to have been rebuilt/remodeled in 1998 per the assessor, retaining the earlier brick chimney. On the rear/south side of the east half of the house, there is a shed-roof addition that is located in the place of an earlier porch that extended across this section and along the east side of the two rear sections to the west. The shed roof has a skylight. At the west end, there is a wood door with a window. There are two one-over-one-light double-hung windows to the east/right of the entry. A wood deck extends to the south. There is a concrete patio that spans the deck and rear of the house.

A detached frame, two-car garage, built in 1998 per the assessor, is located on the southwest corner of the property. It is clad in wood shake siding on the front/north and in vertical wood siding on the other sides. It has a steep front gable roof with asphalt shingles. There are two single overhead garage doors on the north side. There is a large round window in the center of the north gable. There is a window on the west side. The driveway runs from the garage entrance (north side) and along the west side of the house to the street.

**Narrative Statement of Significance**

The Howard A. and Martha J. Burrell House appears to contribute historically and architecturally to the potential residential historic district on the west side of Washington. The house was built during the early period of development of the neighborhood in the 1860s and 1870s, one of the larger Italianate homes built in this period. Howard A. Burrell was editor of the *Washington Press* from 1866 to 1903, and he was influential in town and the state through his newspaper. He then wrote the *History of Washington County*, in 1909, a two-volume set. He living in this house with his second wife Martha J. Burrell from 1877 to her death in 1908. The house is an excellent example of the Italianate style in this neighborhood, retaining many historic features.

The house appears individually eligible for listing on the National Register of Historic Places under Criterion B for its association with Howard A. Burrell and/or Criterion C for its architecture. Further research on Howard Burrell, evaluation of the interior integrity of the house, and comparison with other Italianate houses would solidify these determinations.

*History / research summary of property*

This lot was owned by Mary Ferguson in the 1860s, who sold it to C.T. Jones on November 6, 1866. Jones then sold it to H.A. Burrell on August 20, 1868. The 1869 birds-eye view of Washington shows

**Iowa Site Inventory Form**  
**State Historic Preservation Office**  
**Continuation Sheet**

Site Number: 92-00376  
Related District Number: 92-00350

Page 3

---

Howard A. and Martha J. Burrell House	Washington
Name of Property	County
527 Washington Blvd	Washington
Address	City

---

an earlier one-story side gable house on this lot. Howard A. Burrell was born on January 4, 1838 in Lorain County, Ohio to Robbins and Eliza (Brigham) Burrell. He graduated from Oberlin College in 1862, and moved to Cleveland, Ohio and worked as a writer and city editor on the *Daily Leader* for three years. He appears to have moved to Washington from Ohio due to the family connection of his wife. Harriett's uncle, Norman Everson, was an early settler in Washington, moving here in the 1840s. He was an early teacher, lawyer, and banker in town. During the early 1860s, Everson visited Harriet Everson, a student at Oberlin College in Ohio, and he met her roommate, Ellen E. Pierce. In 1863, Howard Burrell, a journalism student, married his niece Harriet. Norman Everson returned to Ohio in 1865, married Ellen Pierce, and then invited Burrell and his wife, who were living in Cleveland, to join him in Washington. Eversons built their house in 1866 ("Ellen Everson," *Washington Evening Journal*, December 13, 1907; *History of Washington County* 1880: 599-600). In 1866, Howard A. Burrell bought the *Washington Press* from A.R. Wickersham, who had owned it since 1856, and he was the owner/editor of the newspaper until 1903 (Burrell 1909, Vol 1: 313). The 1870 census lists the family in Washington: Howard A. (32, editor, \$2000 in real estate), Harriett (35), Norman (3), and Helen (9 months). A domestic servant also lived with the family. Anna was born in the early 1870s, and Harriett E. Burrell died on June 5, 1876. The 1874 atlas shows a rectangular house, oriented similar to this house (north-south on the lot, not east-west per the 1869 birds-eye view). So, this house may have been built in the early 1870s as the family was growing. The house may also have been built after Harriett died in 1876 (the assessor's date of construction) or in 1877 as Howard prepared to remarry.

Howard A. Burrell then married Martha J. Jackson, daughter of John Jackson, on December 19, 1877. Howard Burrell and his family are listed in the U.S. Federal Census living on Washington Boulevard in 1880. Howard is listed as 43 years old, born in Ohio and employed as an Editor/Publisher, his wife Martha J. was 46 years old and born in Ohio, and children are Norman (12), Helen (10) and Anna (8). The 1885 census lists the family on Washington as well: H.A. Burrell (46, editor), Martha J. (50), Norman E. (17), Helen B. (15), Anna J. (13). The *Washington Press* cited "an addition for H.A. Burrell valued at \$1,000, and built by Harry Shrader", in an article titled 'Building Statistics' published in late 1890. The 1894 atlas then shows this current house with the current footprint. The 1895 Iowa census lists Howard A. Burrell (57, editor), Mattie J. (61), Norman E. (27, printer), and Anna M. (23). They were members of the Methodist church. The 1900 U.S. Federal Census shows that Howard and family lived on Washington and owned the house free of a mortgage. Howard A. is 62 years old, born Jan 1838 in Ohio, married and works as an Editor/Journalist; Martha is 66 years old, born Nov 1833, married and no children; and son Norman E. was 31, born Jun 1868 and worked in composition (newspaper). Kate Baumgartner, age 21, servant, also lives with them. Howard Burrell is listed in the 1903 city directory living at 527 West Washington Street as Editor of the *Press*, and wife Martha J and son Norman live with him. Norman works as a printer. In 1903, Burrell sold the *Washington Press* to Ralph L. Livingston (Burrell 1909, Vol 1: 313).

On June 6, 1905, the Washington County Historical Society was organized, with Marsh W. Bailey president, C. H. Keck, vice president; A. R. Miller, secretary; J. A. Young, treasurer; and C. J. Wilson curator. Directors included H.A. Burrell, A. H. Wallace, Frank Stewart, Col. Bell, S. W. Neal, C. H. Wilson. They worked to collect and organize some old materials, and they authorized the *History of Washington County* in winter of 1908-09 (Burrell 1909, Vol. 1: 364). Howard A. Burrell was the author of this two volume history of Washington County. Martha Jane Burrell died on February 7, 1908. According to her obituary and the *History of Washington County* (1880), she was born November 21, 1833 in Lima, Ohio to John and Jane (Jeffery) Jackson. The Jacksons were one of the pioneer families

**Iowa Site Inventory Form**  
**State Historic Preservation Office**  
**Continuation Sheet**

Site Number: 92-00376  
Related District Number: 92-00350

Page 4

Howard A. and Martha J. Burrell House  
Name of Property

Washington  
County

527 Washington Blvd  
Address

Washington  
City

of Washington. She was about six years old when her family came to Washington. She was a member of the 19<sup>th</sup> Century Club and the Methodist Church. The 1910 census then lists Howard A. (72 years old, widower) and son Norman (41 and single). In the 1910-11 city directory, Howard is listed as a retired editor, and son Norman works for Minnick & Son. Norman E. Burrell died on April 26, 1913. The 1909 and 1917 Sanborn Maps show a 2 story dwelling with a wing off the rear and porches on the front and southeast corner of the house.

Howard A. Burrell died on July 15, 1916. According to his obituary, "Somehow, everyone knew him as 'Burrell' and everybody called him Burrell. Half the people did not know his given name." Burrell was highly admired by his associates for his skills, insight and intellect. His obituary notes that he was "a wonderful writer," "greatest reader of books...in Iowa," "his paper put Washington on the map," and "he had a great command of language being a classical scholar." The *Press* "became the leading Republican paper of the State.....aside from the real ability of Mr. Burrell as a newspaper man and his financial success in managing the business, he has certain peculiarities as a writer which distinguish him from all others." "He did not relish politics, yet he was a valuable aid in the campaign and his editorials were used not only in the county, but all over Iowa..." He traveled a lot and wrote of his travels. Burrell strongly believed in "libraries for the masses, for books for the masses and for schools." He was a councilman and his primary goal was to "...get a city library organized, and he did and quit."

The property transferred from the estate of Howard Burrell to George Teas on April 13, 1920. The 1920 U.S. Federal Census shows that George Tays (Teas) and his wife Mary lived at 527 West Washington Street and owned the house free of a mortgage. George is listed as 54 years old, born in Iowa, married, and worked as a blacksmith; Mary was 44 years old, born in Bohemia and immigrated to the U.S. in 1856. The 1926 City Directory lists George Teas at 527 West Washington Street. They then sold the house later in 1926 and moved down the street. George Teas later died on May 2, 1931 at his home at 409 W. Washington Street. According to his obituary, Mr. Teas was born on April 21, 1865 in Washington to Lucian and Elizabeth (Donovan) Teas. He lived in Washington his entire life. He attended the public schools and established worked in a blacksmithing business for more than 40 years. George married Mame Beranek on May 16, 1894. Mr. Teas served on the Washington City council for a number of years. He was a member of the local fire department and the Odd Fellows Lodge. Mary died in 1964. According to her obituary, she was born Dec 18, 1872 in Prague, Praha, Bohemia to Peter and Rybochek Bernaek. She came to the United States while still an infant and was reared in this community. She was a member of the Presbyterian Church.

George Teas and wife sold this house to Mary E. McCleery on November 27, 1926. McCleery then sold the property to Susie Anderson on June 10, 1929. Anderson then sold it to C.W. Southwell on August 27, 1929. John and Susie Anderson lived across the street at 530 W. Washington. Caughley W. Southwell was married to Helen Anderson Southwell, daughter of Suzie and John Anderson. Based on census records. the Southwells did not live in Washington, Iowa. The 1930 U.S. Federal Census shows two families renting the house at 527 W. Washington. The first family was Isaac Rothchild (60, ready-to-wear clothing), wife Emma (60, buyer for ready-to-wear) and daughter Jeannette (24, private secretary at a publishing house), who rented for \$30 per month. The second family includes Frederick Morrison, wife Lucile M. and son Jimmie Bruce. Frederick is a banker. They also rented for \$30 per month. The 1931 Sanborn Map shows the same two story dwelling with porches as previous years, but there is now an auto garage in the southwest corner of the property.

**Iowa Site Inventory Form**  
**State Historic Preservation Office**  
**Continuation Sheet**

Site Number: 92-00376  
Related District Number: 92-00350

Page 5

Howard A. and Martha J. Burrell House  
Name of Property

Washington  
County

527 Washington Blvd  
Address

Washington  
City

The 1932 and 1935 city directories list Frank B. and Bertha Miller living at 527 W. Washington. Frank is listed as district manager for the Iowa Southern Utilities Co. The property transferred from C.W. Southwell and wife (Helen) to Frank B. and Bertha Miller on May 26, 1937. They continue to be listed here in the 1938 and 1941 city directories. In 1941, children Sara Lu (13), Frances (8), and Frank (6) live with them. The 1940 U.S. Federal Census shows that Frank Miller and family lived on Washington and owned the house free of a mortgage. In the listing, Frank is 42 years old, born in Missouri and worked as a district manager at a utilities company; wife Bertha is 41 years old and born in Iowa; and they have three children, Saralu (12), Frances (7), and Frank (5). Frank Miller died on May 6, 1953. According to his obituary, Frank was born December 31, 1897 in St. Joseph, Missouri to James and Luelia (Brindley) Miller. He worked for the Iowa Southern Utilities company for 37 years and was district manager for 28 years. Mr. Miller lived in Washington since 1915 and was an active worker in many community and civic projects. He was president of the Lake Darling Youth Center and was instrumental in the development of Lake Darling and the Youth Center. He was a charter member and served as president of the Chiaqua chapter of the Izaak Walton league in Washington County. He was a member of the Washington Park Board and participated in development and improvements of Washington's parks and the planning of the Ralph Smith Memorial band stand. Mr. Miller was a member and past president of the Rotary Club, member of Toastmasters and the Washington Golf and Country Club. He was a member of the Presbyterian Church.

From 1954 through 1976, only Bertha Miller (widow of Frank) is listed and worked as a clerk at Seifert's. Boarders are also listed living at 527½: 1941 – Mrs. Sadie Hay; 1954 – H.M. Rabenold & W.R. Gross; 1969 – Mrs. Marguerite P. Crail; 1972 – William R. Gross, Mrs. Marguerite P. Crail. Bertha Miller died on June 13, 1986. According to her obituary, Bertha Adeline Hay was born May 12, 1898 at Mt. Union to Dr. G.W. and Sarah (Dunn) Hay. She was educated in Washington schools and at Northwestern University. She married Frank Miller on September 29, 1926. Mrs. Miller taught school, for eight years prior to her marriage, at Wyman, Crawfordsville, and Washington. After Frank died, she worked for 15 years at Siefert's. She was a member of the Fortnightly Creative Writing Club, 19<sup>th</sup> Century Club, several bridge clubs, and the United Presbyterian Church.

The property transferred from Bertha Miller to the Hart family on September 3, 1985 and then from the Harts to Kevin W. and Linda K. Soukup in 1990. Linda Soukup is the current owner (2015)

**Iowa Site Inventory Form**  
State Historic Preservation Office  
**Continuation Sheet**

Site Number: 92-00376  
Related District Number: 92-00350

Page 6

---

Howard A. and Martha J. Burrell House  
Name of Property

Washington  
County

527 Washington Blvd  
Address

Washington  
City

---

**Bibliography**

*Atlas of Washington County, Iowa.* Clinton, IA, and Philadelphia, PA: Harrison and Warner, 1874.

*Atlas of Washington County, Iowa.* No publisher noted, 1894. In collection of Washington Public Library.

Burrell, Howard A. *History of Washington County, Iowa.* Chicago, IL: S.J. Clarke Publishing Company, 1909. 2 volumes.

City/telephone directories. Washington Public Library. Various years, including 1894, 1903, 1908, 1910-11, 1917, 1932, 1934, 1935, 1938, 1941, 1952, 1954, 1956, 1958, 1960, 1962, 1964, 1967, 1969, 1972, and 1976.

Fisher, Kathy. *In the beginning there was land : a history of Washington County, Iowa.* Washington, Iowa: Washington County Historical Society, 1978.

*History of Washington County, Iowa.* Des Moines, IA: Union Historical Co., 1880.

Koch, Augustus. *Birds-eye View of the City of Washington.* Chicago: Chicago Lithograph Company, 1869.

Newspapers, including anniversary/celebration editions on microfilm and/or bound at Washington Public Library:

*Washington Gazette*, January 6, 1893

Twentieth Anniversary Edition, *Evening Journal*, April 26, 1913

Twenty-Fifth Anniversary Edition, *Evening Journal*, April 3, 1926

Washington County Centennial Edition, *Evening Journal*, July 1936

Souvenir Edition of Washington Centennial, *The Evening Journal*, August 1939

Sixtieth Anniversary Edition, *The Washington Evening Journal*, February 27, 1953

Bicentennial edition, *The Washington Evening Journal*, July 1, 1976

Sesquicentennial edition, *The Washington Evening Journal*, April 13, 1989

Patterson, Mary. Collection of historic postcards, images, and city/telephone directories. Washington, Iowa. Accessed 2014-2015.

*Portrait and Biographical Album of Washington County, Iowa.* Chicago, Acme Publishing Company, 1887.

Sanborn Map Company. *Washington, Iowa.* Fire insurance maps. 1885, 1892, 1897, 1902, 1909, 1917, 1931, 1943.

*Souvenir History of Washington, Iowa.* Washington, IA: Washington Evening Journal, June 23, 1989.

Washington County Historical Society. Collection of historic postcards and photographs.



**Iowa Site Inventory Form**  
State Historic Preservation Office  
**Continuation Sheet**

Site Number: 92-00376  
Related District Number: 92-00350

Page 7

Howard A. and Martha J. Burrell House  
Name of Property

Washington  
County

527 Washington Blvd  
Address

Washington  
City

**Location map**



*2009 aerial photograph (Washington County) – line indicates survey/research area boundary*

**Iowa Site Inventory Form**  
**State Historic Preservation Office**  
**Continuation Sheet**

Site Number: 92-00376  
 Related District Number: 92-00350

Page 8

Howard A. and Martha J. Burrell House  
 Name of Property

Washington  
 County

527 Washington Blvd  
 Address

Washington  
 City

**Building plan (from assessor's website)**

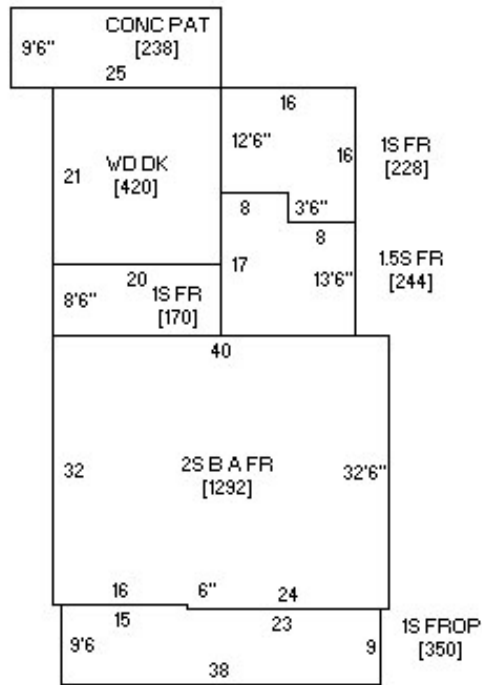

**Photo from assessor's website**



**Iowa Site Inventory Form**  
State Historic Preservation Office  
**Continuation Sheet**

Site Number: 92-00376  
Related District Number: 92-00350

Page 9

---

Howard A. and Martha J. Burrell House  
Name of Property

Washington  
County

527 Washington Blvd  
Address

Washington  
City

---

**Historic images**



**Iowa Site Inventory Form**  
State Historic Preservation Office  
**Continuation Sheet**

Site Number: 92-00376  
Related District Number: 92-00350

Page 10

Howard A. and Martha J. Burrell House  
Name of Property

Washington  
County

527 Washington Blvd  
Address

Washington  
City

**Digital photographs**



**Photograph 92-00376-001 - House, looking southeast (December 2014)**

**Iowa Site Inventory Form**  
State Historic Preservation Office  
**Continuation Sheet**

Site Number: 92-00376  
Related District Number: 92-00350

Page 11

Howard A. and Martha J. Burrell House  
Name of Property

Washington  
County

527 Washington Blvd  
Address

Washington  
City



**Photograph 92-00376-002 - House, looking southwest (December 2014)**

**Iowa Site Inventory Form**  
State Historic Preservation Office  
**Continuation Sheet**

Site Number: 92-00376  
Related District Number: 92-00350

Page 12

Howard A. and Martha J. Burrell House  
Name of Property

Washington  
County

527 Washington Blvd  
Address

Washington  
City



**Photograph 92-00376-003 - House, looking northwest (December 2014)**

**Iowa Site Inventory Form**  
State Historic Preservation Office  
**Continuation Sheet**

Site Number: 92-00376  
Related District Number: 92-00350

Page 13

Howard A. and Martha J. Burrell House  
Name of Property

Washington  
County

527 Washington Blvd  
Address

Washington  
City



**Photograph 92-00376-004 - House, looking northwest (December 2014)**

**Iowa Site Inventory Form**  
State Historic Preservation Office  
**Continuation Sheet**

Site Number: 92-00376  
Related District Number: 92-00350

Page 14

Howard A. and Martha J. Burrell House  
Name of Property

Washington  
County

527 Washington Blvd  
Address

Washington  
City



**Photograph 92-00376-005 - Garage, looking southwest (December 2014)**