

Iowa Site Inventory Form

State Historic Preservation Office

(July 2014)

State Inventory Number: 92-00392 New Supplemental

9-Digit SHPO Review & Compliance (R&C) Number: _____

Non-extant Year: _____

Read the Iowa Site Inventory Form Instructions carefully, to ensure accuracy and completeness before completing this form. The instructions are available on our website: <http://www.iowahistory.org/historic-preservation/statewide-inventory-and-collections/iowa-site-inventory-form.html>

• **Property Name**

A) Historic name: Carl M. and Helen B. Keck House

B) Other names: West side survey map #WS-068

• **Location**

A) Street address: 522 W. Washington Blvd

B) City or town: Washington (Vicinity) County: Washington

C) Legal description:

Rural: Township Name: _____ Township No.: _____ Range No.: _____ Section: _____ Quarter: _____ of Quarter: _____

Urban: Subdivision: Keck's Addition Block(s): _____ Lot(s): Lot 11 except N 8.25'

• **Classification**

A) Property category: *Check only one*

- Building(s)
- District
- Site
- Structure
- Object

B) Number of resources (within property):

If eligible property, enter number of:		If non-eligible property, enter number of:	
Contributing	Noncontributing		
<u>1</u>	Buildings	<u>1</u>	Buildings
—	Sites	—	Sites
—	Structures	—	Structures
—	Objects	—	Objects
<u>1</u>	Total	<u>1</u>	Total

C) For properties listed in the National Register:

National Register status: Listed De-listed NHL NPS DOE

D) For properties within a historic district:

- Property contributes to a National Register or local certified historic district.
- Property contributes to a potential historic district, based on professional historic/architectural survey and evaluation.
- Property *does not* contribute to the historic district in which it is located.

Historic district name: West side residential historic district Historic district site inventory number: 92-00350

E) Name of related project report or multiple property study, if applicable:

MPD title

Historical Architectural Data Base #

Architectural and Historical Survey of the "west side" residential neighborhood in Washington 92-013

• **Function or Use** *Enter categories (codes and terms) from the Iowa Site Inventory Form Instructions*

A) Historic functions

01A01: Domestic / residence

B) Current functions

01A01: Domestic / residence

01C05: Domestic/garage

• **Description** *Enter categories (codes and terms) from the Iowa Site Inventory Form Instructions*

A) Architectural classification

05D: Queen Anne

B) Materials

Foundation (visible exterior): 04: Stone

Walls (visible exterior): 06: Stucco / 02B: wood shingle

Roof: 08A: Asphalt shingles

Other: _____

C) Narrative description *SEE CONTINUATION SHEETS, WHICH MUST BE COMPLETED*

• Statement of Significance

A) Applicable National Register Criteria: *Mark your opinion of eligibility after applying relevant National Register criteria*

- Criterion A: Property is associated with significant events. Yes No More research recommended
 Criterion B: Property is associated with the lives of significant persons. Yes No More research recommended
 Criterion C: Property has distinctive architectural characteristics. Yes No More research recommended
 Criterion D: Property yields significant information in archaeology/history. Yes No More research recommended

B) Special criteria considerations: *Mark any special considerations; leave blank if none*

- A: Owned by a religious institution or used for religious purposes. E: A reconstructed building, object, or structure.
 B: Removed from its original location. F: A commemorative property.
 C: A birthplace or grave. G: Property less than 50 years of age or achieved significance within the past 50 years.
 D: A cemetery

C) Areas of significance

Enter categories from instructions

Community planning and development

D) Period(s) of significance

E) Significant dates

Construction date

1897 *check if circa or estimated date*

Other dates, including renovations

F) Significant person

Complete if Criterion B is marked above

Carl M. Keck

G) Cultural affiliation

Complete if Criterion D is marked above

H) Architect/Builder

Architect

Builder/contractor

I) Narrative statement of significance *SEE CONTINUATION SHEETS, WHICH MUST BE COMPLETED*

• Bibliography *See continuation sheets for the list of research sources used in preparing this form*

• Geographic Data *Optional UTM references* *See continuation sheet for additional UTM or comments*

Zone	Easting	Northing	NAD	Zone	Easting	Northing	NAD
1	_____	_____	_____	2	_____	_____	_____
3	_____	_____	_____	4	_____	_____	_____

• Form Preparation

Name and Title: Joanne L. Breen - volunteer Rebecca Lawin McCarley, consultant Date: July 2, 2015

Organization/firm: Washington Historic Preservation Commission E-mail: -

Street address: City Hall, 215 E, Washington St Telephone: 319-653-6584

City or Town: Washington State: Iowa Zip code: 52353

• ADDITIONAL DOCUMENTATION *Submit the following items with the completed form*

A) For all properties, attach the following, as specified in the Iowa Site Inventory Form Instructions:

1. **Map** of property's location within the community.
2. **Glossy color 4x6 photos labeled** on back with property/building name, address, date taken, view shown, and unique photo number.
3. **Photo key showing each photo number on a map and/or floor plan, using arrows next to each photo number to indicate the location and directional view of each photograph.**
4. **Site plan** of buildings/structures on site, identifying boundaries, public roads, and building/structure footprints.

B) For State Historic Tax Credit Part 1 Applications, historic districts and farmsteads, and barns:

See lists of special requirements and attachments in the Iowa Site Inventory Form Instructions.

State Historic Preservation Office (SHPO) Use Only Below This Line

The SHPO has reviewed the Site Inventory and concurs with above survey opinion on National Register eligibility:

- Yes No More research recommended
 This is a locally designated property or part of a locally designated district.

Comments: _____

SHPO authorized signature: _____ Date: _____

Iowa Site Inventory Form
State Historic Preservation Office
Continuation Sheet

Site Number: 92-00392
Related District Number: 92-00350

Page 1

<u>Carl M. and Helen B. Keck House</u>	<u>Washington</u>
Name of Property	County
<u>522 W. Washington Blvd</u>	<u>Washington</u>
Address	City

Narrative Description

This is a two-story, frame Queen Anne house with a cross gable roof built in 1897 on the north side of W. Washington Boulevard. The house sits on a stone foundation. The walls are clad in stucco though the gables/attic level is clad in wood shingles. The gable roof is covered in asphalt shingles. The gable edges are built-out with wide wood soffits and pointed arch openings. The façade is dominated by a curved two-story section with a balcony. All windows retain wood surrounds and wood sashes, and they have storms/screens on the windows. There is an open porch across the width of the front. A detached frame garage, built in 1990 per the assessor, is behind the house (west side) and is accessed from the street.

The facade (south elevation) is spanned by a full porch. The porch has five round columns and a wide frieze with dentils supporting a flat roof with wood eaves. Wood spindle railings run between the columns. The foundation area is clad in wood lattice. Wood stairs, with wood hand railings lead up to the porch. As noted, the façade has a centered two-story section with rounded corners and a balcony on the roof. On the first story, the entry is located to the west/left side, and it has a wood door with a single-light window. The middle portion of the first story is the curved bay window with three one-over-one-light double-hung windows, including curved glass windows on each rounded corner. There is a one-over-one-light double-hung window to the east/right on the first story. The middle of the second story has the curved bay window with three windows, with three one-over-one-light double-hung windows, including curved glass windows on each rounded corner. The center window has shutters. On the second story to the east and west of this section, there is a one-over-one-light double-hung window with shutters. Above these windows, there are two decorative carved wood brackets under the roof soffit. The front gable with the pointed arch cut-out is centered on the façade above the curved bay window. A balcony is located on top of the curved section, with a two-foot wood railing with half-moon cutouts. In the gable, there is a Palladian window group, with a center taller arch window and double-hung side windows. The wall in the gable is clad in wood shingles.

The west elevation has a gable with a built-out pointed arch opening that spans the width of this side. The first story has two circular windows with a single horizontal window in between them. The second story has a centered pair of one-over-one-light double-hung windows with transoms, and a one-over-one-light double-hung window to the north. In the gable, there are two one-over-one-light double-hung windows. The wall in this area is clad in wood shingles. Three two-light basement windows are found in the stone foundation.

The east elevation likewise has a gable with a built-out pointed arch opening that spans the width of this side. The first story has a pair of one-over-one-light double-hung windows on the south half and a small one-story square bay window on the north half. The bay window has two high rectangular windows. On the second story, there is a one-over-one-light double-hung window on the south half and on the north half. The gable at the attic level has a pair of one-over-one-light double-hung windows. The wall in this area is clad in wood shingles. Two basement windows sit in the stone foundation.

The rear of the house (north elevation) has a gable with a built-out pointed arch opening that spans the west three-quarters of the elevation, with this entire area extending further north than the east quarter of this side. Thus, under the east end of the built-out gable, there is a recessed corner porch on each story. The porch with has round columns at the corner on both stories. There is a wide wood frieze with

Iowa Site Inventory Form
State Historic Preservation Office
Continuation Sheet

Site Number: 92-00392
Related District Number: 92-00350

Page 2

<u>Carl M. and Helen B. Keck House</u>	<u>Washington</u>
Name of Property	County
<u>522 W. Washington Blvd</u>	<u>Washington</u>
Address	City

dentils between the first story cornice and the second story floor. There is also a wood entry door with a wooden surround and a storm/screen door on the first story within the porch. A one-over-one-light double-hung window is found on the second story within the porch. The second story of the porch is enclosed with a spindle railing. The center section of the rear elevation is centered under the rear gable. It has two one-over-one-light double-hung windows on the first story. The second story also has two one-over-one-light double-hung windows, with the left/east one smaller with a higher than typical sill. The gable has a pair of one-over-one-light double-hung windows. The wall in this area is clad in wood shingles. The west end of the first story has an enclosed shed-roof section, located where the rear porch is shown on the 1909-1943 Sanborn maps. It has an entry with a door with a half round window at the top and a storm/screen door. There is a large deck with spindle railings across the rear of the house. Wood steps with spindle railings lead up to the deck.

A detached, two-car, frame garage built in 1990 per the assessor is located on the northwest corner of the property. The foundation is a concrete slab, and it is clad in vertical wood siding. The garage has a front-gabled roof with asphalt shingles and two modern overhead single-car metal garage doors. A driveway runs from the garage entrance (south side) to the street. There is an entry door with a half-light window and two rectangular windows on the east side.

Narrative Statement of Significance

The Carl M. and Helen B. Keck House appears to contribute historically and architecturally to the potential residential historic district on the west side of Washington. The Queen Anne house was built in 1897 during a period of development of the neighborhood in the late 19th century with large homes for successful businessmen. Carl M. Keck entered into the family banking business in the 1890s, rising to president of the Commercial Savings Bank by the 1920s. The Queen Anne house retains a number of historic and unique features, including the built-out gables with pointed arch openings, rounded two-story front bay window section, wood shingles, wood windows, and full front porch.

The house may also be individually eligible for listing on the National Register of Historic Places under Criterion B for its association with Carl M. Keck and/or Criterion C for its architecture. Further evaluation of the interior integrity, comparison with other Queen Anne homes, and research on Carl M. Keck would solidify those determinations.

History / research summary of property

This parcel is part of the larger Out Lot 1 that was platted in Western Addition for Joseph and Elizabeth Keck's house at 500 W. Washington Blvd. It is shown as part of that property on the 1874 and 1894 atlases of Washington. According to his obituary, Joseph Keck was born on November 29, 1819 in Huntington County, Pennsylvania. Joseph arrived in Washington, Iowa in 1842 and opened the first cabinet shop and worked the trade for eight years. He then entered real estate and banking. Joseph Keck formed a local bank in 1859 which was renamed and reorganized several times, ending up as First National Bank. His two sons, Charles and Irving, joined him at the bank, starting as tellers. Irving, the older son, went to Sigourney to open a bank, while Charles remained in Washington. Charles H. Keck became assistant cashier of the First National Bank in 1884, and he became vice president in

Iowa Site Inventory Form
State Historic Preservation Office
Continuation Sheet

Site Number: 92-00392
Related District Number: 92-00350

Page 3

<u>Carl M. and Helen B. Keck House</u>	<u>Washington</u>
Name of Property	County
<u>522 W. Washington Blvd</u>	<u>Washington</u>
Address	City

1890 ("Charles Keck Last of Early Bank Family," *Evening Journal*, May 4, 1955). On May 7, 1892, the Citizens Savings Bank was organized with Joseph Keck, president; Frank Stewart, vice, and Charles H. Keck, cashier (Burrell 1909, Vol. 1: 372). Carl was the son of Irving Keck, grandson of Joseph Keck. According to his obituary, he was born on March 15, 1869 in Washington, Iowa to Irving A. and Nancy (Campbell) Keck. Carl spent most of his early life in Sigourney and received his education there. His family moved to Bowling Green, Florida when he was 15. In Florida he was employed by the Florida Southern railway. He returned to Washington and entered the banking business founded by his grandfather, Joseph Keck. The *Washington Democrat* for September 16, 1891 announced that "Carl Keck and Miss Helen Burrell were married at the bride's home Thursday night, in the presence of relatives of the families." (Note: Helen Burrell's parents, Howard and Harriet Burrell, lived at 523 West Washington Blvd.). The 1894 city directory lists the Carl M. Keck living at 607 W. South Street (now Madison St). The 1895 census lists Carl M. Keck (28, cashier) and his wife Helen B. (25).

This Queen Anne house was then built in 1897. The *Evening Journal* noted on June 15, 1897 that "Excavation was begun today for the elegant residence which Carl Keck will build on West Washington St." It was then listed among the residences built in "Southwest Washington" in the December 20, 1897 year-end review of construction in the *Evening Journal*. The *Evening Journal* notes on August 16, 1899 that Mrs. Carl Keck entertained in her "beautiful home" with sister Anna Burrell. The 1900 census lists Carl M. (32, bank cashier), wife Helen (30), and daughter Harriett E. (2). They are listed immediately before Ella Dodds, who lived in the earlier house to the west at 530 W. Washington, and two households after Joseph Keck, who lived at 500 W. Washington. Thus, they are confirmed to be located on this block by 1900. Joseph Keck died on July 16, 1901. Keck's Addition was then platted to subdivide the larger property (Out lots 1 with Keck's house and Out Lot 2 to the west with Dodds' house). This house is located on Lot 11, which is the western lot along W. Washington in Out Lot 1, which was Joseph Keck's property. A transfer has not been located to Carl M. Keck, but it appears that he would have bought the lot prior to his grandfather's death, or built the house and then inherited the property. Lot 11 would have then been platted for/around his completed house. The first transfers for Keck's Addition in the transfer book date to 1902. The 1909 Sanborn map shows this house as relatively square with the rounded front section and full front porch. The Sanborn maps for 1917, 1931 and 1943 to show the same two story dwelling with a front porch and a porch on the back at 522 West Washington.

Carl M. Keck was involved in a number of community activities by the 1890s. In March 1893, a new Opera House Company was formed, with investors L.D. Robinson, A.N. Alberson, C.H. Wilson, O.E. Rork, Warren Moore, C.M. Keck, W.R. Beamer, E.N. Foster, I. Klein, J.A. Young, Winfield Smouse, George W. Stewart, Frank Stewart, W.A. Wilson, and F.L. Wilson. "The New Graham" opened on November 27, 1893 with Clara Morris performing (Fisher 1978: 413). The 1913 Anniversary Edition of the *Evening Journal* notes that the first efforts to establishing Sunset Park (at the west end of Washington/Jefferson) were made in spring 1899, with land on a long-term lease with the option to purchase. The directors for the original incorporation were Frank Stewart, Charles H. Keck, A.H. Wallace, Carl M. Keck, and H.A. Burrell. A number of improvements were made, with money raised from various performances, plays, and ice cream festivals. The land for the park was later purchased and donated to the City of Washington in 1904 ("Washington's Beautiful Parks, *Evening Journal*, April 26, 1913, 9).

Iowa Site Inventory Form
State Historic Preservation Office
Continuation Sheet

Site Number: 92-00392
 Related District Number: 92-00350

Page 4

Carl M. and Helen B. Keck House	Washington
Name of Property	County
522 W. Washington Blvd	Washington
Address	City

Carl M. and Helen B. Keck are listed in the 1903 and 1910-1911 city directories as living at 520 W. Washington (earlier numbering, now 522). In 1903, he is listed as a banker, and in 1910-11, he is listed a vice president of Citizens Saving Bank. In 1903, the First National Bank renewed its 20-year charter, renamed as the Citizens National Bank. Officers were C. H. Keck, president, Carl M. Keck, vice president, and Frank R. Sage, cashier (Burrell 1909, Vol. 1: 372). The reorganized bank was short-lived, merging into the Citizens Savings Bank in June 1908. At the time of the merger, officers were Charles H. Keck, president; Carl M. Keck, Frank Stewart, and Ira Sproull, vice-presidents; and Frank R. Sage, cashier (Burrell 1909, Vol. 1: 372). Ira Sproull was Charles H. Keck's brother-in-law. The 1910 census lists Carl M. (42, vice president bank), Helen B. (40), Harriett E. (12), and Howard Burrell (8). In 1912, the Citizens Savings Bank united with the Washington County Savings Bank, forming the Commercial Savings Bank. In 1913, officers were Charles H. Keck, president; Frank Stewart, vice president; C.M. Keck, vice president; S.W. Livingston, vice president; D.J. Ross, cashier; and George J. Breitenbach, assistant cashier. The 1917 city directory lists Carl M. Keck then as vice president of the Commercial Savings Bank. The 1920 census lists Carl M. Keck (51, vice president of bank), wife Helen (50), and son Burrell (18). Charles and Minnie Keck sold their house at 410 W. Washington in 1914, moving to California. By 1926, Carl M. Keck was president of the Commercial Savings Bank. In 1926, he also was vice president of the Washington Loan and Trust Company, with Frank R. Sage as president. The company was formed in 1912 and took over the remainder of loans of Washington Building and Loan Association. The Home Builders Loan Department was organized in 1914, and the bond department was organized in 1919 (*Washington Evening Journal*, April 3, 1926, 19, 40). The 1930 census lists Carl M. Keck (62, president of bank) and wife Helen (60) at 522 W. Washington, and the home is valued at \$5,000. The 1935 city directory likewise list Carl and Helen Keck at 522 W. Washington.

Carl M. Keck died on July 5, 1937. His obituary notes that Mr. Keck was a prominent banker, served as vice president of the Iowa State Banker's Association and as secretary and president of the southeastern group of the state bankers' organization. He was connected with the income and corporation tax division of the state board of assessment and review in the state house at Des Moines. He was a member of the Washington County Hospital Board, Methodist Church, the Knights of Pythias Lodge, the Rotary Club, the Commercial Club and many business men's organizations. He helped organize the Washington Country Club. Helen (Burrell) Keck later died on October 17, 1964, age 95, at the Pines Nursing Home. According to her obituary, Helen was born September 10, 1869 in Washington to Howard and Harriett (Everson) Burrell. She was a member of the Seventh Day Adventist Church. At the time of her death, her home was 401 East Jefferson St.

In the 1940 Federal Census, William R. and Harriet H. Gross are shown as renting 522 West Washington. William is 47 years old, born in Iowa, lived in Grinnell in 1935 and worked as a petrol salesman. Harriet is 47 years old and born in Iowa. Their daughter Mildred was 22, born in Iowa, and worked as a public school teacher. The Gross family is also listed in the 1941 city directory as renters at 522. William is shown as a salesman for Standard Oil Company.

Helen B. Keck then sold the property to Florence M. Durst on October 15, 1945. The estate of Florence Durst transferred full interest in the property to Hilda Durst (her daughter) on December 18, 1950. Hilda Durst then sold it to Harold and Helen Durst on January 10, 1951 (Harold was the son of Florence Durst). Harold A. and Helen R. Durst are listed at 522 W. Washington in the City Directories from 1952 through 1976. Harold is listed as a teacher through the 1950s and 1960s, and he is then

Iowa Site Inventory Form
State Historic Preservation Office
Continuation Sheet

Site Number: 92-00392
Related District Number: 92-00350

Page 5

<u>Carl M. and Helen B. Keck House</u>	<u>Washington</u>
Name of Property	County
<u>522 W. Washington Blvd</u>	<u>Washington</u>
Address	City

listed as retired in the 1972 directory. Harold A. Durst died on May 3, 1980. According to his obituary, he was a retired farmer, school teacher and city building inspector. Mr. Durst was born in Washington County, on June 25, 1904 to Arthur C. and Florence M. (Snider) Durst. He attended school in Washington, and later Iowa State University and graduated from Iowa Wesleyan College in 1928. He married Helen Rothenstein Hackert at Rapid City, SD on August 17, 1935. Harold was a member of the United Methodist Church and the Washington Masonic Lodge

The property transferred from the Harold A. Durst Estate to Helen Durst on January 13, 1981. She continued to lived here. Helen LaRue Rothenstein Durst died on January 16, 1988. According to her obituary, she was born on February 20, 1900 in Floris, Davis County to Philip and Linnie (Truitt) Rothenstein. She was educated in Davis County schools. Helen was a member of the D.A.R., ZTA Sorority, the Masonic Lodge and the United Methodist Church. She lived in Washington since 1950.

The property transferred from Helen R. Durst Estate to Roy D. and Diane M. Evanovich on July 23, 1987, who owned it until 2006. Dale and Candace Scheibe recently bought the house on May 26, 2015 and are the current property owners.

Iowa Site Inventory Form
State Historic Preservation Office
Continuation Sheet

Site Number: 92-00392
Related District Number: 92-00350

Page 6

Carl M. and Helen B. Keck House	Washington
Name of Property	County
522 W. Washington Blvd	Washington
Address	City

Bibliography

Atlas of Washington County, Iowa. Clinton, IA, and Philadelphia, PA: Harrison and Warner, 1874.

Atlas of Washington County, Iowa. No publisher noted, 1894. In collection of Washington Public Library.

Burrell, Howard A. *History of Washington County, Iowa.* Chicago, IL: S.J. Clarke Publishing Company, 1909. 2 volumes.

City/telephone directories. Washington Public Library. Various years, including 1894, 1903, 1908, 1910-11, 1917, 1932, 1934, 1935, 1938, 1941, 1952, 1954, 1956, 1958, 1960, 1962, 1964, 1967, 1969, 1972, and 1976.

Fisher, Kathy. *In the beginning there was land : a history of Washington County, Iowa.* Washington, Iowa: Washington County Historical Society, 1978.

History of Washington County, Iowa. Des Moines, IA: Union Historical Co., 1880.

Koch, Augustus. *Birds-eye View of the City of Washington.* Chicago: Chicago Lithograph Company, 1869.

Newspapers, including anniversary/celebration editions on microfilm and/or bound at Washington Public Library:

Washington Gazette, January 6, 1893

Twentieth Anniversary Edition, *Evening Journal*, April 26, 1913

Twenty-Fifth Anniversary Edition, *Evening Journal*, April 3, 1926

Washington County Centennial Edition, *Evening Journal*, July 1936

Souvenir Edition of Washington Centennial, *The Evening Journal*, August 1939

Sixtieth Anniversary Edition, *The Washington Evening Journal*, February 27, 1953

Bicentennial edition, *The Washington Evening Journal*, July 1, 1976

Sesquicentennial edition, *The Washington Evening Journal*, April 13, 1989

Patterson, Mary. Collection of historic postcards, images, and city/telephone directories. Washington, Iowa. Accessed 2014-2015.

Portrait and Biographical Album of Washington County, Iowa. Chicago, Acme Publishing Company, 1887.

Sanborn Map Company. *Washington, Iowa.* Fire insurance maps. 1885, 1892, 1897, 1902, 1909, 1917, 1931, 1943.

Souvenir History of Washington, Iowa. Washington, IA: Washington Evening Journal, June 23, 1989.

Washington County Historical Society. Collection of historic postcards and photographs.

Iowa Site Inventory Form
State Historic Preservation Office
Continuation Sheet

Site Number: 92-00392
Related District Number: 92-00350

Page 7

Carl M. and Helen B. Keck House
Name of Property

Washington
County

522 W. Washington Blvd
Address

Washington
City

Location map



2009 aerial photograph (Washington County) – line indicates survey/research area boundary

Iowa Site Inventory Form
State Historic Preservation Office
Continuation Sheet

Site Number: 92-00392
Related District Number: 92-00350

Page 8

Carl M. and Helen B. Keck House

Washington

Name of Property

County

522 W. Washington Blvd

Washington

Address

City

Building plan (from assessor's website)

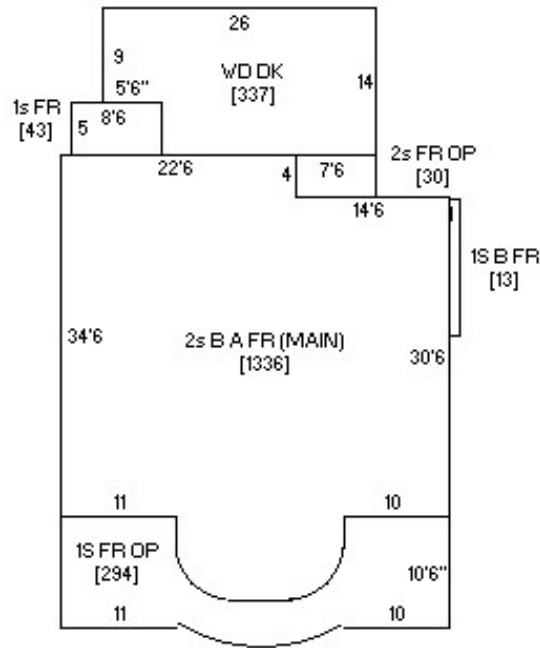

Photo from assessor's website



Iowa Site Inventory Form
State Historic Preservation Office
Continuation Sheet

Site Number: 92-00392
Related District Number: 92-00350

Page 9

Carl M. and Helen B. Keck House
Name of Property

Washington
County

522 W. Washington Blvd
Address

Washington
City

Digital photographs



Photograph 92-00392-001 - House, looking northeast (December 2014)

Iowa Site Inventory Form
State Historic Preservation Office
Continuation Sheet

Site Number: 92-00392
Related District Number: 92-00350

Page 10

Carl M. and Helen B. Keck House

Name of Property

Washington

County

522 W. Washington Blvd

Address

Washington

City



Photograph 92-00392-002 - House, looking northwest (December 2014)

Iowa Site Inventory Form
State Historic Preservation Office
Continuation Sheet

Site Number: 92-00392
Related District Number: 92-00350

Page 11

Carl M. and Helen B. Keck House

Name of Property

Washington

County

522 W. Washington Blvd

Address

Washington

City



Photograph 92-00392-003 - House, looking southwest (December 2014)

Iowa Site Inventory Form
State Historic Preservation Office
Continuation Sheet

Site Number: 92-00392
Related District Number: 92-00350

Page 12

Carl M. and Helen B. Keck House

Name of Property

Washington

County

522 W. Washington Blvd

Address

Washington

City



Photograph 92-00392-004 - House, looking north (December 2014)