

Iowa Site Inventory Form

State Historic Preservation Office

(July 2014)

State Inventory Number: 92-00394 New Supplemental

9-Digit SHPO Review & Compliance (R&C) Number: _____

Non-extant Year: _____

Read the Iowa Site Inventory Form Instructions carefully, to ensure accuracy and completeness before completing this form. The instructions are available on our website: <http://www.iowahistory.org/historic-preservation/statewide-inventory-and-collections/iowa-site-inventory-form.html>

• **Property Name**

A) Historic name: Wesley and Maria Smith House

B) Other names: West side survey map #WS-070

• **Location**

A) Street address: 602 W. Washington Blvd

B) City or town: Washington (Vicinity) County: Washington

C) Legal description:

Rural: Township Name: _____ Township No.: _____ Range No.: _____ Section: _____ Quarter: _____ of Quarter: _____

Urban: Subdivision: Keck's Subdivision Block(s): _____ Lot(s): Lot 09 and E 4.5' of Lot 8

• **Classification**

A) Property category: *Check only one*

- Building(s)
- District
- Site
- Structure
- Object

B) Number of resources (within property):

If eligible property, enter number of:		If non-eligible property, enter number of:	
Contributing	Noncontributing		
<u>2</u>	Buildings	—	Buildings
—	Sites	—	Sites
—	Structures	—	Structures
—	Objects	—	Objects
<u>2</u>	Total	—	Total

C) For properties listed in the National Register:

National Register status: Listed De-listed NHL NPS DOE

D) For properties within a historic district:

- Property contributes to a National Register or local certified historic district.
- Property contributes to a potential historic district, based on professional historic/architectural survey and evaluation.
- Property *does not* contribute to the historic district in which it is located.

Historic district name: West side residential historic district Historic district site inventory number: 92-00350

E) Name of related project report or multiple property study, if applicable:

MPD title

Historical Architectural Data Base #

Architectural and Historical Survey of the "west side" residential neighborhood in Washington 92-013

• **Function or Use** *Enter categories (codes and terms) from the Iowa Site Inventory Form Instructions*

A) Historic functions

01A01: Domestic / residence

01C05: Domestic/garage

B) Current functions

01A01: Domestic / residence

01C05: Domestic/garage

• **Description** *Enter categories (codes and terms) from the Iowa Site Inventory Form Instructions*

A) Architectural classification

09A06: Foursquare

B) Materials

Foundation (visible exterior): 04: Stone

Walls (visible exterior): 05E: Aluminum

Roof: 08A: Asphalt shingles

Other: _____

C) Narrative description **SEE CONTINUATION SHEETS, WHICH MUST BE COMPLETED**

• **Statement of Significance**

A) Applicable National Register Criteria: *Mark your opinion of eligibility after applying relevant National Register criteria*

- Criterion A: Property is associated with significant events. Yes No More research recommended
 Criterion B: Property is associated with the lives of significant persons. Yes No More research recommended
 Criterion C: Property has distinctive architectural characteristics. Yes No More research recommended
 Criterion D: Property yields significant information in archaeology/history. Yes No More research recommended

B) Special criteria considerations: *Mark any special considerations; leave blank if none*

- A: Owned by a religious institution or used for religious purposes. E: A reconstructed building, object, or structure.
 B: Removed from its original location. F: A commemorative property.
 C: A birthplace or grave. G: Property less than 50 years of age or achieved significance within the past 50 years.
 D: A cemetery

C) Areas of significance

Enter categories from instructions

Community planning and development

D) Period(s) of significance

E) Significant dates

Construction date

1908 *check if circa or estimated date*

Other dates, including renovations

F) Significant person

Complete if Criterion B is marked above

G) Cultural affiliation

Complete if Criterion D is marked above

H) Architect/Builder

Architect

Builder/contractor

I) Narrative statement of significance *SEE CONTINUATION SHEETS, WHICH MUST BE COMPLETED*

• **Bibliography** *See continuation sheets for the list of research sources used in preparing this form*

• **Geographic Data** *Optional UTM references* *See continuation sheet for additional UTM or comments*

Zone	Easting	Northing	NAD	Zone	Easting	Northing	NAD
1	_____	_____	_____	2	_____	_____	_____
3	_____	_____	_____	4	_____	_____	_____

• **Form Preparation**

Name and Title: Joanne L. Breen - volunteer Rebecca Lawin McCarley, consultant Date: December 30, 2015

Organization/firm: Washington Historic Preservation Commission E-mail: -

Street address: City Hall, 215 E, Washington St Telephone: 319-653-6584

City or Town: Washington State: Iowa Zip code: 52353

• **ADDITIONAL DOCUMENTATION** *Submit the following items with the completed form*

A) For all properties, attach the following, as specified in the Iowa Site Inventory Form Instructions:

1. **Map** of property's location within the community.
2. **Glossy color 4x6 photos labeled** on back with property/building name, address, date taken, view shown, and unique photo number.
3. **Photo key showing each photo number on a map and/or floor plan, using arrows next to each photo number to indicate the location and directional view of each photograph.**
4. **Site plan** of buildings/structures on site, identifying boundaries, public roads, and building/structure footprints.

B) For State Historic Tax Credit Part 1 Applications, historic districts and farmsteads, and barns:

See lists of special requirements and attachments in the Iowa Site Inventory Form Instructions.

State Historic Preservation Office (SHPO) Use Only Below This Line

The SHPO has reviewed the Site Inventory and concurs with above survey opinion on National Register eligibility:

- Yes No More research recommended
 This is a locally designated property or part of a locally designated district.

Comments: _____

SHPO authorized signature: _____ Date: _____

Iowa Site Inventory Form
State Historic Preservation Office
Continuation Sheet

Site Number: 92-00394
Related District Number: 92-00350

Page 1

Wesley and Maria Smith House

Name of Property

Washington

County

602 W. Washington Blvd

Address

Washington

City

Narrative Description

This is a two-story, frame, hip-roof, Foursquare house built around 1908 on the north side of West Washington Boulevard. The house sits on a stone foundation, and the walls are clad in aluminum siding. The hip roof is covered in asphalt shingles and has wood eaves with curved brackets around the whole house. All windows retain wood surrounds and wood sashes, and they have storms/screens on the windows. There is an open full porch on the front. A detached frame garage, built around 1950, is behind the house (west side) and is accessed from the street.

The façade (south elevation) is spanned by a full porch with four round columns supporting a hip roof with wood eaves. A wood railing runs between the columns. The area under the wood porch floor has wood lattice. Wood stairs lead up to the porch. On the first story of the house, there is a centered entry with a wood door with a large window and a storm/screen door. There are paired one-over-one-light double-hung windows to the west/left and to the east/right. On the second story, there are single one-over-one-light double-hung windows to the west/left and to the east/right. A small octagon window is in the center of the second story. On the roof, there is a gable-roof dormer with paired one-over-one-light double-hung windows. The dormer has asphalt shingles and wood eaves with curved brackets, which extend out along the front of the dormer as well.

The east elevation has a bay window on the south/left portion of the first story. It has three one-over-one-light double-hung windows and a hip roof with asphalt shingles. The north/right half has a group of three one-over-one-light double-hung windows. On the second story, there are three one-over-one-light windows, evenly spaced across the side. On the roof, there is a hip roof dormer with paired one-over-one-light double-hung windows. The dormer has asphalt shingles and wood eaves with curved brackets. At the basement level, there are two windows in the stone foundation.

The west elevation has an entry at the ground level in the center with a full light storm door. There is a shed-roof metal awning above the door. There is a one-over-one-light double-hung window on the first story to the south/right, and no windows to the left/north. Two basement windows are found to the right/south, and one basement window is to the left/north. On the second story, there are three one-over-one-light double-hung windows, evenly spaced across the side. On the roof, there is a hip roof dormer with paired one-over-one-light double-hung windows. The dormer has asphalt shingles and wood eaves with curved brackets.

The rear of the house (north elevation) has a one-story hip-roof frame addition on the west half. There are two sliding glass doors on the rear (west side) of the addition. The west wall of the addition has paired one-over-one-light double-hung windows. On the first story, there is an entry, near the center just east/left of the hip-roof section, with a wood door with three windows and a storm door. On the east/left, there is a horizontal window with decorative stained glass. On the second story, there is a one-over-one-light double-hung window on the west/right and on the east/left, with a smaller one-over-one-light double-hung window between them. There is a basement window on the east/left section. There is a wooden deck with wooden railings on the rear that is accessed from the center entry door and the sliding glass doors from the addition. Wood steps with railings lead to the deck.

A detached-frame double-car garage built in 1950 (per the assessor) is located on the northwest corner of the property. The foundation is a concrete slab, and it is clad in aluminum siding. The garage has a

Iowa Site Inventory Form
State Historic Preservation Office
Continuation Sheet

Site Number: 92-00394
Related District Number: 92-00350

Page 2

Wesley and Maria Smith House	Washington
Name of Property	County
602 W. Washington Blvd	Washington
Address	City

front-gabled roof with asphalt shingles and two single overhead garage doors on the south side. There is a window on west side and a window on the east side. A driveway runs from the garage entrance (south side) to the street.

Narrative Statement of Significance

The Wesley and Maria Smith House appears to contribute historically and architecturally to the potential residential historic district on the west side of Washington. The house was built during the early 20th century development of the neighborhood with large homes for successful businessmen and retired farmers. The house retains a number of characteristic features of Foursquare homes, including the overall cubical form, wide eaves with brackets, dormers, and a full front porch.

The house does not appear to be individually eligible for listing on the National Register of Historic Places under Criteria A, B, or C. The house does not appear to have particular architectural or historical significance.

History / research summary of property

This parcel is part of the larger Out Lot 2 that was platted in Western Addition for John and Ella Dodds' house, west of Joseph Keck's house at 500 W. Washington Blvd on Out Lot 1. It is shown as part of that property on the 1874 and 1894 atlases of Washington. Keck's Addition was then platted in November 1902 to subdivide the larger property (Out lots 1 and 2), and this new lot 9 was platted immediately west of the earlier Dodds house shown on the east portion of Out Lot 2 (site of 530 W. Washington) on the 1894 map. John Dodds died in 1900, and Ella Dodds is listed as living at 602 W. Washington in the 1903 city directory (now 530 W. Washington). In early 1902, she subdivided her property to the west, creating two additional lots along Washington Blvd. The *Press* reported on January 15, 1902 that C.N. Stewart had bought Mrs. John Dodds' middle lot, for \$1,000, and will build on the Ridge, sooner or later. On May 12, 1902, the *Press* noted that Mrs. Ella Dodds will move her home on Gospel Ridge a little to the east and south, as it is partly on the lot sold to C.N. Stewart (her earlier house ended up on the lot platted as Lot 10 in Keck's Addition). However, the 1903 city directory continues to list C.N. Stewart as a nurseryman living at 204 E. 7th Street, with no other Stewarts living in this location on Washington. A quit claim deed dated on December 21, 1903 (but not filed until December 1904) transferred this property (noted as part of Lot 2 in Western Addition) from C.N. Stewart to W.L. Stewart (relationship unknown). Charles N. Stewart died in December 1904, likely spurring filing of the earlier deed. His obituary on December 14, 1904 notes that he was a nurseryman on E. 7th St for many years, married to Mary Lavarie Brown. His children were Gertrude Bowman, Adelbert (Del), and Oleta Stewart. On October 8, 1907, A.T. Stewart et al (heirs of C.N. Stewart) sold the property to Wesley Smith (described yet as 66' west of southeast corner of out lot 2 in Western Addition; then Lot 9 in Keck's Addition). While it is possible that Smith bought an earlier house built by the Stewart family, it has not been confirmed that a house was on this lot by 1907. Thus, this house at 602 W. Washington is noted as built by Wesley Smith around 1908.

The May 1909 Sanborn map shows this square house with a full front porch and an outbuilding at the northwest corner of the lot, confirming construction by this date. Wesley Smith then acquired the lot to

Iowa Site Inventory Form
State Historic Preservation Office
Continuation Sheet

Site Number: 92-00394
Related District Number: 92-00350

Page 3

<u>Wesley and Maria Smith House</u>	<u>Washington</u>
Name of Property	County
<u>602 W. Washington Blvd</u>	<u>Washington</u>
Address	City

the west in August 1909 from Jeannette Simmons (67' east from southwest corner of out lot 2; then Lot 8 in Keck's Addition). He later sold off the west 58' of Lot 8 in May 1912, retaining the east 4.5' with Lot 9 and this house at 602 W. Washington. Wesley and Maria Smith continued to live in this house at 602 W. Washington at this time. Wesley Smith is listed as a retired farmer in the 1910-1911 City Directory at 1120 W. Washington. However, Wesley and Maria Smith are listed in the 1910 U.S. Federal Census at 606 W. Washington Blvd (earlier numbering, now 602) and own the home, free of a mortgage. Wesley is 65 years old, born in Ohio, married 40 years and profession states "own income". Maria is 62 years old, born in Iowa, married 40 years, and has one child. Maria Smith died on September 29, 1912. According to her obituary and other Ancestry.com records, she was born in 1948 in Washington to William Warner and Rebecca Ann (Jackson) Wells. Wesley Smith later died on December 19, 1932. According to his obituary, he was born October 25, 1844 in Ohio to Benjamin and Hettie Smith. They were one of the pioneer families of Dutch Creek Township, coming to Washington County when he was a boy. Wesley married Maria Wells on December 27, 1869. They lived on a farm in Dutch Creek until 1908 when they moved to Washington. Mr. Smith lived in Washington until 1920 when he moved to Medford, Oregon to live with his son Sidney. He returned to Washington a year before his death in 1932.

The property transferred from Wesley Smith (widower) to Ruth Wanda Winter, et. al. on October 22, 1912; then from Ruth Winter to Boyd B. and Carrie M. (Winter) Berdo on September 18, 1914; then from the Berdos to Fannie F. (Winter) Shinabarger on December 18, 1916; and then from Shinabarger to Boyd B. Berdo on May 15, 1918. Ruth Winter, Carrie Berdo, and Fannie (Frances) Shinabarger were sisters. After review of the 1915 Iowa State Census and the 1917 City Directory, it appears none of them lived in the house. According to their obituaries and a biographical sketch in the 1906 Atlas for Washington County, the Winter sisters and a brother Charles were born between 1886-1889, in Washington, to Enoch and Ada (Hollingsworth) Winter. Their mother died in 1894 and their father died in 1896. The Winter children went to live with their grandparents, Dr. William and Mary Ann (Singmaster) Hollingsworth, who lived at 611 W. Washington Blvd. Boyd Berdo was born in 1887 in Iowa to Thomas J. and Chattie (Wright) Berdo. According to the 1915 Iowa State Census, Boyd was a banker. The 1917 Sanborn map reflects the same house and outbuilding at 606 West Washington.

The property transferred from Boyd B. and Carrie Berdo to Frank J. McKay on February 24, 1919. The 1920 census lists Frank and Hattie McKay at 606 W. Washington (now 602). Frank is 50 years old, born in Illinois, married and no occupation is identified. Hattie is 47 years old, born in Iowa and married. The 1926 telephone directory then lists them at 602 W. Washington. The 1930 census also lists them at 602 W. Washington, and the house is valued at \$6,000. Frank is 61 years old, married at age 21, and his occupation is a farmer. Hattie is 58 years old and married at age 18. They are also listed in the 1932 city directory living at 602 W. Washington. The house value is listed as \$6,000. The 1931 Sanborn map reflects the same house and detached outbuilding, now noted as an auto garage, at 602 W. Washington. Hattie died in 1933. Frank J. McKay later died on December 11, 1954. According to his obituary, he was born July 14, 1869 in Hamlet, Illinois to Frank J. and Fannie (Brumly) McKay. The family lived in Kansas and then came to Washington. Frank married Hattie L. Rickabaugh on November 6, 1890. He farmed until 1919 and moved to town where he worked as a nurse for many years. He was a member of the Methodist church. In 1952 Frank went to Packwood, Jefferson County, Iowa to live with his son Charles, and died there.

Iowa Site Inventory Form
State Historic Preservation Office
Continuation Sheet

Site Number: 92-00394
Related District Number: 92-00350

Page 4

Wesley and Maria Smith House	Washington
Name of Property	County
602 W. Washington Blvd	Washington
Address	City

The property transferred from Frank J. McKay to Charles C. McKay on October 31, 1933. The 1935, 1938, 1941 City directories and the 1940 U.S. Federal Census reflect that different people rented the house at 602 West Washington. In 1935, Mrs. Florence White, who worked as a bookkeeper at Nicola & Harmon, and Frank and Jeannette Hynek lived there. Frank was meat department manager at the A&P. In 1938, R.S. Schiekelman lived there. Per the 1940 census, Jacob (60, farm owner) and Mary (58) Fisher lived at 602 W. Washington with daughter Francis (20, stenographer for telephone co), and Bessie A. Brown (56, widow, seamstress at home) and daughter Maye Belle Brown (21, switchboard operator for telephone co) lived at 602½ W. Washington. In 1941, E. L. and Effie Sharpe, and Miss Pauline Wittmer, Robert (15) and Richard (5) Wittmer lived at 602. E. L. Sharpe worked at Oetjen seed store, and Pauline Wittmer worked as a waitress at Gidley Café. Mrs. Bessie Brown and Miss Maye Bell Brown lived at 602½ W. Washington. Bessie Brown was a widow and housekeeper; and May Bell was a telephone operator at Continental Telephone Company. The 1943 Sanborn map reflects the same house and detached auto garage at 602 West Washington.

The property transferred from Charles C. McKay and wife to Wayne A. and Evelyn Simerman on February 19, 1944 and from the Simermans to W.S. and Jennie V. Eldridge on March 28, 1945. The 1952 and 1954 city directories list W. S. Eldridge living at 602 W. Washington. William S. Eldridge died on March 4, 1954. According to his obituary, William was a life-long resident of Washington County, and his home was at 602 West Washington Street. He was born on October 17, 1868 on a farm north of Washington to John and Kate (Souter) Eldridge. He was educated in Washington schools and at the Omaha Business college. William married Jennie V. McCausland on December 24, 1890. Mr. Eldridge served on the Washington city council for 25 years. He was city clerk for a short time. For a number of years, he farmed. He was in the grocery and elevator business with the late D. A. Chambers. He was in the real estate business a number of years. He was a member of the United Presbyterian Church. The 1956, 1958, and 1960 city directories list Mrs. W. S. Eldridge living there.

The property transferred from Jennie Eldridge (widow) back to Evelyn and Wayne Simerman on February 14, 1961. Evelyn is the daughter of William and Jennie Eldridge. Jennie V. Eldridge died on August 22, 1965. According to her obituary, Jennie was born July 5, 1872 in Cherokee County, Kansas to Hugh and Liza (Sweeney) McCausland. The family moved to the Living Lake Community northeast of Washington when she was 2 years old and she was reared there. She attended Washington Academy. She was a member of the Marion Avenue United Presbyterian Church. Her address was 602 W. Washington Street when she died. The 1962, 1964, and 1967 city directories list Wayne and Evelyn Simerman at 602 West Washington as well. Wayne is identified as retired. .

The property transferred from the Simermans to John S. and Mary Ellen Thatcher on June 26, 1968. The 1969 city directory lists John S. and Mary E. Thatcher and children Lonnie ('63) and Debbie ('67) living at 602 West Washington. John is working as a merchandising consultant for Van Heusen.

The property transferred from the Thatchers to Donald J. and Elizabeth A. Miller in August 1970. The 1972 city directory lists Donald J. and Bette A. Miller and son Mark ('58) living at 602 West Washington. Donald is working as a plant manager at Perfex Inc.

The property transferred from the Millers to Lawrence R. and Margaret A. Stark on January 7, 1974. 1976 city directory lists Larry and Margaret Stark at 602 West Washington. Larry is working as a store manager at Gibson Discount.

Iowa Site Inventory Form
State Historic Preservation Office
Continuation Sheet

Site Number: 92-00394
Related District Number: 92-00350

Page 5

Wesley and Maria Smith House	Washington
Name of Property	County
602 W. Washington Blvd	Washington
Address	City

The property transferred from the Starks to Ernest M. Jr. and Karen P. Wagner on November 17, 1976. The property transferred from Karen P. Wagner to Robert R. and Peggy S. Helscher on February 7, 1992; from the Helschers to Shane E. and Katherine A. Gross on April 4, 2004; and from the Gross' to James E. and Julie A. Ross on July 5, 2006. The Ross' are the current owners (2015)

Bibliography

Atlas of Washington County, Iowa. Clinton, IA, and Philadelphia, PA: Harrison and Warner, 1874.

Atlas of Washington County, Iowa. No publisher noted, 1894. In collection of Washington Public Library.

Burrell, Howard A. *History of Washington County, Iowa.* Chicago, IL: S.J. Clarke Publishing Company, 1909. 2 volumes.

City/telephone directories. Washington Public Library. Various years, including 1894, 1903, 1908, 1910-11, 1917, 1932, 1934, 1935, 1938, 1941, 1952, 1954, 1956, 1958, 1960, 1962, 1964, 1967, 1969, 1972, and 1976.

Fisher, Kathy. *In the beginning there was land : a history of Washington County, Iowa.* Washington, Iowa: Washington County Historical Society, 1978.

History of Washington County, Iowa. Des Moines, IA: Union Historical Co., 1880.

Newspapers, including anniversary/celebration editions on microfilm and/or bound at Washington Public Library:

Washington Gazette, January 6, 1893

Twentieth Anniversary Edition, *Evening Journal*, April 26, 1913

Twenty-Fifth Anniversary Edition, *Evening Journal*, April 3, 1926

Washington County Centennial Edition, *Evening Journal*, July 1936

Souvenir Edition of Washington Centennial, *The Evening Journal*, August 1939

Sixtieth Anniversary Edition, *The Washington Evening Journal*, February 27, 1953

Bicentennial edition, *The Washington Evening Journal*, July 1, 1976

Sesquicentennial edition, The Washington Evening Journal, April 13, 1989

Patterson, Mary. Collection of historic postcards, images, and city/telephone directories. Washington, Iowa. Accessed 2014-2015.

Portrait and Biographical Album of Washington County, Iowa. Chicago, Acme Publishing Company, 1887.

Sanborn Map Company. *Washington, Iowa.* Fire insurance maps. 1885, 1892, 1897, 1902, 1909, 1917, 1931, 1943.

Iowa Site Inventory Form
State Historic Preservation Office
Continuation Sheet

Site Number: 92-00394
Related District Number: 92-00350

Page 6

Wesley and Maria Smith House

Washington

Name of Property

County

602 W. Washington Blvd

Washington

Address

City

Souvenir History of Washington, Iowa. Washington, IA: Washington Evening Journal, June 23, 1989.

Washington County Historical Society. Collection of historic postcards and photographs.

Location map



2009 aerial photograph (Washington County) – line indicates survey/research area boundary

Iowa Site Inventory Form
State Historic Preservation Office
Continuation Sheet

Site Number: 92-00394
Related District Number: 92-00350

Page 7

Wesley and Maria Smith House

Washington

Name of Property

County

602 W. Washington Blvd

Washington

Address

City

Building plan (from assessor's website)

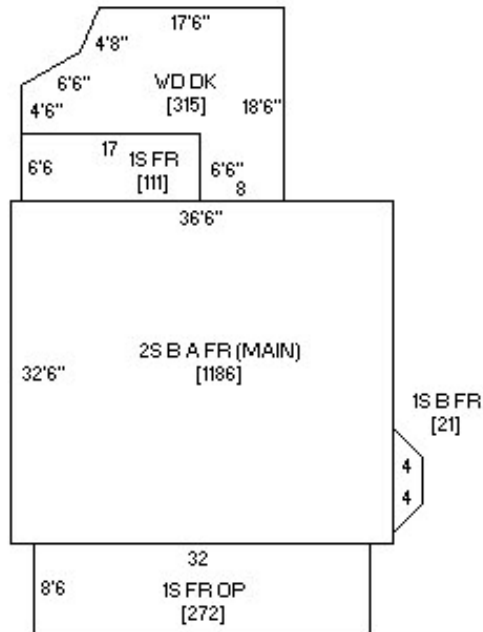

Photo from assessor's website



Iowa Site Inventory Form
State Historic Preservation Office
Continuation Sheet

Site Number: 92-00394
Related District Number: 92-00350

Page 8

Wesley and Maria Smith House
Name of Property

Washington
County

602 W. Washington Blvd
Address

Washington
City

Digital photographs



Photograph 92-00394-001 - House, looking northwest (December 2014)

Iowa Site Inventory Form
State Historic Preservation Office
Continuation Sheet

Site Number: 92-00394
Related District Number: 92-00350

Page 9

Wesley and Maria Smith House

Name of Property

Washington

County

602 W. Washington Blvd

Address

Washington

City



Photograph 92-00394-002 - House, looking northeast (December 2014)

Iowa Site Inventory Form
State Historic Preservation Office
Continuation Sheet

Site Number: 92-00394
Related District Number: 92-00350

Page 10

Wesley and Maria Smith House
Name of Property

Washington
County

602 W. Washington Blvd
Address

Washington
City



Photograph 92-00394-003 - House, looking south (December 2014)

Iowa Site Inventory Form
State Historic Preservation Office
Continuation Sheet

Site Number: 92-00394
Related District Number: 92-00350

Page 11

Wesley and Maria Smith House

Name of Property

Washington

County

602 W. Washington Blvd

Address

Washington

City



Photograph 92-00394-004 - Garage, looking north (December 2014)