

Site Number: 92-00802 Address: 906 W. Main Street City: Washington County: Washington District Number: _____

• **Statement of Significance**

A) Applicable National Register Criteria: *Mark your opinion of eligibility after applying relevant National Register criteria*

- Criterion A: Property is associated with significant events. Yes No More research recommended
- Criterion B: Property is associated with the lives of significant persons. Yes No More Research Recommended
- Criterion C: Property has distinctive architectural characteristics. Yes No More Research Recommended
- Criterion D: Property yields significant information in archeology/history. Yes No More Research Recommended

B) Special criteria considerations: *Mark any special considerations; leave blank if none*

- A Owned by a religious institution or used for religious purposes. E A reconstructed building, object, or structure.
- B Removed from its original location. F A commemorative property.
- C A birthplace or grave. G Less than 50 years of age or achieved significance within the past 50 years.
- D A cemetery

C) Areas of Significance

Enter categories from instructions

Community planning and development

D) Period(s) of significance

E) Significant dates

Construction date

2004 *check if circa or estimated date*

Other dates, including renovations

F) Significant person

Complete if Criterion B is marked above

G) Cultural affiliation

Complete if Criterion D is marked above

H) Architect/Builder

Architect

Builder/contractor

I) Narrative statement of significance **SEE CONTINUATION SHEETS, WHICH MUST BE COMPLETED**

• **Bibliography** *See continuation sheet for the list of research sources used in preparing this form*

• **Geographic Data** *Optional UTM references* *See continuation sheet for additional UTM references or comments*

UTM References (OPTIONAL)

Zone	Easting	Northing	NAD	Zone	Easting	Northing	NAD
1	_____	_____	_____	2	_____	_____	_____
3	_____	_____	_____	4	_____	_____	_____

• **Form Preparation**

Name and Title: Mary Patterson - volunteer Rebecca Lawin McCarley, consultant Date: March 16, 2015

Organization/firm: Washington Historic Preservation Commission E-mail: -

Street address: City Hall, 215 E. Washington St Telephone: 319-653-6584

City or Town: Washington State: Iowa Zip code: 52353

• **ADDITIONAL DOCUMENTATION** *Submit the following items with the completed form*

A) For all properties, attach the following, as specified in the Iowa Site Inventory Form Instructions:

1. **Map** of property's location within the community.
2. **Glossy color 4x6 photos labeled** on back with property/building name, address, date taken, view shown, and unique photo number.
3. **Photo key showing each photo number on a map and/or floor plan, using arrows next to each photo number to indicate the location and directional view of each photograph.**
4. **Site plan** of buildings/structures on site, identifying boundaries, public roads, and building/structure footprints.

B) For State Historic Tax Credit Part 1 Applications, historic districts and farmsteads, and barns:

See lists of special requirements and attachments in the Iowa Site Inventory Form Instructions.

State Historic Preservation Office (SHPO) Use Only Below This Line

The SHPO has reviewed the Site Inventory and concurs with above survey opinion on National Register eligibility:

- Yes No More Research Recommended
- This is a locally designated property or part of a locally designated district.*

Comments: _____

SHPO authorized signature: _____ Date: _____

Iowa Site Inventory Form
State Historic Preservation Office
Continuation Sheet

Site Number: 92-00802
Related District Number: _____

Page 1

<u>Jeffrey and Lisa Wenger House</u>	<u>Washington</u>
Name of Property	County
<u>906 W. Main Street</u>	<u>Washington</u>
Address	City

Narrative Description

This is a one story frame ranch house built on the north side of W. Main Street in 2003-04. The house sits on a poured concrete foundation, and it is clad with vinyl siding. The hip roof is covered with asphalt shingles. The windows are vinyl casement style with vinyl surrounds. There is an attached two car garage.

The façade, the south elevation, is divided into four sections. The section at the far left protrudes about a foot from the rest of the façade, and there is a centered pair of vinyl casement windows. To the right, stepped back about a foot, the second section contains a matching pair of vinyl casement windows. The entry door is located in an inset area in the third section, and it has a low concrete step and stoop nestled between the wall of the second section and the wall of the fourth section, the attached garage. The steel entry door has a semicircular fixed light at the top of the door. The fourth section, the attached garage, protrudes somewhat, and is accessed from W. Main Street. It has a double aluminum garage door facing the street.

The west elevation has no fenestration. The house sits on a rear sloping lot, and vinyl siding steps down to nearly ground level at the left end of this elevation.

The east elevation has a steel entry door at the far left/south/front side. The vinyl siding steps down toward the rear of the house on this side as well.

The north elevation, the rear of the house, has an exposed / walk-out basement. To the left/east on the first/upper story, there is a smaller vinyl casement window, and below it, at ground level, there is a steel entry door with a semi circular fixed light at the top of the door. The second section has a wood deck supported by square wood columns. There are wood stairs down to ground level. There is a patio door on the deck. Below the deck, at ground level, there is a wide picture window with a fixed center light and a casement window on each side of the center window. The third and fourth sections each have paired vinyl casement windows. On the ground level, there are two narrower sets of vinyl casement windows set somewhat to the right of the locations of the first/upper story windows due to the staircase. At the foot of the stairs and across the back of the house, there is a concrete walk to a concrete patio located under the deck which extends almost to the east end of the wall.

There is a two story frame storage shed / playhouse in the yard north of the deck. It has vinyl siding to match the house, and a front gable roof with asphalt shingles. The second story has a porch which projects from the building, and there is a sandbox under the porch. Wood steps on the right of the south elevation lead up to the porch where there is a wood door on the left, and a double-hung vinyl window on the left. The west elevation has a double-hung vinyl window on the first story, with paired vinyl casement windows on the second story. On the east elevation, the first story has a large wood crossbuck door, and on the second story there is a double-hung vinyl window. The north elevation, the rear of the building, has two double-hung vinyl windows on the first story, and a double-hung vinyl window on the second story.

Iowa Site Inventory Form
State Historic Preservation Office
Continuation Sheet

Site Number: 92-00802
Related District Number: _____

Page 2

<u>Jeffrey and Lisa Wenger House</u>	<u>Washington</u>
Name of Property	County
<u>906 W. Main Street</u>	<u>Washington</u>
Address	City

Narrative Statement of Significance

The Jeffrey and Lisa Wenger House was completed in 2004, so it falls well after the period of significance for the potential "west side" residential historic district in Washington (see State #92-00350). As it is located at the northwest corner, it is not included in the recommended district boundary.

Max M. Long and wife sold the property to Jeremy and Tonya F. Patterson on November 25, 2003 as a vacant lot. The Pattersons transferred the property to Lisa E. Wenger on May 21, 2004, and an assessor's note says New Construction – incomplete. Thus, Wengers appear to have finished the house. Two quit claim deeds in December 2008 first listed Lisa and Jeffrey as owners, and then transferred ownership to Jeffrey Wenger.

The property was transferred from Jeffrey D. Wenger to Lucas A. and Kelli Brown on August 4, 2014.

Bibliography

City/telephone directories. Washington Public Library. Various years, including 1894, 1903, 1908, 1910-11, 1917, 1932, 1934, 1935, 1938, 1941, 1952, 1954, 1956, 1958, 1960, 1962, 1964, 1967, 1969, 1972, and 1976.

Fisher, Kathy. *In the beginning there was land : a history of Washington County, Iowa*. Washington, Iowa: Washington County Historical Society, 1978.

Newspapers, including anniversary/celebration editions on microfilm and/or bound at Washington Public Library:

- Washington Gazette*, January 6, 1893
- Twentieth Anniversary Edition, *Evening Journal*, April 26, 1913
- Twenty-Fifth Anniversary Edition, *Evening Journal*, April 3, 1926
- Washington County Centennial Edition, *Evening Journal*, July 1936
- Souvenir Edition of Washington Centennial, *The Evening Journal*, August 1939
- Sixtieth Anniversary Edition, *The Washington Evening Journal*, February 27, 1953
- Bicentennial edition, *The Washington Evening Journal*, July 1, 1976
- Sesquicentennial edition, *The Washington Evening Journal*, April 13, 1989

Sanborn Map Company. *Washington, Iowa*. Fire insurance maps. 1885, 1892, 1897, 1902, 1909, 1917, 1931, 1943.

Iowa Site Inventory Form
State Historic Preservation Office
Continuation Sheet

Site Number: 92-00802
Related District Number: _____

Page 3

Jeffrey and Lisa Wenger House
Name of Property

Washington
County

906 W. Main Street
Address

Washington
City

Location map



2009 aerial photograph (Washington County) – line indicates survey/research area boundary

Iowa Site Inventory Form
State Historic Preservation Office
Continuation Sheet

Site Number: 92-00802
Related District Number: _____

Page 4

Jeffrey and Lisa Wenger House
Name of Property

Washington
County

906 W. Main Street
Address

Washington
City

Building plan (from assessor's website)

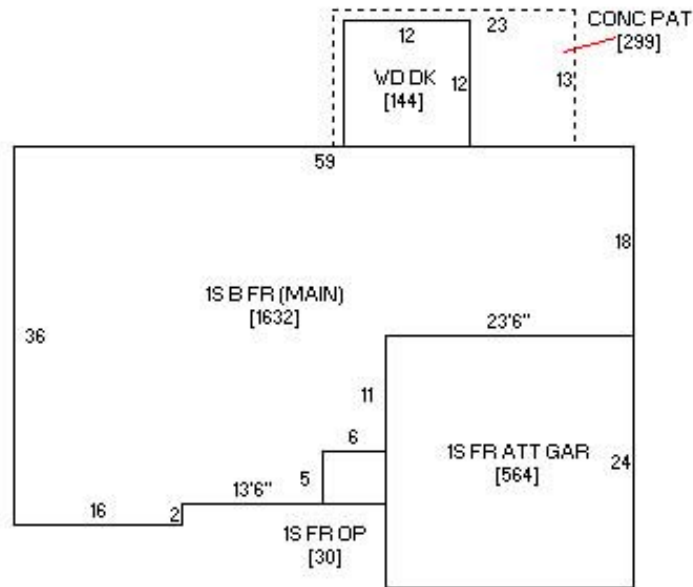

Photo from assessor's website



Iowa Site Inventory Form
State Historic Preservation Office
Continuation Sheet

Site Number: 92-00802
Related District Number: _____

Page 5

Jeffrey and Lisa Wenger House
Name of Property

Washington
County

906 W. Main Street
Address

Washington
City

Digital photographs



Photograph 92-00801-001 - House, looking northeast (December 2014)

Iowa Site Inventory Form
State Historic Preservation Office
Continuation Sheet

Site Number: 92-00802
Related District Number: _____

Page 6

Jeffrey and Lisa Wenger House
Name of Property

Washington
County

906 W. Main Street
Address

Washington
City



Photograph 92-00801-002 - House, looking southwest (December 2014)