

Iowa Site Inventory Form

State Historic Preservation Office

(July 2014)

State Inventory Number: 92-00763 New Supplemental

9-Digit SHPO Review & Compliance (R&C) Number _____

Non-extant Year: _____

Read the Iowa Site Inventory Form Instructions carefully, to ensure accuracy and completeness before completing this form. The instructions are available on our website: <http://www.iowahistory.org/historic-preservation/statewide-inventory-and-collections/iowa-site-inventory-form.html>

• Property Name

A) Historic name James and Geraldine Schmitt House

B) Other names: West side survey map #WS-074

• Location

A) Street address: 624 W. Washington Boulevard

B) City or town: Washington (Vicinity) County Washington

C) Legal Description:

Rural: Township Name: _____ Township No.: _____ Range No.: _____ Section: _____ Quarter: _____ of Quarter: _____

Urban: Subdivision: Western Addition Block(s): 6 Lot(s): 5 and west half of Lot 6

• Classification

A) Property category: *Check only one*

- Building(s)
- District
- Site
- Structure
- Object

B) Number of Resources (within property)

If eligible property, enter number of:		If non-eligible property, enter number of:	
Contributing	Noncontributing		
<u>1</u>	Buildings	—	Buildings
—	Sites	—	Sites
—	Structures	—	Structures
—	Objects	—	Objects
<u>1</u>	Total	—	Total

C) For properties listed in the National Register:

National Register status: Listed De-listed NHL NPS DOE

D) For properties within a historic district:

- Property contributes to a National Register or local certified historic district.
- Property contributes to a potential historic district, based on professional historic/architectural survey and evaluation.
- Property *does not* contribute to the historic district in which it is located.

Historic district name: West side residential historic district Historic district site inventory number: 92-00350

Name of related project report or multiple property study, if applicable:

MPD Title

Historical Architectural Data Base #

Architectural and Historical Survey of the "west side" residential neighborhood in Washington 92-013

• **Function or Use** *Enter categories (codes and terms) from the Iowa Site Inventory Form Instructions*

A) Historic functions

01A01: Domestic / residence

B) Current functions

01A01: Domestic / residence

• **Description** *Enter categories (codes and terms) from the Iowa Site Inventory Form Instructions*

A) Architectural Classification

B) Materials

Foundation (visible exterior): _____

walls (visible exterior): _____

Roof: 08A: Asphalt shingles

Other: _____

C) Narrative Description **SEE CONTINUATION SHEETS, WHICH MUST BE COMPLETED**

• **Statement of Significance**

A) Applicable National Register Criteria: *Mark your opinion of eligibility after applying relevant National Register criteria*

- Criterion A: Property is associated with significant events. Yes No More research recommended
- Criterion B: Property is associated with the lives of significant persons. Yes No More Research Recommended
- Criterion C: Property has distinctive architectural characteristics. Yes No More Research Recommended
- Criterion D: Property yields significant information in archeology/history. Yes No More Research Recommended

B) Special criteria considerations: *Mark any special considerations; leave blank if none*

- A Owned by a religious institution or used for religious purposes. E A reconstructed building, object, or structure.
- B Removed from its original location. F A commemorative property.
- C A birthplace or grave. G Less than 50 years of age or achieved significance within the past 50 years.
- D A cemetery

C) Areas of Significance

Enter categories from instructions

Community planning and development

D) Period(s) of significance

E) Significant dates

Construction date

1965 *check if circa or estimated date*

Other dates, including renovations

F) Significant person

Complete if Criterion B is marked above

G) Cultural affiliation

Complete if Criterion D is marked above

H) Architect/Builder

Architect

Builder/contractor

I) Narrative statement of significance **SEE CONTINUATION SHEETS, WHICH MUST BE COMPLETED**

• **Bibliography** *See continuation sheet for the list of research sources used in preparing this form*

• **Geographic Data** *Optional UTM references* *See continuation sheet for additional UTM references or comments*

UTM References (OPTIONAL)

Zone	Easting	Northing	NAD	Zone	Easting	Northing	NAD
1				2			
3				4			

• **Form Preparation**

Name and Title: Mary Patterson - volunteer Rebecca Lawin McCarley, consultant Date: June 2, 2015

Organization/firm: Washington Historic Preservation Commission E-mail: -

Street address: City Hall, 215 E. Washington St Telephone: 319-653-6584

City or Town: Washington State: Iowa Zip code: 52353

• **ADDITIONAL DOCUMENTATION** *Submit the following items with the completed form*

A) For all properties, attach the following, as specified in the Iowa Site Inventory Form Instructions:

1. **Map** of property's location within the community.
2. **Glossy color 4x6 photos labeled** on back with property/building name, address, date taken, view shown, and unique photo number.
3. **Photo key showing each photo number on a map and/or floor plan, using arrows next to each photo number to indicate the location and directional view of each photograph.**
4. **Site plan** of buildings/structures on site, identifying boundaries, public roads, and building/structure footprints.

B) For State Historic Tax Credit Part 1 Applications, historic districts and farmsteads, and barns:

See lists of special requirements and attachments in the Iowa Site Inventory Form Instructions.

State Historic Preservation Office (SHPO) Use Only Below This Line

The SHPO has reviewed the Site Inventory and concurs with above survey opinion on National Register eligibility:

- Yes No More Research Recommended
- This is a locally designated property or part of a locally designated district.*

Comments: _____

SHPO authorized signature: _____ Date: _____

Iowa Site Inventory Form
State Historic Preservation Office
Continuation Sheet

Site Number: 92-00763
Related District Number: 92-00350

Page 1

<u>James and Geraldine Schmitt House</u>	<u>Washington</u>
Name of Property	County
<u>624 W. Washington Blvd.</u>	<u>Washington</u>
Address	City

Narrative Description

This is a one story frame ranch house with attached two car garage built about 1965 on the northeast corner of the intersection of W. Washington Boulevard and S Avenue F. The house sits on a concrete block foundation, and it is clad with wide wood siding. The roof is covered with asphalt shingles. The windows are vinyl casement style, and most have vinyl shutters. There is a wide centrally located brick chimney.

The façade, the south elevation, is three sections. The central section is recessed and contains the entry door and a large picture window. The door is reached via a curved brick sidewalk from the concrete driveway to the east. There is also a brick clad stoop with a wrought iron railing. The front door is wood with three stair stepped fixed windows in the upper part of the door. To the right of the door, a wide picture window flanked by vinyl shutters fills the rest of the central section. The first and last sections of the picture window are operable casement windows, and the three central lights are fixed. The left/west section of the facade is a cross gable section that extends past the entry area. There are two double casement vinyl windows equally distributed on the south side, and both windows have vinyl shutters. The right/east section of the façade is the attached garage, with a gable facing the street. The two car garage has a double-car aluminum garage door.

The west elevation faces South Avenue F. The front/south section is the side of the front cross gable section, and it has a double vinyl casement window with vinyl shutters. The remainder of the west side is the gable end of the main section of the house. It has a smaller, single light vinyl casement window with vinyl shutters on the right. To the left/north/rear, there is another double vinyl casement window with vinyl shutters.

The east elevation of the house is the side of the garage. It has an entry with an aluminum storm / screen door at the left/south, and a small vinyl awning window centered in the garage wall.

The rear of the house, the north elevation, includes the rear of the garage at the east end, which has a rear entry into the garage. This door has a window in the upper half of the door, and it is flanked by vinyl shutters. Farther to the right, there is a concrete stoop with a steel entry door leading into the main section of the house. The door has a window in the upper half of the door, and an aluminum storm / screen door, and is flanked by vinyl shutters. To the right, there is a double vinyl casement window with vinyl shutters. Then there is another, wider concrete stoop with a two glass patio doors flanked by vinyl shutters. On the right/west side of this elevation, there is a double vinyl casement window flanked by vinyl shutters.

Narrative Statement of Significance

The James and Geraldine Schmitt House appears to contribute historically to the potential “west side” residential historic district in Washington. The ranch house was the last house built during the development of the former Hiram Scofield estate, and it is significant within this period of later development of the neighborhood. It is also part of the development of subdivision of larger lots along

Iowa Site Inventory Form
State Historic Preservation Office
Continuation Sheet

Site Number: 92-00763
Related District Number: 92-00350

Page 2

<u>James and Geraldine Schmitt House</u>	<u>Washington</u>
Name of Property	County
<u>624 W. Washington Blvd.</u>	<u>Washington</u>
Address	City

the west end of W. Washington to the east of Sunset Park in the 1960s. The period of significance for the historic district is anticipated to extend through 1969, so it would fall within this period.

This house does not appear eligible for individual listing on the National Register of Historic Places under Criteria A, B, or C. The house does not appear to have particular historic or architectural significance individually.

History / research summary of property

This parcel (Lot 7 and east half of Lot 6) is part of a larger property owned for many years by the Hiram Scofield family. Hiram Scofield was a lawyer and involved in early banking in Washington, arriving here in 1856. Two of his brothers later moved to town, and he formed a real estate partnership with William, also a lawyer (H. & W. Scofield). Hiram married Amelia B. Wilson in 1866, and they had two children, Clara J. and Cora L (Burrell 1909, Vol. 2: 610-612). Hiram Scofield acquired Lots 1-4 (619-633 W. Main, immediately to the north) in Block 6 of the Western Addition on March 15, 1870. The 1874 atlas shows his house spanning lots 3-4 at the west end of the block at 633 W. Main. He later bought lots 5-6-7 along W. Washington to the south of his house on January 20, 1880. Small houses appear on each of these lots to the south on the 1894 atlas, but the houses on lots 5-6 are gone by the 1909 Sanborn map. The 1903 city directory lists Hiram (lawyer) and Amelia Scofield living at 633 W. Main Street, along with daughter Cora (teacher). Hiram Scofield died in 1906 in Seattle, Washington. Amelia continued to own this property until November 1925 when it transferred to Cora L. Scofield and Clara J. Patterson (Lots 1-7). The 1931 Sanborn map shows the house remaining at 633 W. Main on Lots 3-4, with no other houses on Lots 1-2 to the east or Lots 5-7 to the south. The 1943 Sanborn map shows the Hiram Scofield House demolished, with no construction on Lots 1-7.

On April 25, 1946, Clara Patterson (widow) and Cora Scofield (spinster) transferred the property (Lots 1-7) to Carleton C. Wilson. He quickly sold the property (with alley) to St. James Catholic Church on May 6, 1946. The church also acquired the house on Lot 8 at 614 W. Washington in 1949, thus owning Lots 1-8 in Block 6 of Western Addition. That house on Lot 8 was then used as a convent. St James Catholic Church was located for many decades to the north at 606 W. Second, with the school across the street at 607 W. Second. They considered several plans for expansion in the 1950s, ending up demolishing their older church and building a new one on the same general property in 1961 (Fisher 1978: 170). They sold off these lots in Block 6 of the Western Addition for development in the late 1950s. St. James Church sold the property along W. Main to Dallas and Virginia Chamberlin on May 11, 1956. They appear to have built the house at the corner (633) in 1956 for themselves, and then had houses to the east built that they then sold (627 in 1957, 623 in 1958, 619 in 1959).

The church sold Lots 5, 6, and 7 along W. Washington to Irvin E. Coffey on May 11, 1956, the same day they sold the north property to Chamberlins. Coffey partitioned the property, and on May 3, 1965, sold Lot 5 and the W ½ of Lot 6, along with the S ½ of the vacated alley on the north end of those lots to James and Geraldine Schmitt, the current owners of the property. The Schmitts are first listed at this address in the 1966 telephone directory. The 1967 city directory lists James A. Schmitt, a representative of Morton Salt, and his wife Geraldine J., a teacher at Washington Community Schools,

Iowa Site Inventory Form
State Historic Preservation Office
Continuation Sheet

Site Number: 92-00763
Related District Number: 92-00350

Page 3

James and Geraldine Schmitt House	Washington
Name of Property	County
624 W. Washington Blvd.	Washington
Address	City

and their children Kathryn, born in 1953, and Kirk, born in 1956, living at 625 W. Washington. They continue to appear in telephone directories and city directories until the present year, 2015.

Bibliography

Atlas of Washington County, Iowa. Clinton, IA, and Philadelphia, PA: Harrison and Warner, 1874.

Atlas of Washington County, Iowa. No publisher noted, 1894. In collection of Washington Public Library.

Burrell, Howard A. *History of Washington County, Iowa.* Chicago, IL: S.J. Clarke Publishing Company, 1909. 2 volumes.

City/telephone directories. Washington Public Library. Various years, including 1894, 1903, 1908, 1910-11, 1917, 1932, 1934, 1935, 1938, 1941, 1952, 1954, 1956, 1958, 1960, 1962, 1964, 1967, 1969, 1972, and 1976.

Fisher, Kathy. *In the beginning there was land : a history of Washington County, Iowa.* Washington, Iowa: Washington County Historical Society, 1978.

History of Washington County, Iowa. Des Moines, IA: Union Historical Co., 1880.

Newspapers, including anniversary/celebration editions on microfilm and/or bound at Washington Public Library:

Washington Gazette, January 6, 1893

Twentieth Anniversary Edition, *Evening Journal*, April 26, 1913

Twenty-Fifth Anniversary Edition, *Evening Journal*, April 3, 1926

Washington County Centennial Edition, *Evening Journal*, July 1936

Souvenir Edition of Washington Centennial, *The Evening Journal*, August 1939

Sixtieth Anniversary Edition, *The Washington Evening Journal*, February 27, 1953

Bicentennial edition, *The Washington Evening Journal*, July 1, 1976

Sesquicentennial edition, *The Washington Evening Journal*, April 13, 1989

Patterson, Mary. Collection of historic postcards, images, and city/telephone directories. Washington, Iowa. Accessed 2014-2015.

Portrait and Biographical Album of Washington County, Iowa. Chicago, Acme Publishing Company, 1887.

Sanborn Map Company. *Washington, Iowa.* Fire insurance maps. 1885, 1892, 1897, 1902, 1909, 1917, 1931, 1943.

Souvenir History of Washington, Iowa. Washington, IA: Washington Evening Journal, June 23, 1989.

Iowa Site Inventory Form
State Historic Preservation Office
Continuation Sheet

Site Number: 92-00763
Related District Number: 92-00350

Page 4

James and Geraldine Schmitt House
Name of Property

Washington
County

624 W. Washington Blvd.
Address

Washington
City

Location map



2009 aerial photograph (Washington County) – line indicates survey/research area boundary

Iowa Site Inventory Form
State Historic Preservation Office
Continuation Sheet

Site Number: 92-00763
Related District Number: 92-00350

Page 5

James and Geraldine Schmitt House
Name of Property

Washington
County

624 W. Washington Blvd.
Address

Washington
City

Building plan (from assessor's website)

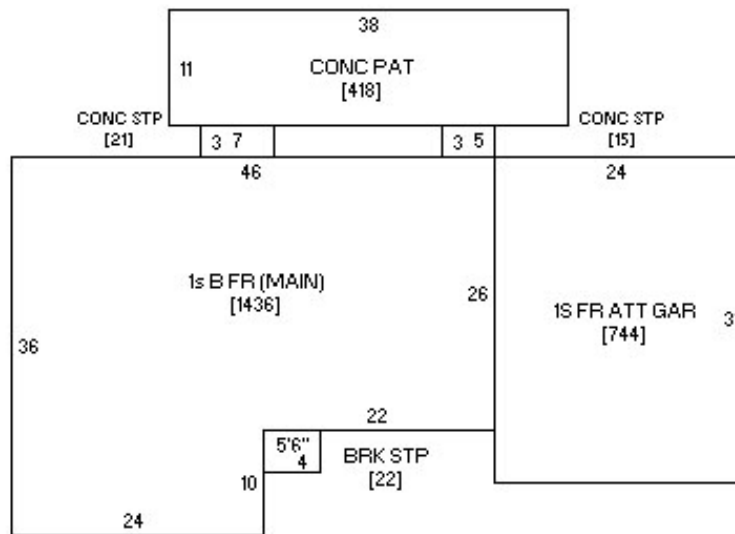

Photo from assessor's website



Iowa Site Inventory Form
State Historic Preservation Office
Continuation Sheet

Site Number: 92-00763
Related District Number: 92-00350

Page 6

James and Geraldine Schmitt House
Name of Property

Washington
County

624 W. Washington Blvd.
Address

Washington
City

Digital photographs



Photograph 92-00763-001 - House, looking northwest (December 2014)

Iowa Site Inventory Form
State Historic Preservation Office
Continuation Sheet

Site Number: 92-00763
Related District Number: 92-00350

Page 7

James and Geraldine Schmitt House
Name of Property

Washington
County

624 W. Washington Blvd.
Address

Washington
City



Photograph 92-00763-002 - House, looking southeast (December 2014)