

Iowa Site Inventory Form

State Historic Preservation Office

(July 2014)

State Inventory Number: 92-00378 New Supplemental

9-Digit SHPO Review & Compliance (R&C) Number _____

Non-extant Year: _____

Read the Iowa Site Inventory Form Instructions carefully, to ensure accuracy and completeness before completing this form. The instructions are available on our website: <http://www.iowahistory.org/historic-preservation/statewide-inventory-and-collections/iowa-site-inventory-form.html>

• Property Name

A) Historic name Mary A. Hollingsworth House

B) Other names: West side survey map #WS-076

• Location

A) Street address: 611 W. Washington Boulevard

B) City or town: Washington (Vicinity) County Washington

C) Legal Description:

Rural: Township Name: _____ Township No.: _____ Range No.: _____ Section: _____ Quarter: _____ of Quarter: _____

Urban: Subdivision: Southwest Washington Block(s): 1 Lot(s): 3

• Classification

A) Property category: *Check only one*

- Building(s)
- District
- Site
- Structure
- Object

B) Number of Resources (within property)

If eligible property, enter number of:		If non-eligible property, enter number of:	
Contributing	Noncontributing		
<u>1</u>	Buildings	<u>1</u>	Buildings
—	Sites	—	Sites
—	Structures	—	Structures
—	Objects	—	Objects
<u>1</u>	Total	<u>1</u>	Total

C) For properties listed in the National Register:

National Register status: Listed De-listed NHL NPS DOE

D) For properties within a historic district:

- Property contributes to a National Register or local certified historic district.
- Property contributes to a potential historic district, based on professional historic/architectural survey and evaluation.
- Property *does not* contribute to the historic district in which it is located.

Historic district name: West side residential historic district Historic district site inventory number: 92-00350

Name of related project report or multiple property study, if applicable:

MPD Title

Historical Architectural Data Base #

Architectural and Historical Survey of the "west side" residential neighborhood in Washington 92-013

• **Function or Use** *Enter categories (codes and terms) from the Iowa Site Inventory Form Instructions*

A) Historic functions

01A01: Domestic / residence

B) Current functions

01A01: Domestic / residence

01C05: Domestic / garage

• **Description** *Enter categories (codes and terms) from the Iowa Site Inventory Form Instructions*

A) Architectural Classification

07E01: Bungalow

B) Materials

Foundation (visible exterior): 06: Stucco

walls (visible exterior): 06: Stucco

Roof: 08A: Asphalt shingles

Other: _____

C) Narrative Description SEE CONTINUATION SHEETS, WHICH MUST BE COMPLETED

● **Statement of Significance**

A) Applicable National Register Criteria: *Mark your opinion of eligibility after applying relevant National Register criteria*

- Criterion A: Property is associated with significant events. Yes No More research recommended
 Criterion B: Property is associated with the lives of significant persons. Yes No More Research Recommended
 Criterion C: Property has distinctive architectural characteristics. Yes No More Research Recommended
 Criterion D: Property yields significant information in archeology/history. Yes No More Research Recommended

B) Special criteria considerations: *Mark any special considerations; leave blank if none*

- A Owned by a religious institution or used for religious purposes. E A reconstructed building, object, or structure.
 B Removed from its original location. F A commemorative property.
 C A birthplace or grave. G Less than 50 years of age or
 D A cemetery achieved significance within the past 50 years.

C) Areas of Significance

Enter categories from instructions

Community planning and development

D) Period(s) of significance

E) Significant dates

Construction date

1909 *check if circa or estimated date*

Other dates, including renovations

F) Significant person

Complete if Criterion B is marked above

G) Cultural affiliation

Complete if Criterion D is marked above

H) Architect/Builder

Architect

Builder/contractor

I) Narrative statement of significance **SEE CONTINUATION SHEETS, WHICH MUST BE COMPLETED**

● **Bibliography** *See continuation sheet for the list of research sources used in preparing this form*

● **Geographic Data** *Optional UTM references* *See continuation sheet for additional UTM references or comments*

UTM References (OPTIONAL)

Zone	Easting	Northing	NAD	Zone	Easting	Northing	NAD
1	_____	_____	_____	2	_____	_____	_____
3	_____	_____	_____	4	_____	_____	_____

● **Form Preparation**

Name and Title: Mary Patterson - volunteer Rebecca Lawin McCarley, consultant Date: September 4, 2015

Organization/firm: Washington Historic Preservation Commission E-mail: -

Street address: City Hall, 215 E. Washington St Telephone: 319-653-6584

City or Town: Washington State: Iowa Zip code: 52353

● **ADDITIONAL DOCUMENTATION** *Submit the following items with the completed form*

A) For all properties, attach the following, as specified in the Iowa Site Inventory Form Instructions:

- 1. Map** of property's location within the community.
- 2. Glossy color 4x6 photos labeled** on back with property/building name, address, date taken, view shown, and unique photo number.
- 3. Photo key showing each photo number on a map and/or floor plan, using arrows next to each photo number to indicate the location and directional view of each photograph.**
- 4. Site plan** of buildings/structures on site, identifying boundaries, public roads, and building/structure footprints.

B) For State Historic Tax Credit Part 1 Applications, historic districts and farmsteads, and barns:

See lists of special requirements and attachments in the Iowa Site Inventory Form Instructions.

State Historic Preservation Office (SHPO) Use Only Below This Line

The SHPO has reviewed the Site Inventory and concurs with above survey opinion on National Register eligibility:

- Yes No More Research Recommended
 This is a locally designated property or part of a locally designated district.

Comments: _____

SHPO authorized signature: _____ Date: _____

Iowa Site Inventory Form
State Historic Preservation Office
Continuation Sheet

Site Number: 92-00378
Related District Number: 92-00350

Page 1

<u>Mary A. Hollingsworth House</u>	<u>Washington</u>
Name of Property	County
<u>611 W. Washington Blvd.</u>	<u>Washington</u>
Address	City

Narrative Description

This is a one-and-one-half story bungalow built in 1909 on the south side of W. Washington Boulevard. The house's brick walls and foundation are covered with stucco. The front gable roof has a half flared gambrel pitch on the west, and the east and north (rear) gables have full flared gambrel rooflines. The roof is covered with asphalt shingles. The west side has a gable-roof dormer. All the gables and the dormer are clad with rectangular wood shingles. There is a full front porch with stucco-clad columns supporting the roof, and a small open back porch, also with stucco-clad columns. A historic chimney is located on the east side of the house. The windows are wood with wood surrounds and aluminum storm / screens. The first story windows have concrete sills while those on the second story are wood. A frame two and a half car garage sits south of the house with access on the east side of the house via a paved driveway from W. Washington Boulevard.

The façade, the north elevation, is spanned by a full front porch across the width of the house with a wood shingled gable pediment above the center portion of the porch. There are wood steps with a wood railing at the left/east end of the porch, and the wood railing continues around the perimeter of the porch. The center section of the house with the entry appears slightly recessed, with the window bays to either side projected. The historic door has a window in the top third of the door, with a large single wood panel below the window. The window bays to either side of the entry protrude about one foot from the mass of the house. Each section has a centered four-over-one-light double-hung wood window. On the second story, there is a front facing gable which has a flared gambrel profile on the west/right, and a typical straight gable roofline on the east/left. There is a set of three four-over-one-light double-hung windows centered in the gable, and an attic window / vent combination just below the peak of the gable. The attic window is divided vertically into thirds, with fixed glass in the left and right thirds, and an aluminum vent in the center third.

The east elevation is composed of the side of the east gambrel-roof wing and the side of the rear gambrel-roof wing. The east gambrel-roof window has a centered exterior chimney which rises from ground level on the outside of the house and through the roof. The chimney is covered with stucco on the first story, and is brick on the second story and above the roof. On the first story, on either side of the chimney, there is a four-over-one-light double-hung wood window. On the second story, there is a gambrel gable covered with rectangular wood shingles. On either side of the brick chimney, there is a four-over-one-light double-hung wood window. There are two wood basement windows with aluminum storm windows on this section. The east side of the rear section is recessed several feet from the east section. There are two one-over-one-light double-hung wood windows which are somewhat smaller and have higher sills than typical for this house. The basement window on this section is covered with a plywood panel.

The west elevation has a set of three narrow one-over-one-light double-hung wood windows on the left/front/north. The center of this side has a small one-over-one-light double-hung wood window with a sill higher than typical for this house. To the right/south/rear, there is a pair of one-over-one-light double-hung wood windows. On the second story, there is a centrally located gable-roof dormer with a pair of one-over-one-light double-hung wood windows. The dormer is clad with rectangular wood

Iowa Site Inventory Form
State Historic Preservation Office
Continuation Sheet

Site Number: 92-00378
Related District Number: 92-00350

Page 2

<u>Mary A. Hollingsworth House</u>	<u>Washington</u>
Name of Property	County
<u>611 W. Washington Blvd.</u>	<u>Washington</u>
Address	City

shingles. The gable projects slightly from the remainder of the dormer. There are two wood single-light basement windows, one toward the left of the house and the other toward the right.

The south elevation, the rear of the house, has a small open porch with stucco-clad columns and wall on the left/west, providing access to the rear wood entry door. The porch has a nearly flat roof, stucco walls below the railing, and wood steps and floor. The entry door has a fixed window in the upper part of the door, and horizontal wood panels below the window. There is also a wood screen door with screening in the upper half of the door, and horizontal wood panels in the lower half. To the right, at the center of the south elevation, there is a pair of one-over-one-light double-hung wood windows roughly centered on the wall. On the second story, there is a gambrel gable clad with wood shingles. There are three equally distributed one-over-one-light double-hung wood windows, with a three-light attic window centered just under the peak of the gable. At the far right/east, on the south side of the east section of the house, there is a one-over-one-light double-hung wood window on the first story. Below this window there is a basement entry with a slanted wood door and stucco walls.

The two and a half car frame garage sits just south of the house. The assessor lists a construction date of 1984. It sits on a poured concrete foundation, is clad with T-111 siding, and has asphalt shingles on the side gable roof. There are two single-car aluminum garage doors facing east which are located offset to the right/north side of that elevation. The north elevation facing the house has a wood entry door with three horizontal fixed windows in the upper part of the door, and three horizontal wood panels in the lower part. The south elevation has two one-over-over-double-hung wood windows.

Narrative Statement of Significance

The Mary A. Hollingsworth House appears to contribute historically and architecturally to the potential "west side" residential historic district in Washington. The house was built in the early 1900s when redevelopment of lots with early houses increased the overall density of housing in the neighborhood. The house is an excellent example of bungalows that were built as the smaller housing choice in the neighborhood in this period.

The house may be individually eligible for listing on the National Register of Historic Places under Criterion C for its architecture. The bungalow retains excellent historic integrity on the exterior, and the flared gambrel roof lines appear to be a relatively unique feature, providing additional architectural significance for this house. Further evaluation of the interior integrity and comparison to other bungalows in Washington would solidify this determination. The house does not appear likely individually eligible under Criteria A or B.

History / research summary of property (chronological order, by owner/period):

The 1909 Sanborn map shows an earlier house that spanned Lots 3 and 4 in Block 1 of the Southwest Addition, with the notation of "ruins" from a fire. This property was owned by Elizabeth Corbin in the 1860s, and then by Joseph McKee from 1866 to 1876. He sold the property to William Hollingsworth in

Iowa Site Inventory Form
State Historic Preservation Office
Continuation Sheet

Site Number: 92-00378
Related District Number: 92-00350

Page 3

<u>Mary A. Hollingsworth House</u>	<u>Washington</u>
Name of Property	County
<u>611 W. Washington Blvd.</u>	<u>Washington</u>
Address	City

1876, who then transferred it to Clarence Hollingsworth on April 6, 1907 (both lots 3 and 4). Local history notes that the house burned on January 4, 1908. Clarence then split the property into the separate lots, with Lot 3 (this property) transferred to Mary A. Hollingsworth on August 16, 1909, and then Lot 4 to the west sold to A.N. Alberson on March 28, 1910.

The 1880 census lists Dr. William Hollingsworth, retired physician, age 61, his wife Mary A., age 46, and children Ada, age 23, Duane, age 20, Virthene, age 18, Voline, age 16, Henry, age 14, Livingston, age 12, and Clarence, age 9. The 1885 Iowa census places the Hollingsworth family on W. Washington street, between Howard Burrell (now 527) and Joseph Campbell (now 631). The family consisted of William, age 68, employed in Clothing, his wife Mary A., age 55, a son Duane, age 24, also working in the clothing business, daughters Ada, age 27, Bertha, age 20, Della, age 18, and Clara, age 12, and sons Henry, age 16, and Livingston, age 14. Ada Hollingsworth married Enoch Winter in February 1885, and they became parents of four children, a son Charles, and three daughters, Ruth, Carrie, and Francis. Ada died in 1894, and Enoch died in 1896. The children were raised by their grandmother Mary A. Hollingsworth, and their unmarried aunts and uncles who lived with the family. The 1900 census lists the Hollingsworth household as William, age 82 and a capitalist, his wife Ann, age 70, his wife Ann, age 70, a daughter Bertha, age 35, single and not working, a son Clarence, age 30, single and not working, and a son Livingston, age 28, also single and not working. Living elsewhere in Washington in the 1900 census, on a page with with no ward number or street name, is a household composed of Della Hollingsworth, age 35 and home owner, Charles Winter, a nephew, age 14, Ruth Winter, a niece, age 13, Carrie Winter, a niece, age 11, and Fanny Winter, also a niece, age 9. By 1903, both families are listed together at 617 W. Washington (earlier house on lots 3-4). The 1903 city directory lists Dr. William Hollingsworth, a retired farmer, his wife Mary, and Della P, Livingston, a farmer, and Charles J. Winter, Ruth Winter, Carrie Winter, and Fanny Winter, all students. At this time, they were living in the large brick house that burned in 1908. Descendents say the current house at 611 W. Washington was built from salvaged brick from that house, and was covered with stucco due to discoloration from the fire. In April 1907, William Hollingsworth transferred the property to his son Clarence. William died in April 1908.

Clarence Hollingsworth transferred the property back to his mother Mary A. Hollingsworth on August 16, 1909. The May 1909 Sanborn map continues to show the earlier house in ruins, so this house was built likely in the summer of 1909 or in 1910. An article in June 1909 on residences under construction notes one being built for Mrs. Mary Hollingsworth ("Some Building This Year," *Evening Journal*, July 8, 1909, 8). The 1910-11 city directory lists Mrs. Mary A. Hollingsworth (widow Wm.) living at 615 W. Washington (now 611) with Miss Della D. Hollingsworth. The 1910 census identifies the residents at 607 W. Washington as Mary A. Hollingsworth, a widow age 70, and her daughter Della, single and 44 years of age. The 1917 Sanborn map shows the current house with the current footprint. The 1917 county directory uses the 615 W. Washington address for Mrs. Mary Hollingsworth and Berthine and Pearline, housekeepers. The census in 1920 lists Mary Hollingsworth as head of the household, age 86 and a widow, and her daughter Bertha, age 67 and single, living at 615 W. Washington (now 611). On September 22, 1921, Mary A. Hollingsworth transferred the property to Berthine and Della Hollingsworth, followed by a quit claim deed to Berthine and Della from Duane Hollingsworth and wife in February 1924. The 1925 Iowa census names Clarence and May Hollingsworth, who are 50 and 43

Iowa Site Inventory Form
State Historic Preservation Office
Continuation Sheet

Site Number: 92-00378
Related District Number: 92-00350

Page 4

<u>Mary A. Hollingsworth House</u>	<u>Washington</u>
Name of Property	County
<u>611 W. Washington Blvd.</u>	<u>Washington</u>
Address	City

respectively, living at 611 W. Washington with their daughter Mary, age 14. The 1926 telephone directory lists D.P. Hollingsworth living at 611 W. Washington.

While Della Hollingsworth continued to own the property, her brothers Henry C. Hollingsworth, age 63 and single, and his brother Livingston, age 61, also single as listed as residents at 611 W. Washington in the 1930 census. The 1935 city directory lists the residents as Henry and Livingston Hollingsworth, although they do not appear in the 1932 or 1938 telephone directories. In 1940, the census again lists Henry Hollingsworth as head of the household, now age 73 and single. Other residents at this address are Livingston Hollingsworth, age 71 and single, and Alex Lytle, age 52, and his wife Ruth, age 52 and Henry's niece. The city directory for 1941 lists only Henry and Livingston living at this address. City directories do not exist for the remainder of the 1940s.

The 1954 city directory lists Mrs. Alex Lytle and Henry Hollingsworth living here, and the 1954 telephone directory confirms Mrs. Alex Lytle living at 611 W. Washington. The Della Pauline Hollingsworth Trust transferred ownership of the property to Ruth Lytle on December 31, 1958. She continues to be listed in telephone directories at this address through 1976, and also appears in the 1964, 1967, 1972, and 1976 city directories as living here with her sister Mrs. Carrie Berdo.

On March 31, 1982, Steven and Michelle Svoboda purchased the property from Ruth Lytle, and five years later, on December 14, 1987, they sold it to Bernard and Maureen Havlovic. The current owners are Bradley and Mary Ward.

Iowa Site Inventory Form
State Historic Preservation Office
Continuation Sheet

Site Number: 92-00378
Related District Number: 92-00350

Page 5

Mary A. Hollingsworth House
Name of Property

Washington
County

611 W. Washington Blvd.
Address

Washington
City

Bibliography

Atlas of Washington County, Iowa. Clinton, IA, and Philadelphia, PA: Harrison and Warner, 1874.

Atlas of Washington County, Iowa. No publisher noted, 1894. In collection of Washington Public Library.

Burrell, Howard A. *History of Washington County, Iowa.* Chicago, IL: S.J. Clarke Publishing Company, 1909. 2 volumes.

City/telephone directories. Washington Public Library. Various years, including 1894, 1903, 1908, 1910-11, 1917, 1932, 1934, 1935, 1938, 1941, 1952, 1954, 1956, 1958, 1960, 1962, 1964, 1967, 1969, 1972, and 1976.

Fisher, Kathy. *In the beginning there was land : a history of Washington County, Iowa.* Washington, Iowa: Washington County Historical Society, 1978.

History of Washington County, Iowa. Des Moines, IA: Union Historical Co., 1880.

Koch, Augustus. *Birds-eye View of the City of Washington.* Chicago: Chicago Lithograph Company, 1869.

Newspapers, including anniversary/celebration editions on microfilm and/or bound at Washington Public Library:

Washington Gazette, January 6, 1893

Twentieth Anniversary Edition, *Evening Journal*, April 26, 1913

Twenty-Fifth Anniversary Edition, *Evening Journal*, April 3, 1926

Washington County Centennial Edition, *Evening Journal*, July 1936

Souvenir Edition of Washington Centennial, *The Evening Journal*, August 1939

Sixtieth Anniversary Edition, *The Washington Evening Journal*, February 27, 1953

Bicentennial edition, *The Washington Evening Journal*, July 1, 1976

Sesquicentennial edition, *The Washington Evening Journal*, April 13, 1989

Patterson, Mary. Collection of historic postcards, images, and city/telephone directories. Washington, Iowa. Accessed 2014-2015.

Portrait and Biographical Album of Washington County, Iowa. Chicago, Acme Publishing Company, 1887.

Sanborn Map Company. *Washington, Iowa.* Fire insurance maps. 1885, 1892, 1897, 1902, 1909, 1917, 1931, 1943.

Souvenir History of Washington, Iowa. Washington, IA: Washington Evening Journal, June 23, 1989.

Washington County Historical Society. Collection of historic postcards and photographs.

Iowa Site Inventory Form
State Historic Preservation Office
Continuation Sheet

Site Number: 92-00378
Related District Number: 92-00350

Page 6

Mary A. Hollingsworth House
Name of Property

Washington
County

611 W. Washington Blvd.
Address

Washington
City

Location map



2009 aerial photograph (Washington County) – line indicates survey/research area boundary

Iowa Site Inventory Form
State Historic Preservation Office
Continuation Sheet

Site Number: 92-00378
 Related District Number: 92-00350

Page 7

Mary A. Hollingsworth House	Washington
Name of Property	County
611 W. Washington Blvd.	Washington
Address	City

Building plan (from assessor's website)

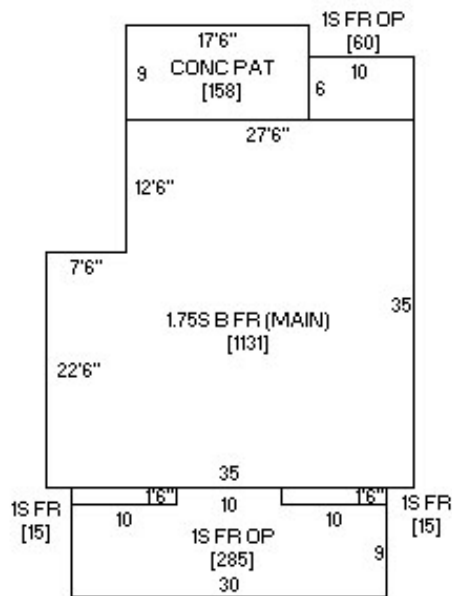

Photo from assessor's website



Iowa Site Inventory Form
State Historic Preservation Office
Continuation Sheet

Site Number: 92-00378
Related District Number: 92-00350

Page 8

Mary A. Hollingsworth House
Name of Property

Washington
County

611 W. Washington Blvd.
Address

Washington
City

Digital photographs



Photograph 92-00378-001 - House, looking southeast (December 2014)

Iowa Site Inventory Form
State Historic Preservation Office
Continuation Sheet

Site Number: 92-00378
Related District Number: 92-00350

Page 9

Mary A. Hollingsworth House
Name of Property

Washington
County

611 W. Washington Blvd.
Address

Washington
City



Photograph 92-00378-002 - House, looking southwest (December 2014)

Iowa Site Inventory Form
State Historic Preservation Office
Continuation Sheet

Site Number: 92-00378
Related District Number: 92-00350

Page 10

Mary A. Hollingsworth House
Name of Property

Washington
County

611 W. Washington Blvd.
Address

Washington
City



Photograph 92-00378-003 - House, looking northwest (December 2014)