

Iowa Site Inventory Form

State Historic Preservation Office

(July 2014)

State Inventory Number: 92-00431 New Supplemental

9-Digit SHPO Review & Compliance (R&C) Number _____

Non-extant Year: _____

Read the Iowa Site Inventory Form Instructions carefully, to ensure accuracy and completeness before completing this form. The instructions are available on our website: <http://www.iowahistory.org/historic-preservation/statewide-inventory-and-collections/iowa-site-inventory-form.html>

• Property Name

A) Historic name Daniel and Elizabeth Wilde House

B) Other names: West side survey map #WS-081

• Location

A) Street address: 209 S. Avenue F

B) City or town: Washington (Vicinity) County Washington

C) Legal Description:

Rural: Township Name: _____ Township No.: _____ Range No.: _____ Section: _____ Quarter: _____ of Quarter: _____

Urban: Subdivision: Southwest Addition Block(s): 2 Lot(s): S 74.25' of Lots 1 & 2 (also N 8.25' exc W 10' of Lots 7-8)

• Classification

A) Property category: *Check only one*

- Building(s)
- District
- Site
- Structure
- Object

B) Number of Resources (within property)

If eligible property, enter number of:		If non-eligible property, enter number of:	
Contributing	Noncontributing		
<u>2</u>	Buildings	—	Buildings
—	Sites	—	Sites
—	Structures	—	Structures
—	Objects	—	Objects
<u>2</u>	Total	—	Total

C) For properties listed in the National Register:

National Register status: Listed De-listed NHL NPS DOE

D) For properties within a historic district:

- Property contributes to a National Register or local certified historic district.
- Property contributes to a potential historic district, based on professional historic/architectural survey and evaluation.
- Property *does not* contribute to the historic district in which it is located.

Historic district name: West side residential historic district Historic district site inventory number: 92-00350

Name of related project report or multiple property study, if applicable:

MPD Title

Historical Architectural Data Base #

Architectural and Historical Survey of the "west side" residential neighborhood in Washington 92-013

• **Function or Use** *Enter categories (codes and terms) from the Iowa Site Inventory Form Instructions*

A) Historic functions

01A01: Domestic / residence

01C05: Domestic / garage

B) Current functions

01A01: Domestic / residence

01C05: Domestic / garage

• **Description** *Enter categories (codes and terms) from the Iowa Site Inventory Form Instructions*

A) Architectural Classification

05: Late Victorian

B) Materials

Foundation (visible exterior): 03: Brick

walls (visible exterior): 02A: Wood weatherboard

Roof: 08A: Asphalt shingles

Other: _____

C) Narrative Description SEE CONTINUATION SHEETS, WHICH MUST BE COMPLETED

• **Statement of Significance**

A) Applicable National Register Criteria: *Mark your opinion of eligibility after applying relevant National Register criteria*

- Criterion A: Property is associated with significant events. Yes No More research recommended
Criterion B: Property is associated with the lives of significant persons. Yes No More Research Recommended
Criterion C: Property has distinctive architectural characteristics. Yes No More Research Recommended
Criterion D: Property yields significant information in archeology/history. Yes No More Research Recommended

B) Special criteria considerations: *Mark any special considerations; leave blank if none*

- A Owned by a religious institution or used for religious purposes. E A reconstructed building, object, or structure.
 B Removed from its original location. F A commemorative property.
 C A birthplace or grave. G Less than 50 years of age or
 D A cemetery achieved significance within the past 50 years.

C) Areas of Significance

Enter categories from instructions

Community planning and development

D) Period(s) of significance

E) Significant dates

Construction date

1902 *check if circa or estimated date*

Other dates, including renovations

F) Significant person

Complete if Criterion B is marked above

G) Cultural affiliation

Complete if Criterion D is marked above

H) Architect/Builder

Architect

Builder/contractor

I) Narrative statement of significance **SEE CONTINUATION SHEETS, WHICH MUST BE COMPLETED**

• **Bibliography** *See continuation sheet for the list of research sources used in preparing this form*

• **Geographic Data** *Optional UTM references* *See continuation sheet for additional UTM references or comments*

UTM References (OPTIONAL)

Zone	Easting	Northing	NAD	Zone	Easting	Northing	NAD
1				2			
3				4			

• **Form Preparation**

Name and Title: Mary Patterson - volunteer Rebecca Lawin McCarley, consultant Date: September 11, 2015

Organization/firm: Washington Historic Preservation Commission E-mail: -

Street address: City Hall, 215 E. Washington St Telephone: 319-653-6584

City or Town: Washington State: Iowa Zip code: 52353

• **ADDITIONAL DOCUMENTATION** *Submit the following items with the completed form*

A) For all properties, attach the following, as specified in the Iowa Site Inventory Form Instructions:

- 1. Map** of property's location within the community.
- 2. Glossy color 4x6 photos labeled** on back with property/building name, address, date taken, view shown, and unique photo number.
- 3. Photo key showing each photo number on a map and/or floor plan, using arrows next to each photo number to indicate the location and directional view of each photograph.**
- 4. Site plan** of buildings/structures on site, identifying boundaries, public roads, and building/structure footprints.

B) For State Historic Tax Credit Part 1 Applications, historic districts and farmsteads, and barns:

See lists of special requirements and attachments in the Iowa Site Inventory Form Instructions.

State Historic Preservation Office (SHPO) Use Only Below This Line

The SHPO has reviewed the Site Inventory and concurs with above survey opinion on National Register eligibility:

- Yes No More Research Recommended
 This is a locally designated property or part of a locally designated district.

Comments: _____

SHPO authorized signature: _____ Date: _____

Iowa Site Inventory Form
State Historic Preservation Office
Continuation Sheet

Site Number: 92-00431
Related District Number: 92-00350

Page 1

<u>Daniel and Elizabeth Wilde House</u>	<u>Washington</u>
Name of Property	County
<u>207 S. Avenue F</u>	<u>Washington</u>
Address	City

Narrative Description

This is a one-and-one-half-story, two bay, frame Victorian vernacular house built about 1902 on the west side of S. Avenue F. The house has a brick foundation, though the south side has been replaced. The siding and shingles on the gables are wood. The cross gable roof is covered with asphalt shingles. The house features many characteristic elements of the Victorian vernacular style, including asymmetrical design, a bay window, decorative glass windows, and gables with decorative surfaces, and decorative windows. The windows retain historic wood surrounds, wood sills, and wood sashes and wood storm windows remain on the larger fixed light windows. The double-hung windows have aluminum storm / screens. A historic garage sits behind and to the left of the house, accessed by a concrete driveway on the south side of the house.

The façade (east elevation) is divided into two sections. The right (north) half is a projected gable-roof section, and it is spanned by a front porch. The porch has three square fluted columns with a wide railing and square balusters between the columns. There are two half columns where the porch meets the house. The top of each arched porch bay has raised panels and a wood keystone within the arches, and there is a built-up patterned wood ceiling. The porch has a historic metal roof. The entry door is on the left side this section of the house, and it has an historic wood and glass entry door with an aluminum combination storm/screen door. The height of the entry has been lowered to accommodate the modern storm door, but the taller entry door remains intact behind it. To the right of the entry, there is a large picture window with transom. The window has a wood storm window with one large upper light and two lights below. The northeast corner of the house, to the right/north of the porch, is a chamfered corner with decorative brackets supporting the gable roof. The angled wall has a one-over-one-light double-hung wood window and a smaller aluminum storm / screen. The front gable of the house is clad with fish scale wood shingles, flared at the base where the gable meets the first story. There is a centrally located decorative window unit consisting of one larger, fixed window flanked by decorative double-hung wood windows. The window unit is further adorned with a pediment and square pilasters with decorative bases. The flared gable is supported by small brackets. The left/south half of the facade is the east side of the gable-roof wing to the south. It features a rectangular oriel window with an asphalt-shingled hip roof and a large single light window with a two-light storm window. The window is supported below by decorative wood brackets. The sides of the oriel window are narrow wood slats, which is visible on the interior as well. There is a four-light wood basement window below the oriel window on the left, with a concrete window well.

The south elevation is divided similarly divided into two sections by the protrusion of a large bay window at the right/east. The foundation on this side of the house is replacement concrete block. The east half of the south side is a bay window with a gable. The center of the bay window has a large one-over-one-light wood window. The two lights of the window are the same size, but the wood storm window has a smaller portion at the top and the larger portion at the bottom. There is a typical one-over-one light window on each angled side of the bay window, and both windows have wood storm windows. Above each side window, where the gable roof overhangs the angled portions of the bay window, are two decorative brackets. The gable has decorative wood shingles, a flared skirting at the base with brackets under it, and a centered decorative window unit, matching the front gable. This window likewise has a larger, fixed single-light window flanked by decorative double-hung wood

Iowa Site Inventory Form
State Historic Preservation Office
Continuation Sheet

Site Number: 92-00431
Related District Number: 92-00350

Page 2

<u>Daniel and Elizabeth Wilde House</u>	<u>Washington</u>
Name of Property	County
<u>207 S. Avenue F</u>	<u>Washington</u>
Address	City

windows. The left/rear/west section of the south elevation has a one-over-one-light double-hung wood window with an aluminum storm / screen. Above this window on the roof, there is a shed-roof dormer with a one-over-one-light double-hung wood window with a wood screen on the lower half of the window. There are two one-by-one-light sliding vinyl windows in the later concrete block foundation, one under the large bay window and the other under the window at the left.

The north elevation consists of the side of the main house and the north side of the rear section. On the left/front/east, west of the chamfered corner, there is a one-over-one-light double-hung wood window with an aluminum storm /screen. The center section is defined by a gable with decorative vergeboard trim. There is a side entry at the ground level, with a wood door with a window and three lower wood panels. Between the first and second/attic stories, there is a one-over-one-light double-hung wood window with an aluminum storm / screen. To the right/west/rear, there is a pair of one-over-one-light double-hung wood windows with aluminum storm / screens. The foundation on this elevation is brick. There are three three-light wood basement windows, two in the left section and one in the right section. The side of the rear section has a single-light window. This section also sits on a brick foundation on this side.

The west elevation, the rear of the house, has a large wood deck and pergola west of an enclosed one story rear porch. The porch sits on a brick foundation, though it does not appear on Sanborn maps. The porch has an asphalt-shingled hip roof, and it has a steel entry door at the left with an aluminum storm / screen door. To the right of the door, there are two pair of one-over-one-light double-hung wood windows with wood surrounds, and there is a pair of matching windows around the corner on the south facing side of the porch. To the left of the entry door, there is a one-over-one-light double-hung wood window with wood surround. To the right/south of the enclosed porch, on the west side of the house, there is a one-over-one-light double-hung wood window. On the second story of the main section of the house, there is a clipped gable clad in wood fishscale shingles that are flared at the base, with a row of small brackets under the trim. There are two typical size one-over-one-light double-hung wood windows evenly spaced within the gable, and just to the left/north of the left window there is a smaller one-over-one-light double-hung wood window.

Southwest of the house is a historic one-car garage with a gable-front roof and historic curbed concrete driveway. The 1917 Sanborn map shows a long building in this location, and it is labeled as a garage on the 1931 and 1943 Sanborn maps. The building may have been a workshop later converted to a garage. The garage sits on a wood post foundation, and the walls are clad with vertical boards, similar to the design of a barn. A pair of sliding wood doors, each with a single-light window, faces east toward the street. The doors are hung from a metal rail and slide to open. Above the garage doors in the gable, there is a pair of vertical two-light fixed wood windows. The south elevation has a hinged window wood panel on the right/east, with two-light wood window. The north elevation has a centered bay window with a shingled hip roof. It has a piece of plywood covering an opening in the top half of the bay window, with a plywood wall below it. To the right of the bay window is a two-over-two-light double-hung wood window. The west elevation, the rear of the garage, had a small projection centered on the lower portion of the wall. It has a shingle covered shed roof, and projects only about a foot. In the gable of the garage, there is a four-over-four-light double-hung wood window. Inside the garage, the floor is composed of thick wood planks with the center area assembled in a circular shape. This circular floor in

Iowa Site Inventory Form
State Historic Preservation Office
Continuation Sheet

Site Number: 92-00431
Related District Number: 92-00350

Page 3

<u>Daniel and Elizabeth Wilde House</u>	<u>Washington</u>
Name of Property	County
<u>207 S. Avenue F</u>	<u>Washington</u>
Address	City

the center of the garage turns by a (missing) crank. This would permit a car to be turned within the garage to exit through the same door that it entered.

Narrative Statement of Significance

The Daniel and Elizabeth Wilde House appears to contribute historically and architecturally to the potential "west side" residential historic district in Washington. The house was built around 1902 for successful businessman and inventor Daniel Wilde and his wife Elizabeth. Daniel was well-known for his foundry and time-saving agricultural inventions, and this house was built for the family when he was 67. The house is an excellent example of the Victorian vernacular style, retaining excellent historic integrity and characteristic features of the style. The outbuilding behind the house is one of the oldest remaining outbuildings in the neighborhood, and it may have significance as a workshop or early garage. Both buildings are contributing to the potential historic district.

The house and outbuilding may also be individually eligible for listing on the National Register of Historic Places under Criteria B for its association with Daniel Wilde or under Criteria C for its architecture. Daniel Wilde was a prominent and significant person in Washington, and this house was built for him at the peak of his career. Further research on Wilde and other extant homes/buildings associated with him would solidify this determination. Additionally, as noted, the house is an excellent example of the Victorian vernacular style with good integrity, and the outbuilding/garage is an early extant example of this type of building.

History / research summary of property

Both the 1869 Bird's Eye View of Washington and the 1874 Atlas of Washington County map of Washington show a building at the west side of Washington on this site, and the Bird's Eye View identifies it as the 2nd U.P. Church. The Trustees of the 2nd U.P. Church transferred Lot 1 to H. & W. Scofield on November 18, 1878. Hiram and William Scofield owned almost all of block 2 in the Southwest Addition at that time. The Scofields were real estate investors and agents, and they owned many other parcels at this time as well. No transfers were identified from the Scofields to anyone else for the south portions of lots 1 and 2. The Scofields sold the north part of the lots (701 W. Washington) to James Work on October 26, 1894. This house sits on the south part of the lots (209 S. Avenue F). Thus, the lots were platted to face W. Washington, but then sold to create two parcels facing S. Avenue F. The 1909 *History of Washington County* notes that the Second U.P. Church had stood on the sites of the homes of Daniel Wilde and James Work, and they built a new church in 1890 (Burrell 1909, Vol. 1: 244). The Wilde and Work families were related, as James Work married Amy Wilde, daughter of Daniel and Elizabeth Wilde. The census for 1900 lists Daniel Wilde in Ward 1, while the James A. Work family at 701 W. Washington, next door to this property, are listed in Ward 4. Thus, it appears that they moved to this house after 1900.

The *Evening Journal* on December 3, 1901 reported a sale of property from H & W Scofield to Daniel Wilde. The newspaper then reported on December 30, 1901 that workmen who have been sinking a

Iowa Site Inventory Form
State Historic Preservation Office
Continuation Sheet

Site Number: 92-00431
Related District Number: 92-00350

Page 4

<u>Daniel and Elizabeth Wilde House</u>	<u>Washington</u>
Name of Property	County
<u>207 S. Avenue F</u>	<u>Washington</u>
Address	City

40-foot well for Daniel Wilde south of the James Work residence struck some old brick at the bottom, likely remnants from earlier days. In December 1902, the newspaper notes: "In the vicinity of Sunset Park, Daniel Wilde has just completed one of the handsomest little cottages in town" ("Recent Improvements," *Evening Journal*, December 23, 1902, 3). The first identified listing for 209 S. Avenue F is the 1903 city directory, which lists Daniel Wilde living here. The 1894 city directory lists Daniel Wilde living at 209 W North, now W 3rd Street. In the 1903 city directory, Daniel Wilde, inventor, and his wife Elizabeth, are living at 209 So. Ave. F. Daniel Wilde started Wilde & Co, agricultural works and foundry, in fall 1863. They received the contract in March 1881 to build a new iron fence around Central Park, replacing the old fence (*Evening Journal*, County centennial edition, July 1936, 63). The foundry made iron storefront columns in the 1890s as well, with an example stamping and remaining on the Columbian Block (1893) in downtown Washington. Several patents to Wilde are noted in the newspaper in the early 1900s. Burrell notes in his 1909 history: "Daniel Wilde is probably our most resourceful and miscellaneous inventor - his brain is a hot-house for the development of ideas. His grain-weigher scheme was his master-piece, a fruitful gem that makes for him a fine income, and is putting his son Walter to the fore as a capable business man in Peoria" (Burrell 1909, Vol. 1: 434). They are listed at 209 S. Avenue F again in the 1910-11 city directory. The 1910 census lists Daniel Wilde, age 75, Elizabeth M., his wife, age 73, and housekeeper Fannie Dexter, age 55 and a widow living at 209 S. Ave. F. On February 8, 1911, James A. Work sold his property next door at 701 W. Washington, and the family moved to Montana. The *Evening Journal* notes on October 30, 1911 that Mrs. J.A. Work, and son James Jr, would be visiting the home of Mr. and Mrs. Daniel Wilde.

The *Evening Journal* on August 27, 1912 reported that Daniel Wilde had invented a new scoop board, an improvement on his popular old model. The scoop board could be seen at this home, 100 feet to the south of the entrance to Sunset Park on W. Washington. The new board opened at four points on the bottom to empty a wagon quickly and easily, eliminating the need to remove the board. It used the same lugs to attach to a wagon as the old board, allowing the new to replace the old for greater time savings. Upon moving back to Washington, James and Amy Work moved in with her mother Elizabeth Wilde. The 1917 county directory lists J.A. Work, traveling salesman, Amy M, his wife, Helen E, a teacher, and James A., a student living at 209 S. Ave. F. The 1920 census identifies the residents at that address as James A. Work, age 69, a real estate and insurance agent, Amy M. his wife, age 67, James A. Jr., age 15, and Elizabeth Wilde, age, 88 and mother-in-law to the head of the household. The Works apparently bought the property, as it was then transferred from James Work to Amy Work on May 24, 1926 (described as "commencing 132 ft. north of the southeast corner of Block 2, west 102 ft., north to point 66 ft. south of north line of said block, east 132 ft., then south to beginning"). The 1926 telephone book lists Mrs. James A. Work, 209 S Ave F. In 1930, the census lists George C. Stewart, hardware and implement salesman, age 32, his wife Ruby M., age 31, and children Clinton, age 8, Roberta, age 7, and Henrietta, age 3, living at 209 S. Ave. F. They rented the house for \$30 per month.

The property was transferred from the Work heirs to Howard G. Richardson and Emma B. Richardson on February 13, 1931, and the Richardson's first appear in the telephone directory in 1932 at 209 S. Avenue F. They are also listed in the 1935 city directory where Howard's employment is Constable. The 1940 census identifies the resident as owner H.G. Richardson, a peace office for the county, age 69, his wife (name illegible), a corset saleslady, age 61, and Hattie McConnell, a registered nurse in

Iowa Site Inventory Form
State Historic Preservation Office
Continuation Sheet

Site Number: 92-00431
Related District Number: 92-00350

Page 5

<u>Daniel and Elizabeth Wilde House</u>	<u>Washington</u>
Name of Property	County
<u>207 S. Avenue F</u>	<u>Washington</u>
Address	City

private nursing, their lodger. The 1941 city directory lists H.G. Richardson as unemployed, and Emma is working as a Spencer Corsetiere. Telephone directories for 1952, through 1958 list Mrs. Emma Richardson at this address.

Emma B. Richardson transferred the property to Raymond J. and Bernadette Van Zile on October 10, 1958. Telephone directories for 1959, 1960, and 1962 have a listing for Ray J. Van Zile at 209 S Ave F. The Van Ziles sold the property to Iva M. Roberts on July 29, 1963, and the 1964 city directory lists E.J. Roberts living here. City directories from 1967 through 1976 list Edward J. Roberts with no employer, and in 1969 and again in 1976, he is listed as retired.

Bibliography

Atlas of Washington County, Iowa. Clinton, IA, and Philadelphia, PA: Harrison and Warner, 1874.

Atlas of Washington County, Iowa. No publisher noted, 1894. In collection of Washington Public Library.

Burrell, Howard A. *History of Washington County, Iowa.* Chicago, IL: S.J. Clarke Publishing Company, 1909. 2 volumes.

City/telephone directories. Washington Public Library. Various years, including 1894, 1903, 1908, 1910-11, 1917, 1932, 1934, 1935, 1938, 1941, 1952, 1954, 1956, 1958, 1960, 1962, 1964, 1967, 1969, 1972, and 1976.

Fisher, Kathy. *In the beginning there was land : a history of Washington County, Iowa.* Washington, Iowa: Washington County Historical Society, 1978.

History of Washington County, Iowa. Des Moines, IA: Union Historical Co., 1880.

Koch, Augustus. *Birds-eye View of the City of Washington.* Chicago: Chicago Lithograph Company, 1869.

Newspapers, including anniversary/celebration editions on microfilm and/or bound at Washington Public Library:

Washington Gazette, January 6, 1893

Twentieth Anniversary Edition, *Evening Journal*, April 26, 1913

Twenty-Fifth Anniversary Edition, *Evening Journal*, April 3, 1926

Washington County Centennial Edition, *Evening Journal*, July 1936

Souvenir Edition of Washington Centennial, *The Evening Journal*, August 1939

Sixtieth Anniversary Edition, *The Washington Evening Journal*, February 27, 1953

Bicentennial edition, *The Washington Evening Journal*, July 1, 1976

Sesquicentennial edition, *The Washington Evening Journal*, April 13, 1989

Iowa Site Inventory Form
State Historic Preservation Office
Continuation Sheet

Site Number: 92-00431
 Related District Number: 92-00350

Page 6

<u>Daniel and Elizabeth Wilde House</u>	<u>Washington</u>
Name of Property	County
<u>207 S. Avenue F</u>	<u>Washington</u>
Address	City

Patterson, Mary. Collection of historic postcards, images, and city/telephone directories. Washington, Iowa. Accessed 2014-2015.

Portrait and Biographical Album of Washington County, Iowa. Chicago, Acme Publishing Company, 1887.

Sanborn Map Company. *Washington, Iowa.* Fire insurance maps. 1885, 1892, 1897, 1902, 1909, 1917, 1931, 1943.

Souvenir History of Washington, Iowa. Washington, IA: Washington Evening Journal, June 23, 1989.

Washington County Historical Society. Collection of historic postcards and photographs.

Location map



2009 aerial photograph (Washington County) – line indicates survey/research area boundary

Iowa Site Inventory Form
State Historic Preservation Office
Continuation Sheet

Site Number: 92-00431
Related District Number: 92-00350

Page 7

Daniel and Elizabeth Wilde House
Name of Property

Washington
County

207 S. Avenue F
Address

Washington
City

Building plan (from assessor's website)

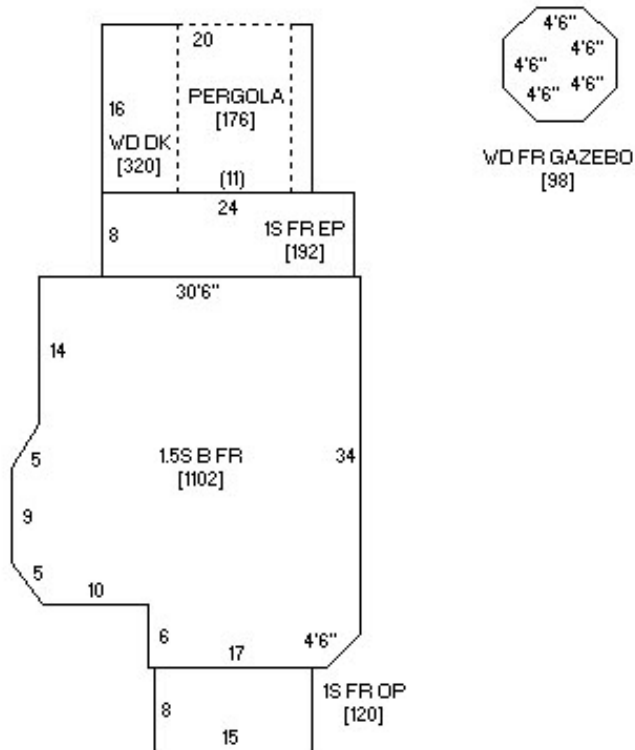

Photo from assessor's website



Iowa Site Inventory Form
State Historic Preservation Office
Continuation Sheet

Site Number: 92-00431
Related District Number: 92-00350

Page 8

Daniel and Elizabeth Wilde House
Name of Property

Washington
County

207 S. Avenue F
Address

Washington
City

Digital photographs



Photograph 92-00431-001 - House, looking northwest (December 2014)

Iowa Site Inventory Form
State Historic Preservation Office
Continuation Sheet

Site Number: 92-00431
Related District Number: 92-00350

Page 9

Daniel and Elizabeth Wilde House
Name of Property

Washington
County

207 S. Avenue F
Address

Washington
City



Photograph 92-00431-002 - House, looking southwest (December 2014)

Iowa Site Inventory Form
State Historic Preservation Office
Continuation Sheet

Site Number: 92-00431
Related District Number: 92-00350

Page 10

Daniel and Elizabeth Wilde House
Name of Property

Washington
County

207 S. Avenue F
Address

Washington
City



Photograph 92-00431-003 - House, looking east (December 2014)

Iowa Site Inventory Form
State Historic Preservation Office
Continuation Sheet

Site Number: 92-00431
Related District Number: 92-00350

Page 11

Daniel and Elizabeth Wilde House
Name of Property

Washington
County

207 S. Avenue F
Address

Washington
City



Photograph 92-00431-004 - Garage, looking northwest (December 2014)

Iowa Site Inventory Form
State Historic Preservation Office
Continuation Sheet

Site Number: 92-00431
Related District Number: 92-00350

Page 12

Daniel and Elizabeth Wilde House
Name of Property

Washington
County

207 S. Avenue F
Address

Washington
City



Photograph 92-00435-005 - Garage, looking southeast (December 2014)