

Iowa Site Inventory Form

State Historic Preservation Office

(July 2014)

State Inventory Number: 92-00765 New Supplemental

9-Digit SHPO Review & Compliance (R&C) Number _____

Non-extant Year: _____

Read the Iowa Site Inventory Form Instructions carefully, to ensure accuracy and completeness before completing this form. The instructions are available on our website: <http://www.iowahistory.org/historic-preservation/statewide-inventory-and-collections/iowa-site-inventory-form.html>

• Property Name

A) Historic name James A. and Amy Work House

B) Other names: West side survey map #WS-082

• Location

A) Street address: 701 W. Washington Street

B) City or town: Washington (Vicinity) County Washington

C) Legal Description:

Rural: Township Name: _____ Township No.: _____ Range No.: _____ Section: _____ Quarter: _____ of Quarter: _____

Urban: Subdivision: Southwest Addition Block(s): 2 Lot(s): N 66' of Lots 1 & 2

• Classification

A) Property category: *Check only one*

- Building(s)
- District
- Site
- Structure
- Object

B) Number of Resources (within property)

If eligible property, enter number of:		If non-eligible property, enter number of:	
Contributing	Noncontributing		
<u>1</u>	Buildings	—	Buildings
—	Sites	—	Sites
—	Structures	—	Structures
—	Objects	—	Objects
<u>1</u>	Total	—	Total

C) For properties listed in the National Register:

National Register status: Listed De-listed NHL NPS DOE

D) For properties within a historic district:

- Property contributes to a National Register or local certified historic district.
- Property contributes to a potential historic district, based on professional historic/architectural survey and evaluation.
- Property *does not* contribute to the historic district in which it is located.

Historic district name: West side residential historic district Historic district site inventory number: 92-00350

Name of related project report or multiple property study, if applicable:

MPD Title

Historical Architectural Data Base #

Architectural and Historical Survey of the "west side" residential neighborhood in Washington 92-013

• **Function or Use** *Enter categories (codes and terms) from the Iowa Site Inventory Form Instructions*

A) Historic functions

01A01: Domestic / residence

B) Current functions

01A01: Domestic / residence

01C05: Domestic / garage

• **Description** *Enter categories (codes and terms) from the Iowa Site Inventory Form Instructions*

A) Architectural Classification

05D Queen Anne

B) Materials

Foundation (visible exterior): 04: Stone

walls (visible exterior): 10B: Vinyl

Roof: 08A: Asphalt shingles

Other: _____

C) Narrative Description SEE CONTINUATION SHEETS, WHICH MUST BE COMPLETED

● **Statement of Significance**

A) Applicable National Register Criteria: *Mark your opinion of eligibility after applying relevant National Register criteria*

- Criterion A: Property is associated with significant events. Yes No More research recommended
 Criterion B: Property is associated with the lives of significant persons. Yes No More Research Recommended
 Criterion C: Property has distinctive architectural characteristics. Yes No More Research Recommended
 Criterion D: Property yields significant information in archeology/history. Yes No More Research Recommended

B) Special criteria considerations: *Mark any special considerations; leave blank if none*

- A Owned by a religious institution or used for religious purposes. E A reconstructed building, object, or structure.
 B Removed from its original location. F A commemorative property.
 C A birthplace or grave. G Less than 50 years of age or
 D A cemetery achieved significance within the past 50 years.

C) Areas of Significance

Enter categories from instructions

Community planning and development

D) Period(s) of significance

E) Significant dates

Construction date

1895 *check if circa or estimated date*

Other dates, including renovations

F) Significant person

Complete if Criterion B is marked above

G) Cultural affiliation

Complete if Criterion D is marked above

H) Architect/Builder

Architect

Builder/contractor

I) Narrative statement of significance **SEE CONTINUATION SHEETS, WHICH MUST BE COMPLETED**

● **Bibliography** *See continuation sheet for the list of research sources used in preparing this form*

● **Geographic Data** *Optional UTM references* *See continuation sheet for additional UTM references or comments*

UTM References (OPTIONAL)

Zone	Easting	Northing	NAD	Zone	Easting	Northing	NAD
1	_____	_____	_____	2	_____	_____	_____
3	_____	_____	_____	4	_____	_____	_____

● **Form Preparation**

Name and Title: Mary Patterson - volunteer Rebecca Lawin McCarley, consultant Date: March 11, 2015

Organization/firm: Washington Historic Preservation Commission E-mail: -

Street address: City Hall, 215 E. Washington St Telephone: 319-653-6584

City or Town: Washington State: Iowa Zip code: 52353

● **ADDITIONAL DOCUMENTATION** *Submit the following items with the completed form*

A) For all properties, attach the following, as specified in the Iowa Site Inventory Form Instructions:

- 1. Map** of property's location within the community.
- 2. Glossy color 4x6 photos labeled** on back with property/building name, address, date taken, view shown, and unique photo number.
- 3. Photo key showing each photo number on a map and/or floor plan, using arrows next to each photo number to indicate the location and directional view of each photograph.**
- 4. Site plan** of buildings/structures on site, identifying boundaries, public roads, and building/structure footprints.

B) For State Historic Tax Credit Part 1 Applications, historic districts and farmsteads, and barns:

See lists of special requirements and attachments in the Iowa Site Inventory Form Instructions.

State Historic Preservation Office (SHPO) Use Only Below This Line

The SHPO has reviewed the Site Inventory and concurs with above survey opinion on National Register eligibility:

- Yes No More Research Recommended
 This is a locally designated property or part of a locally designated district.

Comments: _____

SHPO authorized signature: _____ Date: _____

Iowa Site Inventory Form
State Historic Preservation Office
Continuation Sheet

Site Number: 92-00765
Related District Number: 92-00350

Page 1

<u>James A. and Amy Work House</u>	<u>Washington</u>
Name of Property	County
<u>701 W. Washington Street</u>	<u>Washington</u>
Address	City

Narrative Description

This is a two story frame Queen Anne house located on the southwest corner of the intersection of W. Washington Street and South Avenue F. Sunset Park is located immediately to the west of this property, established in the early 1900s. The house sits on a stone foundation, and it is clad with vinyl siding. The windows are vinyl replacements, and some have shutters. All the windows have aluminum storm /screens. There is a basement level attached garage at the northwest corner of the house, and a one story frame addition at the southwest corner of the house.

The façade, the east elevation, is divided into with a two-story bay window on the left/south and the main section of the house on the right/north. The façade has a wrap around porch which begins at the bay window and continues around the northeast corner past the entry door to the east side of the north gable-roof wing of the house. The porch has wood steps leading up to the corner of the porch at a 45° angle from an angled sidewalk from the steps at the corner of the property. The porch floor is wood, and the railings are vinyl. There is a gable-roof pediment over the steps with beadboard on the gable. The hip roof of the porch is clad in asphalt shingles. The entry sits on a chamfered northeast corner of the house at a 45° angle to the house and faces the steps / corner of the property. The historic wood door has a window in the top half of the door, with decorative wood carving and two wood panels below the window. There is a single light aluminum storm / screen door. To the left of the entry door, facing east, there is a one-over-one-light double-hung vinyl window, and to the left of the entry door, facing north, there is another one-over-one-light double-hung vinyl window on the first story. At the far right side of the porch where it meets the east wall of the north gable-roof window, there is a third one-over-one-light double-hung vinyl window with a lower sill than the other two porch windows on the east wall of the north wing. A one-over-one-light double-hung vinyl window is found on the second story above this window also. There is a two-story bay window on the left/south half of the facade. It has a large single-light fixed window on the center wall of the first story and a one-over-one-light double-hung vinyl window with shutters on the center wall of the second story. The angled walls of the bay window have one-over-one-light double-hung vinyl windows on both the first and second stories. The gable overhangs the angled walls of the bay window, supported by decorative brackets. There is a window size attic vent centered in the gable. The second story of the facade, to the right/north of the bay window, has a one-over-one-light double-hung vinyl window with shutters.

The north elevation is divided into three sections, the side of the main/east section of the house, the gable-roof north wing, and the north side of the one-story rear section. The north side of the east section was described with the porch, with a window on the first story and no windows on the second story. The center gable-roof section extends north from the main form of the house. It has a one-over-one-light double-hung vinyl window centered on the first story. Above it, on the second story, there is a one-over-one-light double-hung vinyl window with shutters. The gable retains an original decorative wood windows, with colored lights around a large center pane. The third section is the north side of the one-story rear section, and it has two smaller one-over-one-light double-hung vinyl windows. There is a two-light wood basement window below the gable, and another matching window in the rear section.

The south elevation is similarly divided into three sections. The right/east section is the side of the main section of the house and front bay window. There is no fenestration on this section. The center

Iowa Site Inventory Form
State Historic Preservation Office
Continuation Sheet

Site Number: 92-00765
Related District Number: 92-00350

Page 2

James A. and Amy Work House	Washington
Name of Property	County
701 W. Washington Street	Washington
Address	City

section is the south gable-roof section, which extends somewhat to the south from the main form of the house. It has two one-over-one-light double-hung vinyl windows evenly spaced on the first story, with similar windows above them on the second story. The gable has a small vent. The third section is the south side of the rear one-story section, and it has a steel entry door with a window. It has a small wood stoop and steps down to a concrete walk. Immediately to the right of the side entry, there is a small one-over-one-light double-hung vinyl window.

The west elevation, the rear of the house, is partly obscured by a one story addition, a three seasons room, and the garage roof. The second story of the main two-story section of the house has a one-over-one-light double-hung vinyl window on the right/south. The one-story rear section appears original, appearing on the first Sanborn map with this block in 1917. It has a hip roof covered with asphalt shingles, vinyl siding, and sits on a stone foundation. It has a one-over-one-light double-hung vinyl window with wood shutters on the left. There is a patio door on the right. There is a small hip-roof dormer at the center of the roof with a single-light vinyl window. A basement garage addition extends west from the rear section, with a driveway through the hill to W. Washington to the north. The assessor lists a construction date of 2001. The roof is flat and has a wood deck over the roofing material, with a vinyl railing around the perimeter. There are wood steps leading from the roof deck down into the yard. At the southwest corner of the one story rear section, and south of the garage/deck, there is a three seasons room clad in vinyl siding and has a gable roof covered with asphalt shingles. The south elevation has nine single-light vinyl casement windows, the east elevation has two single-light vinyl casement windows, the west elevation has six single-light vinyl casement windows, and the north elevation has six single-light vinyl casement windows. At the far left on the north side, a steel entry door leads to the garage roof deck.

Narrative Statement of Significance

The James A. and Amy Work House appears to contribute historically to the potential “west side” residential historic district in Washington. The construction of the Queen Anne house in 1895 was on a prominent site at the west end of W. Washington. The house was built for businessman James Work, owner of a boots and shoe store on the west side of the square. With the later designation of Sunset Park, the house became located on the south side of the entry into the park.

The house does not appear individually eligible for listing on the National Register of Historic Places under Criteria A, B, or C. The vinyl siding and replacement windows have impacted the integrity for individual listing.

History / research summary of property

A large portion of block 2 of the Southwest Addition to Washington was owned in the 1890s by Hiram and William Scofield, real estate investors and agents. On October 26, 1894, they sold part of lots 1 & 2 to James A. Work, described as “commencing at the northeast corner of Block 2, west 124 ft., then south 66 ft, then east 124 ft, then north 66 ft to beginning.” Lots 1 and 2 were originally platted north-

Iowa Site Inventory Form
State Historic Preservation Office
Continuation Sheet

Site Number: 92-00765
Related District Number: 92-00350

Page 3

James A. and Amy Work House	Washington
Name of Property	County
701 W. Washington Street	Washington
Address	City

south to face W. Washington, but this parceled the lots into east-west lots facing S. Avenue F to the east instead. A note in the *Washington Press* on October 31, 1894 says, "James Work will join the Gospel Ridge set ... He has bought the northeast part of the old 2nd U.P. Church grounds, on that high knoll made dry by the dry sermons preached there, and will build in the spring." On April 10, 1895, the *Press* reported, "The frame of Jim Work's new house is up on Gospel Knoll..." and later, in June 1895, the *Press* described the house, "Taking into account the situation and the style of the house, Jim Work has the prettiest place in town. Little towers and points are just the thing for a building on a hillside. Viewed from the street north, especially, it is very striking. We always coveted that building lot. Now some pretty color of paint and it will be perfect." James Work is listed in the 1894 city directory living at 608 N 2nd. He was partner in a shoe store on the west side of the square which advertised from 1895 through 1906. He was also twice elected Supreme President of the Home Guards of the World, a fraternal beneficiary society. The 1900 census lists the family as James A. Work, age 39, a shoe merchant, his wife Amy M., age 38, and daughters Florence, age 12, and Helen, age 8. The 1903 city directory lists J.A. Work, shoe dealer, wife Amy, and Helen, a student, at 701 W. Washington. By 1910, the census includes James A. Work, age 49, his wife Amy M., age 48, daughter Helen, age 18, and son James A. Jr., age 5. The 1910-11 city directory lists James A. Work (wife Amy M.) residing at 701 W Washington, with the shoe store at 107 S Marion. The property was sold to Matthew and Elizabeth Gillespie in February 1911, and the Work family apparently moved to Montana. The *Evening Journal* notes on October 30, 1911 that Mrs. J.A. Work, and son James Jr, would be visiting the home of Mr. and Mrs. Daniel Wilde. They later moved back to Washington and into the house to the south with Amy's mother Elizabeth Wilde.

James A. and Amy Work sold the house to Matthew and Elizabeth Gillespie on February 8, 1911. The 1917 county directory lists Matt Gillespie, retired, and his wife Elizabeth living at this address. The 1920 census lists Matthew and Elizabeth Gillespie living at 701 W. Washington. He is the owner of the house, age 80, while Mrs. Gillespie is age 60. By 1930, the census shows only Mrs. Gillespie, head of the household, age 69 and a widow. Her house is valued at \$3,500. The 1935 city directory lists her as Mrs. Mattie Gillespie, owner. In the 1940 census, she is still living at this address and is age 80. The following year, the city directory lists Mrs. Mattie Gillespie, widow, retired, and Miss Zoe Gillespie, housekeeper.

The Elizabeth J. Gillespie estate transferred interest in the property to Thomas & Wallace McCracken on January 11, 1944. It apparently transferred in family, and in September 1946, Zoe Gillespie sold the property to George C. Stewart. No city directories exist for the late 1940s to confirm if he lived here. In 1930, the census lists George C. Stewart, hardware and implement salesman, age 32, his wife Ruby M., age 31, and children Clinton, age 8, Roberta, age 7, and Henrietta, age 3, renting the house next door at 209 S. Ave. F. The 1941 city directory lists them as living in and owning the house at 421 S. Avenue B, and he was a salesman for Fred L. Stewart Hardware. They owned this house at 701 W. Washington St for five years.

George Stewart sold the property to Keith and Margaret Norton on September 27, 1951. Keith Norton is listed in the 1952 telephone book, at 701 W. Washington, and in subsequent directories through 1960. However, on August 2, 1955, Norton sold the property to Glenn L. and Florence Laffer. In the 1964 city directory, Glenn L. Laffer, retired, is listed as living at this address. Laffers continued to own the

Iowa Site Inventory Form
State Historic Preservation Office
Continuation Sheet

Site Number: 92-00765
Related District Number: 92-00350

Page 4

James A. and Amy Work House	Washington
Name of Property	County
701 W. Washington Street	Washington
Address	City

property but apparently use it as a rental. By the 1967 city directory, the residents are Clifford R. and Verda Braun and sons Dennis and Daryl. He is working as a salesman for Yoder Feeds, and his wife is an employee at Advance Ross Electronics. In the 1969 city directory, he is a district representative for Full-O-Pep Feed with Allied Mills, and Verda is a secretary receptionist for Drs. Vosika, Montgomery, and Martens. Daryl is living at home, but Dennis is not listed here. The 1972 city directory identifies Rev. Leland Grove, pastor of the First Christian Church, his wife Jeanette, and their children Linda Kay, a student at the University of Iowa, and a son Marv at this address.

Bibliography

Atlas of Washington County, Iowa. Clinton, IA, and Philadelphia, PA: Harrison and Warner, 1874.

Atlas of Washington County, Iowa. No publisher noted, 1894. In collection of Washington Public Library.

Burrell, Howard A. *History of Washington County, Iowa.* Chicago, IL: S.J. Clarke Publishing Company, 1909. 2 volumes.

City/telephone directories. Washington Public Library. Various years, including 1894, 1903, 1908, 1910-11, 1917, 1932, 1934, 1935, 1938, 1941, 1952, 1954, 1956, 1958, 1960, 1962, 1964, 1967, 1969, 1972, and 1976.

Fisher, Kathy. *In the beginning there was land : a history of Washington County, Iowa.* Washington, Iowa: Washington County Historical Society, 1978.

History of Washington County, Iowa. Des Moines, IA: Union Historical Co., 1880.

Koch, Augustus. *Birds-eye View of the City of Washington.* Chicago: Chicago Lithograph Company, 1869.

Newspapers, including anniversary/celebration editions on microfilm and/or bound at Washington Public Library:

Washington Gazette, January 6, 1893

Twentieth Anniversary Edition, *Evening Journal*, April 26, 1913

Twenty-Fifth Anniversary Edition, *Evening Journal*, April 3, 1926

Washington County Centennial Edition, *Evening Journal*, July 1936

Souvenir Edition of Washington Centennial, *The Evening Journal*, August 1939

Sixtieth Anniversary Edition, *The Washington Evening Journal*, February 27, 1953

Bicentennial edition, *The Washington Evening Journal*, July 1, 1976

Sesquicentennial edition, *The Washington Evening Journal*, April 13, 1989

Patterson, Mary. Collection of historic postcards, images, and city/telephone directories. Washington, Iowa. Accessed 2014-2015.

Iowa Site Inventory Form
State Historic Preservation Office
Continuation Sheet

Site Number: 92-00765
Related District Number: 92-00350

Page 5

Name of Property	James A. and Amy Work House	County	Washington
Address	701 W. Washington Street	City	Washington

Portrait and Biographical Album of Washington County, Iowa. Chicago, Acme Publishing Company, 1887.

Sanborn Map Company. *Washington, Iowa.* Fire insurance maps. 1885, 1892, 1897, 1902, 1909, 1917, 1931, 1943.

Souvenir History of Washington, Iowa. Washington, IA: Washington Evening Journal, June 23, 1989.

Washington County Historical Society. Collection of historic postcards and photographs.

Location map



2009 aerial photograph (Washington County) – line indicates survey/research area boundary

Iowa Site Inventory Form
State Historic Preservation Office
Continuation Sheet

Site Number: 92-00765
 Related District Number: 92-00350

Page 6

Name of Property	James A. and Amy Work House	County	Washington
Address	701 W. Washington Street	City	Washington

Building plan (from assessor's website)

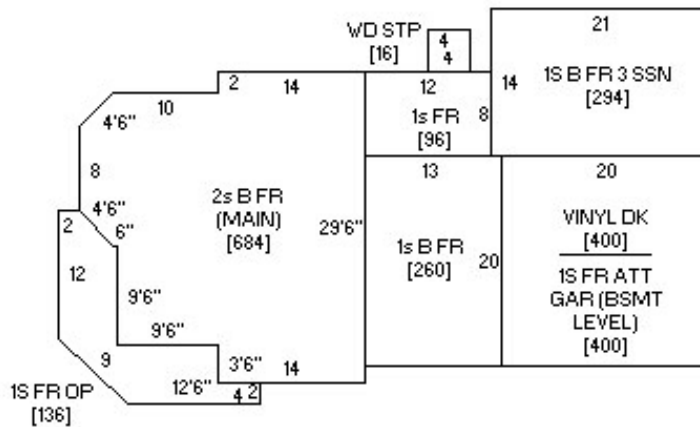

Photo from assessor's website



Iowa Site Inventory Form
State Historic Preservation Office
Continuation Sheet

Site Number: 92-00765
Related District Number: 92-00350

Page 7

James A. and Amy Work House
Name of Property

Washington
County

701 W. Washington Street
Address

Washington
City

Digital photographs



Photograph 92-00765-001 - House, looking southwest (December 2014)

Iowa Site Inventory Form
State Historic Preservation Office
Continuation Sheet

Site Number: 92-00765
Related District Number: 92-00350

Page 8

James A. and Amy Work House
Name of Property

Washington
County

701 W. Washington Street
Address

Washington
City



Photograph 92-00765-002 - House, looking northwest (December 2014)

Iowa Site Inventory Form
State Historic Preservation Office
Continuation Sheet

Site Number: 92-00765
Related District Number: 92-00350

Page 9

James A. and Amy Work House
Name of Property

Washington
County

701 W. Washington Street
Address

Washington
City



Photograph 92-00765-003 - House, looking southeast (December 2014)