

Iowa Site Inventory Form

State Historic Preservation Office

(July 2014)

State Inventory Number: 92-00411 New Supplemental

9-Digit SHPO Review & Compliance (R&C) Number _____

Non-extant Year: _____

Read the Iowa Site Inventory Form Instructions carefully, to ensure accuracy and completeness before completing this form. The instructions are available on our website: <http://www.iowahistory.org/historic-preservation/statewide-inventory-and-collections/iowa-site-inventory-form.html>

● **Property Name**

A) Historic name William A. and Josephine Stiles House

B) Other names: Dr. Charles W. and Bessie McLaughlin House, West side survey map #WS-091

● **Location**

A) Street address: 308 W. Main Street

B) City or town: Washington (Vicinity) County Washington

C) Legal Description:

Rural: Township Name: _____ Township No.: _____ Range No.: _____ Section: _____ Quarter: _____ of Quarter: _____

Urban: Subdivision: _____ Block(s): _____ Lot(s): _____

● **Classification**

A) Property category: *Check only one*

- Building(s)
- District
- Site
- Structure
- Object

B) Number of Resources (within property)

If eligible property, enter number of:		If non-eligible property, enter number of:	
Contributing	Noncontributing		
<u>2</u>	Buildings	—	Buildings
—	Sites	—	Sites
—	Structures	—	Structures
—	Objects	—	Objects
<u>2</u>	Total	—	Total

C) For properties listed in the National Register:

National Register status: Listed De-listed NHL NPS DOE

D) For properties within a historic district:

- Property contributes to a National Register or local certified historic district.
- Property contributes to a potential historic district, based on professional historic/architectural survey and evaluation.
- Property *does not* contribute to the historic district in which it is located.

Historic district name: West side residential historic district Historic district site inventory number: 92-00350

Name of related project report or multiple property study, if applicable:

MPD Title

Historical Architectural Data Base #

Architectural and Historical Survey of the "west side" residential neighborhood in Washington 92-013

● **Function or Use** *Enter categories (codes and terms) from the Iowa Site Inventory Form Instructions*

A) Historic functions

B) Current functions

01A01: Domestic / residence

01A01: Domestic / residence

● **Description** *Enter categories (codes and terms) from the Iowa Site Inventory Form Instructions*

A) Architectural Classification

B) Materials

09A01: Gable front house

Foundation (visible exterior): 04: Stone

walls (visible exterior): 05E: Aluminum

Roof: 08A: Asphalt shingles

Other: _____

C) Narrative Description **SEE CONTINUATION SHEETS, WHICH MUST BE COMPLETED**

● **Statement of Significance**

A) Applicable National Register Criteria: *Mark your opinion of eligibility after applying relevant National Register criteria*

- Criterion A: Property is associated with significant events. Yes No More research recommended
- Criterion B: Property is associated with the lives of significant persons. Yes No More Research Recommended
- Criterion C: Property has distinctive architectural characteristics. Yes No More Research Recommended
- Criterion D: Property yields significant information in archeology/history. Yes No More Research Recommended

B) Special criteria considerations: *Mark any special considerations; leave blank if none*

- A Owned by a religious institution or used for religious purposes. E A reconstructed building, object, or structure.
- B Removed from its original location. F A commemorative property.
- C A birthplace or grave. G Less than 50 years of age or achieved significance within the past 50 years.
- D A cemetery

C) Areas of Significance

Enter categories from instructions

Community planning and development

D) Period(s) of significance

E) Significant dates

Construction date

1870 *check if circa or estimated date*

Other dates, including renovations

F) Significant person

Complete if Criterion B is marked above

G) Cultural affiliation

Complete if Criterion D is marked above

H) Architect/Builder

Architect

Builder/contractor

I) Narrative statement of significance **SEE CONTINUATION SHEETS, WHICH MUST BE COMPLETED**

● **Bibliography** *See continuation sheet for the list of research sources used in preparing this form*

● **Geographic Data** *Optional UTM references* *See continuation sheet for additional UTM references or comments*

UTM References (OPTIONAL)

Zone	Easting	Northing	NAD	Zone	Easting	Northing	NAD
1				2			
3				4			

● **Form Preparation**

Name and Title: June Henderson - volunteer Rebecca Lawin McCarley, consultant Date: June 12, 2015

Organization/firm: Washington Historic Preservation Commission E-mail: -

Street address: City Hall, 215 E. Washington St Telephone: 319-653-6584

City or Town: Washington State: Iowa Zip code: 52353

● **ADDITIONAL DOCUMENTATION** *Submit the following items with the completed form*

A) For all properties, attach the following, as specified in the Iowa Site Inventory Form Instructions:

1. **Map** of property's location within the community.
2. **Glossy color 4x6 photos labeled** on back with property/building name, address, date taken, view shown, and unique photo number.
3. **Photo key showing each photo number on a map and/or floor plan, using arrows next to each photo number to indicate the location and directional view of each photograph.**
4. **Site plan** of buildings/structures on site, identifying boundaries, public roads, and building/structure footprints.

B) For State Historic Tax Credit Part 1 Applications, historic districts and farmsteads, and barns:

See lists of special requirements and attachments in the Iowa Site Inventory Form Instructions.

State Historic Preservation Office (SHPO) Use Only Below This Line

The SHPO has reviewed the Site Inventory and concurs with above survey opinion on National Register eligibility:

- Yes No More Research Recommended
- This is a locally designated property or part of a locally designated district.*

Comments: _____

SHPO authorized signature: _____ Date: _____

Iowa Site Inventory Form
State Historic Preservation Office
Continuation Sheet

Site Number: 92-00411
Related District Number: 92-00350

Page 1

William A. and Josephine Stiles House
Name of Property

Washington
County

308 W. Main Street
Address

Washington
City

Narrative Description

This is a two-story, gable front, frame house built in the early 1870s. The foundation is stone covered with stucco on the original section of the house and concrete block on the addition. The cross gable roof has asphalt shingles. There is a garage at the rear of the lot.

The house faces south with a narrowing south section extending to the south. This section has a porch that wraps around the east, south, and west sides. The entry is found around the southwest corner of the front, on the south side of the original west section. The south side of this front/south section has a picture window with transom on the first story and paired one-over-one-light double-hung windows on the second story. A small gable-roof porch extends in front of these windows. The east and west sides of this south section each have a one-over-one-light double-hung window on the first and second stories. The south side of the west section has the entry on the first story and a one-over-one-light double-hung window on the second story. The south side of the east section has a decorative small window on the first story and a one-over-one-light double-hung window on the second story.

The east side of the house has three sections. The first is the side of the front/south section, described above. The second is the cross-gable east side section. It has a square bay window on the first story, which sits on a stone foundation and has one-over-one-light double-hung windows on each side. The second story has paired one-over-one-light double-hung windows. The gable has a continuous return and a small one-over-one-light double-hung window. The third section is the enclosed side porch on the east side of the rear section of the house. An open one-story porch appears here on Sanborn maps through 1909, with an enclosed two-story porch on the 1917 map. The first story is slightly larger than the second story, supporting this evolution. The east side of the first story has four one-over-one-light double-hung windows. The second story has two one-over-one-light double-hung windows.

The west side has four sections. The first/south one is the side of the front/south section, described above. The second is a cross-gable side section, which has a one-over-one-light double-hung window on each story. The third is a cross-gable side section that extends further west than the previous section, which also has a one-over-one-light double-hung window on each story. It has a gable with a continuous sill and a small one-over-one-light double-hung window. The fourth/rear section is the side of the rear addition, constructed in place of the rear porch shown on the 1943 map. It also extends further west than the previous section, and it has a six-over-six-light double-hung vinyl window on this small south side. No fenestration is found on the west side, though a bump out in the center suggests an interior fireplace.

The north/rear elevation has the main gable-roof two-story section of the house visible above/around the rear addition. It has a small one-over-one-light double-hung window on the first story, and a larger centered one-over-one-light double-hung window on the second story. Another one-over-one-light double-hung window is located to the right/west, on the rear of the west side section. The gable has a continuous return and a small one-over-one-light double-hung window. The east portion of the north elevation is the north side of the enclosed side porch. It has two one-over-one-light double-hung windows on the first story and a smaller one-over-one-light double-hung window on the second story. The one-story rear addition extends to the north from the west half of the first story of the house. It has

Iowa Site Inventory Form
State Historic Preservation Office
Continuation Sheet

Site Number: 92-00411
Related District Number: 92-00350

Page 2

<u>William A. and Josephine Stiles House</u>	<u>Washington</u>
Name of Property	County
<u>308 W. Main Street</u>	<u>Washington</u>
Address	City

a wood deck along the east side, with a side entry located close to the original portion of the house. There are two six-over-six-light double-hung vinyl windows to the north on the east side. The north side has three six-over-six-light double-hung vinyl windows on this addition. A daycare currently operates in this addition.

A two-car gable-oriented frame garage in the northeast corner of the lot is accessed from Main Street to the south. The 1931 and 1943 Sanborn maps show a garage toward the northwest corner of the lot. This garage thus appears to have been built after 1943, though the style of the wood siding suggests perhaps in the 1950s. The south side has a two-car garage door. A six-light window is located on the north side, and a boarded up window is found on the east side.

Narrative Statement of Significance

The William A. and Josephine Stiles House appears to contribute historically to the potential “west side” residential historic district in Washington. The house was likely built in the early 1870s, reflecting the early development of this neighborhood. William A. Stiles was a carpenter/contractor who worked in Washington from the 1860s until his death in 1902. The house was then owned by Dr. Charles W. McLaughlin from 1903 until his death in 1957. He was a prominent local physician, recognized in 1956 for his 60 years of practice.

The house may be individually eligible for listing on the National Register of Historic Places under Criterion B. Additional research on William A. Stiles and/or Dr. Charles W. McLaughlin would be needed to fully assess their significance. Further evaluation of the interior of the house would also be needed, as the integrity of the exterior has been somewhat compromised. The house does not appear individually eligible under Criteria A or C.

History / research summary of property

William Stiles arrived in Washington County from Maryland via Ohio in 1855. He married Josephine Mealey in Washington on April 10, 1857. He served in Company H of the 2nd Iowa Volunteer Infantry in the Civil War. Stiles purchased Lot 7 sometime before 1867 when transfers are first recorded in the transfer books. His obituary notes that he has lived at the same location since his marriage (1857). A small one story side-gable house appears on the 1869 Bird's Eye View drawing of Washington at approximately this location. The 1870 census lists the family living in Washington, including William A. Stiles, age 37, a carpenter with real estate valued at \$2,000, his wife Josephine, age 30, and children Vincent H., age 11, George E., age 9, Ida, age 8, Henrietta, age 6, Grace, age 4, and Lillian, age 1. The 1874 map shows a larger house on this lot, longer from north-south with a side section. It appears to be the current house, placing construction likely in the early 1870s. The assessor lists an estimated construction date of 1885, and it is possible/consistent that it may have been built later. However, if it is the same house that appears on the 1874 map, then it was prior to this date. As William Stiles was a carpenter / contractor, it is likely that he built a larger home for his family as he became successful. He continued to work on large buildings and homes in Washington through the 1890s. The 1885 Iowa

Iowa Site Inventory Form
State Historic Preservation Office
Continuation Sheet

Site Number: 92-00411
Related District Number: 92-00350

Page 3

<u>William A. and Josephine Stiles House</u>	<u>Washington</u>
Name of Property	County
<u>308 W. Main Street</u>	<u>Washington</u>
Address	City

census lists the family as William A. Stiles, age 52, a carpenter living in block 6 on Main Street. The household includes his wife Josephine, age 45, Etta, age 21, teacher, George E., age 24, "B. Carpenter," Grace, age 19, Lillian, age 16, Minnie R., age 14, Howard H., age 11, Viola M., age 9, and Albert, age 7. The 1892 Sanborn map shows the current house on Lot 7, with two one-story outbuildings at the north end of the lot on the alley. In the 1894 city directory, W.A. Stiles is listed as living at 304 W. Main. The 1900 census lists the household as William A. Stiles, age 67, who owns his home, and his wife Josephine, age 60; Thomas, a son, age 22, single; Lillian Haggott, a daughter, age 31, widow, with grandson William S. Haggott, age 7; and Abigail Maley, mother-in-law, age 86, widow. The 1902 Sanborn map shows the house with a larger back porch, and with three outbuildings instead of two. William Stiles died suddenly of a heart attack in December 1902. His obituary notes that he was a carpenter, who had done contracting work in the city since the Civil War ("Sudden Death of W.A. Stiles," *Evening Journal*, December 30, 1902).

In early 1903, Josephine Stiles, a widow, sold the property to Dr. C.W. McLaughlin, who moved into Washington from Crawfordsville at this time. The 1903 city directory lists Dr. C.W. McLaughlin, physician, living at 308 W Main Street with his wife Bessie H. and daughter Maurine. On the 1909 Sanborn map, the back porch has been enclosed, and the outbuilding nearest the house is gone. The 1910-11 city directory lists Charles W. McLaughlin, Physician & Surgeon, office at 209 W. Main, residing with his wife Bessie at 308 W. Main Street. The 1910 census identifies the family as Charles W. McLaughlin, a physician in general practice, and home owner with no mortgage, age 40, his wife Bessie B., age 38, and daughter Maurine, age 9 and son Charles, age 4. The 1917 Sanborn map shows the house without the enclosed back porch, and with the rear side porch now enclosed, and the front porch expanded to all three sides of the protruding front portion of the house. In addition, there is now only one outbuilding on the alley. The 1920 census describes the family as Charles W. McLaughlin, a doctor in medicine and a home owner, age 49, his wife Bessie, age 48, and their children Maurine, age 18, and Charles Jr. age 13. The 1930 census lists the value of the house at \$6,000. The household includes Charles W. McLaughlin, age 60, medical doctor; wife Bessie B., she 58, and son Charles W., age 24, no occupation. The 1931 Sanborn map shows a new open back porch on the house, and a new auto garage near the location of the earlier outbuilding at the northwest corner of the lot. In 1935, the city directory lists Dr. C.W. McLaughlin at this address. The 1932 and 1938 telephone directories list Dr. C.W. McLaughlin's office at 213 W. Main Street, and his residence at 308 W. Main Street. The 1941 census lists Charles W. McLaughlin, age 70, and his wife Bessie, age 68, living at this address, and he lists his occupation as Surgeon / Medical Doctor. The 1941 city directory listing for Dr. McLaughlin, physician, lists his wife as Bess, and they are still living at this address. Telephone directories from 1952 through 1958 continue to list the McLaughlins living here. Dr. McLaughlin kept his medical office at 213 W. Main Street until 1956.

Dr. C.W. McLaughlin died on May 27, 1957. His obituary notes that he was born in Washington County on February 5, 1870. He graduated from the Washington Academy in 1891 and then from Monmouth College in 1893. He completed his doctorate degree at the University of Iowa in 1896. He married Bessie Hamilton on May 20, 1897. Dr. McLaughlin practiced medicine in Crawfordsville from 1896 to 1903 and then moved to Washington. He was active as a obstetrician and pediatrician in town for many years. He was featured in a story in the *Ladies Home Journal* on "The Country Doctor" for a rescue of a nurse from a swollen stream on their way to deliver a baby. The Washington County

Iowa Site Inventory Form
State Historic Preservation Office
Continuation Sheet

Site Number: 92-00411
Related District Number: 92-00350

Page 4

William A. and Josephine Stiles House
Name of Property

Washington
County

308 W. Main Street
Address

Washington
City

Medical Society honored him with a gold medal and dinner for 50 years of practice in 1946, and the State Medical Society made him an honorary member. In 1956, the community of Washington honored him for practicing medicine for 60 years ("Dr. C.W. McLaughlin Dies," *Evening Journal*, May 28, 1957).

On August 1, 1957, executors of the C.W. McLaughlin estate, Richard McCleery & Charles W. McLaughlin Jr., sold the property to Dale & Helen Woodburn. The 1958 through 1962 telephone directories list Dale Woodburn at 308 W. Main Street. The 1964 city directory lists Dale as a farmer and Helen as a head cook at Washington Community Schools. They are listed with the same information in the 1967 and 1969 city directories. Dale died in 1971. On July 14, 1972, the property was transferred to Helen Woodburn and she continued to live here. According to the 1972 city directory, Helen's mother, Mrs. Sarah Elizabeth Young also lived here at that time and died in April 1975. Helen died in November 1975.

Iowa Site Inventory Form
State Historic Preservation Office
Continuation Sheet

Site Number: 92-00411
Related District Number: 92-00350

Page 5

William A. and Josephine Stiles House
Name of Property

Washington
County

308 W. Main Street
Address

Washington
City

Bibliography

Atlas of Washington County, Iowa. Clinton, IA, and Philadelphia, PA: Harrison and Warner, 1874.

Atlas of Washington County, Iowa. No publisher noted, 1894. In collection of Washington Public Library.

Burrell, Howard A. *History of Washington County, Iowa.* Chicago, IL: S.J. Clarke Publishing Company, 1909. 2 volumes.

City/telephone directories. Washington Public Library. Various years, including 1894, 1903, 1908, 1910-11, 1917, 1932, 1934, 1935, 1938, 1941, 1952, 1954, 1956, 1958, 1960, 1962, 1964, 1967, 1969, 1972, and 1976.

Fisher, Kathy. *In the beginning there was land : a history of Washington County, Iowa.* Washington, Iowa: Washington County Historical Society, 1978.

History of Washington County, Iowa. Des Moines, IA: Union Historical Co., 1880.

Koch, Augustus. *Birds-eye View of the City of Washington.* Chicago: Chicago Lithograph Company, 1869.

Newspapers, including anniversary/celebration editions on microfilm and/or bound at Washington Public Library:

Washington Gazette, January 6, 1893

Twentieth Anniversary Edition, *Evening Journal*, April 26, 1913

Twenty-Fifth Anniversary Edition, *Evening Journal*, April 3, 1926

Washington County Centennial Edition, *Evening Journal*, July 1936

Souvenir Edition of Washington Centennial, *The Evening Journal*, August 1939

Sixtieth Anniversary Edition, *The Washington Evening Journal*, February 27, 1953

Bicentennial edition, *The Washington Evening Journal*, July 1, 1976

Sesquicentennial edition, *The Washington Evening Journal*, April 13, 1989

Patterson, Mary. Collection of historic postcards, images, and city/telephone directories. Washington, Iowa. Accessed 2014-2015.

Portrait and Biographical Album of Washington County, Iowa. Chicago, Acme Publishing Company, 1887.

Sanborn Map Company. *Washington, Iowa.* Fire insurance maps. 1885, 1892, 1897, 1902, 1909, 1917, 1931, 1943.

Souvenir History of Washington, Iowa. Washington, IA: Washington Evening Journal, June 23, 1989.

Washington County Historical Society. Collection of historic postcards and photographs.

Iowa Site Inventory Form
State Historic Preservation Office
Continuation Sheet

Site Number: 92-00411
Related District Number: 92-00350

Page 6

William A. and Josephine Stiles House
Name of Property

Washington
County

308 W. Main Street
Address

Washington
City

Location map



2009 aerial photograph (Washington County) – line indicates survey/research area boundary

Iowa Site Inventory Form
State Historic Preservation Office
Continuation Sheet

Site Number: 92-00411
Related District Number: 92-00350

Page 7

William A. and Josephine Stiles House
Name of Property

Washington
County

308 W. Main Street
Address

Washington
City

Building plan (from assessor's website)

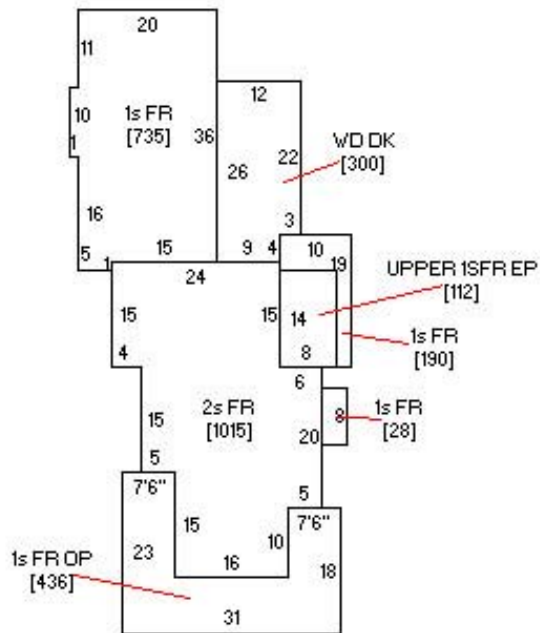

Photo from assessor's website



Iowa Site Inventory Form
State Historic Preservation Office
Continuation Sheet

Site Number: 92-00411
Related District Number: 92-00350

Page 8

William A. and Josephine Stiles House
Name of Property

Washington
County

308 W. Main Street
Address

Washington
City

Digital photographs



Photograph 92-00411-001 - House, looking northwest (December 2014)

Iowa Site Inventory Form
State Historic Preservation Office
Continuation Sheet

Site Number: 92-00411
Related District Number: 92-00350

Page 9

William A. and Josephine Stiles House
Name of Property

Washington
County

308 W. Main Street
Address

Washington
City



Photograph 92-00411-002 - House, looking northeast (December 2014)

Iowa Site Inventory Form
State Historic Preservation Office
Continuation Sheet

Site Number: 92-00411
Related District Number: 92-00350

Page 10

William A. and Josephine Stiles House
Name of Property

Washington
County

308 W. Main Street
Address

Washington
City



Photograph 92-00411-003 - House, looking northwest (December 2014)

Iowa Site Inventory Form
State Historic Preservation Office
Continuation Sheet

Site Number: 92-00411
Related District Number: 92-00350

Page 11

William A. and Josephine Stiles House
Name of Property

Washington
County

308 W. Main Street
Address

Washington
City



Photograph 92-00411-004 - House, looking southwest (December 2014)

Iowa Site Inventory Form
State Historic Preservation Office
Continuation Sheet

Site Number: 92-00411
Related District Number: 92-00350

Page 12

William A. and Josephine Stiles House
Name of Property

Washington
County

308 W. Main Street
Address

Washington
City



Photograph 92-00411-005 - House, looking southeast (December 2014)

Iowa Site Inventory Form
State Historic Preservation Office
Continuation Sheet

Site Number: 92-00411
Related District Number: 92-00350

Page 13

William A. and Josephine Stiles House
Name of Property

Washington
County

308 W. Main Street
Address

Washington
City



Photograph 92-00411-006 - Garage, looking northwest (December 2014)